LIST OF FIGURES

Title

- 1-1 Locations of Operable Units (OUs)
- 2.1-1 Housatonic River Sediment Sampling Locations West of Newell Street Bridge
- 2.1-2 Housatonic River Sediment Sampling Locations East of Newell Street Bridge
- 3.3.1-1 East Street Area 1 USEPA Area 3 SWMU Locations
- 3.3.1-2 Locations of Miscellaneous Investigations
- 3.3.1-3 Extent of PCBs in Surface Soil, East Street Area 1/US EPA Area 3
- 3.3.1-4 Pipelines Retained for Phase III Analysis
- 3.3.1-5 Summary of Select Groundwater Data
- 3.3.1-6 Oil Plume Map—October 1983
- 3.3.1-7 Locations of Remaining Oil Occurrences—October 1997
- 3.3.2-1 Site Layout and Potential Contaminant Source Areas
- 3.3.2-2 Extent of PCBs in Surface Soil, East Street Area 2/USEPA Area 4
- 3.3.2-3 Oil Plume Map—October 1997
- 3.3.2-4 Oil Plume Map—April 1997, East Street Area 2
- 3.3.2-5 DNAPL Measurements, East Street Area 2
- 3.3.2-6 Building 68 DNAPL Area Cross Section
- 3.3.2-7 Housatonic River Outfalls
- 3.3.2-8 Monitoring Well and Soil Sampling Locations, East Street Area 2—1996
- 3.3.2-9 Interpreted Groundwater Contour Map, East Street Area 2—1996
- 3.3.2-10 Groundwater Flow Simulation—East Street Area 2 Recovery System—1997
- 3.3.2-11 Riverbank Area Groundwater Elevation Contour Map—6/4,5/97
- 3.3.2-12 Interpreted Contour Map Top of Till—East Street Area 2
- 3.3.3-1 Hill 78 Area Potential Source Areas
- 3.3.3-2 Pipelines Retained for Phase III Analysis
- 3.3.3-3 Summary of Select Groundwater Data
- 3.3.3-4 Extent of PCBs in Surface Soil, Hill 78 Area/USEPA Area 2
- 3.3.4-1 Unkamet Brook Location Map, Unkamet Brook Area/USEPA Area 1

LIST OF FIGURES (Continued)

Section

- 3.3.4-2 Extent of PCBs in Surface Soil, Unkamet Brook Area
- 3.3.5-1 LNAPL/DNAPL Extent
- 3.3.5-2 Interpretive Top of Silt Elevation Contours
- 3.3.5-3 Extent of PCBs in Surface Soil, Lyman Street Area
- 3.3.5-4 Interpretive Groundwater Elevation Contours—January 1998
- 3.5-1 Summary of Horizontal Extent of PCBs in Soil at Allendale School
- 3.6-1 Facility Drainage
- 3.6-2 Additional Municipal Sewer Outfalls into Silver Lake
- 3.6-3 [Summary of Silver Lake Sediment Sampling Locations and PCB Data](#)
- 3.6-4 [Silver Lake Floodplain Soil Sampling Locations and PCB Results](#)
- 3.6-5 [Location of Monitoring Wells Near Silver Lake](#)
- 3.7-1 Location Plan for Newell Street Area I and Area II
- 3.7-2 Limit of Approximate 10-Year Floodplain for Newell Street Area I and II
- 3.7-3 Newell Street Area NAPL Well Location Map
- 3.8-1 Sampling Locations for Oxbow Areas A, B, and C
- 3.8-2 Soil PCB Data for Oxbow Areas A, B, and C
- 3.8-3 Sampling Locations for Oxbow Areas J and K
- 3.8-4 Soil PCB Data for Oxbow Areas J and K
- 5-1 Identified Contaminant Source Areas

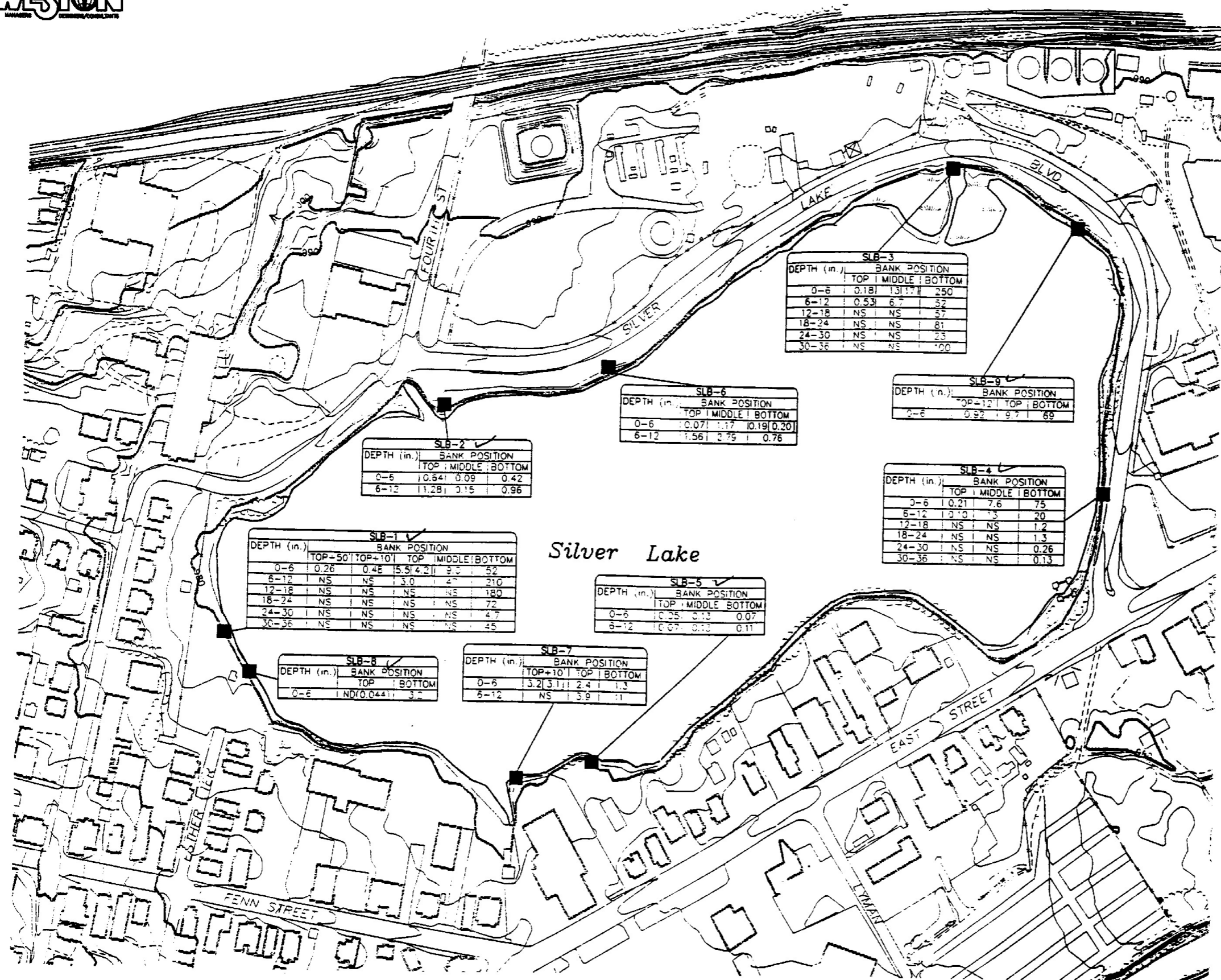

SLB-1

DEPTH (in.)	BANK POSITION				
	TOP-50'	TOP-10'	TOP	MIDDLE	BOTTOM
0-6	0.26	0.46	5.5	4.2	9.0
6-12	NS	NS	3.0	4	210
12-18	NS	NS	NS	NS	180
18-24	NS	NS	NS	NS	72
24-30	NS	NS	NS	NS	4.7
30-36	NS	NS	NS	NS	45

SLB-2

DEPTH (in.)	BANK POSITION		
	TOP	MIDDLE	BOTTOM
0-6	0.54	0.09	0.42
6-12	1.28	0.15	0.96

SLB-6

DEPTH (in.)	BANK POSITION		
	TOP	MIDDLE	BOTTOM
0-6	0.07	1.17	10.19
6-12	1.56	2.79	0.76

SLB-3

DEPTH (in.)	BANK POSITION		
	TOP	MIDDLE	BOTTOM
0-6	0.18	131.7	250
6-12	0.53	6.7	52
12-18	NS	NS	57
18-24	NS	NS	81
24-30	NS	NS	23
30-36	NS	NS	100

SLB-4

DEPTH (in.)	BANK POSITION		
	TOP	MIDDLE	BOTTOM
0-6	0.21	7.6	75
6-12	0.13	3	20
12-18	NS	NS	1.2
18-24	NS	NS	1.3
24-30	NS	NS	0.26
30-36	NS	NS	0.13

SLB-5

DEPTH (in.)	BANK POSITION		
	TOP	MIDDLE	BOTTOM
0-6	0.05	0.13	0.07
6-12	0.07	0.13	0.11

SLB-8

DEPTH (in.)	BANK POSITION	
	TOP	BOTTOM
0-6	ND(0.044)	3.2

SLB-7

DEPTH (in.)	BANK POSITION		
	TOP+10'	TOP	BOTTOM
0-6	3.2	3.1	2.4
6-12	NS	3.9	1.1

SLB-9

DEPTH (in.)	BANK POSITION		
	TOP	MIDDLE	BOTTOM
0-6	0.92	1.97	69

LEGEND

- APPROXIMATE AREA SUBJECT TO SOIL SAMPLING
- SAMPLE ID
- DISTRIBUTION OF TOTAL PCBs (ppm DRY WT.) VALUES ARE SHOWN FOR CONSECUTIVE 6" INTERVALS
- ND= NOT DETECTED
- DETECTION LIMITS SHOWN IN PARENTHESES.
- BRACKETS INDICATE DUPLICATE ANALYSIS.
- NS= NOT SAMPLED.
- EDGE OF WATER (SURFACE ELEVATION: 976.00' ON APRIL 28, 1995)
- PAVED ROADWAY
- - - UNPAVED ROADWAY OR TRAIL
- RAILROAD
- FENCELINE
- 970 — ELEVATION CONTOUR
- VEGETATION
- MARSH AREA

NOTES:

1. THE BASE MAP FEATURES PRESENTED ON THIS FIGURE WERE PHOTOGRAMMETRICALLY MAPPED FROM APRIL 1990 AERIAL PHOTOGRAPHS.
2. BANK SAMPLING LOCATIONS WERE SURVEYED BY BLASLAND, BOUCK & LEE, INC., BUT ARE ILLUSTRATED AS APPROXIMATE.

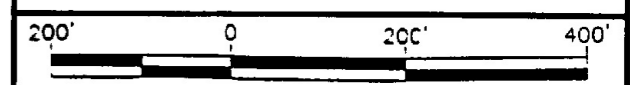

APPROXIMATE SCALE: 1"=200'

Map produced by WESTON adapted from Blasland, Bouck & Lee, Inc.

Source Area Characterization Report
 Pittsfield/Housatonic River Site
 Pittsfield, Massachusetts
FIGURE 3.6-4
SILVER LAKE FLOODPLAIN
SOIL SAMPLING LOCATIONS
AND PCB RESULTS

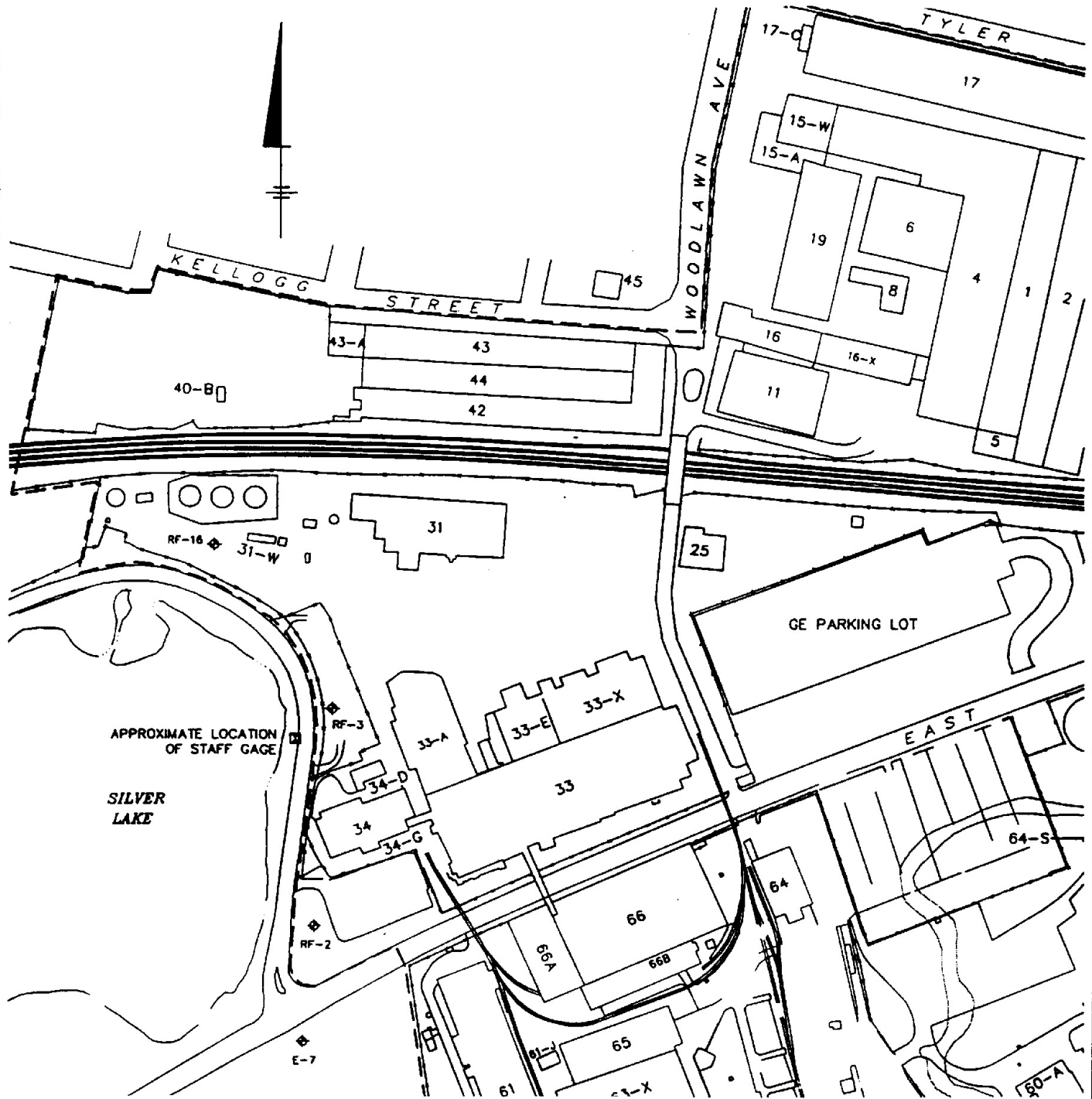

LEGEND:

- RF-3 EXISTING MONITORING WELL
- STAFF GAGE

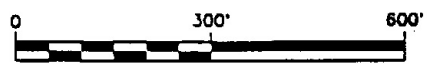

APPROXIMATE SCALE: 1" = 300'

Map produced by WESTON adapted from Blasland, Bouck & Lee, Inc.

NOTES:

1. MAPPING IS BASED ON AERIAL PHOTOGRAPHS AND PHOTOGRAMMETRIC MAPPING BY LOCKWOOD MAPPING, INC. - FLOWN IN APRIL 1990 AND DATA PROVIDED BY GENERAL ELECTRIC COMPANY.
2. NOT ALL PHYSICAL FEATURES SHOWN.
3. ALL MONITORING WELL LOCATIONS ARE APPROXIMATE.

**Source Area Characterization Report
 Pittsfield/Housatonic River Site
 Pittsfield, Massachusetts**

**FIGURE 3.6-5
 LOCATION OF MONITORING
 WELLS NEAR SILVER LAKE**