LIST OF FIGURES

Title

- 1-1 Locations of Operable Units (OUs)
- 2.1-1 Housatonic River Sediment Sampling Locations West of Newell Street Bridge
- 2.1-2 Housatonic River Sediment Sampling Locations East of Newell Street Bridge
- 3.3.1-1 East Street Area 1 USEPA Area 3 SWMU Locations
- 3.3.1-2 Locations of Miscellaneous Investigations
- 3.3.1-3 Extent of PCBs in Surface Soil, East Street Area 1/US EPA Area 3
- 3.3.1-4 Pipelines Retained for Phase III Analysis
- 3.3.1-5 Summary of Select Groundwater Data
- 3.3.1-6 Oil Plume Map—October 1983
- 3.3.1-7 Locations of Remaining Oil Occurrences—October 1997
- 3.3.2-1 Site Layout and Potential Contaminant Source Areas
- 3.3.2-2 Extent of PCBs in Surface Soil, East Street Area 2/USEPA Area 4
- 3.3.2-3 Oil Plume Map—October 1997
- 3.3.2-4 Oil Plume Map—April 1997, East Street Area 2
- 3.3.2-5 DNAPL Measurements, East Street Area 2
- 3.3.2-6 Building 68 DNAPL Area Cross Section
- 3.3.2-7 Housatonic River Outfalls
- 3.3.2-8 Monitoring Well and Soil Sampling Locations, East Street Area 2—1996
- 3.3.2-9 [Interpreted Groundwater Contour Map, East Street Area 2—1996](#)
- 3.3.2-10 [Groundwater Flow Simulation—East Street Area 2 Recovery System—1997](#)
- 3.3.2-11 [Riverbank Area Groundwater Elevation Contour Map—6/4,5/97](#)
- 3.3.2-12 [Interpreted Contour Map Top of Till—East Street Area 2](#)
- 3.3.3-1 Hill 78 Area Potential Source Areas
- 3.3.3-2 Pipelines Retained for Phase III Analysis
- 3.3.3-3 Summary of Select Groundwater Data
- 3.3.3-4 Extent of PCBs in Surface Soil, Hill 78 Area/USEPA Area 2
- 3.3.4-1 Unkamet Brook Location Map, Unkamet Brook Area/USEPA Area 1

LIST OF FIGURES

(Continued)

Section

- 3.3.4-2 Extent of PCBs in Surface Soil, Unkamet Brook Area
- 3.3.5-1 LNAPL/DNAPL Extent
- 3.3.5-2 Interpretive Top of Silt Elevation Contours
- 3.3.5-3 Extent of PCBs in Surface Soil, Lyman Street Area
- 3.3.5-4 Interpretive Groundwater Elevation Contours—January 1998
- 3.5-1 Summary of Horizontal Extent of PCBs in Soil at Allendale School
- 3.6-1 Facility Drainage
- 3.6-2 Additional Municipal Sewer Outfalls into Silver Lake
- 3.6-3 Summary of Silver Lake Sediment Sampling Locations and PCB Data
- 3.6-4 Silver Lake Floodplain Soil Sampling Locations and PCB Results
- 3.6-5 Location of Monitoring Wells Near Silver Lake
- 3.7-1 Location Plan for Newell Street Area I and Area II
- 3.7-2 Limit of Approximate 10-Year Floodplain for Newell Street Area I and II
- 3.7-3 Newell Street Area NAPL Well Location Map
- 3.8-1 Sampling Locations for Oxbow Areas A, B, and C
- 3.8-2 Soil PCB Data for Oxbow Areas A, B, and C
- 3.8-3 Sampling Locations for Oxbow Areas J and K
- 3.8-4 Soil PCB Data for Oxbow Areas J and K
- 5-1 Identified Contaminant Source Areas

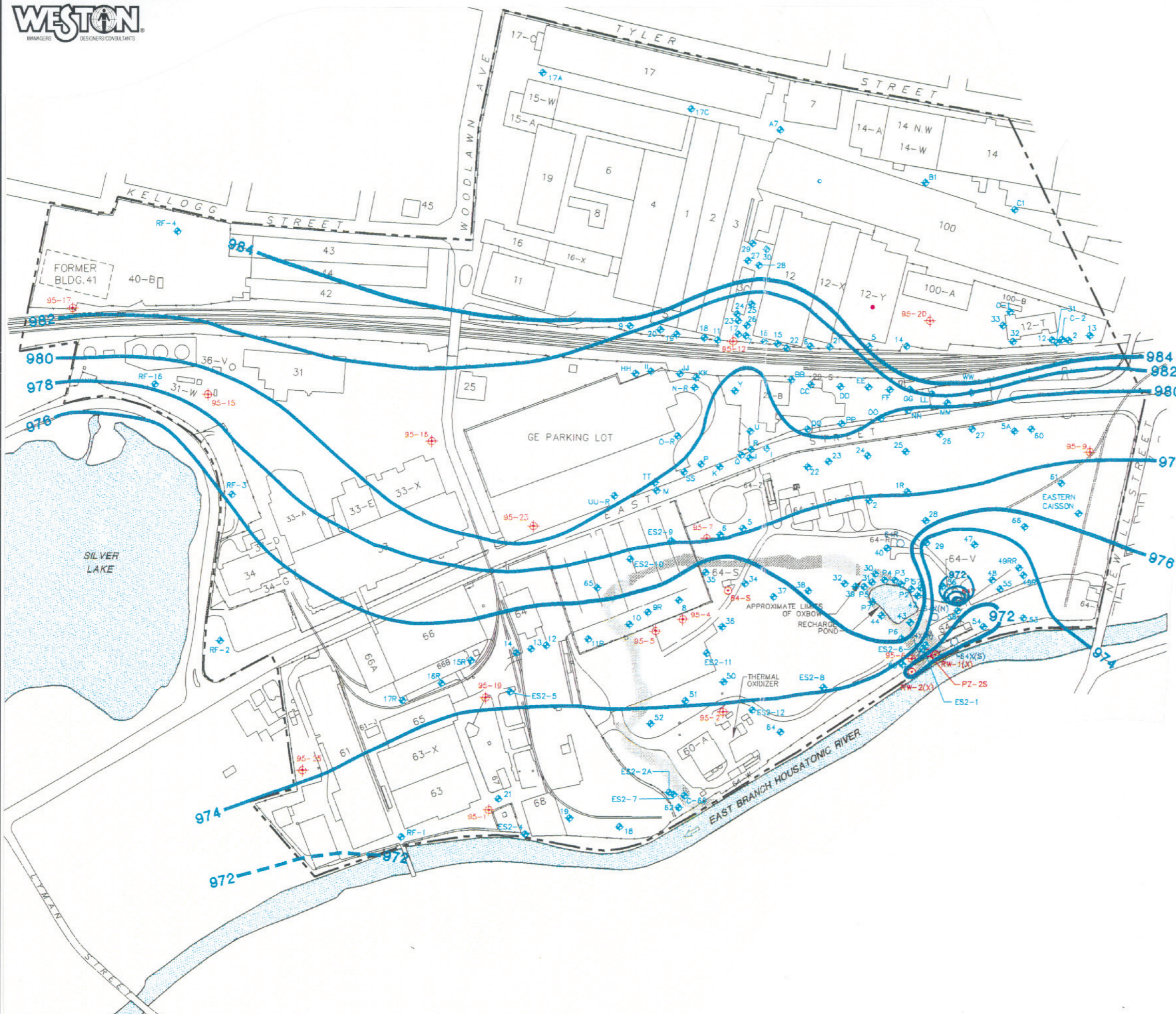

LEGEND

- APPROXIMATE SITE BOUNDARY
- FENCE
- 25 EXISTING MONITORING WELL
- PZ-25 EXISTING PIEZOMETER
- 95-5 PHASE II / RFI MONITORING WELL
- 6+R RECOVERY CAISSON
- RW-1(X) PUMPING WELL
- 980 INTERPRETED GROUNDWATER ELEVATION CONTOURS ; FT-MSL (DASHED WHERE INFERRED)

NOTES

- 1.) MAPPING IS BASED ON AERIAL PHOTOGRAPHS AND PHOTOGRAMMETRIC MAPPING BY LOCKWOOD MAPPING, INC. - FLOWN IN APRIL 1990; PROVIDED BY GENERAL ELECTRIC COMPANY, AND BLASLAND AND BOUCK ENGINEERS, P.C. CONSTRUCTION PLANS.
- 2.) NOT ALL PHYSICAL FEATURES SHOWN
- 3.) SITE BOUNDARY IS APPROXIMATE.
- 4.) ALL EXISTING MONITORING WELL LOCATIONS ARE APPROXIMATE AND ALL PHASE II / RFI MONITORING WELLS ARE SURVEYED TO MASSACHUSETTS STATE PLANE.

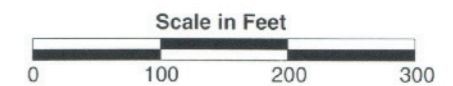
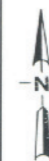

Original map produced by Golder Associates, 1996.

Source Area Characterization Report
Pittsfield Massachusetts
FIGURE 3.3.2-9
INTERPRETED GROUNDWATER
CONTOUR MAP, EAST STREET AREA 2-1996

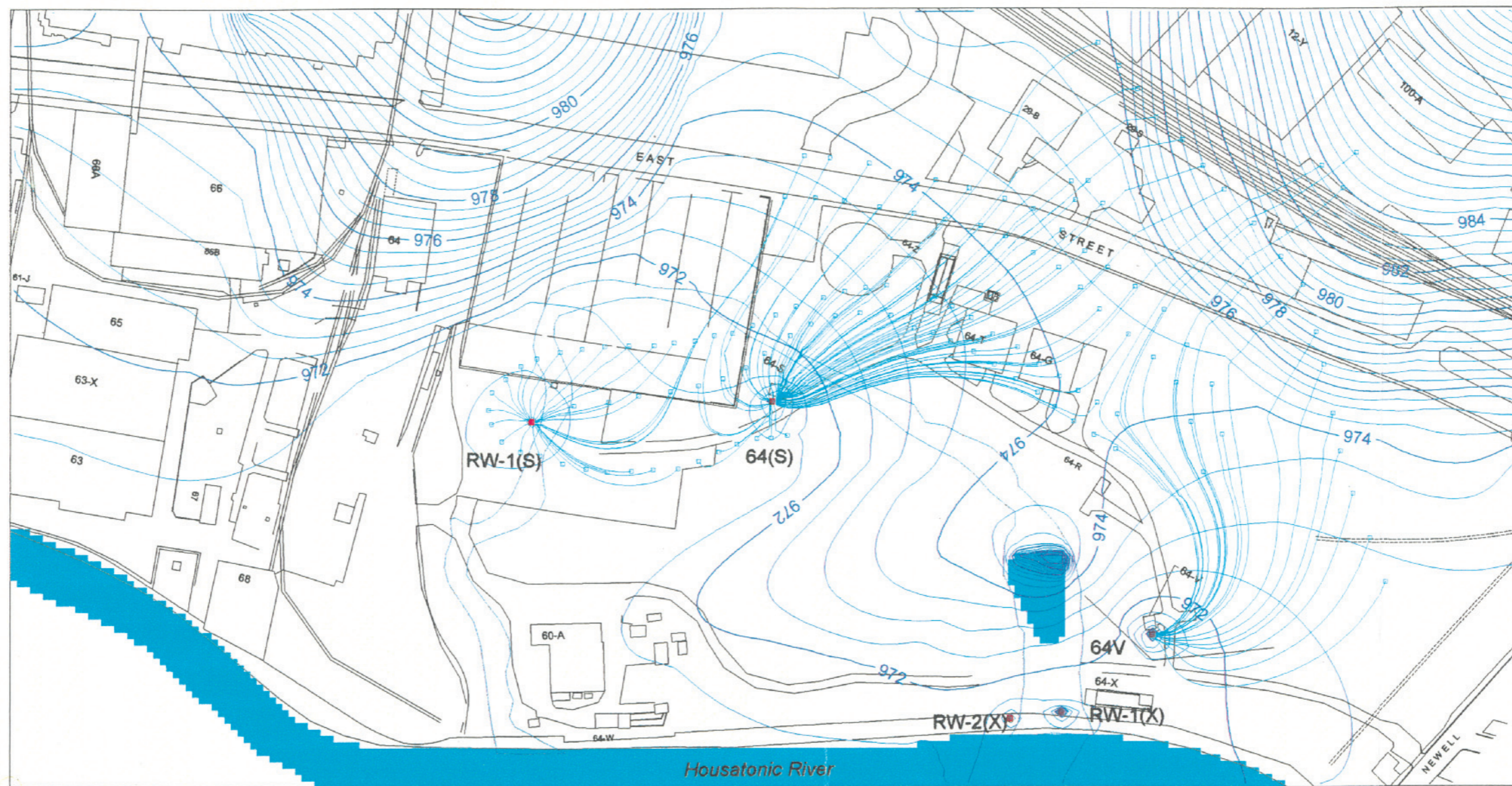

Computer Run: A2c20.gww

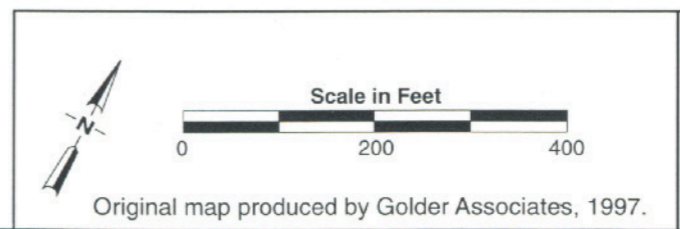

Source Area Characterization Report
Pittsfield Massachusetts
FIGURE 3.3.2-10
GROUNDWATER FLOW SIMULATION-
EAST STREET AREA 2 RECOVERY SYSTEM, 1997

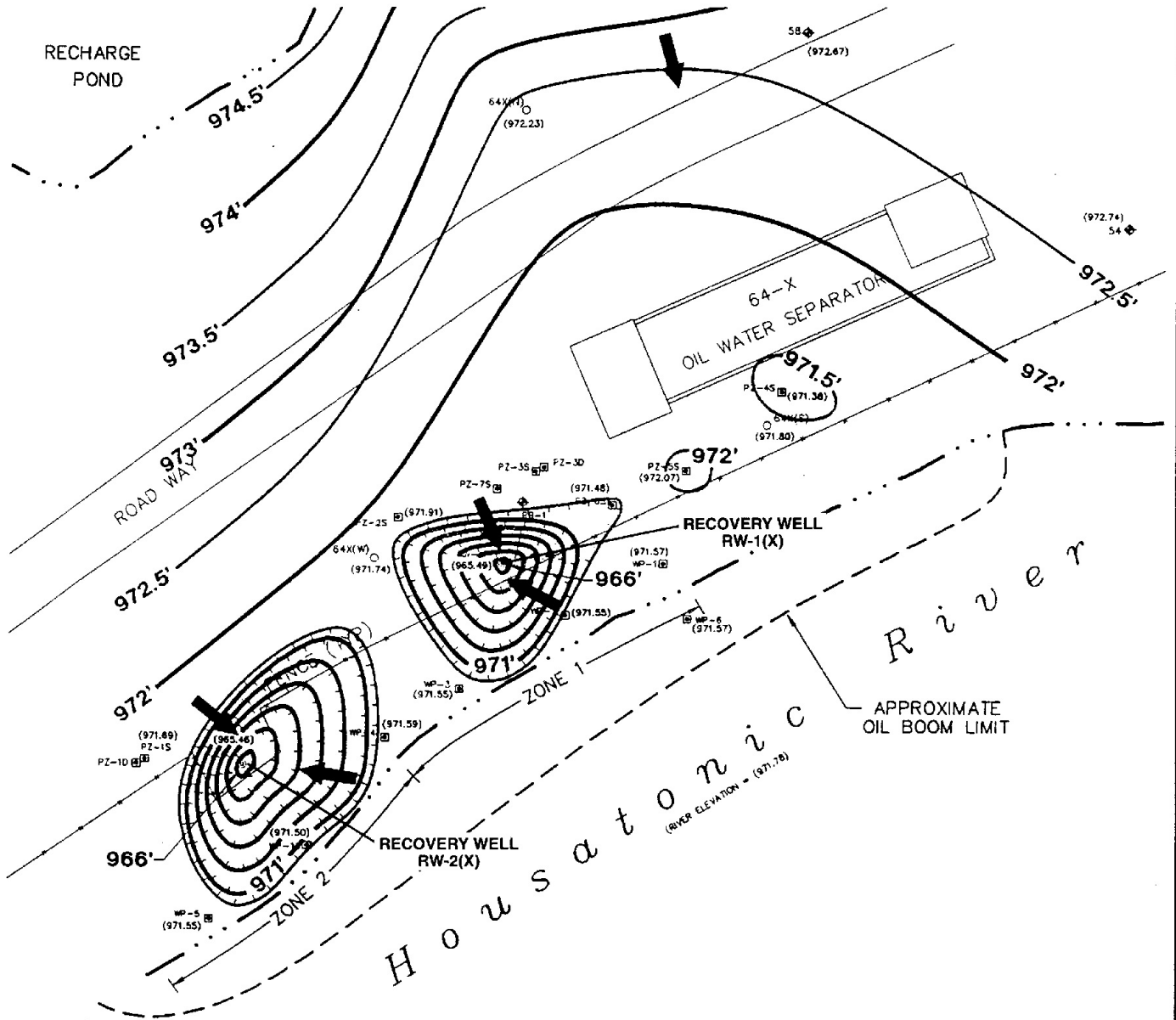

LEGEND:

- PZ-15 □ PIEZOMETER
- RW-1(X) ⊙ PUMPING WELL
- 64X ○ OIL RECOVERY CAISSON
- 25 ◆ MONITORING WELL
- (972.07) GROUNDWATER ELEVATION
- 973' ——— GROUNDWATER ELEVATION CONTOUR (1 FT INTERVAL)
- 972.5' ——— GROUNDWATER ELEVATION CONTOUR (0.5 FT INTERVAL)
- ← GROUNDWATER FLOW DIRECTION

NOTES:

1. MAPPING IS BASED ON AERIAL PHOTOGRAPHS AND PHOTOGRAMMETRIC MAPPING BY LOCKWOOD MAPPING, INC. - FLOWN IN APRIL 1990.
2. NOT ALL PHYSICAL FEATURES SHOWN.
3. ALL WELL/PIEZOMETER LOCATIONS ARE APPROXIMATE.

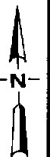

Source Area Characterization Report
Pittsfield Massachusetts
Mcp East Street Area 2/USEPA Area 4

FIGURE 3.3.2-11
RIVERBANK AREA GROUNDWATER
ELEVATION CONTOUR MAP - 6/4,5/97

Original map produced by Blasland, Bouck, Lee, Inc., 1997.

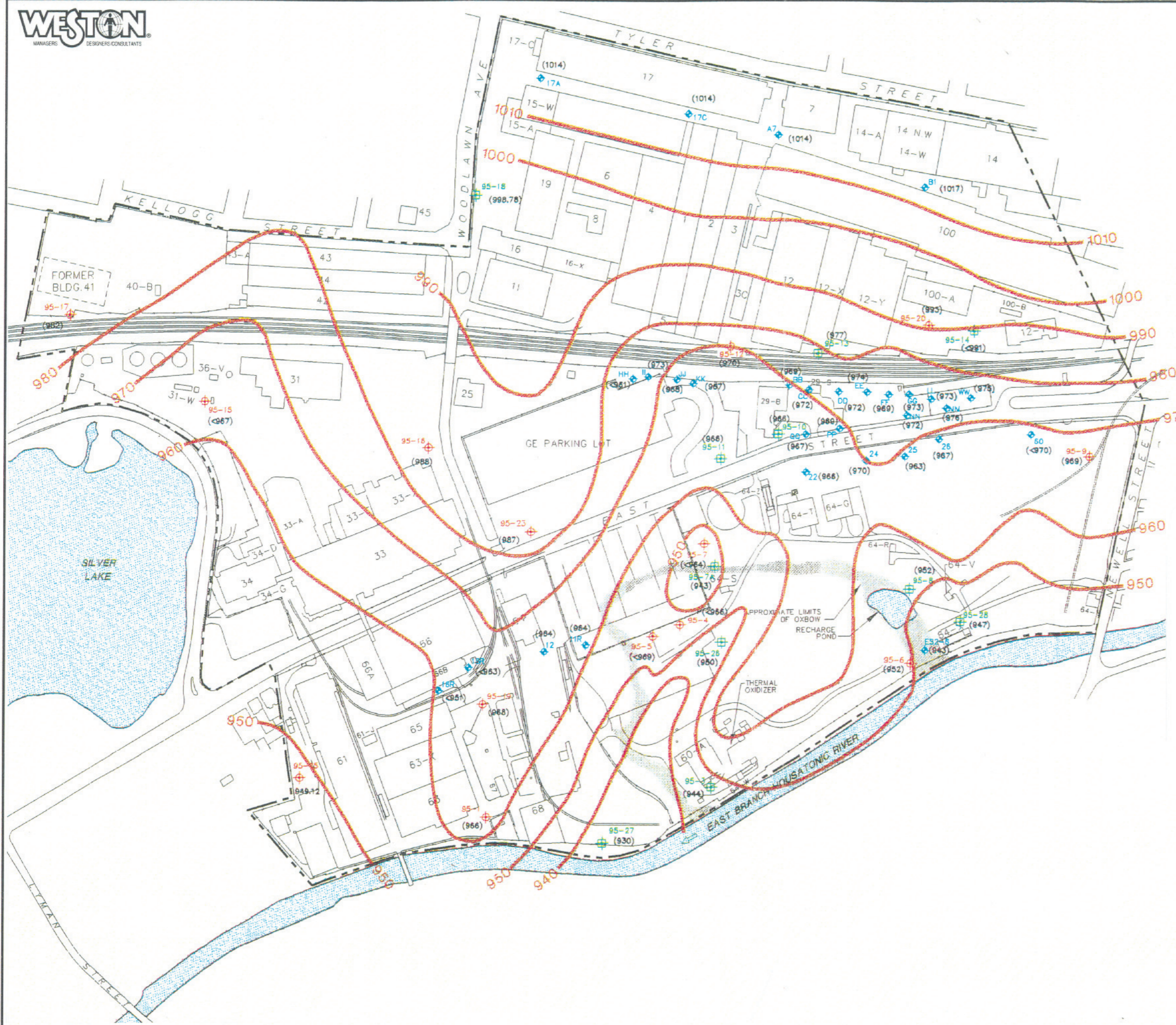

LEGEND

- APPROXIMATE SITE BOUNDARY
- FENCE
- EXISTING MONITORING WELL
- EXISTING PIEZOMETER
- PHASE II / RFI SOIL BORING LOCATION
- PHASE II / RFI MONITORING WELL
- INTERPRETED TOP OF TILL STRUCTURAL CONTOURS
- TOP OF TILL ELEVATION
- TOP OF TILL NOT INTERCEPTED

NOTES

- 1.) MAPPING IS BASED ON AERIAL PHOTOGRAPHS AND PHOTOGRAMMETRIC MAPPING BY LOCKWOOD MAPPING, INC. - FLOWN IN APRIL 1990; PROVIDED BY GENERAL ELECTRIC COMPANY, AND BLASLAND AND BOUCK ENGINEERS, P.C. CONSTRUCTION PLANS.
- 2.) NOT ALL PHYSICAL FEATURES SHOWN
- 3.) SITE BOUNDARY IS APPROXIMATE.
- 4.) ALL EXISTING MONITORING WELL LOCATIONS ARE APPROXIMATE AND ALL PHASE II / RFI MONITORING WELLS ARE SURVEYED TO MASSACHUSETTS STATE PLANE.

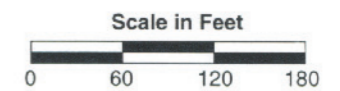
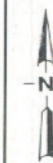

Original map produced by Golder Associates, 4/96

Source Area Characterization Report
Pittsfield Massachusetts
FIGURE 3.3.2-12
INTERPRETED CONTOUR MAP-TOP OF TILL,
EAST STREET AREA 2