



GE
159 Plastics Avenue
Pittsfield, MA 01201
USA

Transmitted Via Federal Express

March 28, 2007

Mr. Dean Tagliaferro
United States Environmental Protection Agency
c/o Weston Solutions
10 Lyman Street
Pittsfield, MA 01201

**Re: GE Pittsfield/Housatonic River Site
East Street Area 2-North (GECD 140)
Buildings 11 and 16 Demolition and Site Restoration Program
Ambient Air Monitoring Station Locations**

Dear Mr. Tagliaferro:

This letter notifies the U.S. Environmental Protection Agency (EPA) of the approximate locations of the polychlorinated biphenyl (PCB) and particulate ambient air monitoring stations to be used during the upcoming demolition and site restoration program for Buildings 11 and 16 located at the General Electric Company (GE) facility in Pittsfield, Massachusetts. In addition, this letter identifies revised ambient air monitoring station locations for the demolition and site restoration program for Buildings 7, 17, 17C, and 19, assuming that that program is conducted concurrently with the activities at Buildings 11 and 16.

GE previously identified locations for ambient air monitoring stations for the Buildings 7, 17, 17C, and 19 program, including supplemental location M2, in a July 6, 2006 letter to EPA. Figure 1 from that letter is attached for convenience. However, demolition activities at Buildings 7, 17, 17C, and 19 have not yet commenced. At this time, it is anticipated that demolition activities associated with Buildings 11 and 16 and Buildings 7, 17, 17C, and 19 may be conducted concurrently (during the 2007 construction season). In this situation, given the proximity of Buildings 7, 17, 17C, and 19 to Buildings 11 and 16, it is appropriate to coordinate the air monitoring program for both sets of buildings.

Specifically, if demolition activities at these two sets of buildings are conducted concurrently, two of the air monitoring stations proposed in GE's July 6, 2006 letter – namely, M2A and supplemental station M2, located in close proximity to Buildings 11 and 16 – would not be fully representative of perimeter ambient air conditions and could be damaged as a result of the nearby demolition activities. In these circumstances, GE intends to use four ambient air monitoring stations during the combined demolition and site restoration program – namely, stations S2, M6, MC3A, and M7, as shown on the attached Figure 2. Stations S2, M6, and MC3A will be used to monitor demolition/restoration activities at Buildings 11 and 16, while stations M6, MC3A, and M7 will be used to monitor such activities at Buildings 7, 17, 17C, and 19.

Alternatively, if the demolition activities associated with Buildings 7, 17, 17C, and 19 are not conducted concurrently with the demolition activities associated with Buildings 11 and 16, then the locations identified in GE's July 6, 2006 letter and shown on Figure 1 (i.e., M2A, MC3A, M7, and supplemental station M2) will be used for Buildings 7, 17, 17C, and 19, and the three relevant locations identified on Figure 2 (i.e., S2, M6, and MC3A) will be used for Buildings 11 and 16.

Mr. Dean Tagliaferro
March 28, 2007

In either case, the background air monitoring station shown on both Figures 1 and 2 will be utilized during the air monitoring program(s).

Please feel free to contact me with questions or comments.

Sincerely,



Michael T. Carroll
Manager, Pittsfield Remediation Programs

Attachments

cc: T. Conway, EPA
J. Kilborn, EPA
H. Inglis, EPA
R. Howell, EPA
S. Steenstrup, MDEP (2 copies)
J. Rothchild, MDEP
A. Symington, MDEP
K.C. Mitkevicius, USACE
L. Palmieri, Weston (2 copies)
Mayor J. Ruberto, City of Pittsfield
T. Hickey, Director, PEDDA
J. Bernstein, Bernstein, Cushner & Kimmel
T. Bowers, Gradient
R. McLaren, GE
A. Silber, GE
R. Gates, GE
J. Bieke, Goodwin Procter
S. Gutter, Sidley Austin
J. Nuss, ARCADIS BBL
M. Hawkins, BEC
GE Internal Repositories
Public Information Repositories

Figures

SYR-85-BOP D:\P LAF LAYER: ON=*, OFF=*REF*, LANDFILL*, ISP-SB-7-99
 G:\CAD\GE-CAD\ACTIVE\C\20933001\DEMO\20912G03.DWG SAVED: 3/27/2007 8:44 AM LAYOUT: Layout1 PAGESETUP: PENTABLE: PLFULL.CTB PRINTED: 3/27/2007 2:45 PM BY: JHRICHARDSON
 PROJECTNAME: 20933X01 XREFS: IMAGES:

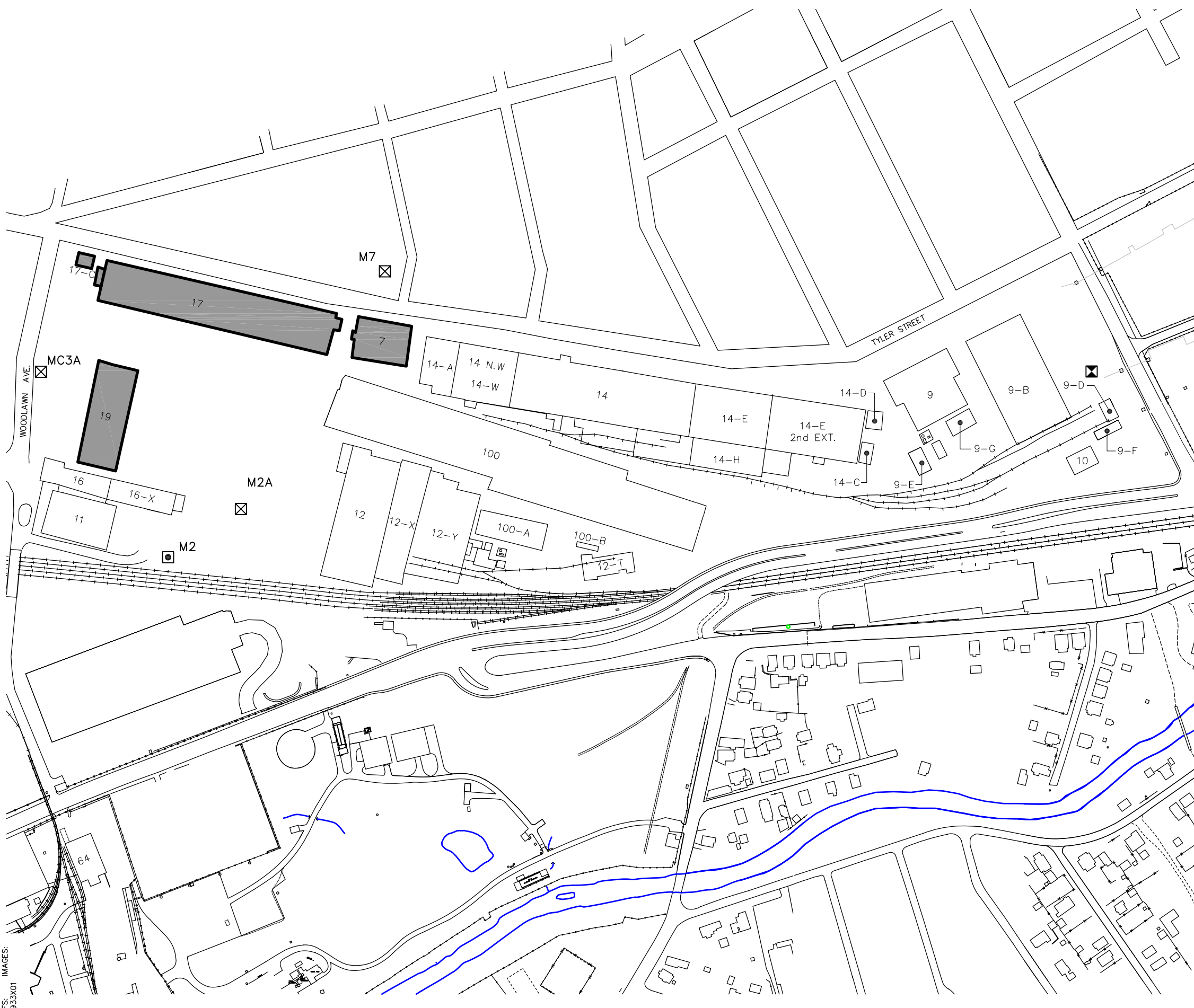

LEGEND:

- BUILDINGS SUBJECT TO DEMOLITION
- M2A APPROXIMATE AMBIENT AIR MONITORING STATION LOCATION AND ID NUMBER
- APPROXIMATE BACKGROUND AMBIENT AIR MONITORING STATION LOCATION
- M2 APPROXIMATE SUPPLEMENTAL AMBIENT AIR MONITORING STATION LOCATION AND ID NUMBER



NOTES:

1. MAPPING IS BASED ON AERIAL PHOTOGRAPHS AND PHOTOGRAMMETRIC MAPPING BY LOCKWOOD MAPPING, INC. - FLOWN IN APRIL 1990; DATA PROVIDED BY GENERAL ELECTRIC COMPANY; AND BLASLAND, BOUCK & LEE, INC. (BBL) CONSTRUCTION PLANS; AND FROM SURVEY PROVIDED BY HILL ENGINEERS, ARCHITECTS, AND PLANNERS, DATED 6/5/01.
2. BUILDING NUMBER DESIGNATIONS ARE BASED ON A GE DRAWING TITLED, GROUND PLAN, SHEET 1, AND DATED JANUARY 1, 1994.
3. NOT ALL PHYSICAL FEATURES ARE SHOWN.
4. THE LOCATIONS OF AIR MONITORING STATIONS SHOWN ON THIS DRAWING ARE APPROXIMATE ONLY. ACTUAL LOCATIONS TO BE DETERMINED BASED ON SITE CONDITIONS AT THE TIME OF DEMOLITION.
5. THE LOCATION OF AMBIENT AIR MONITORING STATION M7 HAS BEEN RELOCATED TO THE GE-OWNED LOT LOCATED ACROSS TYLER STREET, AS REQUESTED BY EPA.
6. AMBIENT AIR MONITORING STATIONS M2A AND MC3A HAVE BEEN RELOCATED BASED ON COMMENTS FROM EPA; HOWEVER, ON-SITE CONSTRUCTION ACTIVITIES (e.g., TRUCK TRAFFIC, DEBRIS STAGING) RESTRICT THE AVAILABLE SPACE WITHIN WHICH THESE STATIONS CAN BE RELOCATED.

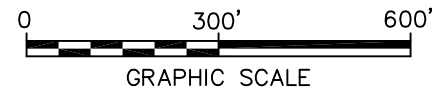

GENERAL ELECTRIC COMPANY
 PITTSFIELD, MASSACHUSETTS
BUILDINGS 7, 17, 17C, AND 19
DEMOLITION AND SITE RESTORATION PROGRAM
BUILDINGS 7, 17, 17C, AND 19
LOCATIONS OF AMBIENT AIR
MONITORING STATIONS



SYR-85-BGP LAF JHR LAYER: ON=*, OFF=*REF*
 G:\CAD\GE-CAD\GE_ACTIVE\C\20933001\DEMO\20933002.DWG SAVED: 3/27/2007 2:44 PM LAYOUT: 1 PAGESETUP: BL-PDF PENTABLE: PLT\FULL.CTB PRINTED: 3/27/2007 2:44 PM BY: JHRICHARDSON
 PROJECTNAME: 20933X01 XREFS: IMAGES:

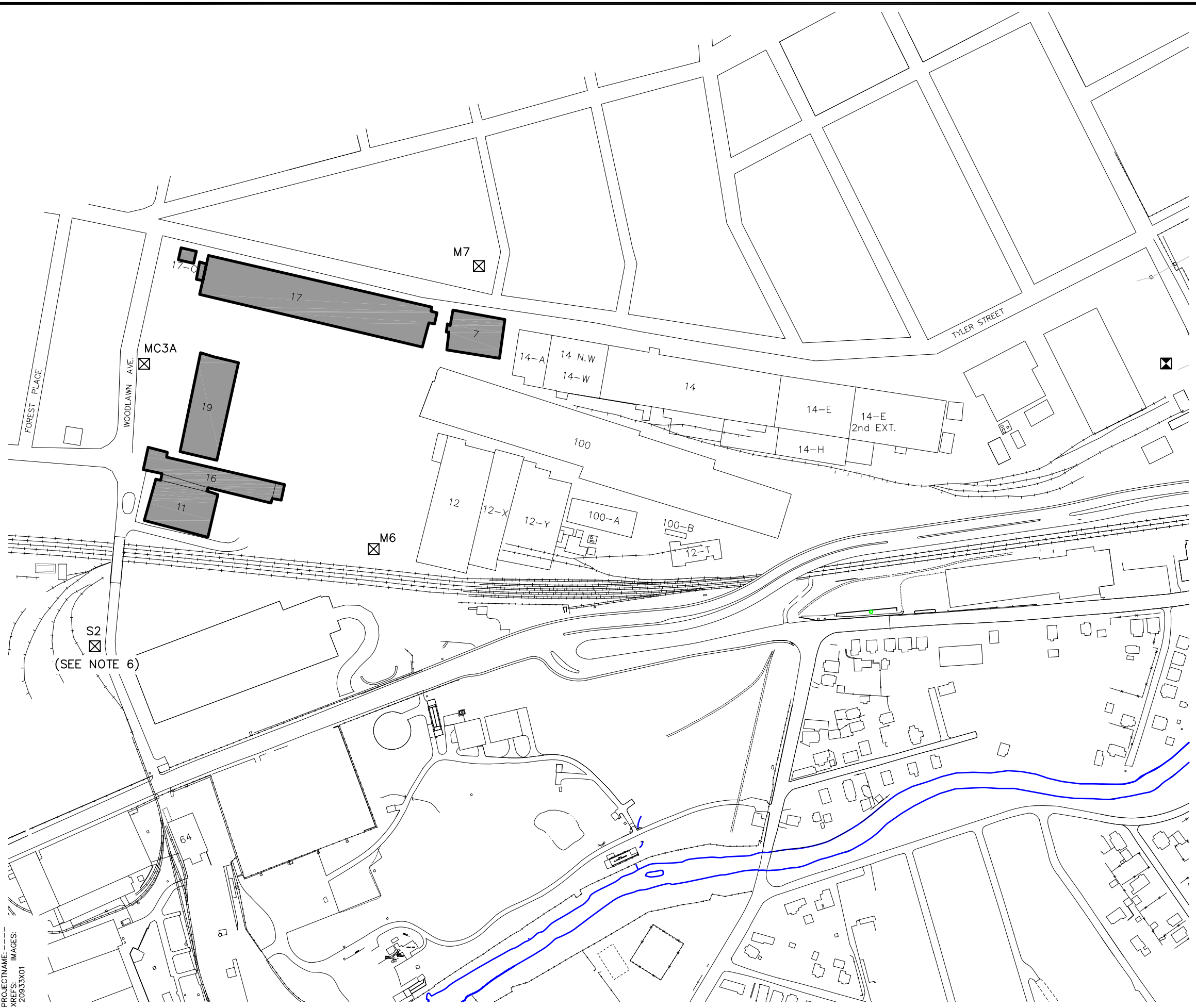

LEGEND:

- BUILDINGS SUBJECT TO DEMOLITION
- M6 APPROXIMATE AMBIENT AIR MONITORING STATION LOCATION AND ID NUMBER
- APPROXIMATE BACKGROUND AMBIENT AIR MONITORING STATION LOCATION

NOTES:

1. MAPPING IS BASED ON AERIAL PHOTOGRAPHS AND PHOTOGRAMMETRIC MAPPING BY LOCKWOOD MAPPING, INC. - FLOWN IN APRIL 1990; DATA PROVIDED BY GENERAL ELECTRIC COMPANY; AND BLASLAND, BOUCK & LEE, INC. (BBL) CONSTRUCTION PLANS; AND FROM SURVEY PROVIDED BY HILL ENGINEERS, ARCHITECTS, AND PLANNERS, DATED 6/5/01.
2. BUILDING NUMBER DESIGNATIONS ARE BASED ON A GE DRAWING TITLED, GROUND PLAN, SHEET 1, AND DATED JANUARY 1, 1994.
3. NOT ALL PHYSICAL FEATURES ARE SHOWN.
4. THE LOCATIONS OF AIR MONITORING STATIONS SHOWN ON THIS DRAWING ARE APPROXIMATE ONLY. ACTUAL LOCATIONS TO BE DETERMINED BASED ON SITE CONDITIONS AT THE TIME OF DEMOLITION.
5. AMBIENT AIR MONITORING STATIONS S2, M6, AND MC3A WILL BE USED TO MONITOR DEMOLITION / RESTORATION ACTIVITIES AT BUILDINGS 11 AND 16; AND AMBIENT AIR MONITORING STATIONS M6, MC3A, AND M7 WILL BE USED TO MONITOR SUCH ACTIVITIES AT BUILDINGS 7, 17, 17C, AND 19.
6. THE LOCATION OF AIR MONITORING STATION S2 WILL BE OFF TO THE SIDE OF THE ROAD IN THE WOODLAWN AVENUE RIGHT-OF-WAY.

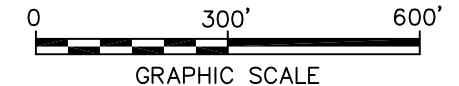

GENERAL ELECTRIC COMPANY
PITTSFIELD, MASSACHUSETTS

DEMOLITION AND SITE RESTORATION PROGRAM

LOCATIONS OF AMBIENT AIR
MONITORING STATIONS

infrastructure, environment, facilities

FIGURE
2