



01-0920

GE  
159 Plastics Avenue  
Pittsfield, MA 01201  
USA

SDMS 248185

*Transmitted Via Federal Express*

March 27, 2006

Ms. Sharon Hayes  
United States Environmental Protection Agency  
EPA New England  
One Congress Street, Suite 1100  
Boston, MA 02114-2023

**Re: GE Pittsfield/Housatonic River Site  
Buildings 7, 17, 17C, and 19 Demolition and Site Restoration Program (GEC D 140)  
Ambient Air Monitoring Station Locations**

Dear Ms. Hayes:

This letter serves to notify the U.S. Environmental Protection Agency of the approximate polychlorinated biphenyl and particulate ambient air monitoring station locations at Buildings 7, 17, 17C, and 19 located at the General Electric Company facility in Pittsfield, Massachusetts. The locations of the air monitoring stations are shown on the attached figure. These locations will be utilized for future ambient air monitoring associated with demolition and restoration activities at Buildings 7, 17, 17C, and 19.

Please feel free to contact me with questions or comments.

Sincerely,

John F. Novotny, P.E.  
Manager, Facilities and Brownfields Programs

Attachment



cc: T. Conway, EPA  
D. Tagliaferro, EPA  
H. Inglis, EPA  
R. Howell, EPA\*  
S. Steenstrup, MDEP (2 copies)  
R. Bell, MDEP\*  
T. Angus, MDEP\*  
A. Symington, MDEP\*  
K.C. Mitkevicius, USACE  
L. Palmieri, Weston (2 copies)  
Mayor J. Ruberto, City of Pittsfield  
Pittsfield Commissioner of Public Health  
T. Hickey, Director, PED A

N.E. Harper, MA AG\*  
D. Young, MA EOE A\*  
J. Bernstein, Bernstein, Cushner & Kimmel\*  
T. Bowers, Gradient  
R. McLaren, GE\*  
M. Carroll, GE\*  
A. Silber, GE\*  
J. Bieke, Goodwin Procter  
J. Nuss, BBL  
GE Internal Repositories  
Public Information Repositories

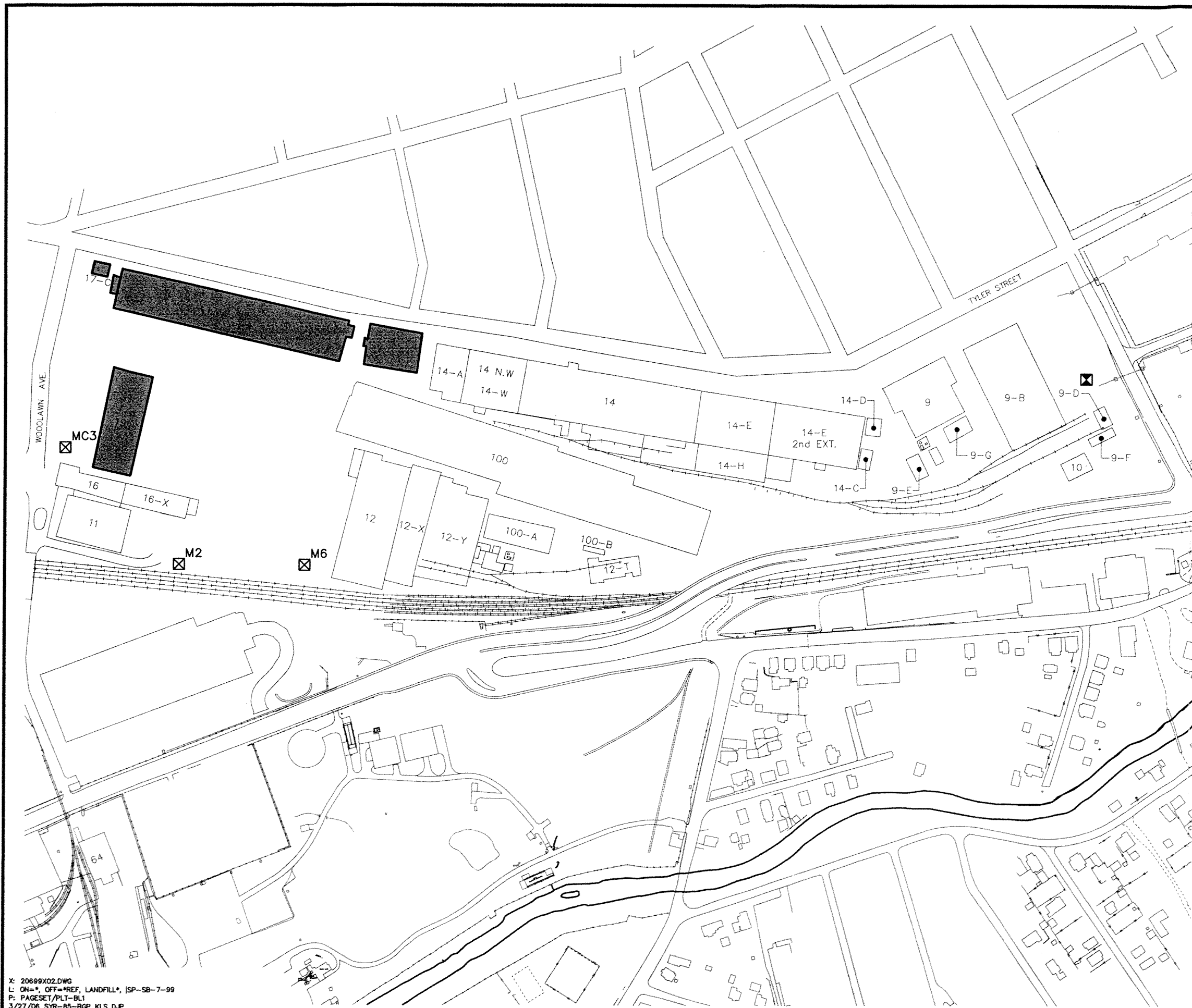
(\* without attachments)



**LEGEND:**

- 
**M2** APPROXIMATE AMBIENT AIR MONITORING STATION LOCATION AND ID NUMBER (SEE NOTE 4)
- 
 APPROXIMATE BACKGROUND AMBIENT AIR MONITORING STATION LOCATION



**NOTES:**

1. MAPPING IS BASED ON AERIAL PHOTOGRAPHS AND PHOTOGRAMMETRIC MAPPING BY LOCKWOOD MAPPING, INC. - FLOWN IN APRIL 1990; DATA PROVIDED BY GENERAL ELECTRIC COMPANY; AND BLASLAND, BOUCK & LEE, INC. (BBL) CONSTRUCTION PLANS; AND FROM SURVEY PROVIDED BY HILL ENGINEERS, ARCHITECTS, AND PLANNERS, DATED 6/5/01.
2. BUILDING NUMBER DESIGNATIONS ARE BASED ON A GE DRAWING TITLED, GROUND PLAN, SHEET 1, AND DATED JANUARY 1, 1994.
3. NOT ALL PHYSICAL FEATURES ARE SHOWN.
4. THE LOCATIONS OF AIR MONITORING STATIONS SHOWN ON THIS DRAWING ARE APPROXIMATE ONLY. ACTUAL LOCATIONS TO BE DETERMINED BASED ON SITE CONDITIONS AT THE TIME OF DEMOLITION.
5. THE LOCATION OF AMBIENT AIR MONITORING STATION M6 MAY BE MODIFIED AT THE TIME OF DEMOLITION, DEPENDING ON THE STATUS OF WASTE HANDLING/MOVEMENT ACTIVITIES ASSOCIATED WITH DEMOLITION DEBRIS FROM FORMER BUILDINGS 1, 2, 3, AND 3B. THE MAJORITY OF THE ABOVE-REFERENCED DEMOLITION DEBRIS IS CURRENTLY PRESENT WITHIN THIS AREA.
6. DEPENDING ON THE ACTUAL SEQUENCE OF DEMOLITION ACTIVITIES, AMBIENT AIR MONITORING STATION MC3 MAY BE RELOCATED FURTHER TO THE NORTH TO PROVIDE A MORE REPRESENTATIVE INDICATION OF POTENTIAL AMBIENT AIR QUALITY IMPACTS RESULTING FROM THE DEMOLITION OF BUILDINGS 17 AND 17C.

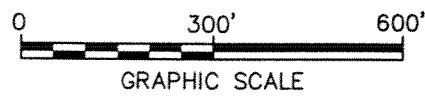

GENERAL ELECTRIC COMPANY  
PITTSFIELD, MASSACHUSETTS  
**BUILDINGS 7, 17, 17C, AND 19**  
**DEMOLITION AND SITE RESTORATION PROGRAM**  
**BUILDINGS 7, 17, 17C, AND 19**  
**LOCATIONS OF AMBIENT AIR**  
**MONITORING STATIONS**



X: 20699X02.DWG  
L: ON=\*, OFF=\*REF, LANDFILL\*, JSP-SB-7-99  
P: PAGESET/PLT-BL1  
3/27/06 SYR-B5-BGP KLS DJP  
C/20866001/BLDG-7-19/20866B01.DWG