



01-0891
SDMS 237400

GE
159 Plastics Avenue
Pittsfield, MA 01201
USA

Transmitted Via Federal Express

September 30, 2005

Ms. Sharon Hayes
United States Environmental Protection Agency
EPA New England
One Congress Street, Suite 1100
Boston, MA 02114-2023

**Re: GE Pittsfield/Housatonic River Site
Buildings 1, 1A, 2, 3, 3B, and 100 Annex Demolition and Site Restoration Program (GECD 140)
Ambient Air Monitoring Station Locations**

Dear Ms. Hayes:

This letter serves to notify the U.S. Environmental Protection Agency of the approximate polychlorinated biphenyl and particulate ambient air monitoring station locations at Buildings 1, 1A, 2, 3, 3B, and 100 Annex located at the General Electric Company facility in Pittsfield, Massachusetts. The locations of the air monitoring stations are shown on the attached figure. These locations will be utilized for future ambient air monitoring associated with demolition and restoration activities at Buildings 1, 1A, 2, 3, 3B, and 100 Annex.

Please feel free to contact me with questions or comments.

Sincerely,

John F. Novotny, P.E.
Manager, Facilities and Brownfields Programs

Attachment

cc: T. Conway, EPA
D. Tagliaferro, EPA
H. Inglis, EPA
R. Howell, EPA*
S. Steenstrup, MDEP (2 copies)
R. Bell, MDEP*
T. Angus, MDEP*
A. Symington, MDEP*
K.C. Mitkevicius, USACE
L. Palmieri, Weston (2 copies)
Mayor J. Ruberto, City of Pittsfield
Pittsfield Commissioner of Public Health
T. Hickey, Director, PEDDA
N.E. Harper, MA AG*
D. Young, MA EOE*
J. Bernstein, Bernstein, Cushner & Kimmel*
T. Bowers, Gradient
R. McLaren, GE*
M. Carroll, GE*
A. Silber, GE*
J. Bieke, Goodwin Procter
J. Nuss, BBL
GE Internal Repositories
Public Information Repositories
(* without attachments)

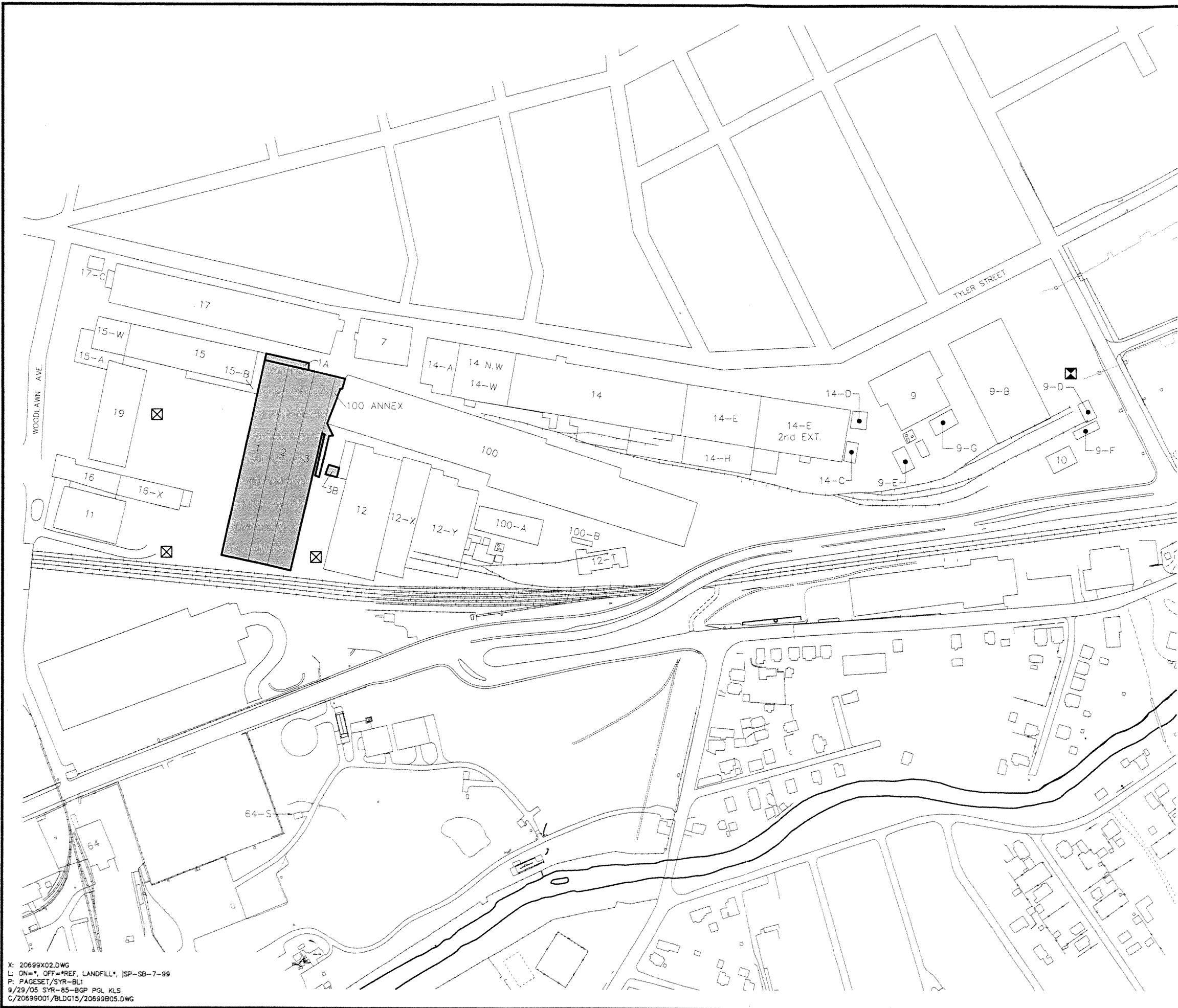

LEGEND:

- ☒ APPROXIMATE AMBIENT AIR MONITORING STATION LOCATION (SEE NOTE 5)
- ☒ APPROXIMATE BACKGROUND AMBIENT AIR MONITORING STATION LOCATION

NOTES:

1. MAPPING IS BASED ON AERIAL PHOTOGRAPHS AND PHOTOGRAMMETRIC MAPPING BY LOCKWOOD MAPPING, INC. - FLOWN IN APRIL 1990; DATA PROVIDED BY GENERAL ELECTRIC COMPANY; AND BLASLAND, BOUCK & LEE, INC. (BBL) CONSTRUCTION PLANS; AND FROM SURVEY PROVIDED BY HILL ENGINEERS, ARCHITECTS, AND PLANNERS, DATED 6/5/01.
2. BUILDING NUMBER DESIGNATIONS ARE BASED ON A GE DRAWING TITLED, GROUND PLAN, SHEET 1, AND DATED JANUARY 1, 1994.
3. NOT ALL PHYSICAL FEATURES ARE SHOWN.
4. ALL LOCATIONS ARE APPROXIMATE.
5. THE LOCATIONS OF AIR MONITORING STATIONS SHOWN ON THIS DRAWING ARE APPROXIMATE ONLY. ACTUAL LOCATIONS TO BE DETERMINED BASED ON SITE CONDITIONS AT THE TIME OF DEMOLITION.

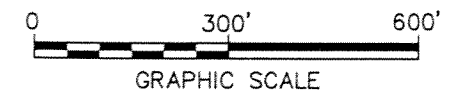

GENERAL ELECTRIC COMPANY
 PITTSFIELD, MASSACHUSETTS
**BUILDINGS 1, 1A, 2, 3, 3B & 100 ANNEX
 DEMOLITION AND SITE RESTORATION PROGRAM**
BUILDINGS 1, 1A, 2, 3, 3B & 100 ANNEX
**LOCATIONS OF AMBIENT AIR
 MONITORING STATIONS**



FIGURE
1

X: 20699X02.DWG
 L: ON=*, OFF=*REF, LANDFILL*, ISP-SB-7-99
 P: PAGESET/SYR-BL1
 9/29/05 SYR-85-BGP PGL KLS
 C:/20699001/BLDG15/20699805.DWG