



01-0872
SDMS 236709

GE
159 Plastics Avenue
Pittsfield, MA 01201
USA

Transmitted Via Federal Express

August 15, 2005

Ms. Sharon Hayes
United States Environmental Protection Agency
EPA New England
One Congress Street, Suite 1100
Boston, MA 02114-2023

**Re: GE Pittsfield/Housatonic River Site
Buildings 15, 15A, 15B, and 15W Demolition and Site Restoration Program (GECD 140)
Ambient Air Monitoring Station Locations**

Dear Ms. Hayes:

This letter serves to notify the U.S. Environmental Protection Agency of the approximate polychlorinated biphenyl and particulate ambient air monitoring station locations at Buildings 15, 15A, 15B, and 15W located at the General Electric Company facility in Pittsfield, Massachusetts. The locations of the air monitoring stations are shown on the attached figure. These locations will be utilized for future ambient air monitoring associated with demolition and restoration activities at Buildings 15, 15A, 15B, and 15W.

Please feel free to contact me with questions or comments.

Sincerely,

John F. Novotny, P.E.
Manager, Facilities and Brownfields Programs

Attachment

cc: T. Conway, EPA
D. Tagliaferro, EPA
H. Inglis, EPA
R. Howell, EPA*
S. Steenstrup, MDEP (2 copies)
R. Bell, MDEP*
T. Angus, MDEP*
A. Symington, MDEP*
K.C. Mitkevicius, USACE
L. Palmieri, Weston (2 copies)
Mayor J. Ruberto, City of Pittsfield
Pittsfield Commissioner of Public Health
T. Hickey, Director, PED A

N.E. Harper, MA AG*
D. Young, MA EOEA*
J. Bernstein, Bernstein, Cushner & Kimmel*
T. Bowers, Gradient
R. McLaren, GE*
M. Carroll, GE*
A. Silber, GE*
J. Bieke, Goodwin Procter
J. Nuss, BBL
GE Internal Repositories
Public Information Repositories

(* without attachments)

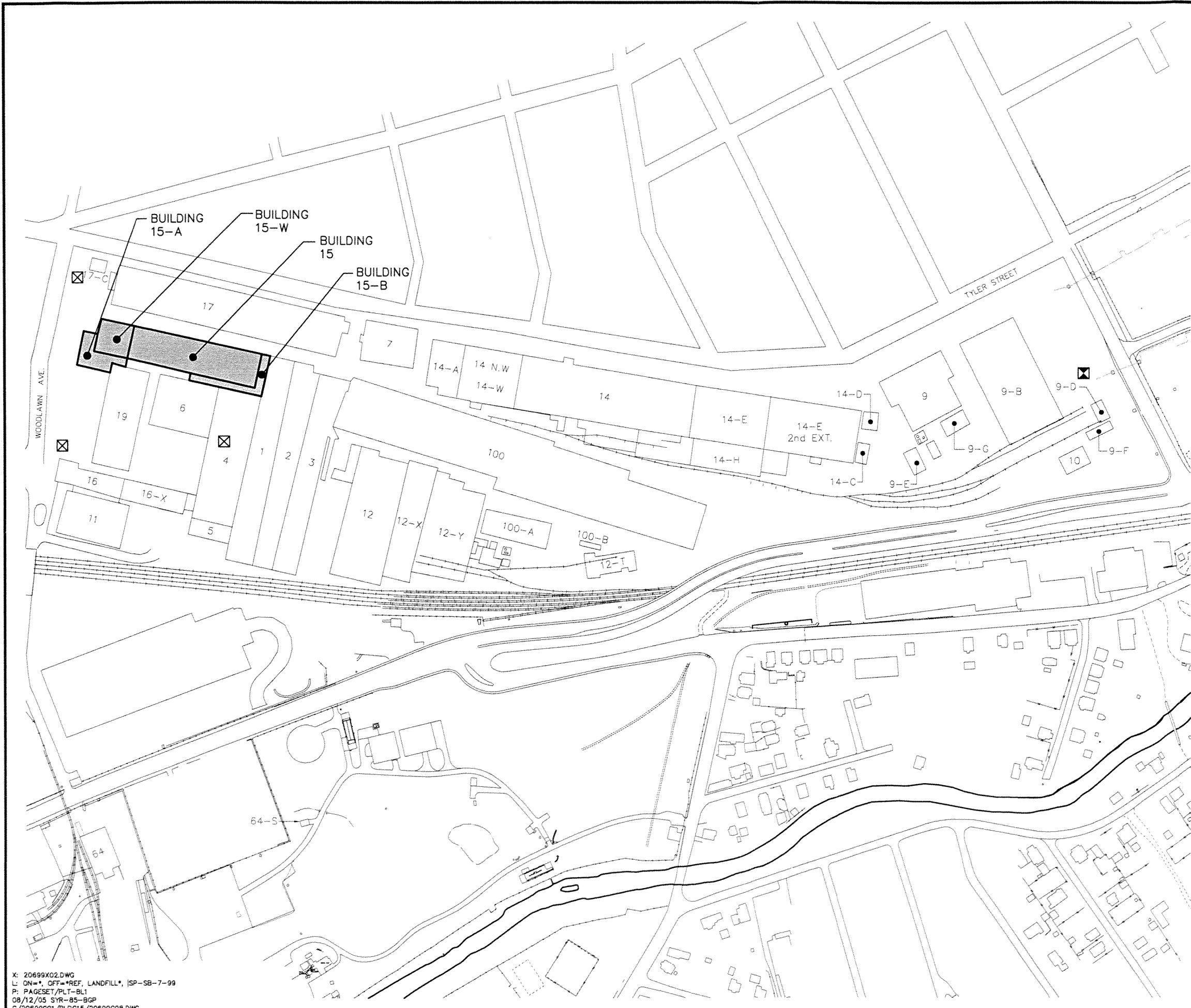

LEGEND:

- ☒ APPROXIMATE AMBIENT AIR MONITORING STATION LOCATION (SEE NOTE 5)
- APPROXIMATE BACKGROUND AMBIENT AIR MONITORING STATION LOCATION

NOTES:

1. MAPPING IS BASED ON AERIAL PHOTOGRAPHS AND PHOTOGRAMMETRIC MAPPING BY LOCKWOOD MAPPING, INC. - FLOWN IN APRIL 1990; DATA PROVIDED BY GENERAL ELECTRIC COMPANY; AND BLASLAND, BOUCK & LEE, INC. (BBL) CONSTRUCTION PLANS; AND FROM SURVEY PROVIDED BY HILL ENGINEERS, ARCHITECTS, AND PLANNERS, DATED 6/5/01.
2. BUILDING NUMBER DESIGNATIONS ARE BASED ON A GE DRAWING TITLED, GROUND PLAN, SHEET 1, AND DATED JANUARY 1, 1994.
3. NOT ALL PHYSICAL FEATURES ARE SHOWN.
4. ALL LOCATIONS ARE APPROXIMATE.
5. THE LOCATIONS OF AIR MONITORING STATIONS SHOWN ON THIS DRAWING ARE APPROXIMATE ONLY. ACTUAL LOCATIONS TO BE DETERMINED BASED ON SITE CONDITIONS AT THE TIME OF DEMOLITION.

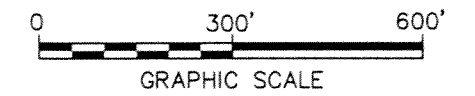

GENERAL ELECTRIC COMPANY
 PITTSFIELD, MASSACHUSETTS
BUILDINGS 15, 15A, 15B, AND 15W
DEMOLITION AND SITE RESTORATION PROGRAM
BUILDINGS 15, 15A, 15B, AND 15W
LOCATIONS OF AMBIENT AIR
MONITORING STATIONS



FIGURE
1

X: 20699X02.DWG
 L: ON=*, OFF=*REF, LANDFILL*, ISP-SB-7-99
 P: PAGESET/PLT-BL1
 08/12/05 SYR-85-BGP
 C:/20699001/BLDG15/20699G08.DWG