

H A R M O N Y

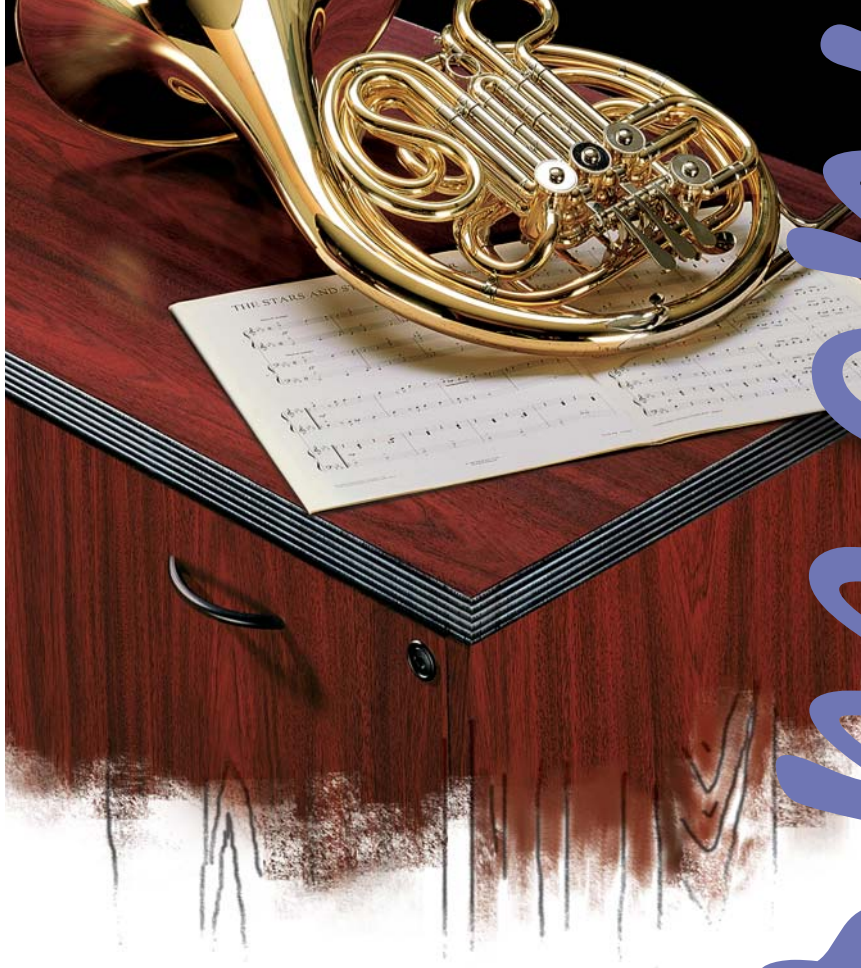

Harmony

Transitional Office Laminate Products

OFFICE FURNITURE GROUP



Building On The Basics

The Harmony line is the perfect solution for the user seeking quality and functionality in a mid-priced office product. Common sense design and engineering make Harmony easy to understand, specify, install and reconfigure. Wood core construction

with a durable laminate finish ensures long life at a reasonable cost. Harmony is a comprehensive modular office furniture line with multiple filing and storage options, and generous electrical and data cable management capabilities. It offers easy planning

and gives a pleasant work environment for all Federal office needs. The Harmony line comes in preconfigured, typical assemblies for your convenience. But the real beauty of this line is its flexibility. It is designed to allow the user to build on the basics. Harmony

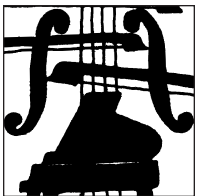



gives you the basic pieces such as stand-alone shell desks, bridges, and credenzas. Then there are the elements that can be added to customize your space. For example, overhead storage units, bookcases, and a choice of desktop organizers

offer quick accessibility to computer media and miscellaneous work materials. Transaction components transform desks into reception counters and keep important business forms at the user's fingertips in a presentable organized manner.

Featuring premier quality laminates in six faux wood finishes, and three solid finishes Harmony's color palette offers cool to warm tones that work in any environment. *Harmony—a tremendous value for your furniture investment.*

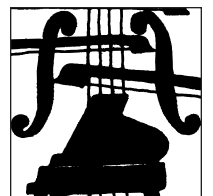

**1000
SERIES**

Double
Pedestal Desk,
Wardrobes
with Credenza

Harmony excels in ease of assembly and configuration allowing for a powerful and exciting workplace. You'll find this line gives you many options, such as this distinctive bowed-front desk and comprehensive utility credenza. There are any number of items that can be added to these basic units to customize your space. In this example, complementing the free-standing desk are matching wardrobes at each end of the wall unit. Overhead storage, a mobile pedestal and a versatile paper management organizer are all part of a modular work space designed for convenience.

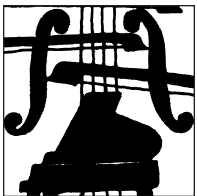
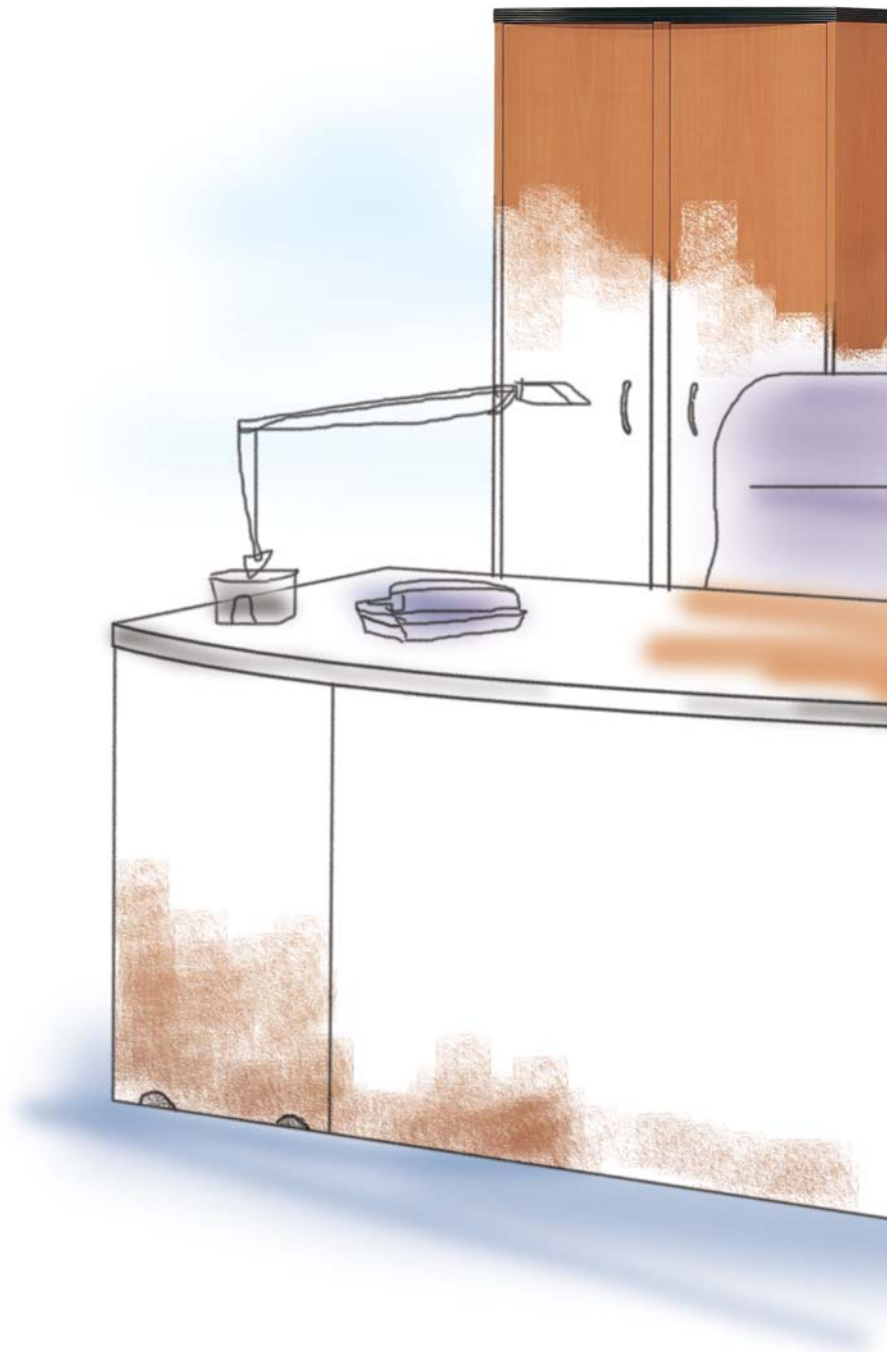



HE1500P
Shown in Pearwood

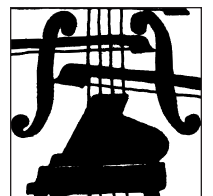

**2000
SERIES**

Single
Pedestal Desk,
Computer
Workstation

Harmony's components include desks, bridges, credenzas, corner units, and over-desk units with open-back or closed-back options. The transitional style and pleasing scale of this line work well with both contemporary and traditional seating and other office furnishings. Harmony offers lasting beauty while meeting the functional needs of today's office environment. Here, the complete working office is enhanced with a corner computer workstation. Extensive overhead storage and bookcase shelving free up the work surface for major projects. Harmony's storage system supplements any configuration with mobile and fixed pedestals. Optional lateral filing cabinets also provide ample and secure storage.





Lateral File Options For All Series



HE2500RM
Shown in Mahogany

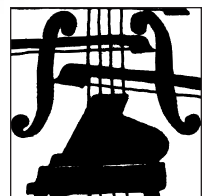

**3000
SERIES**

Transaction
Counter,
Bridge and
Credenza

With its strong, proven solution to the storage and retrieval of business documents, convenient placement of communications equipment and extensive space-planning possibilities, Harmony supports state-of-the-art information management and successful user interchange. This U-shaped workstation, with transaction counter and multiple filing and storage options, makes a distinctive and welcoming visitors area. You can plan your space in a clear and logical manner with this line. Create areas for workers who consult with others frequently, but also need computer work space to complete private tasks.

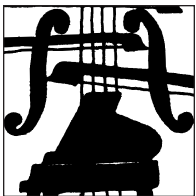



HE3500RA
Shown in Ash

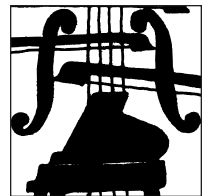

**4000
SERIES**

Conference
End, Bridge
and Credenza

Harmony's components provide semi-private office settings for managers and others requiring computer work space, meeting areas, varying amounts of storage, and the ability to interact with co-workers. The configurations in this series provide maximum desk surface and storage capacity without relinquishing aesthetic appeal. This workstation features a conference end for informal meetings. Easy access to stored files and ample desk surface area provide the work space needed for project-driven managers. Harmony's quality laminate and modular construction offer casegoods with the stability, look and feel of high-end wood furniture. Harmony products resist damage from spills, abrasions, heat and the harmful effects of direct sunlight, while providing an ageless appearance for years to come.

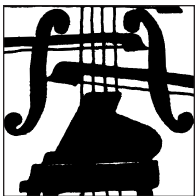



HE4500RC
Shown in Cherry

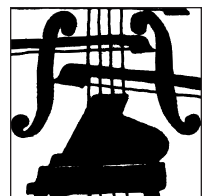

**5000
SERIES**

Conference
End Desk,
Bridge and
Credenza with
Wardrobe

Beauty you'll be proud of, function you can rely on, and convenience you'll appreciate more each day. This Harmony series gives you the refreshing ability to enjoy a well-designed office environment with a clearly defined work flow. In this combination, a spacious desktop with conference end is accented by an assortment of organizing and utility spaces. With side shelves in the wardrobe unit for project-oriented manuals and books, it can also be used for display. The Harmony advantage is ease of space planning, ease of assembly, and ease of maintenance. So, in whatever configuration you choose, you'll always have the best options for adding convenience to your work environment.

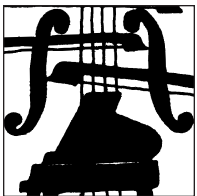



HE5500RO
Shown in Oak

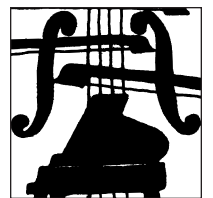

**6000
SERIES**

L-Wall Unit,
With Wardrobe

Harmony's clean profile and pleasing proportions enhance any office space. The streamlined edge detail, sophisticated selection of wood or solid finish laminates, and understated drawer pulls meet a wide variety of aesthetic requirements. Within the confines of this L-shaped unit, you'll find a remarkable amount of storage space—from filing cabinets, to overhead storage alternatives and even a wardrobe. By adding the optional articulating keyboard, the L-wall unit becomes a computer workstation. Components with a transitional style and many different applications, in attractive finishes—now that's working in Harmony!

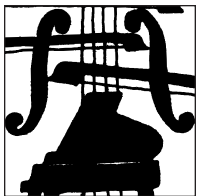



HE6400LF
Shown in Fog

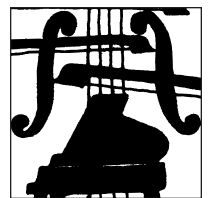

TABLES

Conference Tables



Round Conference Table, H42RDTBG
Shown in Maple



As Center Section Only, H3672TBG
Shown in Maple

Conference Tables Of Distinction

Impressive in scale and versatility, Harmony tables will distinguish your conference areas. Classic and stylish, the ribbed-edge molding perfectly accentuates the contemporary lines of these tables and offers protection against the bumps and bruises common to multi-purpose furniture.

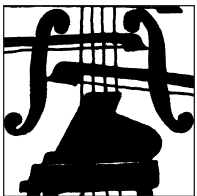



Full Conference Table, H3672TBG
With Conference Ends, H36RTTEG
Shown in Maple



As Ends Only, H36RTTEG
Shown in Maple

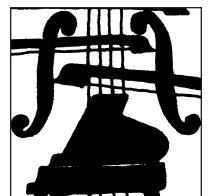

DETAILS



Paper Management System

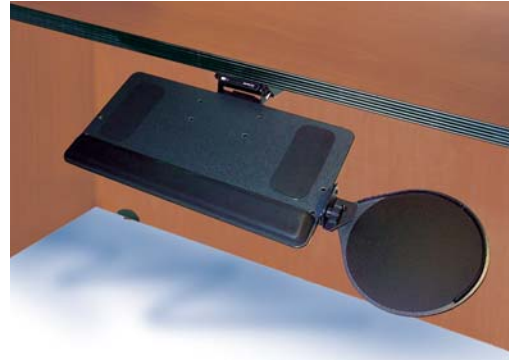

Fully Articulating ADA Keyboard with Mousepad



Ribbed Edge Detail with Wire Management Grommet



Solid Wood Drawer Construction with Glides, Contemporary Pull

Options And Details

It is a pleasure to work at good quality furniture that is well-designed with attention to detail. All in black, the grommets, paper management system, articulating keyboard, ribbed-edge molding and mobile pedestals give a dynamic color contrast to the

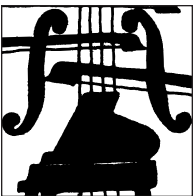

FINISHES

Fog - F
*F



Light Ash - A
*A



Pennsylvania Cherry - C
*C



Maple - G
*G



Mahogany- M
*M



Oak - O
*O



Pearwood - P
*P

* - Build current Harmony stock numbers using single letter designators.

exciting laminate choices. These details work together to define Harmony's distinctive lines and clean appearance. All Harmony items are available in the finishes shown above. Harmony laminates coordinate with UNICOR's wood veneer products.

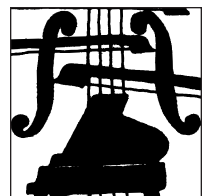

**1000
SERIES**

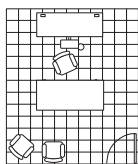

HE1100_

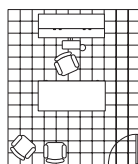

HE1200_

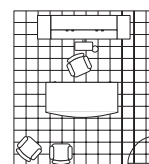

HE1300_

**2000
SERIES**

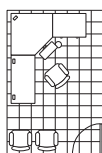

HE2100_

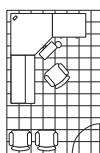
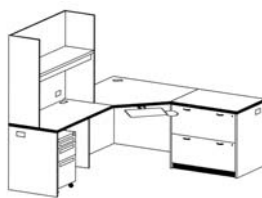

HE2200_

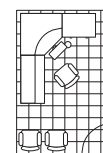
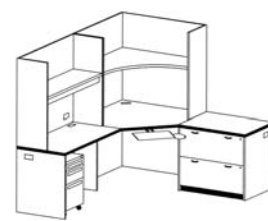

HE2300_

**3000
SERIES**

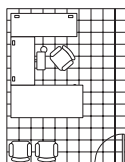
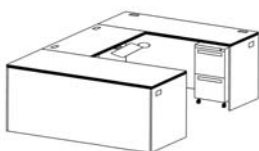

HE3100_

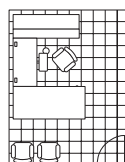

HE3200_

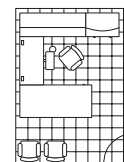

HE3300_

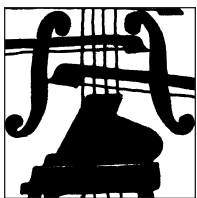

Note: Plan view scale, one square equals one foot

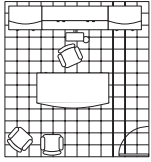

HE1400_

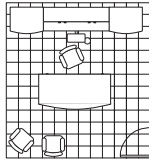

HE1500_

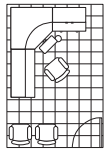
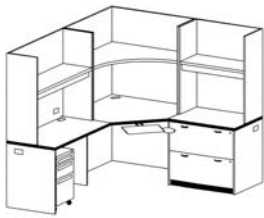

HE2400_

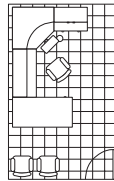
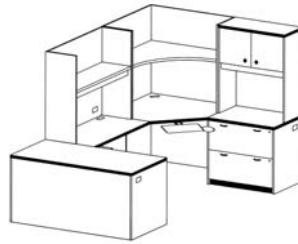

HE2500_

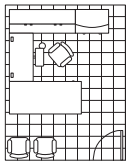

HE3400_

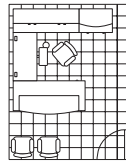

HE3500_

Note: Plan view scale, one square equals one foot

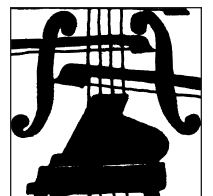

**4000
SERIES**

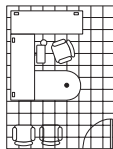

HE4100_

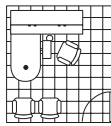

HE4200_

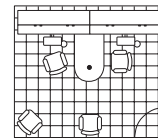

HE4300_

**5000
SERIES**

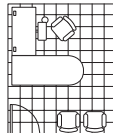

HE5100_

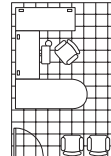

HE5200_

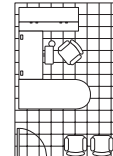

HE5300_

**6000
SERIES**

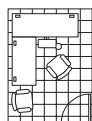

HE6100_

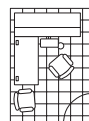

HE6200_

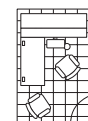

HE6300_

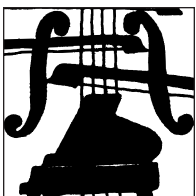

Note: Plan view scale, one square equals one foot

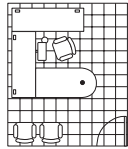

HE4400_

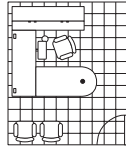

HE4500_

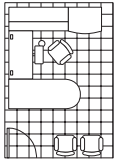
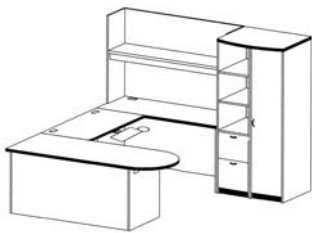

HE5400_

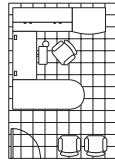

HE5500_

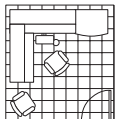

HE6400_



HE6500_

Note: Plan view scale, one square equals one foot

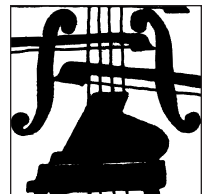

H A R M O N Y



www.unicor.gov/office_furniture

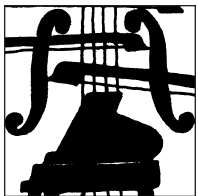

The
OFFICE
FURNITURE
GROUP

(800) 827-3168

www.unicor.gov

CATA304 FPI-PET
Printed on Recycled Paper