

CPSC Mattress Seminar

Prototyping

Bob Sabalasky

Lilly Management Group

These presentations were not prepared by the Commission or Commission staff and are not official documents of the CPSC, have not been reviewed by, and may not necessarily reflect the views of, the Commission.

February 16, 2006

- On February 16, 2006 the Consumer Products Safety Commission gave final approval to the new federal open-flame standard called 16 CFR Part 1633.
- The new standard applies to *ALL* mattresses and mattress/foundation sets sold in the United States on or after July 1, 2007.

Observations

- 16 CFR Part 1633 does NOT replace the current 16 CFR Part 1632 cigarette ignition standard.
- It is NOT the same as California Technical Bulletin 603.
- 1633 requires prototype certification, a quality assurance program and detailed recordkeeping.



Starting the Compliance Process

Starting the Compliance Process

- Select “point person” for FR program
 - Responsible for reviewing, understanding and explaining all parts of 16 CFR Part 1633
 - Responsible for coordinating ALL aspects of the compliance program within your company
- Determine Timeline for Implementation
 - Mandatory Compliance Date: July 1, 2007
 - How much time do I need to switch out current line with new FR line?
 - When will I introduce new product line to my retailers?

Timeline for Implementation

1633 Timeline to Meet Compliance Date

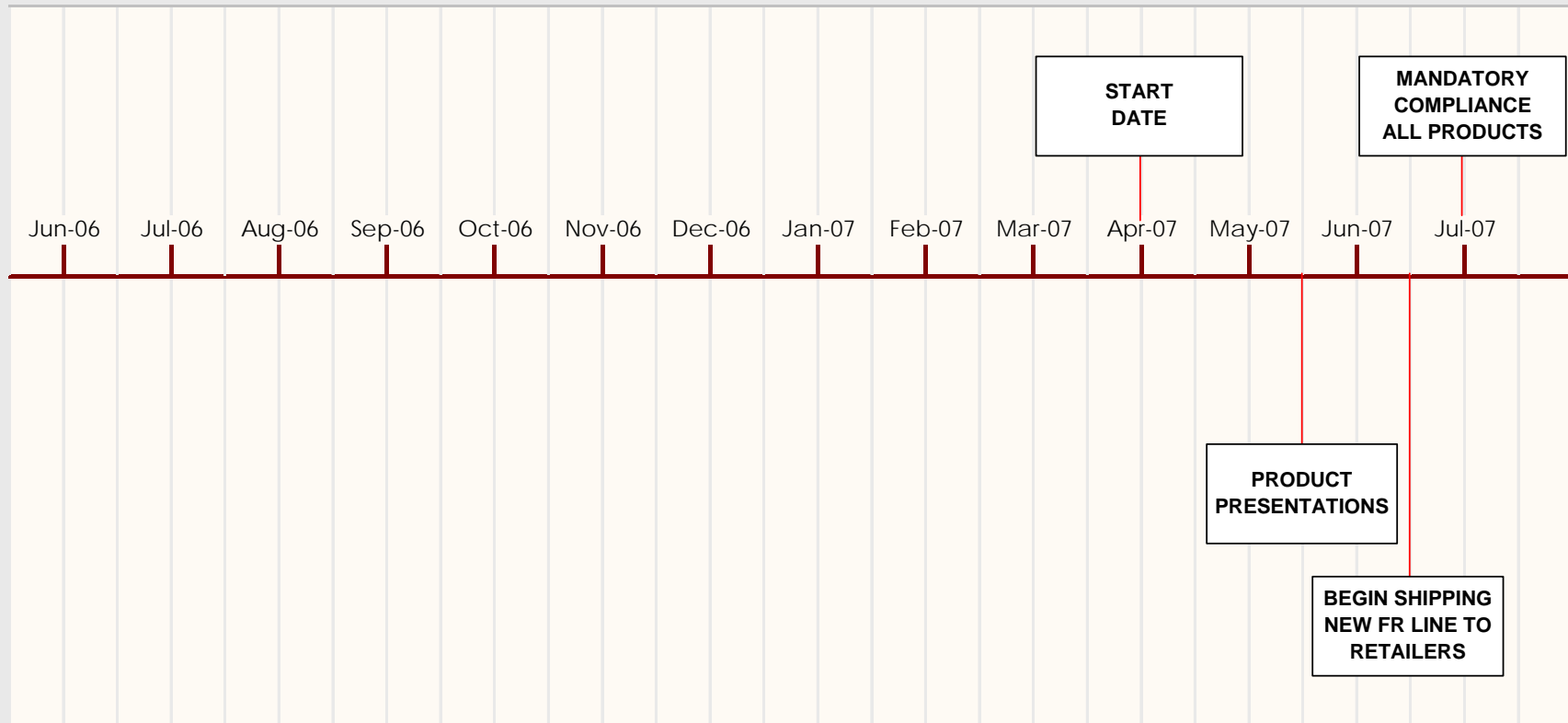

Timeline for Implementation

1633 Timeline to Meet Compliance Date

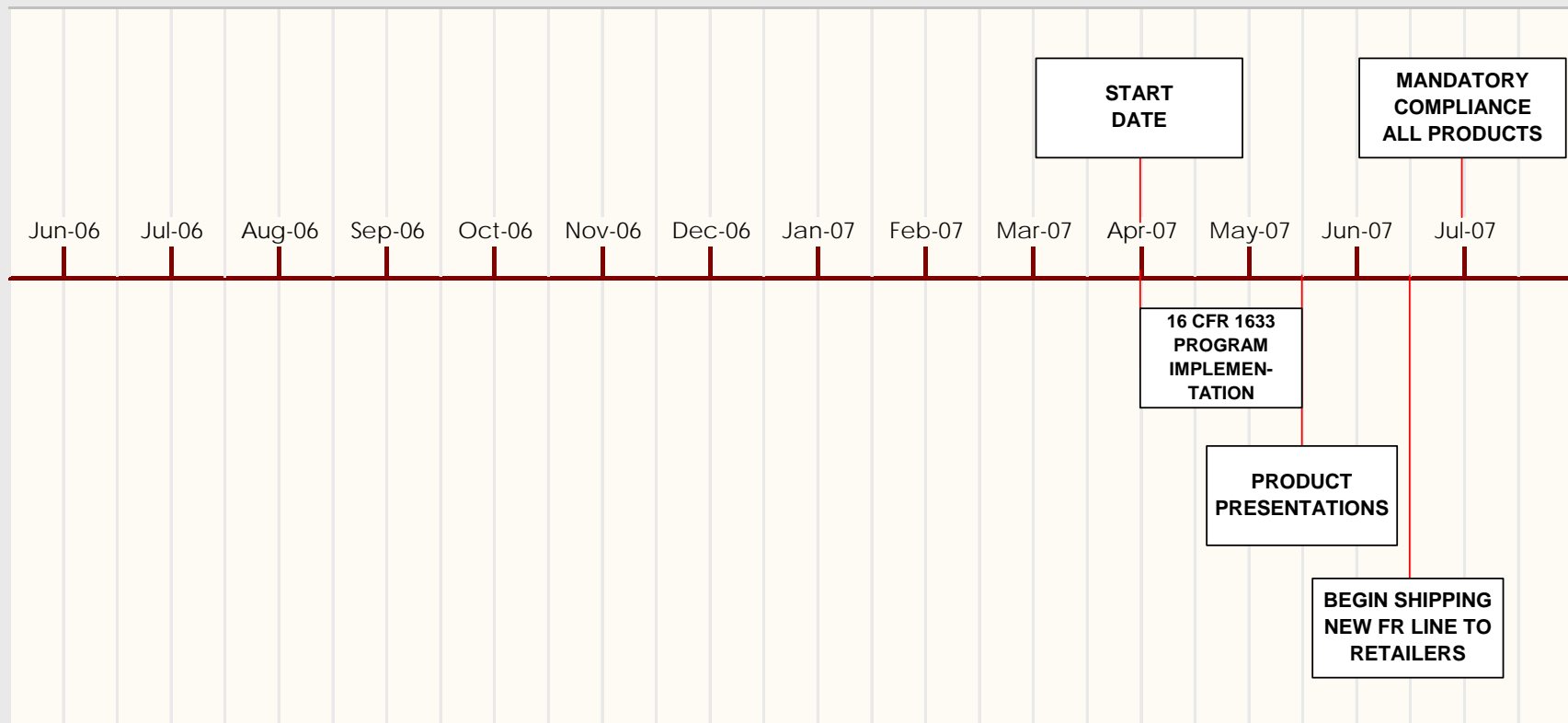

Timeline – Strategic Approach

1633 Timeline to Meet Compliance Date

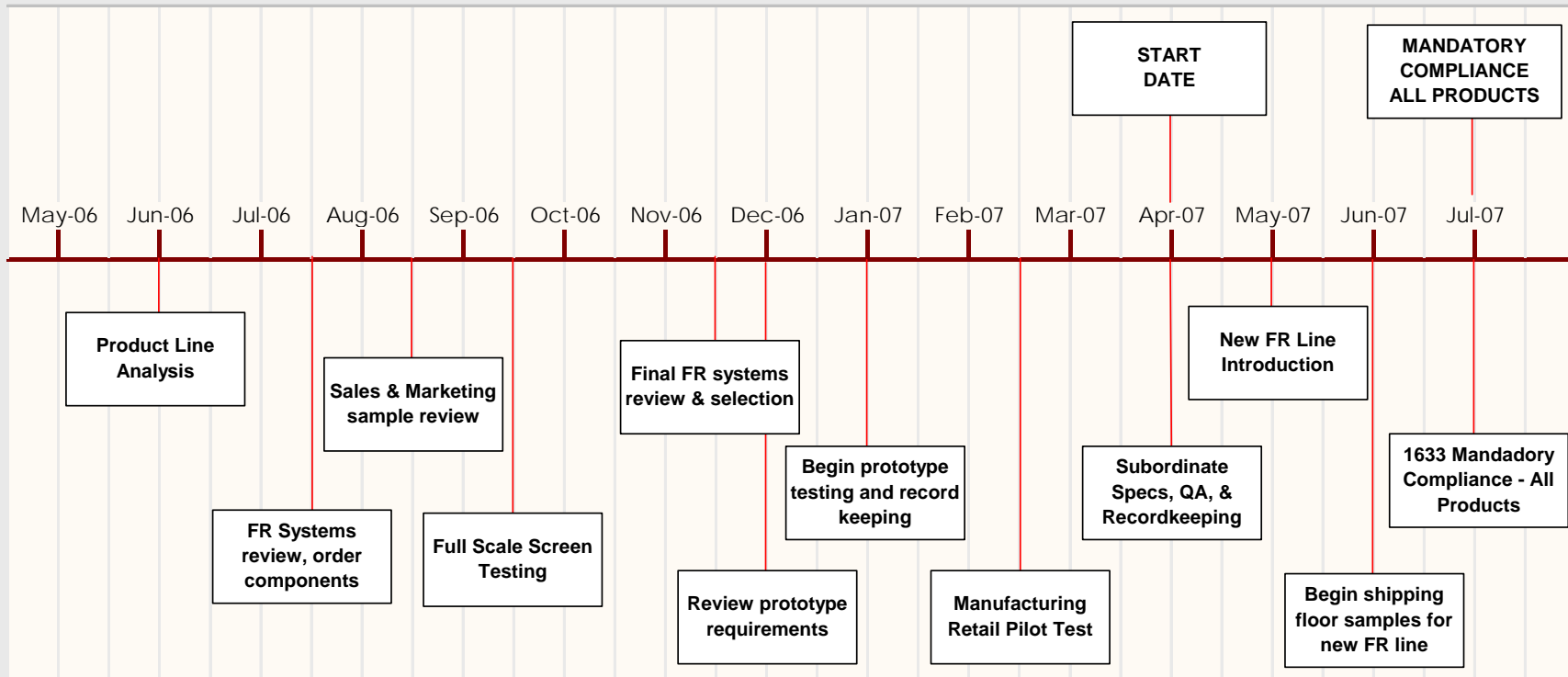

16 CFR Part 1633 Requirements

- Prototypes
 - Qualified
 - Confirmed
 - Subordinate
- Quality Assurance Program
 - Inspections (Incoming, WIP & Finished Goods)
 - Production Lots
- Recordkeeping
 - Prototype Test Results
 - Prototype Records
 - Quality Assurance

16 CFR Part 1633 Requirements

- Labeling
 - Sold With Boxspring
 - Sold Without Boxspring (Mattress Only)
 - Sold With or Without Boxspring



16 CFR Part 1633 Implementation

16 CFR Part 1633 Implementation

- Product Line Analysis
- FR Systems Review
- FR System “Screen Testing” & Selection
- Qualify Prototypes
- Preparing for Production
 - Confirm Prototypes
 - Create Subordinate Prototypes
 - Quality Assurance Program
 - Recordkeeping
- Maintaining Compliance

Product Line Analysis

Product Line Analysis

- General Information
 - Retail Price Points by % of units sold
 - Mattress Type & Height by % of units sold
 - Boxspring Type & Height by % of units sold
- Mattress Specific
 - One or Two Sided (or both)
 - Constructions Offered
 - Core Unit: Innerspring, Foam Encased, Foam Core, Visco
- Boxspring Specific
 - Sewing Method
 - High or Low Profile
 - Unit
- Sets versus Mattress Only

Product Line Analysis

- Manufacturing Specific
 - Current processes and procedures
 - Current equipment and capacity (by department)
 - Current quality control procedures within each department and/or operation
- Purchasing Specific
 - Current suppliers
 - Supplier locations
- Future Considerations - Sales & Marketing
 - Top Panels
 - Borders
 - Bottom Panels
 - Boxspring

FR Systems Review

FR Systems Review

- How many FR systems do I need?
- How many FR systems can my factory handle?
- How will I differentiate the various FR systems within my factory?
- FR components selection criteria
 - Product Aesthetics
 - Supplier Capacity and Manufacturing Locations
 - Supplier QA and Component Certification
 - Cost
- Full Scale Sampling
 - Sales and Marketing Evaluation
 - Manufacturing Evaluation
 - Final Cost Impact
- Select possible FR solutions



FR Screen Testing & Selection

FR System "Screen" Test & Selection

- Produce identical twin size samples (2 each) for each possible FR system to compare FR performance

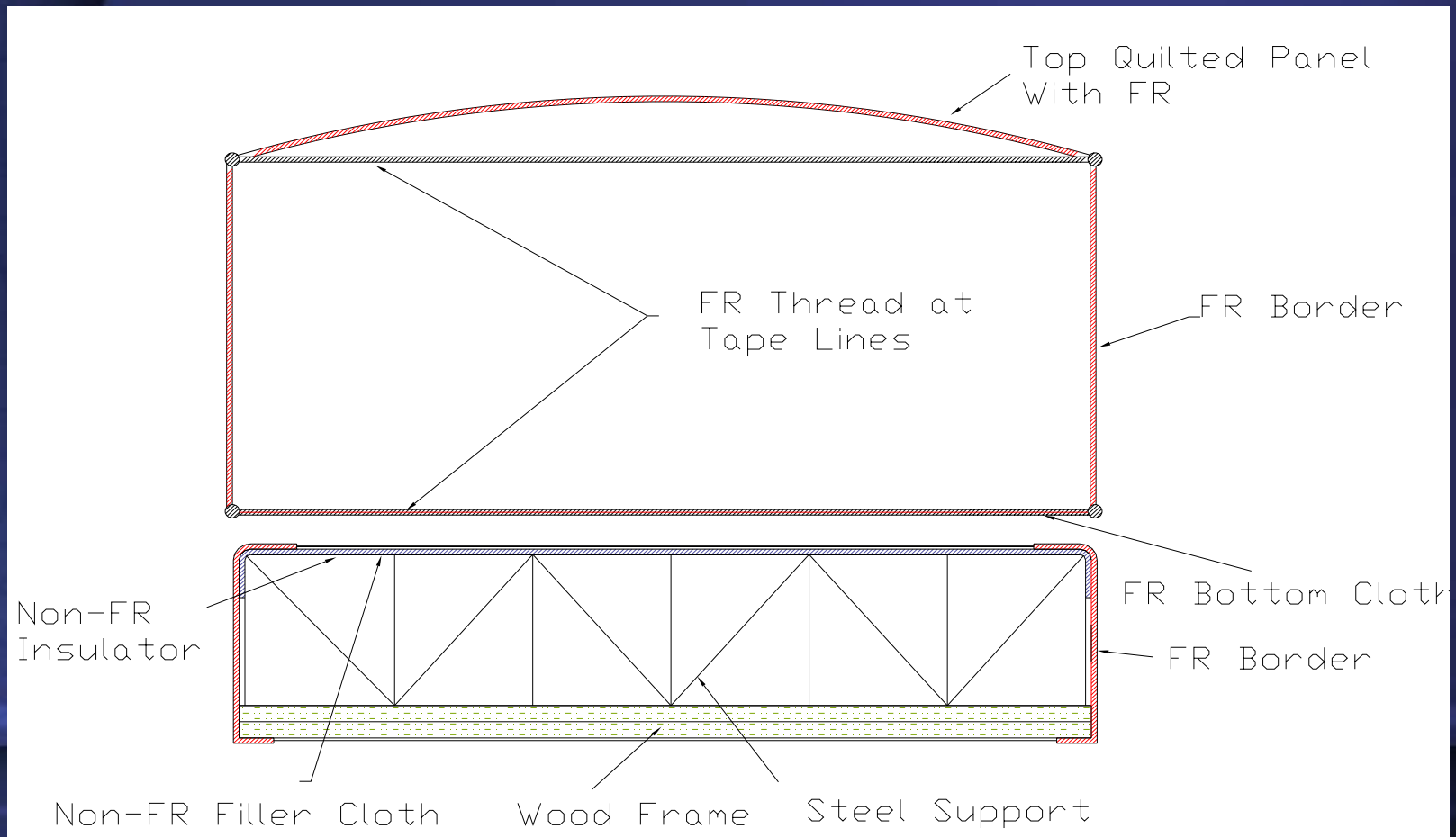

FR System "Screen" Test & Selection

- Test for 16 CFR Part 1633
 - Attend the burn
 - Document burn characteristics of various systems
 - Rate FR systems tested
- FR System Selection
 - Build additional samples (if required) for review
 - Review Sales, Marketing, Manufacturing & Purchasing aspects of each FR system
 - Select FR System(s) to Qualify

Assistance in Selecting FR System without Testing

- ***Consulting Groups / 3rd Party Prototype Developers***
 - Sampled and Qualified several FR component weights, blends and FR systems. Should be able to offer performance data on various FR systems.
- ***Suppliers***
 - Usually have tested and Qualified their own FR System. Ask for test results.
- ***Other Manufactures***
 - Review FR components and specifications used by manufacturers who might be willing to share their information and test results.

Qualify Prototypes

Qualified Prototypes

- *What is a “Qualified Prototype”?*
 - A Qualified Prototype is a representative sample of a mattress or mattress set introduced for sale in the U.S. that has passed the “burn test” a minimum of three consecutive times.
 - Each Qualified Prototype must be assigned a unique identification number.
 - Every mattress or mattress set sold in the U.S. must include the Qualified Prototype identification number on which the specification is based.
 - The regulation does not stipulate prototype requirements; the number of Qualified Prototypes is determined by the manufacturer.

Qualified Prototypes

- ***Smart prototyping is the single most important step in controlling cost during the compliance process.***
 - Too MANY prototypes = wasted time and high up front cost with no additional benefits.
 - Too FEW prototypes = increased risk of non-compliance and perception of manufacturer's intent to comply with the regulation.

Confirmed Prototypes & Prototype Pooling

- *What is a “Confirmed Prototype”?*
 - One manufacturer can “pool” Qualified Prototype specifications from another manufacturer, supplier or 3rd party as long as:
 - The manufacturer passes one confirmation burn of the pooled prototype. After passing the burn test, it is now referred to as a **Confirmed Prototype**.
 - The manufacturer maintains a copy of the prototype test records and the unique prototype identification number from the original manufacturer or supplier
 - The manufacturer can now use the Confirmed Prototype specifications to introduce Subordinate Prototype specifications.
 - Very beneficial and cost effective to companies who have multiple facilities and have implemented a “core” line where product specifications must be followed.

Subordinate Prototypes

- *What is a “Subordinate Prototype”?*
 - A Subordinate Prototype is a mattress or mattress set introduced for sale in the U.S. that is based on a Qualified or Confirmed Prototype and differs only in:
 - Size
 - Ticking
 - Components or materials shown not to degrade flammability performance
 - Each Subordinate Prototype requires a record of the manufacturing specification and description of variation from the Qualified Prototype
 - Each Subordinate Prototype requires documentation “based on reasonable criteria” that changes will not cause failure.

Qualify Prototypes

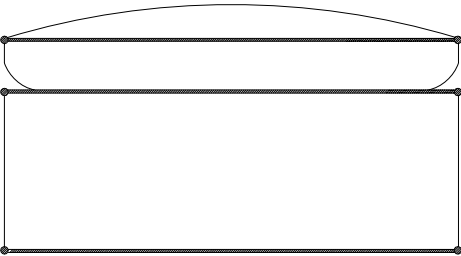

Super Pillow Top

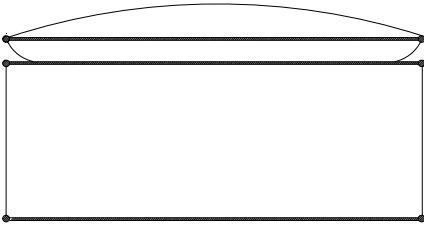

Pillow Top

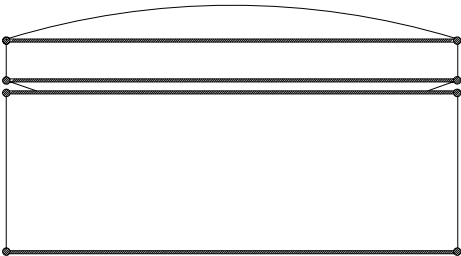

Ultra Cushion/Box Top

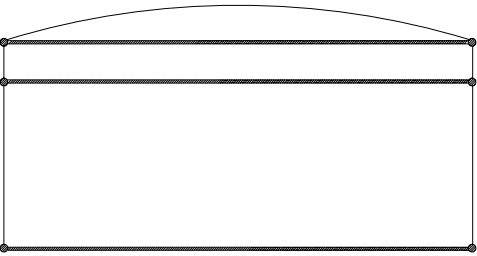

Euro Top

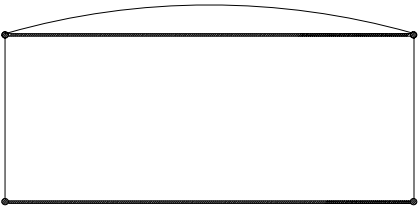

Tight Top



Smooth Top

Qualify Prototypes

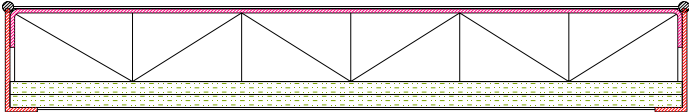

Taped Low Profile

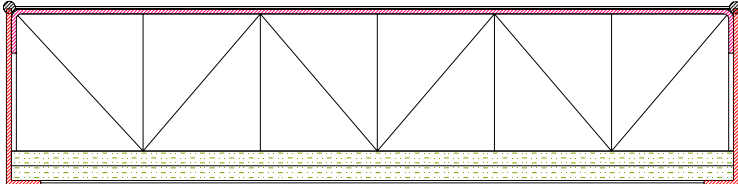

Taped High Profile

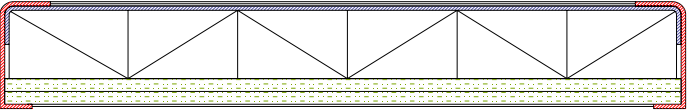

Continental Low Profile

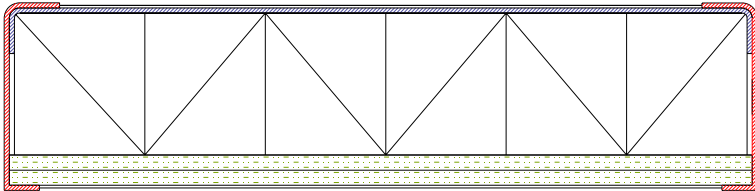

Continental High Profile

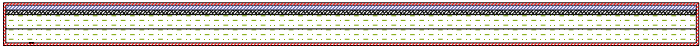

Bunkie Board

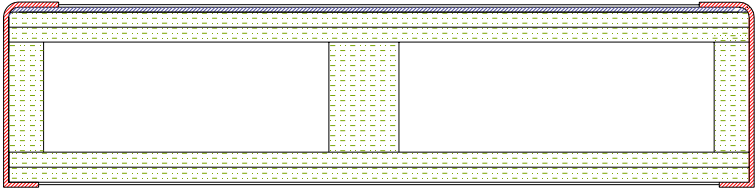

Wood Build Up

No Boxspring – Mattress Only

Qualify Prototypes

Realistic Product Line Offering (All Single Sided):

<u>Core Unit</u>	<u>Choice of Firmness</u>	<u>Panel Quilts</u>	<u>Boxsprings</u>	<u>Thickness Range</u>
Innerspring	Tight Top	All Foam	Continental - Hi Pro	0" - 20"
Foam Encased	Pillow Top	Foam & Fiber	Taped Hi Pro	
Visco Core	Super Pillow Top		Continental - Lo Pro	
Latex Core	Euro/Box Top		Taped - Lo Pro	
	Ultra Cushion Top		Wood Build Up	
	Smooth Top		Bunkie Board	
			No Boxspring	

Total Product Line Variations

336

Determining Prototypes to Qualify

- Review Product Line Offerings & Options
 - Mattress Constructions
 - Tight Top, Pillow Top, Box Top Smooth Top, etc...
 - One Sided, Two Sided or Both
 - Boxspring Constructions
 - Taped, Inverted Seam, Continental
 - High & Low Profile, Wood Build Up, Bunkie, etc...
 - Quilt Specifications
 - FR Barrier Directly under Ticking
 - Sacrificial Layer above FR Barrier
 - Sold as mattress only or sets
- Determine “Worst Case” scenarios within Product Line
- Determine “Reasonable Criteria” for specs not tested

Possible Issues with Qualifying Prototypes

- Do not have a good understanding of 1633 requirements
- Have never witnessed a burn test and do not know how constructions effect FR performance
 - Over compensate and test too many prototypes
 - Burn too few prototypes to reduce compliance costs
- Do not understand how to establish Reasonable Criteria for Subordinate Prototypes

Qualified Prototype Guidelines

- Testing Experience
 - Witnessed over 800 tests with Lilly Management Group
 - Witnessed over 500 tests at Serta Mattress Company
- Observations
 - Not all mattress constructions perform the same
 - Boxspring DO affect FR Performance of the set AND there is a difference between low profile, high profile, wood build up and bunkie board boxsprings
 - Handles, polyethylene edge supports and foam encasement can all affect FR performance of a mattress
 - Ticking Selection on Qualified Prototypes

Qualified Prototype Testing

- Items that ***influence*** results
 - The “gap” or “smile” between a mattress and boxspring will have a significant impact on the FR performance of a mattress set
 - Overlap of “continental border” can have an impact on FR performance of mattress set (especially two sided mattresses)
 - Mattress versus Boxspring finished size (Foam Encased)
 - Wrinkled or “saggy” borders
 - Borders that are too tight

Qualified Prototype Testing

- Items that **almost always** cause failures
 - FR component does not extend to all edges of panel and/or border
 - Operators use a “butt seam” when transitioning from one roll to another in the quilting operation
 - Thin spots or windows in FR component
 - FR Component is being “stretched” as it goes through quilter resulting in thin spots in finished panel and/or border
 - Failure to use FR Thread where specified
 - Border and panel not caught in tape line

Where can I get Qualified Prototypes?

- ***Consulting Groups / 3rd Party Prototype Developers***
 - Qualified several FR component weights, blends and FR systems.
- ***Suppliers***
 - May have Qualified their own FR System. Ask for test results.
- ***Other Manufactures***
 - Review FR components and specifications used by manufacturers who might be willing to share their information and test results.

Pooling Qualified Prototypes – What to ask for

- Prototype Specifications
 - Mattress & Boxspring constructions and combinations
 - Methods of Construction
 - Non FR component specifications
- Unique Qualified Prototype Identification Numbers
- Qualified Prototype Test Results & Video/Pictures
- REASONABLE CRITERIA
 - Changes in construction, raw materials and/or methods
 - 90% of Subordinates will be through Reasonable Criteria

Reasonable Criteria – Are these covered?

- Qualified Prototype
 - Tight Top, 6” Foam (1.2#), 9” Continental Boxspring
- Subordinate #1
 - Pillow Top, 6” Foam (1.2#), 9” Continental Boxspring
- **No, Pillow Top constructions burn differently than Tight Tops. Must have additional testing.**
- Subordinate #2
 - Tight Top, 4” Foam (1.2#), 9” Continental
- **Yes. Same construction, same boxspring, less foam.**
- Subordinate #3
 - Tight Top, 6” Foam (1.2#), 5.5” Continental
- **No. Need testing to demonstrate 5.5” boxspring will not effect FR performance of set.**
- Subordinate #4
 - Euro Top, 6” Foam (1.2#), 9” Continental
- **No. Different mattress construction. Must have additional testing.**

Reasonable Criteria – Are these covered?

- Qualified Prototype
 - Tight Top, 6” Foam (1.2#), 9” Continental Boxspring
- Subordinate #5
 - Tight Top, 6” Foam (1.2 #), 9” Taped Boxspring
- **No. Taped Boxsprings will perform differently than Continental Boxsprings. Must have additional testing.**
- Subordinate #6
 - Tight Top Foam Encased, 4” Foam (1.2#), 9” Continental
- **No. Different mattress construction.**
- Subordinate #7
 - Tight Top, 6” Foam (1.5#), 9” Continental
- **Maybe. Must have test data to support difference between 1.5# and 1.2# foam.**
- Subordinate #8
 - Tight Top, 6” Foam (1.0#), 9” Continental
- **Maybe. Must have test data to support difference between 1.0# and 1.2# foam.**

The background is a dark blue gradient with several overlapping, semi-transparent shapes. On the left side, there is a grid pattern. The overall aesthetic is modern and professional.

Prepare for Production

Prepare for Production

- Confirm Prototypes (If using prototype pooling)
- Create Subordinate Prototypes
 - 90% of products inspected will subordinate specifications
 - Reasonable Criteria and “backup” test results are essential
- Quality Assurance Program
- Recordkeeping
- Labeling Requirements & System Changes
 - Permanent Label
 - Production Lots
 - Qualified, Confirmed & Subordinate Prototypes by Production Lot Number
- Manufacturing Considerations
 - FR Effect on Manpower Requirements
 - Equipment

Maintaining Compliance

Maintaining Compliance

- FR Training Program
 - Supervisors & Operators understanding of program
 - Video – Non FR Test
 - Video – FR Test
 - Video – Manufacturing Defects and effects on test results
 - Inspectors/QA
- Work In Process Inspection Program
- Final Inspection Program (what to look for)
- Finished Goods
 - Teardowns
 - Random Testing
- Third Party Audits

Resources for help

Resources for help

- Consultant Groups
- FR Component Suppliers
- FR Testing Laboratories
- ISPA
- CPSC - Interpretation of Regulation
- Sleep Products Safety Council

Questions?