

# The Mojave National Preserve

## Geology and Water Shape Desert Plant Communities

**By David Miller, Geologist, and John Nimmo, Soil Hydrologist**

*Also featuring presentation of a short video, "Mojave National Preserve-A Place to Explore"  
by Steve Wessells, USGS*



- One of the largest units in the National Park System, the Mojave National Preserve was established in 1994

- The Preserve encompasses great sand dunes (including "singing sands"), young volcanic features, forests of Joshua trees, and fields of wildflowers

- Maps of the surface geology can predict the distribution of vegetation types

- How do the different ways soils accept rainwater affect plant communities?

- Learn how USGS researchers are modeling the relations of geology, water, and desert plants

**Thursday, December 14, 2006, 7 p.m.**  
**USGS, Building Three, Menlo Park, CA**

Learn about all the activities the 1906 Earthquake Centennial Alliance is sponsoring throughout this year by going to <http://1906centennial.org>

See other side for USGS site map.

For information on USGS public events, call (650) 329-5000 or visit our website at <http://online.wr.usgs.gov/calendar/>  
U.S. Department of the Interior • U.S. Geological Survey • Western Region Center

## Directions to USGS Menlo Park Service Center

The campus of the USGS Menlo Park Service Center is located at 345 Middlefield Road in Menlo Park. From San Francisco, exit highway 101 at Marsh Road, Atherton and go west to the T junction of Middlefield and turn left (south). From San Jose, exit highway 101 at Willow Road, Menlo Park, and go west to the intersection with Middlefield, turning right (at the Chevron Station). Enter the USGS campus at Survey Land (the main driveway, with large stone markers labeled "U.S. Geological Survey"). You may park in any of our lots and walk to Building 3 (see campus map at right).

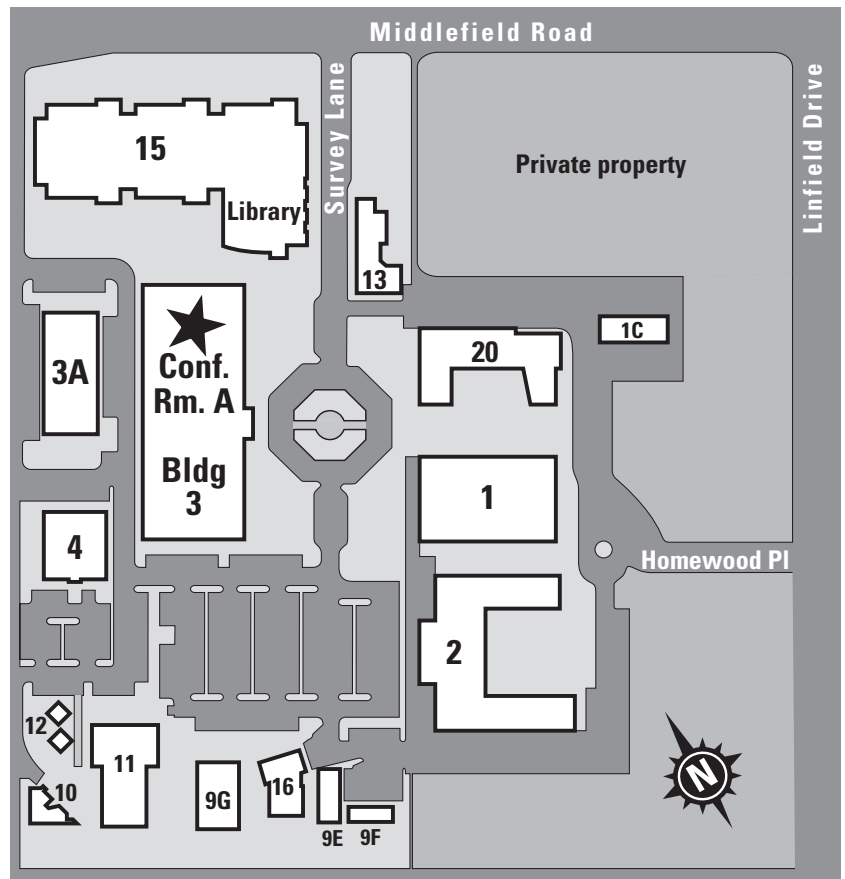
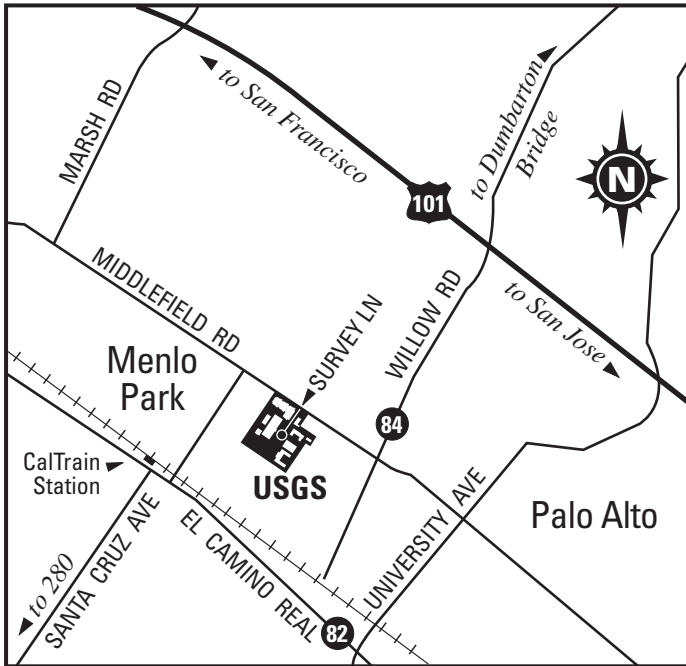

## Invitation to free public lecture at U.S. Geological Survey, Menlo Park Service Center



Office of Communications  
U.S. Geological Survey – MS144  
345 Middlefield Road  
Menlo Park, CA 94025

FIRST CLASS POSTAGE

