

P. L. 94-171 COUNTY BLOCK MAP (CENSUS 2000)

GEOGRAPHIC AREAS LEGEND

SYMBOL	NAME STYLE
*****	INTERNATIONAL
*****	AIR (FEDERAL)
*****	Trust Land
//////	STATE
	COUNTY
○○○○○	MINOR CIVIL DIV ¹
■■■■■	Incorporated Place ¹
■■■■■	Census Designated Place ¹
.....	Corporate Offset Boundary
●●●●●	Voting District ²
—	Census Tract
—	BLOCK ³
■	Military
■	Inset
■	Out Area

Abbreviation Reference: AIR = American Indian Reservation; Trust Land = Off-Reservation Trust Land

1 A "*" following a place name indicates that the place is consecutive with a MCD. A "-" indicates that the place is also a false MCD. In both cases, the MCD name is shown only when it differs from the place name.

2 A "*" following a VTD code indicates an actual voting district. Its absence indicates that the VTD is a pseudo voting district or no information is available as to its status.

3 A "*" following a block number indicates that the block number is repeated elsewhere in the block.

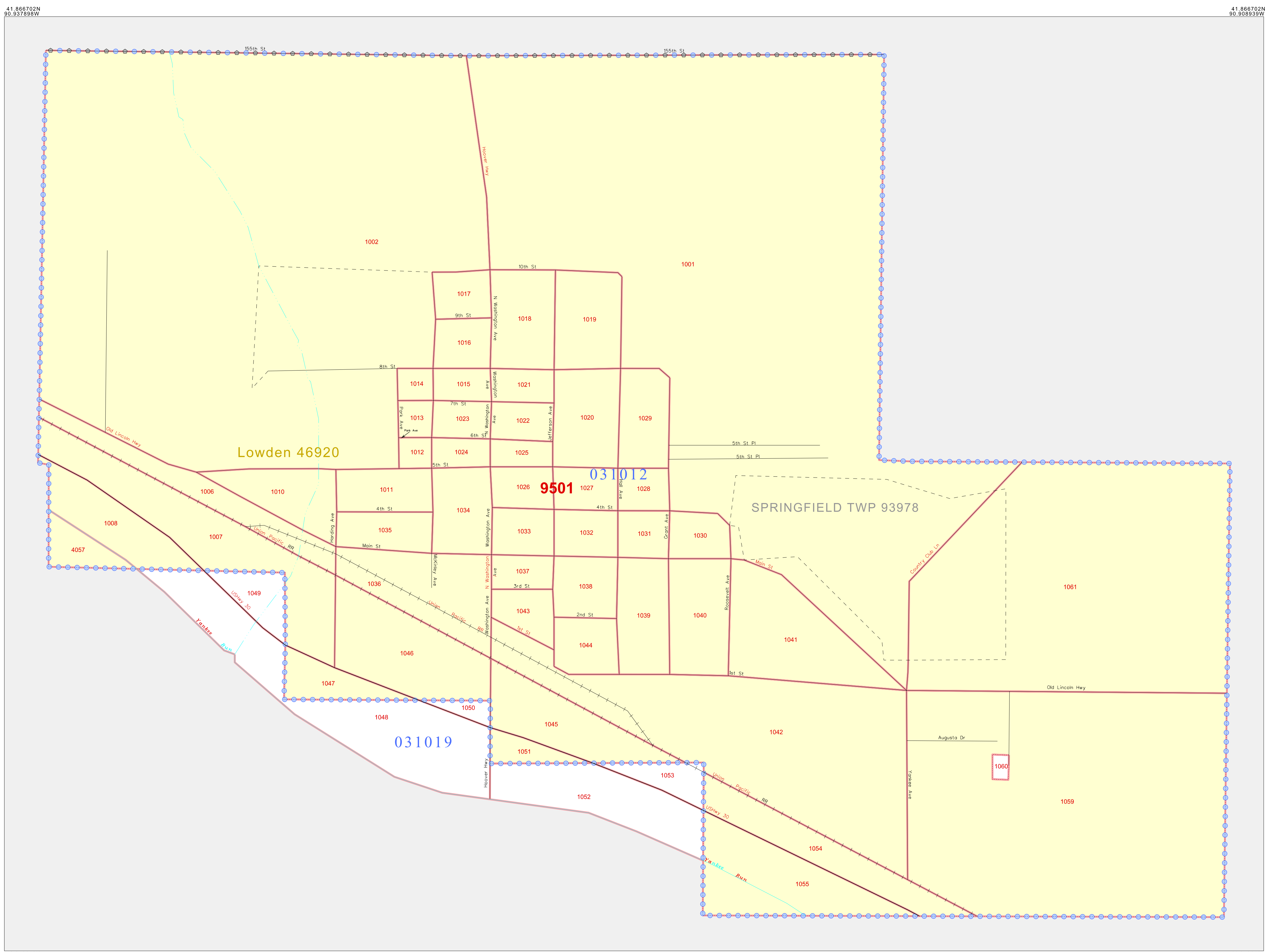

41.856702N 90.937895W (top-left and bottom-left coordinates)

41.856702N 90.908939W (top-right and bottom-right coordinates)

North arrow pointing up.

Scale bars: 0 to 2 miles and 0 to 3 kilometers.

The plotted map scale is 1:4000

Sheet Location within County: A small map showing the current sheet's location within the county.

Key to Adjacent Sheets: A grid showing the current sheet (D01) and its neighbors.

ST: Iowa (19)
 COU: Cedar (031)
 INSET SHEET D01

P.L. 94-171 COUNTY BLOCK MAP (CENSUS 2000)
 (CKPLBLK)2101903168010000000

All legal boundaries and names are as of January 1, 2000. The boundaries shown on this map are for Census Bureau statistical data collection and tabulation purposes only; their depiction and designation for statistical purposes does not constitute a determination of jurisdictional authority or rights of ownership or entitlement. U.S. DEPARTMENT OF COMMERCE Economics and Statistics Administration U.S. Census Bureau