

P.L. 94-171 COUNTY BLOCK MAP (CENSUS 2000)

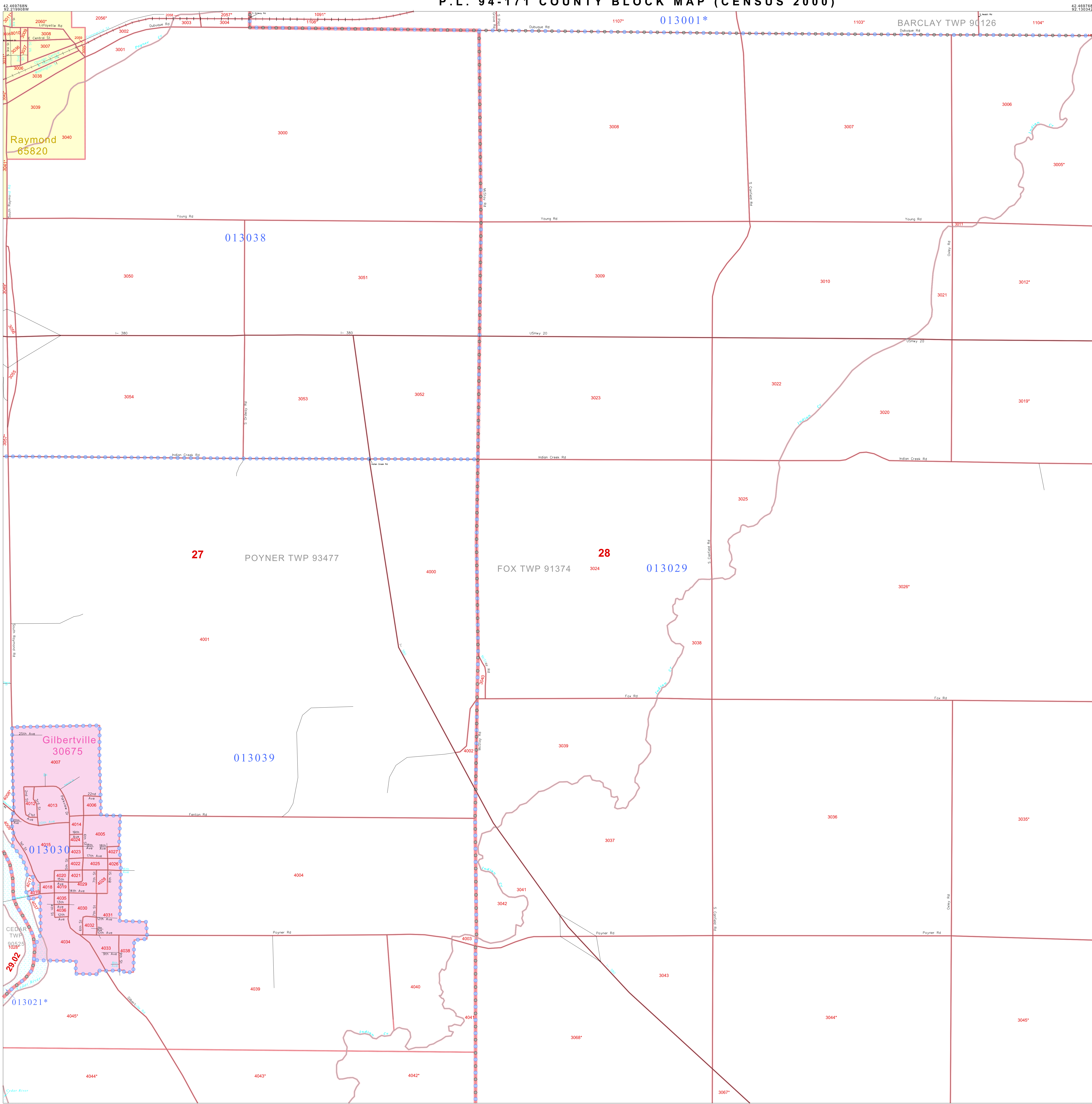

**GEOGRAPHIC AREAS LEGEND**

SYMBOL	NAME STYLE
*****	INTERNATIONAL
*****	AIR (FEDERAL)
*****	Trust Land
//////	STATE
	COUNTY
o-o-o-o-o	MINOR CIVIL DIV'
Yellow	Incorporated Place'
Light Yellow	Census Designated Place'
Blue Dotted	Corporate Offset Boundary
Blue Dotted	Voting District'
Red	Census Tract
Red	BLOCK*

Military  Inset  Out Area

Abbreviation Reference: AIR = American Indian Reservation; Trust Land = Gift/Reservation Trust Land

1 A "\*" following a place name indicates that the place is coterminous with a MCD. A "-" indicates that the place differs from the MCD. In both cases, the MCD name is shown only when it differs from the place name.  
 2 A "-" following a VTD code indicates an actual voting district. Its absence indicates that the VTD is a pseudo voting district or no information is available as to its status.  
 3 A "\*" following a block number indicates that the block number is repeated elsewhere in the block.

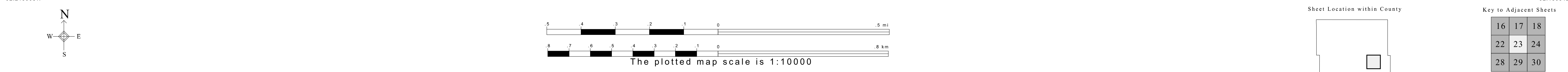

Sheet Location within County

Key to Adjacent Sheets

16	17	18
22	23	24
28	29	30

ST: Iowa (19)  
 COU: Black Hawk (013)  
 SHEET 23 OF 36 PARENT SHEETS

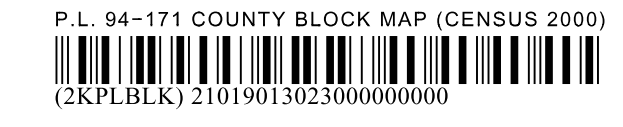

All legal boundaries and names are as of January 1, 2000. The boundaries shown on this map are for Census Bureau statistical data collection and tabulation purposes only; their depiction and designation for statistical purposes does not constitute a determination of jurisdictional authority or rights of ownership or entitlement. U.S. DEPARTMENT OF COMMERCE Economics and Statistics Administration U.S. Census Bureau