

GEOGRAPHIC AREAS LEGEND

| SYMBOL | NAME STYLE |
|-----------|--------------------------------------|
| ☆☆☆☆☆ | INTERNATIONAL |
| ★ ★ ★ ★ ★ | AIR (FEDERAL) |
| ◇ ◇ ◇ ◇ ◇ | SDA/SA |
| ○ ○ ○ ○ ○ | TRIBAL SUBDIVISION |
| /////// | STATE |
| ■■■■■ | COUNTY |
| ● ● ● ● ● | MINOR CIVIL DIV. ¹ |
| ■ ■ ■ ■ ■ | Incorporated Place ¹ |
| ■ ■ ■ ■ ■ | Census Designated Place ¹ |
| ----- | Corporate Offset Boundary |
| ● ● ● ● ● | Voting District ² |
| ————— | Census Tract |
| ————— | BLOCK ³ |
| ■ ■ ■ ■ ■ | Military |
| ■ ■ ■ ■ ■ | Inset |
| ■ ■ ■ ■ ■ | Out Area |

Abbreviation Reference: AIR = American Indian Reservation; SDA/SA = State Designated American Indian Statistical Area; Tribal Subdivision = American Indian Tribal Subdivision

1 A " " following a place name indicates that the place is consecutive with a MCD. A " " indicates that the place is also a false MCD. In both cases, the MCD name is shown only when it differs from the place name.

2 A " " following a VTD code indicates an actual voting district. Its absence indicates that the VTD is a pseudo voting district or no information is available as to its status.

3 A " " following a block number indicates that the block number is repeated elsewhere in the block.

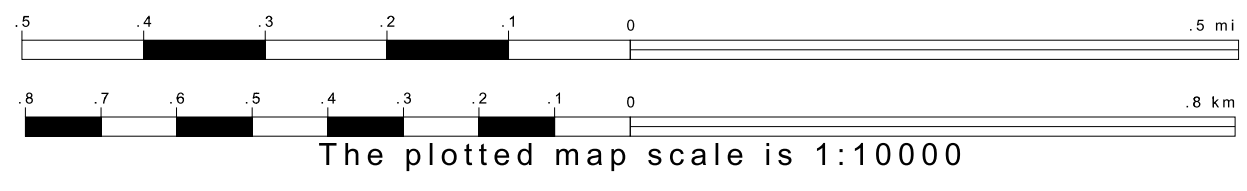
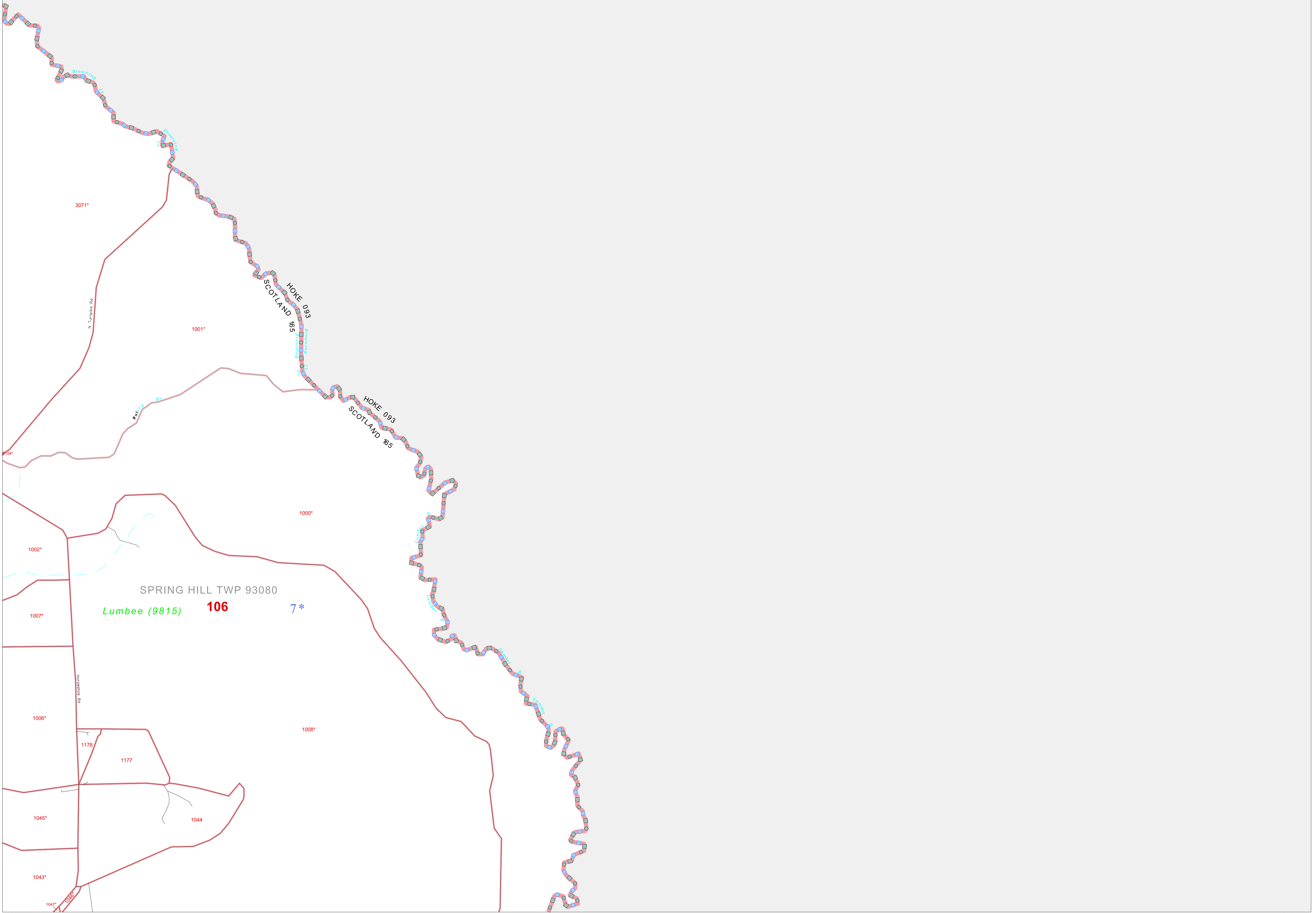

Sheet Location within County

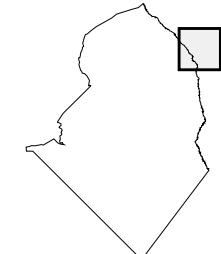

Key to Adjacent Sheets

| | |
|----|----|
| 3 | |
| 6 | 7 |
| 10 | 11 |

ST: North Carolina (37)
 COU: Scotland (165)
 SHEET 7 OF 27 PARENT SHEETS

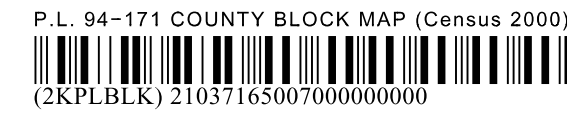

All legal boundaries and names are as of January 1, 2000. The boundaries shown on this map are for Census Bureau statistical data collection and tabulation purposes only; their depiction and designation for statistical purposes does not constitute a determination of jurisdictional authority or rights of ownership or entitlement. U.S. DEPARTMENT OF COMMERCE Economics and Statistics Administration U.S. Census Bureau