

P. L. 94-171 COUNTY BLOCK MAP (CENSUS 2000)

35 288938N
76.874788W

35 288938N
76.713105W

GEOGRAPHIC AREAS LEGEND

SYMBOL	NAME STYLE
☆☆☆☆	INTERNATIONAL
★ ★ ★ ★ ★	AIR (FEDERAL)
◇ ◇ ◇ ◇ ◇	SDA/ISA
○ ○ ○ ○ ○	TRIBAL SUBDIVISION
//////	STATE
■■■■■	COUNTY
□ □ □ □ □	MINOR CIVIL DIV. ¹
■ ■ ■ ■ ■	Incorporated Place ¹
■ ■ ■ ■ ■	Census Designated Place ¹
-----	Corporate Offset Boundary
● ● ● ● ●	Voting District ²
— — — — —	Census Tract
— — — — —	BLOCK ³
■ ■ ■ ■ ■	Military
□ □ □ □ □	Inset
□ □ □ □ □	Out Area

Abbreviation Reference: AIR = American Indian Reservation; SDA/ISA = State Designated American Indian Statistical Area; Tribal Subdivision = American Indian Tribal Subdivision
 1 A * * following a place name indicates that the place is consecutive with a MCD. A * * indicates that the place is also a false MCD. In both cases, the MCD name is shown only when it differs from the place name.
 2 A * * following a VTD code indicates an actual voting district. Its absence indicates that the VTD is a pseudo voting district or no information is available as to its status.
 3 A * * following a block number indicates that the block number is repeated elsewhere in the block.

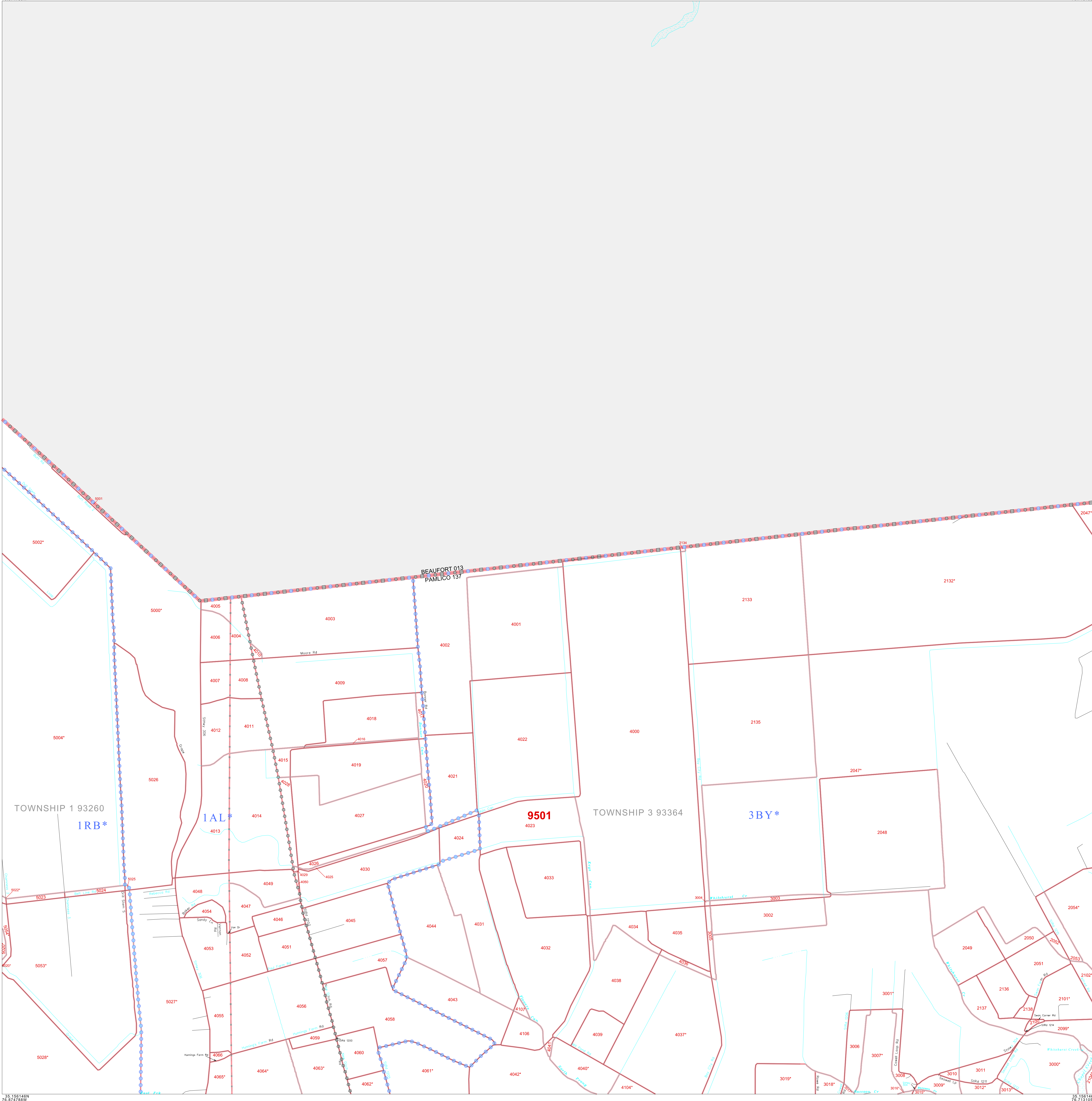

Sheet Location within County

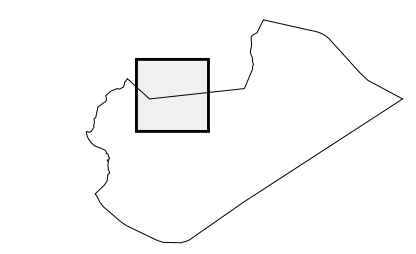

Key to Adjacent Sheets

		1
3	4	5
7	8	9

ST: North Carolina (37)
 COU: Pamlico (137)
 SHEET 4 OF 13 PARENT SHEETS



All legal boundaries and names are as of January 1, 2000. The boundaries shown on this map are for Census Bureau statistical data collection and tabulation purposes only; their depiction and designation for statistical purposes does not constitute a determination of jurisdictional authority or rights of ownership or entitlement. U.S. DEPARTMENT OF COMMERCE Economics and Statistics Administration U.S. Census Bureau