

P. L. 94-171 COUNTY BLOCK MAP (CENSUS 2000)

GEOGRAPHIC AREAS LEGEND

SYMBOL	NAME STYLE	
*****	INTERNATIONAL	
*****	AIR (FEDERAL)	
*****	SDA/SA	
*****	STATE SUBDIVISION	
//////	STATE	
	COUNTY	
	MINOR CIVIL DIV.¹	
	Incorporated Place¹	
	Census Designated Place¹	
.....	Corporate Offset Boundary	
.....	Voting District²	
.....	Census Tract	
.....	BLOCK³	
Military	Inset	Out Area

Abbreviation Reference: AIR = American Indian Reservation; SDA/SA = State Designated American Indian Statistical Area; Tribal Subdivision = American Indian Tribal Subdivision

1 A \* \* following a place name indicates that the place is consecutive with a MCD. A \* \* indicates that the place is also a false MCD. In both cases, the MCD name is shown only when it differs from the place name.

2 A \* \* following a VTD code indicates an actual voting district. Its absence indicates that the VTD is a pseudo voting district or no information is available as to its status.

3 A \* \* following a block number indicates that the block number is repeated elsewhere in the block.

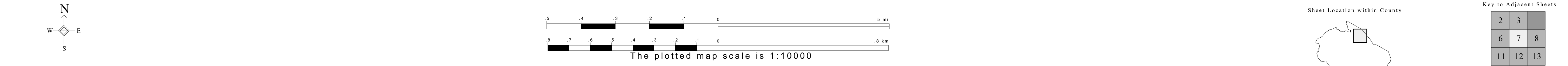
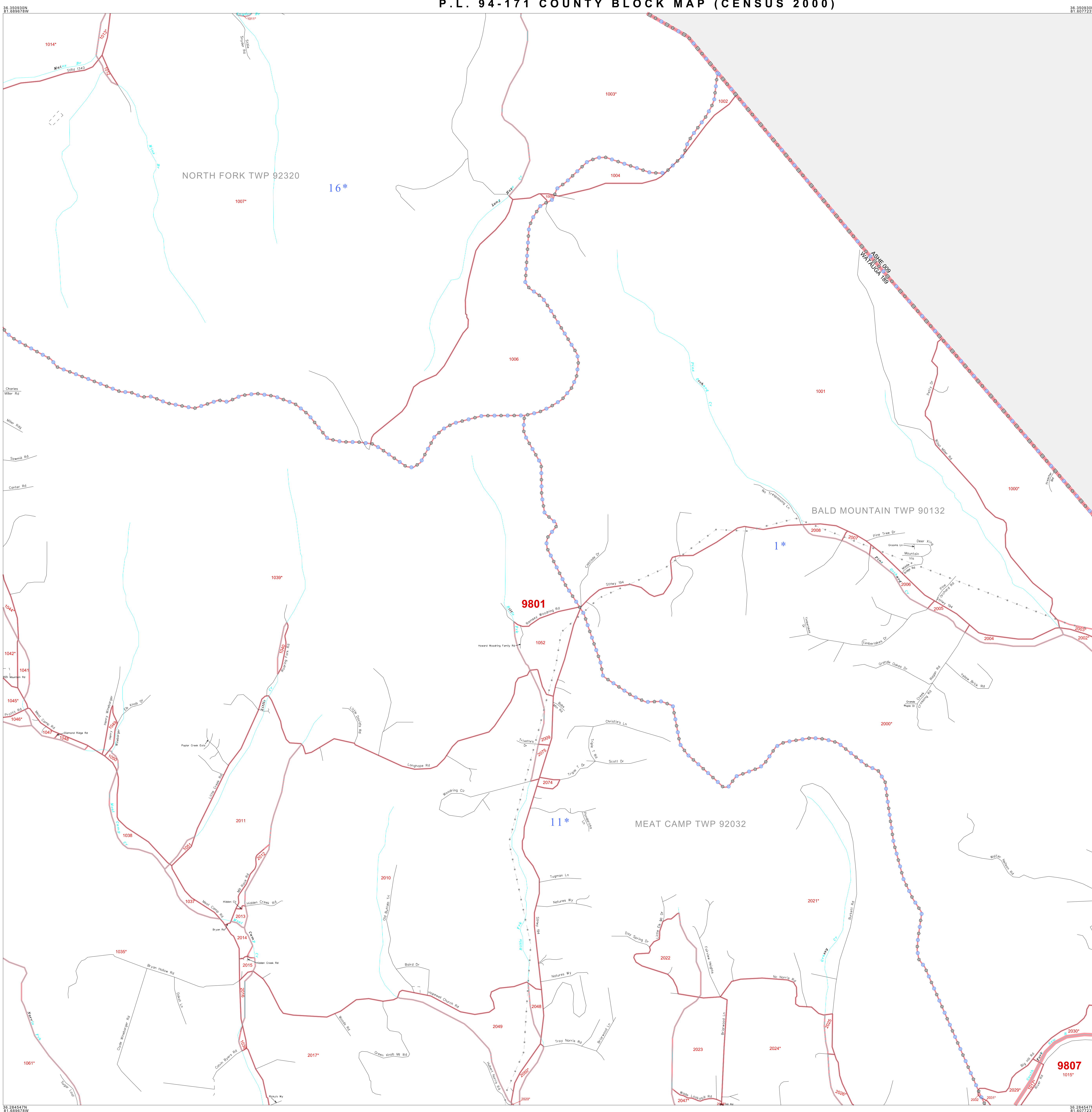

Key to Adjacent Sheets

2	3
6	7 8
11	12 13

ST: North Carolina (37)  
 COU: Watauga (189)  
 SHEET 7 OF 25 PARENT SHEETS

All legal boundaries and names are as of January 1, 2000. The boundaries shown on this map are for Census Bureau statistical data collection and tabulation purposes only; their depiction and designation for statistical purposes does not constitute a determination of jurisdictional authority or rights of ownership or entitlement. U.S. DEPARTMENT OF COMMERCE Economics and Statistics Administration U.S. Census Bureau