

P. L. 94-171 COUNTY BLOCK MAP (CENSUS 2000)

34 744482N  
78 458724W

34 744482N  
78 298103W

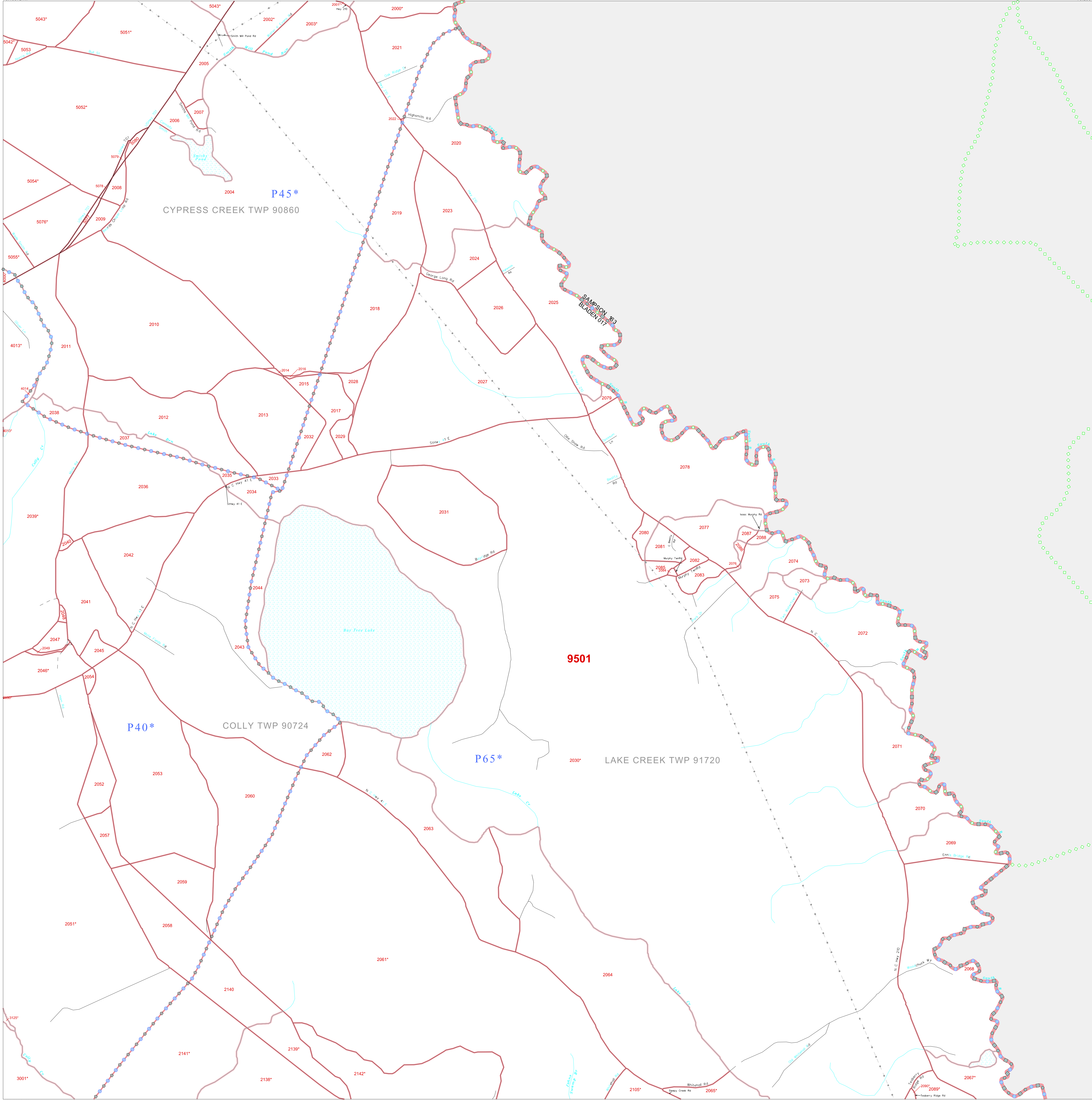

**GEOGRAPHIC AREAS LEGEND**

SYMBOL	NAME STYLE
*****	INTERNATIONAL
*****	AIR (FEDERAL)
*****	SDA/SA
*****	TRIBAL SUBDIVISION
//////	STATE
	COUNTY
	MINOR CIVIL DIV.¹
	Incorporated Place¹
	Census Designated Place¹
-----	Corporate Offset Boundary
.....	Voting District²
-----	Census Tract
-----	BLOCK³
-----	Military
-----	Inset
-----	Out Area

Abbreviation Reference: AIR = American Indian Reservation; SDA/SA = State Designated American Indian Statistical Area; Tribal Subdivision = American Indian Tribal Subdivision

1 A \* \* following a place name indicates that the place is consecutive with a MCD. A \* \* indicates that the place is also a false MCD. In both cases, the MCD name is shown only when it differs from the place name.

2 A \* \* following a VTD code indicates an actual voting district. Its absence indicates that the VTD is a pseudo voting district or no information is available as to its status.

3 A \* \* following a block number indicates that the block number is repeated elsewhere in the block.

34 611676N  
78 458724W

34 611676N  
78 298103W

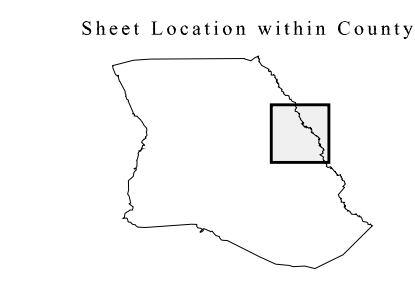
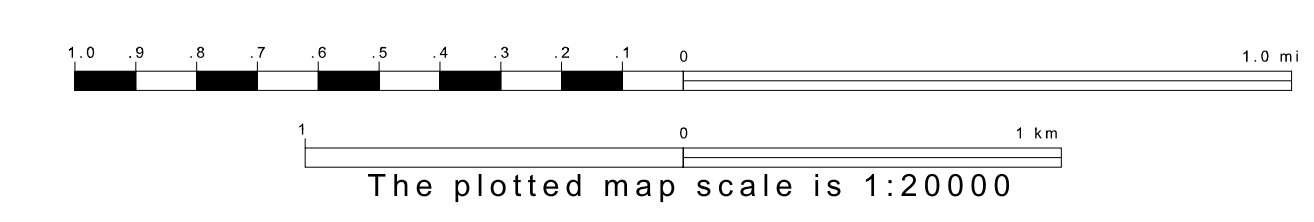

Key to Adjacent Sheets

3	4
7	8
11	12 13

ST: North Carolina (37)  
 COU: Bladen (017)  
 SHEET 8 OF 18 PARENT SHEETS

All legal boundaries and names are as of January 1, 2000. The boundaries shown on this map are for Census Bureau statistical data collection and tabulation purposes only; their depiction and designation for statistical purposes does not constitute a determination of jurisdictional authority or rights of ownership or entitlement. U.S. DEPARTMENT OF COMMERCE Economics and Statistics Administration U.S. Census Bureau

