

P. L. 94-171 COUNTY BLOCK MAP (CENSUS 2000)

35 898260N  
81 825052W

35 898260N  
81 723012W

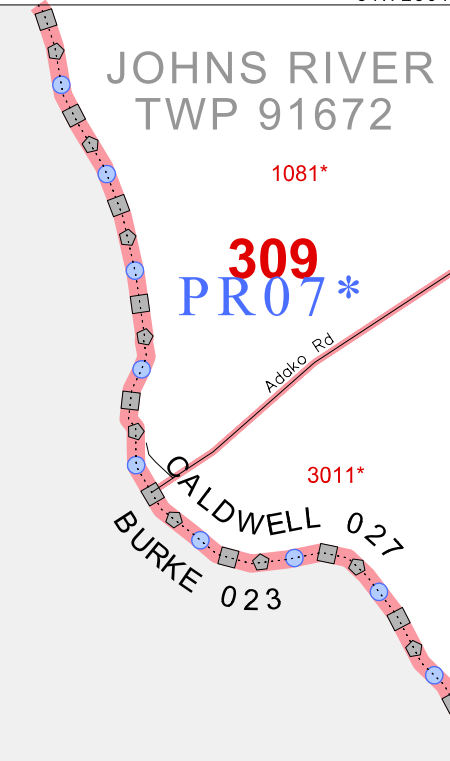

**GEOGRAPHIC AREAS LEGEND**

| SYMBOL | NAME STYLE                           |
|--------|--------------------------------------|
| *****  | INTERNATIONAL                        |
| *****  | AIR (FEDERAL)                        |
| *****  | SDA/SA                               |
| *****  | TRIBAL SUBDIVISION                   |
| #####  | STATE                                |
| #####  | COUNTY                               |
| #####  | MINOR CIVIL DIV. <sup>1</sup>        |
| #####  | Incorporated Place <sup>1</sup>      |
| #####  | Census Designated Place <sup>1</sup> |
| -----  | Corporate Offset Boundary            |
| .....  | Voting District <sup>2</sup>         |
| -----  | Census Tract                         |
| -----  | BLOCK <sup>3</sup>                   |
| -----  | Military <sup>3</sup>                |
| -----  | Inset                                |
| -----  | Out Area                             |

Abbreviation Reference: AIR = American Indian Reservation; SDA/SA = State Designated American Indian Statistical Area; Tribal Subdivision = American Indian Tribal Subdivision

1 A \* \* following a place name indicates that the place is coterminous with a MCD. A \* \* indicates that the place is also a false MCD. In both cases, the MCD name is shown only when it differs from the place name.

2 A \* \* following a VTD code indicates an actual voting district. Its absence indicates that the VTD is a pseudo voting district or no information is available as to its status.

3 A \* \* following a block number indicates that the block number is repeated elsewhere in the block.

35 815228N  
81 825052W

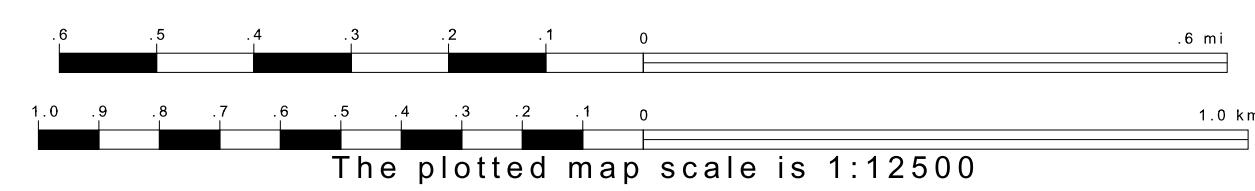
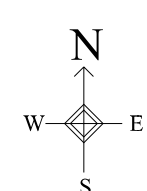

Sheet Location within County

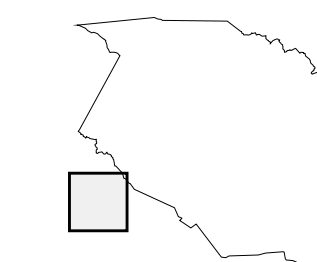

Key to Adjacent Sheets

|    |    |
|----|----|
| 11 | 12 |
| 16 | 17 |

ST: North Carolina (37)  
 COU: Caldwell (027)  
 SHEET 16 OF 23 PARENT SHEETS

