

P.L. 94-171 COUNTY BLOCK MAP (CENSUS 2000)

31 081173N  
82 473540W

31 081173N  
82 262068W

**GEOGRAPHIC AREAS LEGEND**

SYMBOL	NAME STYLE
☆☆☆☆	INTERNATIONAL
////	AIR (State)
////	STATE
■■■■	COUNTY
○○○○	CENSUS COUNTY DIV. Consolidated City
■■■■	Incorporated Place
■■■■	Census Designated Place
.....	Corporate Offset Boundary
●●●●	Voting District
■■■■	Census Tract
■■■■	BLOCK <sup>2</sup>

Mosaic:  Inset  Out Area

Abbreviation Reference: AIR = American Indian Reservation  
 1 A " " following a VTD code indicates an actual voting district. Its absence indicates that the VTD is a pseudo voting district or no information is available as to its status.  
 2 A " " following a block number indicates that the block number is repeated elsewhere in the block.

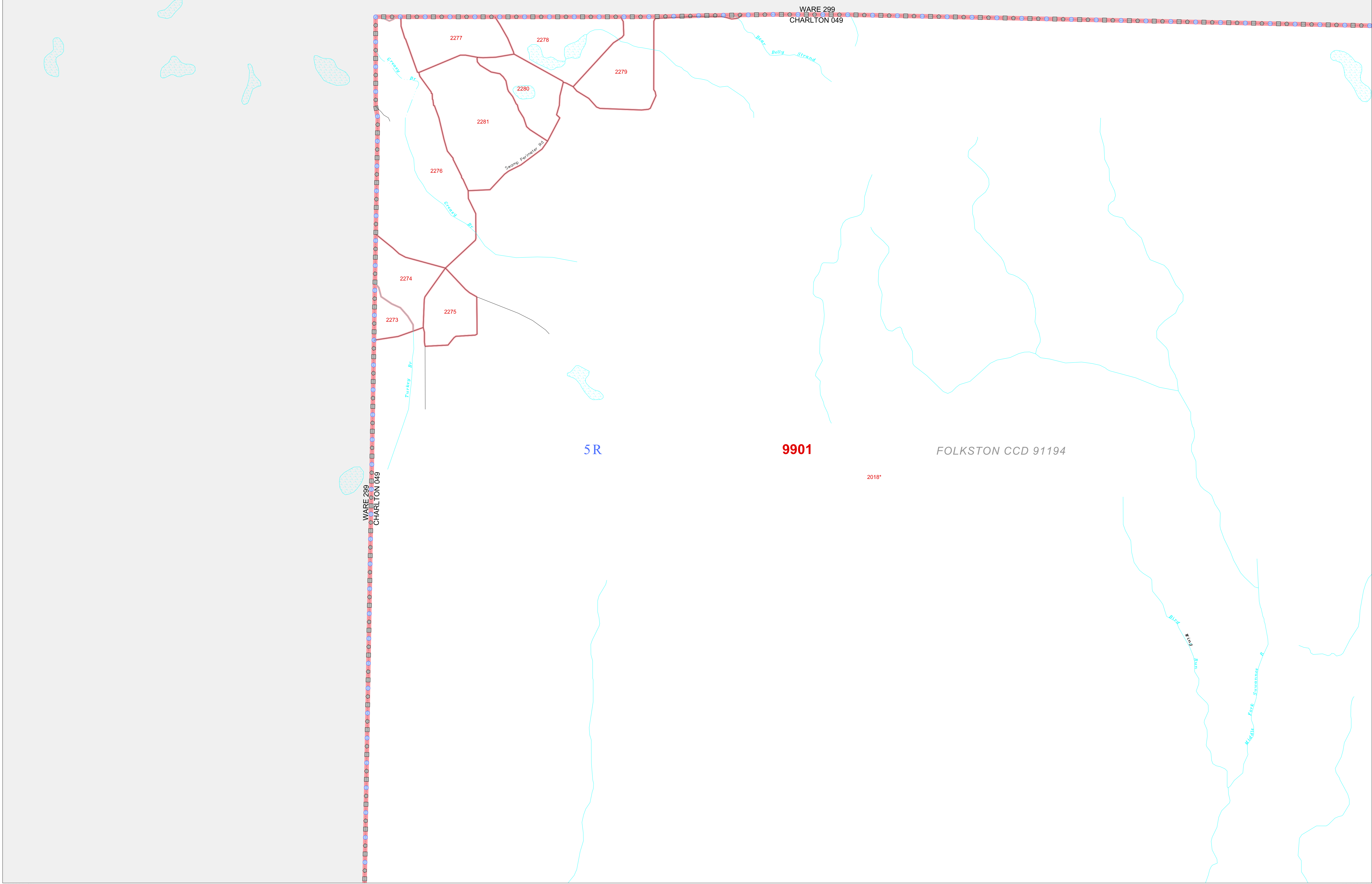

30 898453N  
82 473540W

30 898453N  
82 262068W

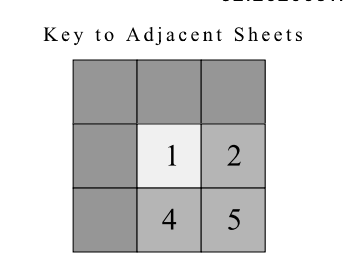
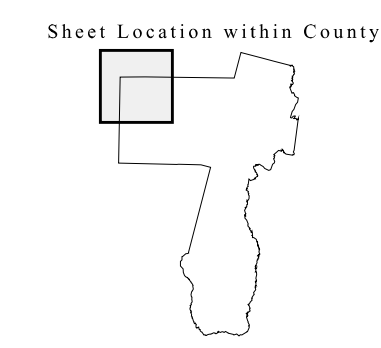
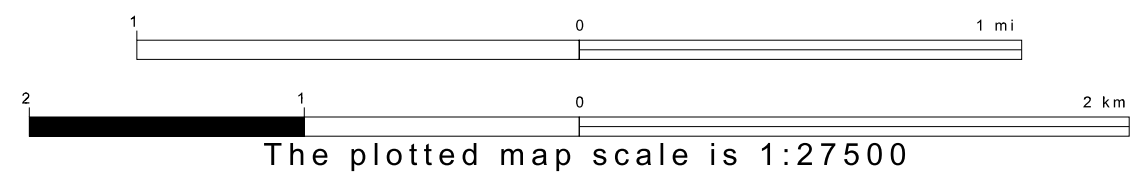
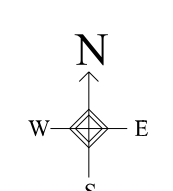

ST: Georgia (13)  
 COU: Charlton (049)  
 SHEET 1 OF 10 PARENT SHEETS



All legal boundaries and names are as of January 1, 2000. The boundaries shown on this map are for Census Bureau statistical data collection and tabulation purposes only; their depiction and designation for statistical purposes does not constitute a determination of jurisdictional authority or rights of ownership or entitlement. U.S. DEPARTMENT OF COMMERCE Economics and Statistics Administration U.S. Census Bureau