

P. L. 94-171 COUNTY BLOCK MAP (CENSUS 2000)

34 555644N
84.737892W

34 555644N
84.681744W

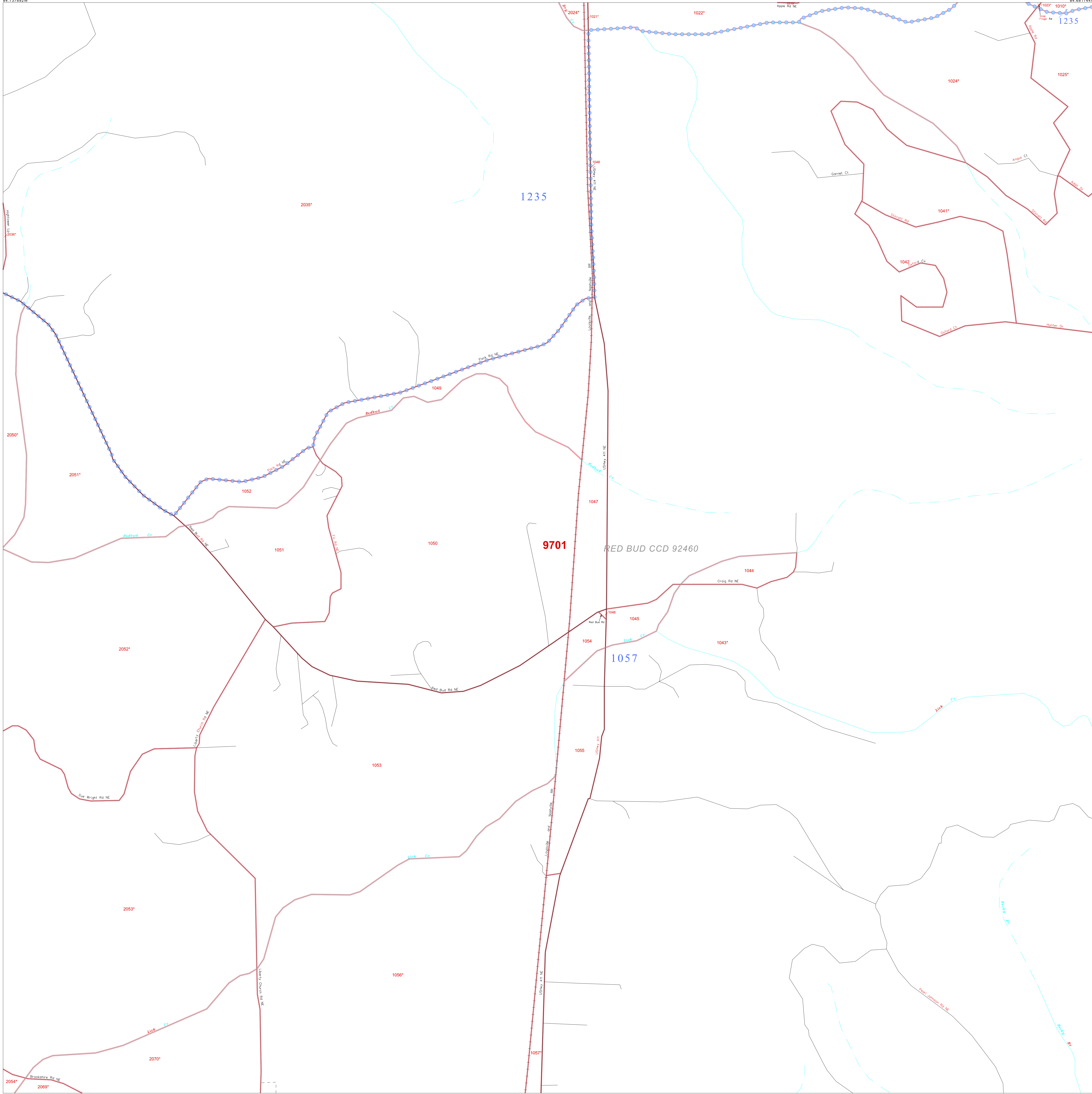

GEOGRAPHIC AREAS LEGEND

SYMBOL	NAME	STYLE
☆☆☆☆☆	INTERNATIONAL	
//////	AIR (State)	
	STATE	
■■■■■	COUNTY	
□□□□□	CENSUS COUNTY DIV.	
○	Consolidated City	
○	Incorporated Place	
○	Census Designated Place	
.....	Corporate Offset Boundary	
.....	Voting District	
---	Census Tract	
---	BLOCK ²	

Abbreviation Reference: AIR = American Indian Reservation
 1 A " " following a VTD code indicates an actual voting district. Its absence indicates that the VTD is a pseudo voting district or no information is available as to its status.
 2 A " " following a block number indicates that the block number is repeated elsewhere in the block.

34 555162N
84.737892W

34 555162N
84.681744W

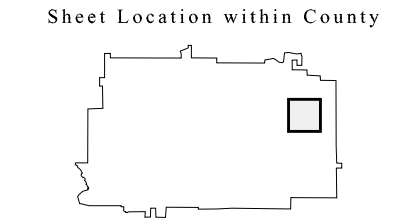
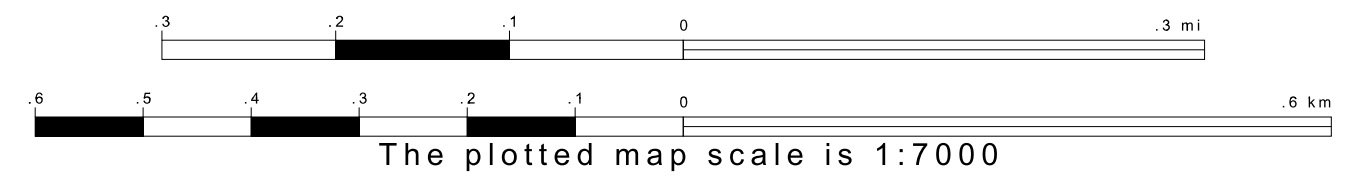

Key to Adjacent Sheets

13	14	15
22	23	24
31	32	33

ST: Georgia (13)
 COU: Gordon (129)
 SHEET 23 OF 51 PARENT SHEETS

All legal boundaries and names are as of January 1, 2000. The boundaries shown on this map are for Census Bureau statistical data collection and tabulation purposes only; their depiction and designation for statistical purposes does not constitute a determination of jurisdictional authority or rights of ownership or entitlement. U.S. DEPARTMENT OF COMMERCE Economics and Statistics Administration U.S. Census Bureau

