

P. L. 94-171 COUNTY BLOCK MAP (CENSUS 2000)

31 540634N
84 497619W

31 540634N
84 284929W

GEOGRAPHIC AREAS LEGEND

SYMBOL	NAME STYLE
☆☆☆☆☆	INTERNATIONAL
///////	AIR (State)
#####	STATE
■■■■■	COUNTY
○○○○○	CENSUS COUNTY DIV. Consolidated City
■■■■■	Incorporated Place
■■■■■	Census Designated Place
.....	Corporate Offset Boundary
.....	Voting District
■■■■■	Census Tract
■■■■■	BLOCK ²

Mosaic: Inset Out Area

Abbreviation Reference: AIR = American Indian Reservation
 1 A * following a VTD code indicates an actual voting district. Its absence indicates that the VTD is a pseudo voting district or no information is available as to its status.
 2 A * * following a block number indicates that the block number is repeated elsewhere in the block.

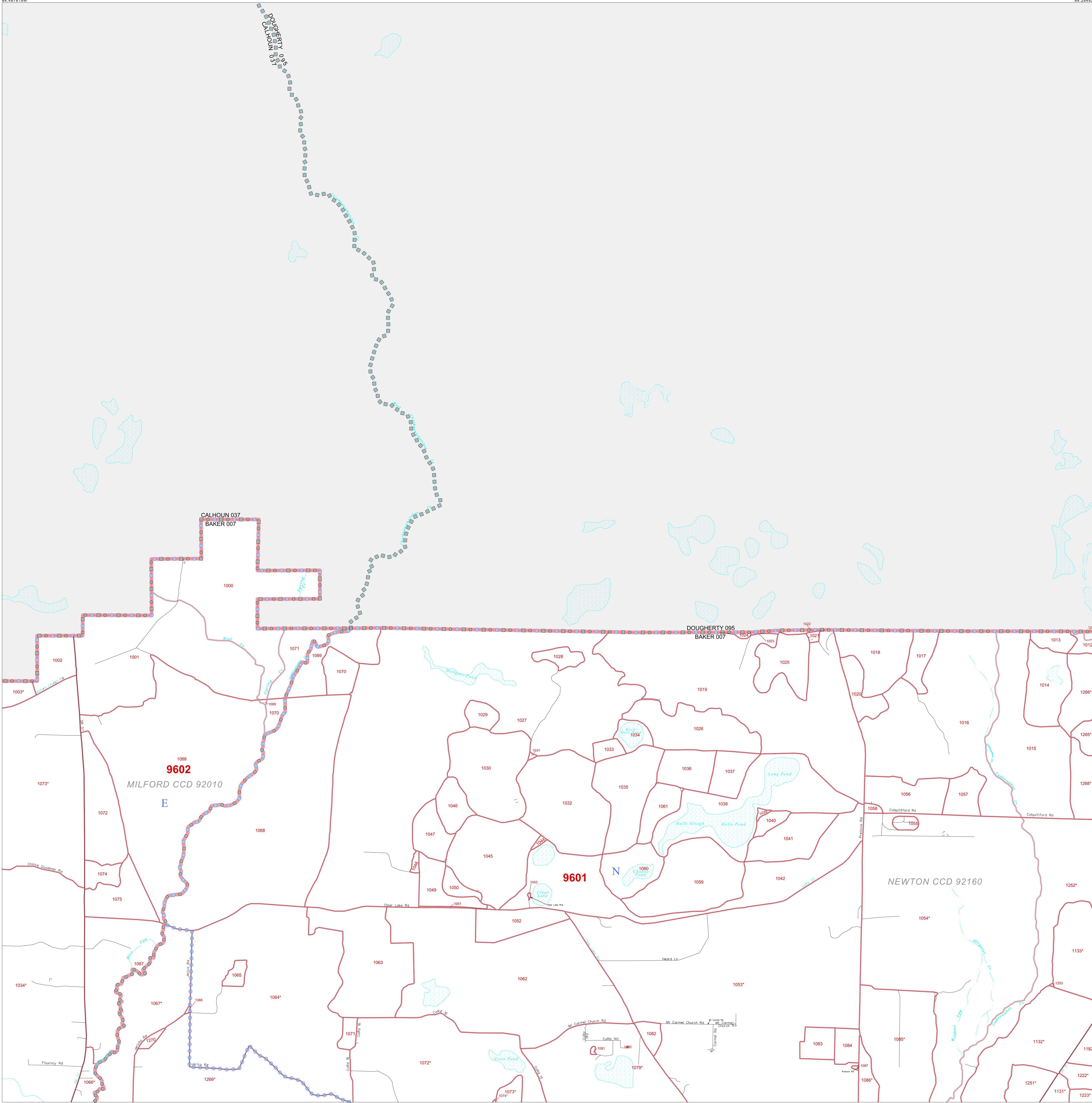

31 357929N
84 497619W

31 357929N
84 284929W

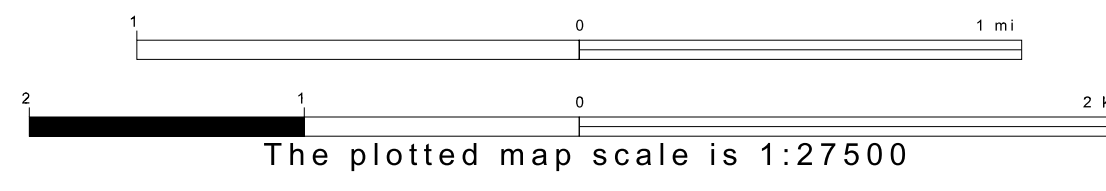

Sheet Location within County

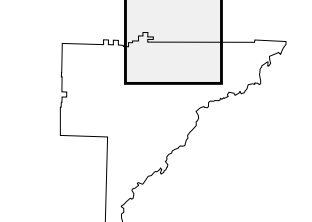

Key to Adjacent Sheets

1	2	3
4	5	6

ST: Georgia (13)
 COU: Baker (007)
 SHEET 2 OF 8 PARENT SHEETS

All legal boundaries and names are as of January 1, 2000. The boundaries shown on this map are for Census Bureau statistical data collection and tabulation purposes only; their depiction and designation for statistical purposes does not constitute a determination of jurisdictional authority or rights of ownership or entitlement. U.S. DEPARTMENT OF COMMERCE Economics and Statistics Administration U.S. Census Bureau

