

CENSUS TRACT OUTLINE MAP (CENSUS 2000)

ABBREVIATED LEGEND

SYMBOL	NAME STYLE
☆☆☆☆☆	INTERNATIONAL
☆☆☆☆☆	AIR (FEDERAL)
☆☆☆☆☆	Trust Land
◇◇◇◇◇	OTSA / TDSA
◇◇◇◇◇	TRIBAL SUBDIVISION
///////	AIR (State)
◇◇◇◇◇	SDA/SA
#####	STATE
#####	COUNTY
○○○○○	CENSUS COUNTY DIV.
○○○○○	Consolidated City
■■■■■	Incorporated Place
■■■■■	Census Designated Place
■■■■■	Census Tract

Abbreviation Reference: AIR = American Indian Reservation; Trust Land = Off-Reservation Trust Land; OTSA = Oklahoma Tribal Statistical Area; TDSA = Tribal Designated Statistical Area; Tribal Subdivision = American Indian Tribal Subdivision; SDA/SA = State Designated American Indian Statistical Area

FEATURES	FEATURES
All Roads	Stream/Shoreline
Spur Road	Intermittent Stream
Play/Paver Line	River/Lake
Physical Feature	Glacier
Navigable Boundary	
Military	

Inset Out Area

OFF-RESERVATION TRUST LAND NAMES
T1235 Fort Mojave

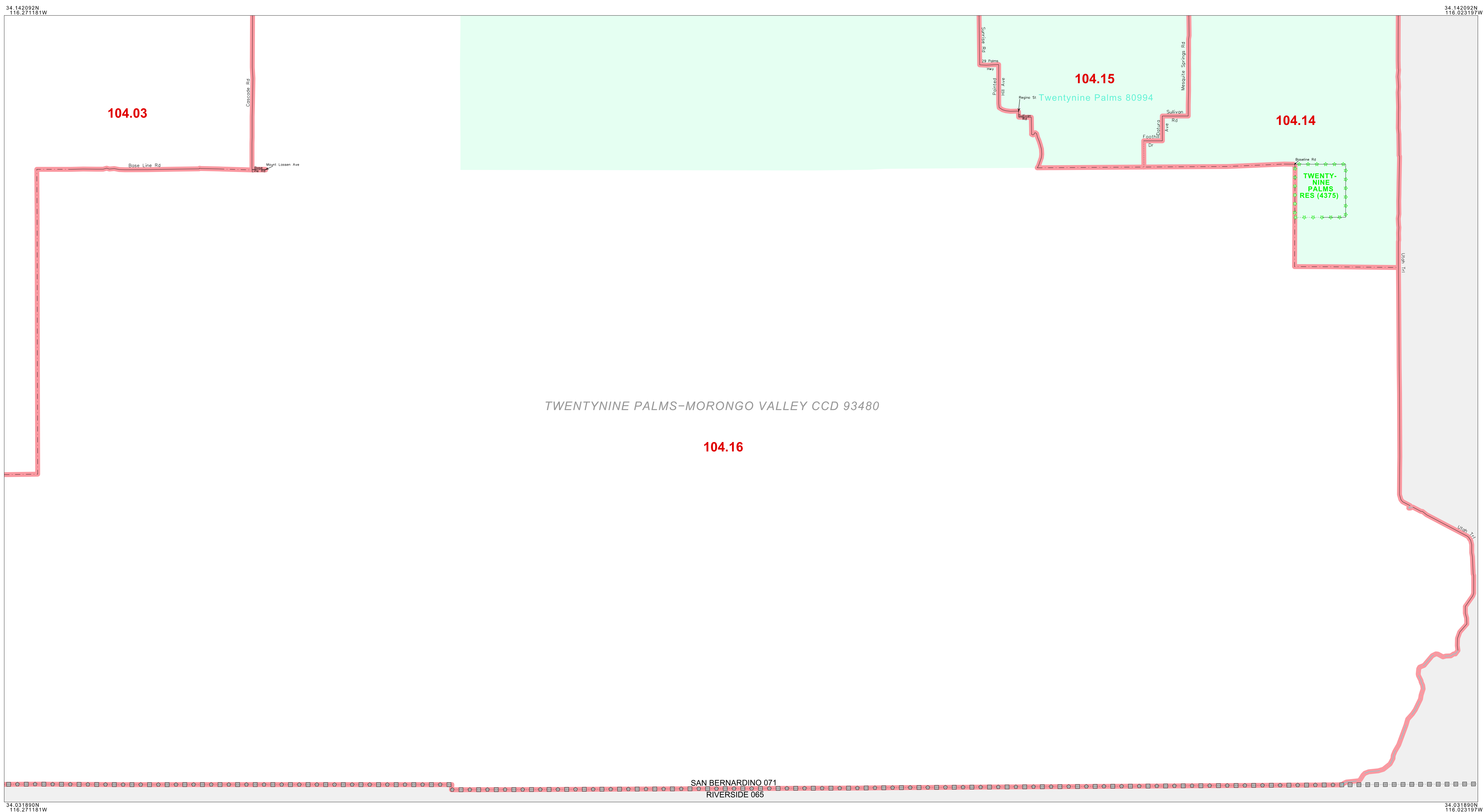

34 031892N 116 023197W

34 142022N 116 21118W

34 031892N 116 023197W

34 142022N 116 21118W

SAN BERNARDINO 071
RIVERSIDE 065

Key to Adjacent Sheets

F04

Sheet Location within County

The plotted map scale is 1:31680

ST: California (06)
COU: San Bernardino (071)
INSET SHEET F04

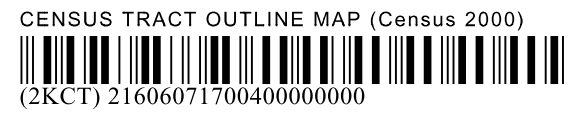

All legal boundaries and names are as of January 1, 2000. The boundaries shown on this map are for Census Bureau statistical data collection and tabulation purposes only; their depiction and designation for statistical purposes does not constitute a determination of jurisdictional authority or rights of ownership or entitlement. U.S. DEPARTMENT OF COMMERCE Economics and Statistics Administration U.S. Census Bureau