

CENSUS TRACT OUTLINE MAP (CENSUS 2000)

**ABBREVIATED LEGEND**

SYMBOL	NAME STYLE
☆☆☆☆	INTERNATIONAL
☆☆☆☆	AIR (FEDERAL)
☆☆☆☆	Trust Land
◇◇◇◇	OTSA / TDSA
◇◇◇◇	TRIBAL SUBDIVISION
//////	AIR (State)
◇◇◇◇	SDA/SA
#####	STATE
#####	COUNTY
○○○○○	CENSUS COUNTY DIV.
○○○○○	Consolidated City
■■■■■	Incorporated Place
■■■■■	Census Designated Place
■■■■■	Census Tract

Abbreviation Reference: AIR = American Indian Reservation; Trust Land = Off-Reservation Trust Land; OTSA = Oklahoma Tribal Statistical Area; TDSA = Tribal Designated Statistical Area; Tribal Subdivision = American Indian Tribal Subdivision; SDA/SA = State Designated American Indian Statistical Area

FEATURES	FEATURES
All Roads	Stream/Shareline
Spur Road	Intermittent Stream
Flow/Power Line	River/Lake
Physical Feature	Claypan
Navigable Boundary	

Inset Out Area

OFF-RESERVATION TRUST LAND NAMES  
T1235 Fort Mojave

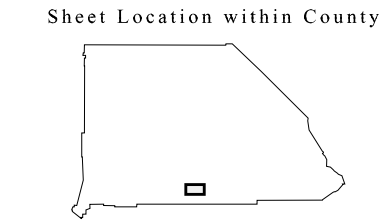
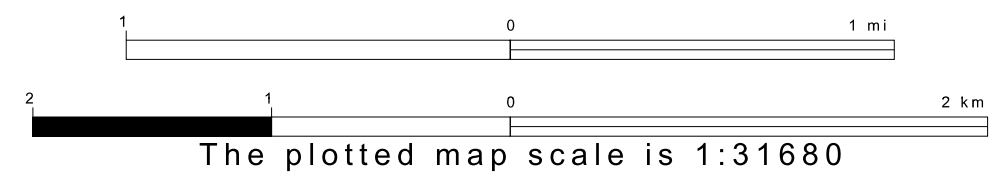
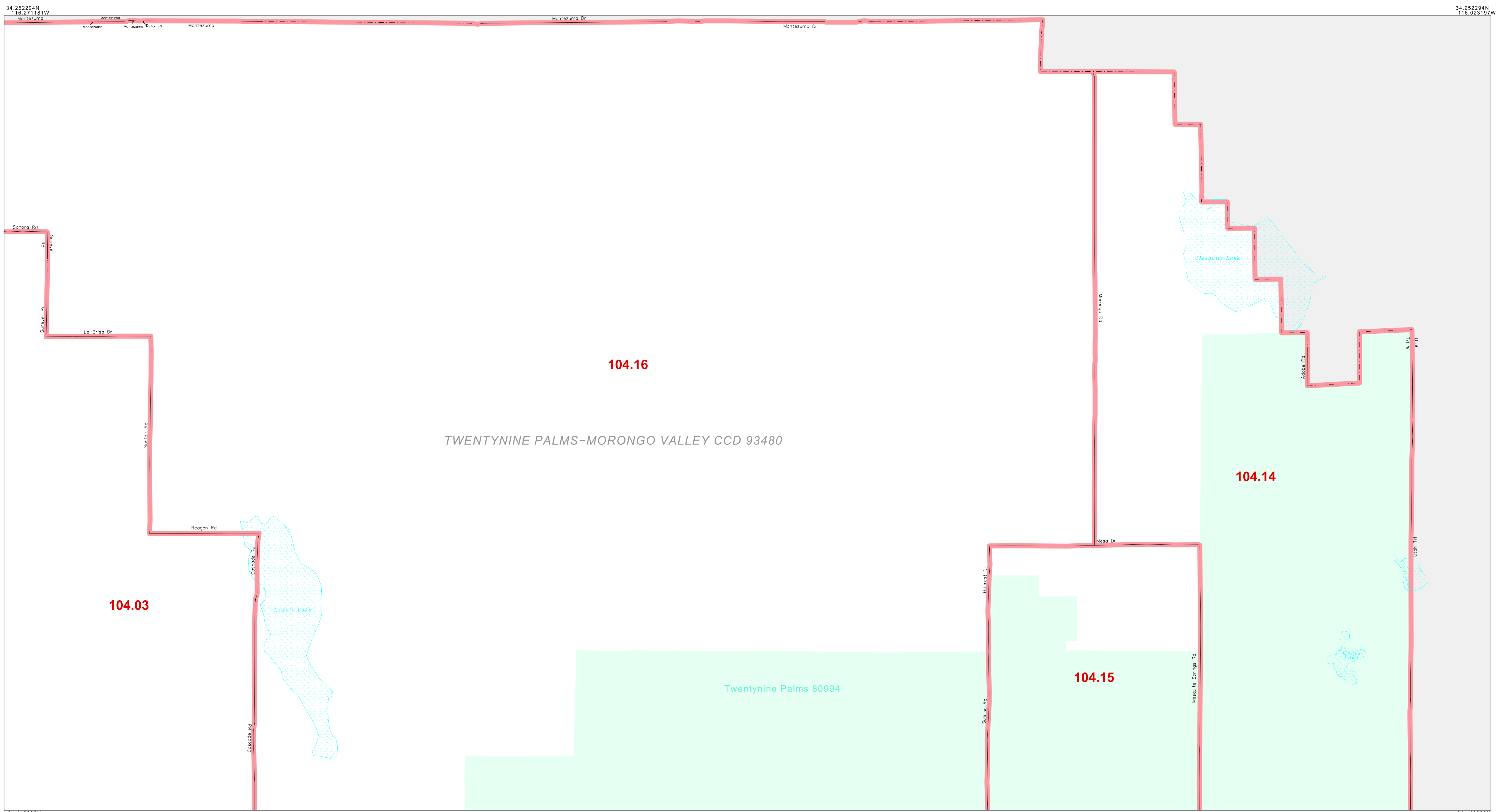

ST: California (06)  
COU: San Bernardino (071)  
INSET SHEET F02

All legal boundaries and names are as of January 1, 2000. The boundaries shown on this map are for Census Bureau statistical data collection and tabulation purposes only; their depiction and designation for statistical purposes does not constitute a determination of jurisdictional authority or rights of ownership or entitlement. U.S. DEPARTMENT OF COMMERCE Economics and Statistics Administration U.S. Census Bureau

