

**2006 Pennsylvania State Mine Rescue Contest**  
**August 23, 2006**

**STATEMENT**

I am \_\_\_\_\_, Superintendent of the King Coal Festival Mine. You are located on the surface of the 1 Main entries. The mine only has one small block of coal left on the right side of 1 Main which will finish the reserves for this mine. The last reserve of coal is adjacent to the old China Maze Mine which was abandoned in 1950.

A four man maintenance crew entered the 1 Main entries at 12:01 a.m. to clean up, perform general maintenance work and continue production. Midway through the shift a call was received from the 1 Main entries indicating there was excessive water coming out of the face and then communication was suddenly lost. All subsequent attempts to contact the section crew have been unsuccessful. The mine is ventilated by the main exhaust fan which cannot be reversed and must remain on to ventilate the mine.

The Carmichaels Rescue Team has explored as much of the mine after entering from the West Mains but was unable to complete the 1 Main entries due to unsafe roof conditions, water and time limitations. A fresh air base has been established here on the surface of 1 Main entries. Rescue teams are available to build and/or remove ventilation structures in areas that have been explored by the Carmichaels Rescue Team. Overcasts cannot be built or removed by the outby teams. You may request assistance from them through the Superintendent. The team will mark the changes on the maps, initial the map, and present the map to the Superintendent who will notify them when the changes are completed. Carmichaels Rescue Team will serve as backup while you are working. Maps of the areas explored were prepared by the Carmichaels Rescue Team.

All electrical circuits inby the fresh air base have been de-energized. Power is available to be used if necessary. The coal seam is walking height and the roof is supported by roof bolts. Water and explosive gases have been encountered at this mine. We have been encountering an excessive amount of water in the 1 Main entries and three pumps have been used to keep the airways open. The pumps in these entries are wired in series and all pumps need to remain in the circuit to operate if needed. The pump will operate properly as long as it is located within five feet of the water needed to pump and the excess water will be discharged outside of the mine. The mine maps are up-to date in all areas except for the projections. We have a competent lifeline person to give and return signals.

Written instructions and the following mine maps will be provided when you are ready to work:

1. Two blank maps
2. Two maps indicating the ventilation prior to incident
3. Two maps indicating the ventilation after the incident and the areas explored by the Carmichaels Rescue Team
4. Two blank maps to request ventilation changes

Good Luck.

2006 Pennsylvania State Mine Rescue Contest  
August 23, 2006

## **PROBLEM**

**Account for all missing persons.**

**Explore all areas of the mine that  
can be safely examined.**

2006 Pennsylvania State Mine Rescue Contest

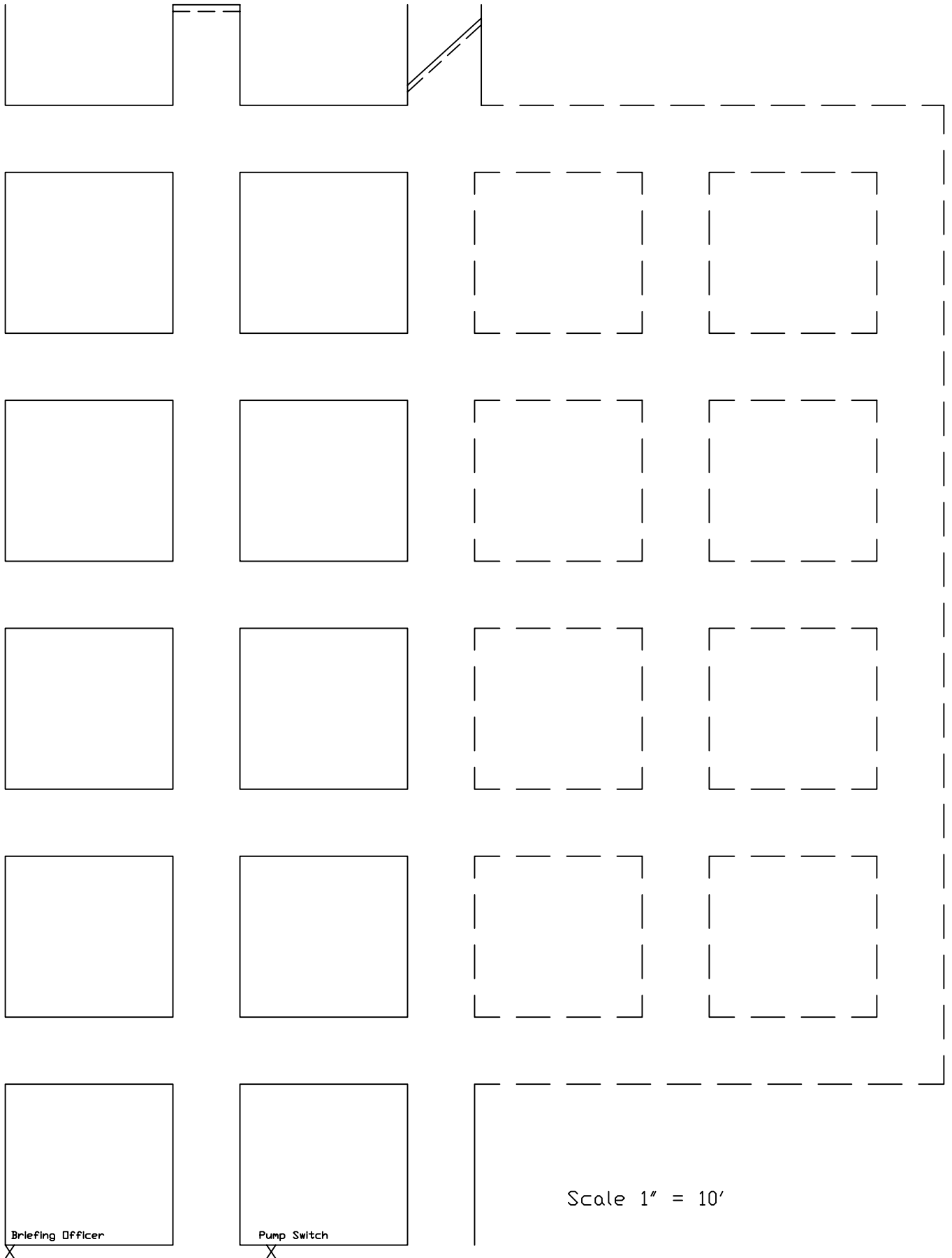

Briefing Officer

Pump Switch

Scale 1" = 10'



TO SURFACE  
EXHAUST FAN

VENTILATION PRIOR  
TO INCIDENT

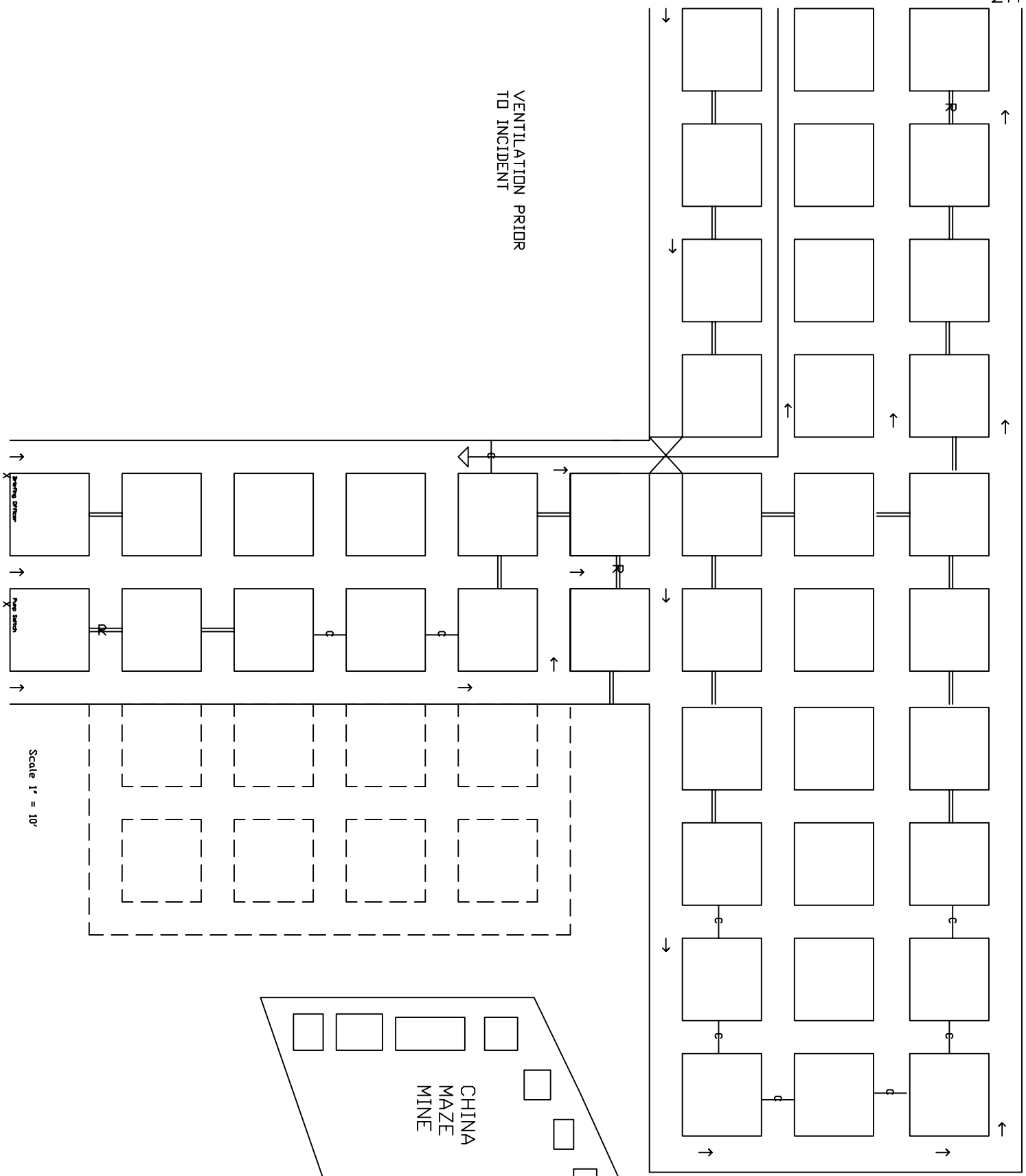

Return Airway  
X

Two Series  
X

Scale 1" = 10'

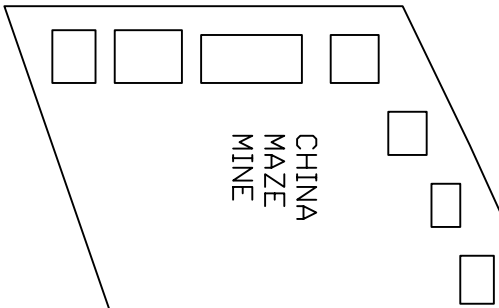

CHINA  
MAZE  
MINE

TO SURFACE  
EXHAUST FAN

VENTILATION AFTER INCIDENT  
AND AREA EXPLORED

AREA  
UNEXPLORED

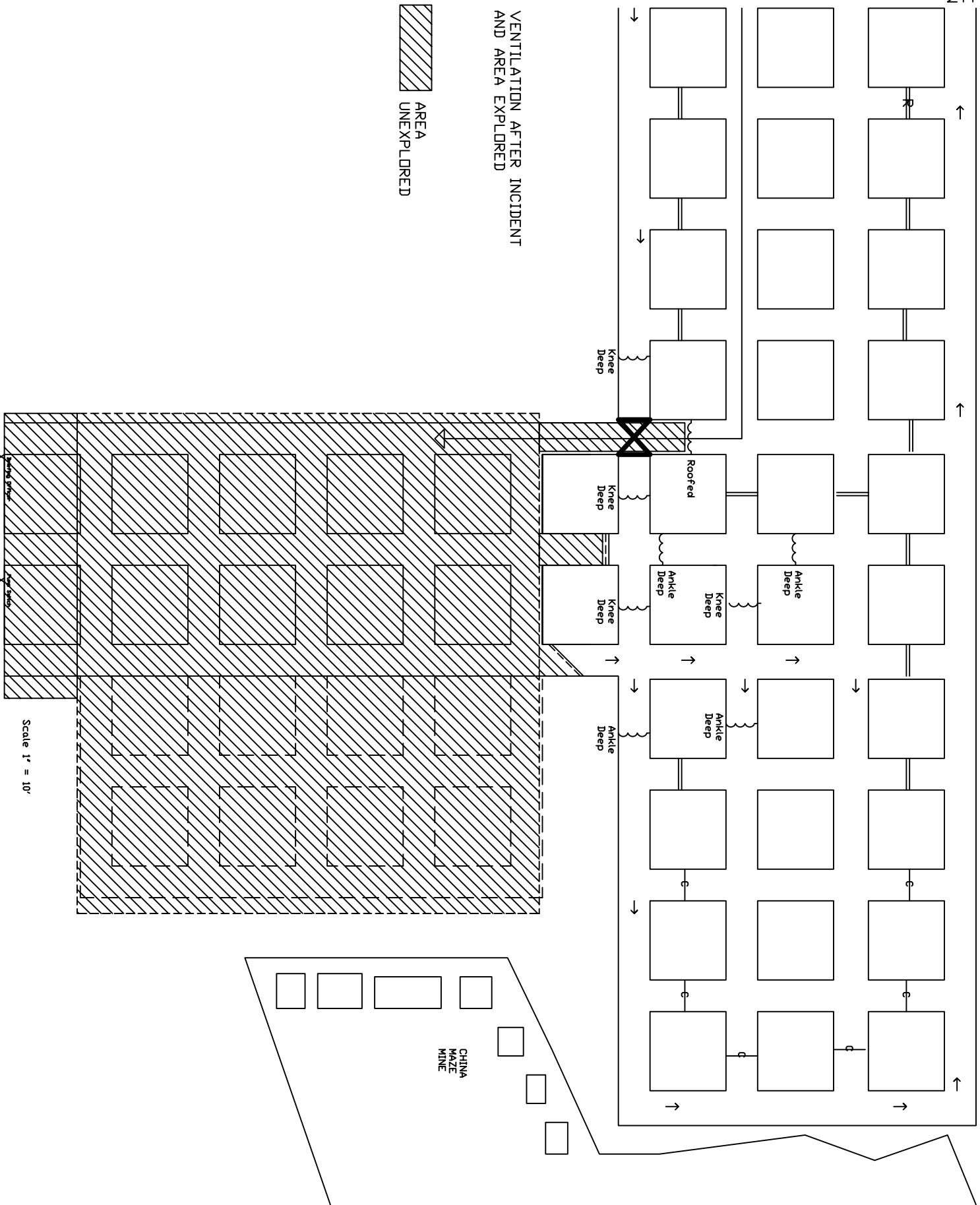

Scale 1" = 10'

CHINA  
MAZE  
MINE







# 2006 Pennsylvania State Mine Rescue Contest

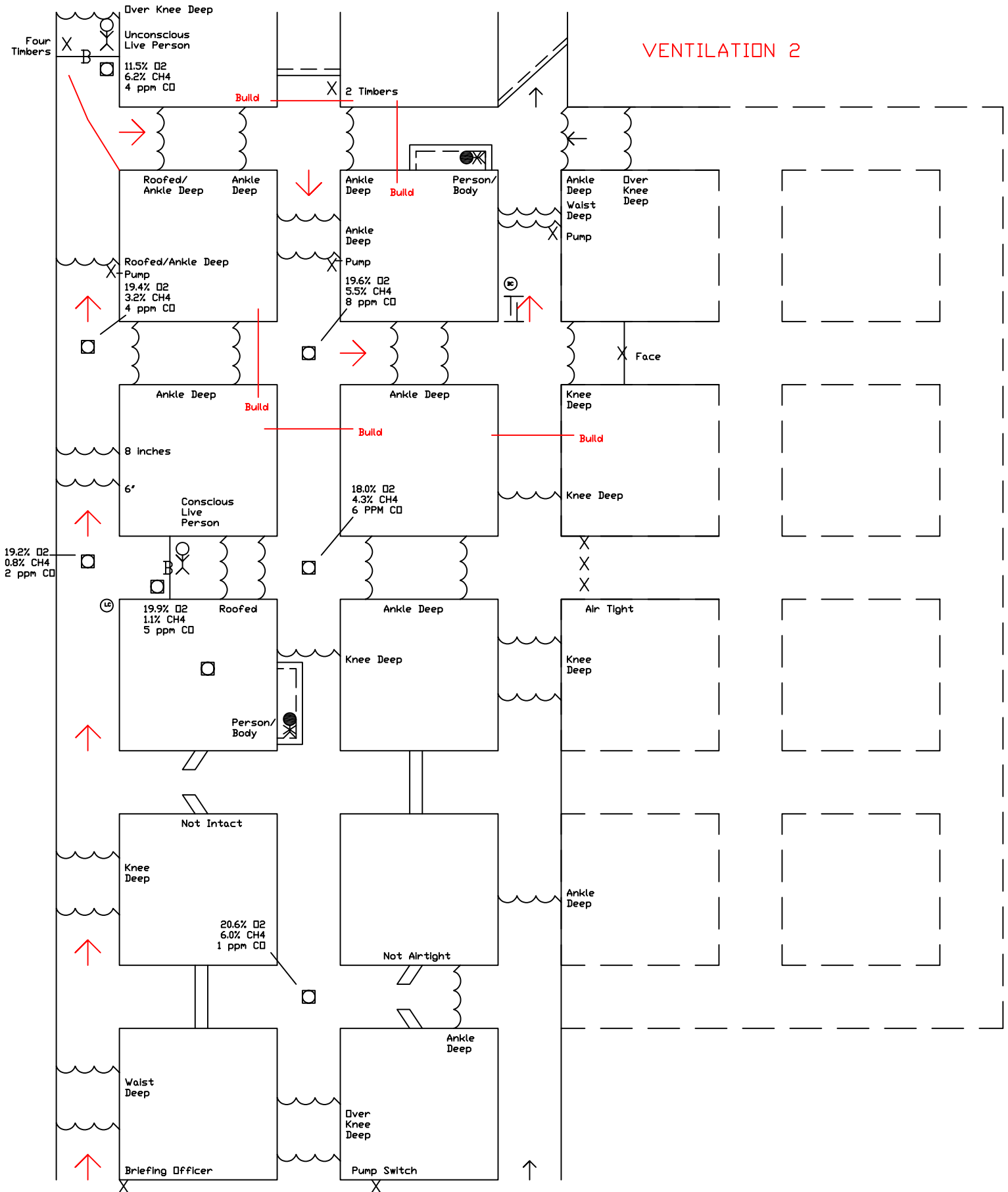

**Patient Statement**

**HELP!**

**IT IS AIRTIGHT ALL AROUND  
ME.**

**GET ME OUT!**