

Existing Verterans Drive

Proposed Veterans Drive / Lover's Lane

Lover's Lane



Long Bay Road

Former Ramada Heaven
November 27, 2004

Cruise Ship Dock

Havensight Mall

General Site Area Photograph

(Photograph Taken 11-27-04)



Long Bay Road

Centerline Road

To Frenchman's Bay Road

Proposed Centerline Road Extension

Havensight Mall

Cruise Ship Dock

Former Ramada Heaven
November 27, 2004

General Site Area Photograph

(Photograph Taken 11-27-04)

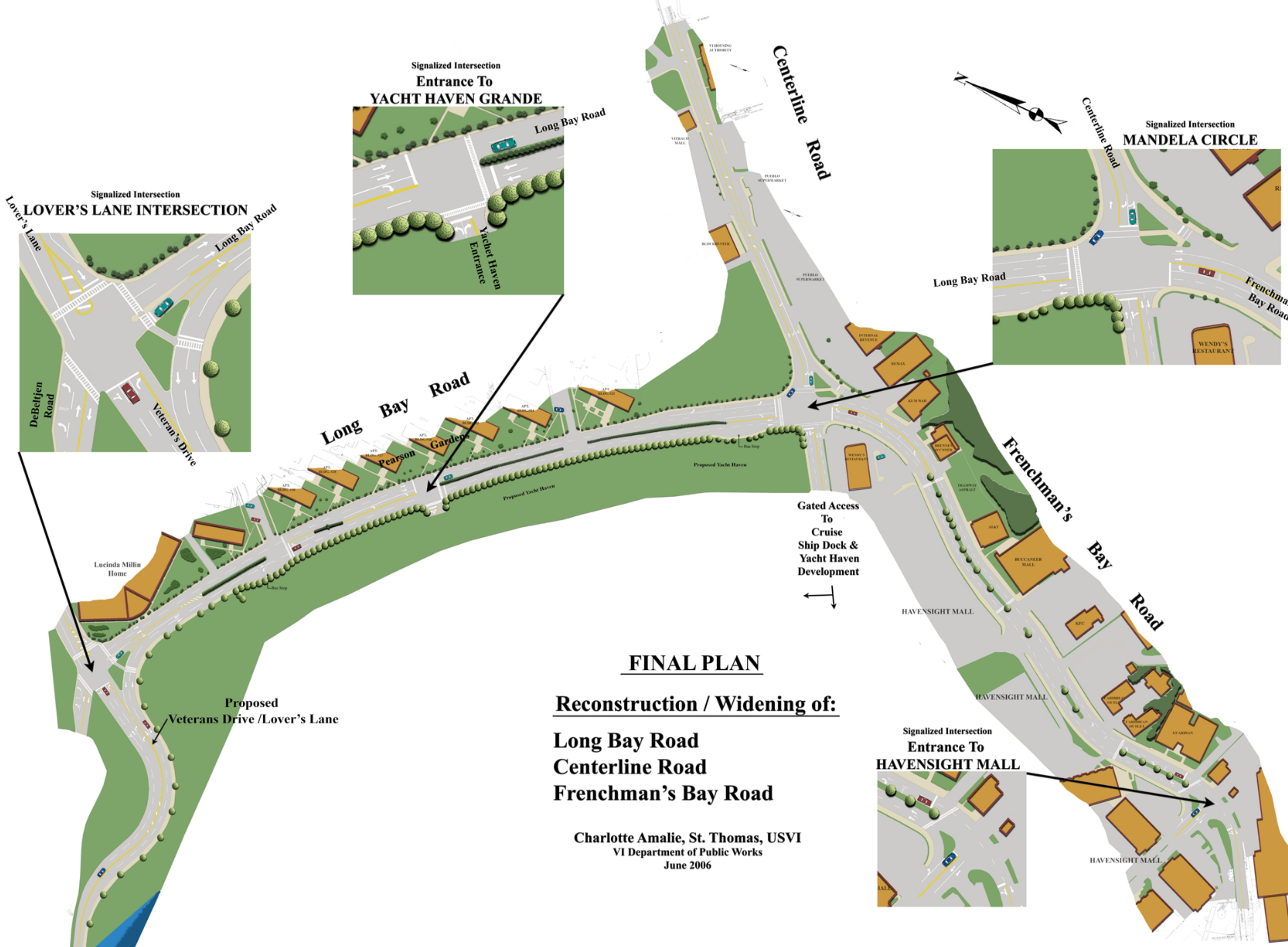

Signalized Intersection
Entrance To
YACHT HAVEN GRANDE

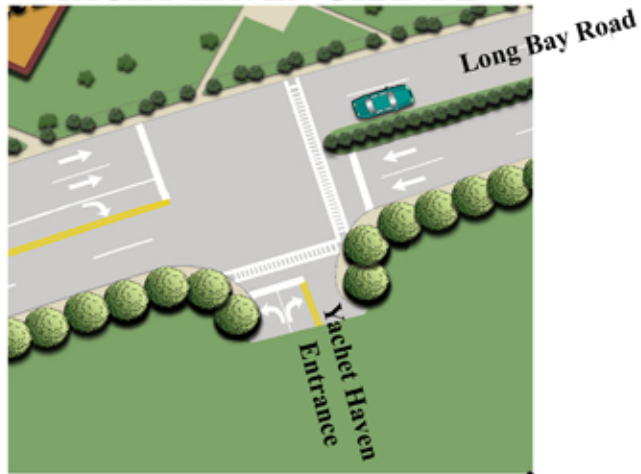

Signalized Intersection
MANDELA CIRCLE



Signalized Intersection
LOVER'S LANE INTERSECTION

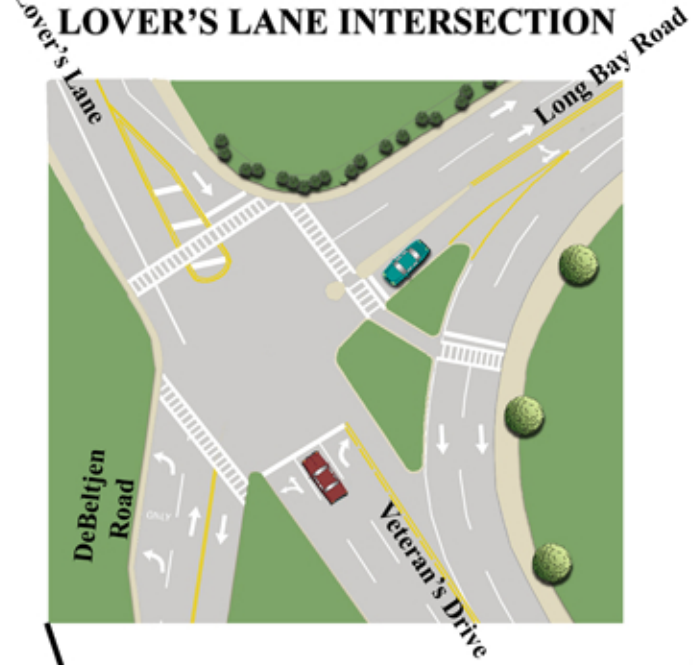

FINAL PLAN

Reconstruction / Widening of:

- Long Bay Road**
- Centerline Road**
- Frenchman's Bay Road**

Charlotte Amalie, St. Thomas, USVI
VI Department of Public Works
June 2006

Gated Access
To
Cruise
Ship Dock &
Yacht Haven
Development

Proposed
Veterans Drive /Lover's Lane



Centerline Road @ Long Bay Road - Phase III
Roadway Reconstruction Typical
(View North)



Long Bay Road - Phase III
Roadway Reconstruction Typical
(View East)



Frenchman Bay Road - Phase III
Roadway Reconstruction Typical
(View South)



LEGEND

-  PHASE III WORK
-  Vehicular Traffic Flow

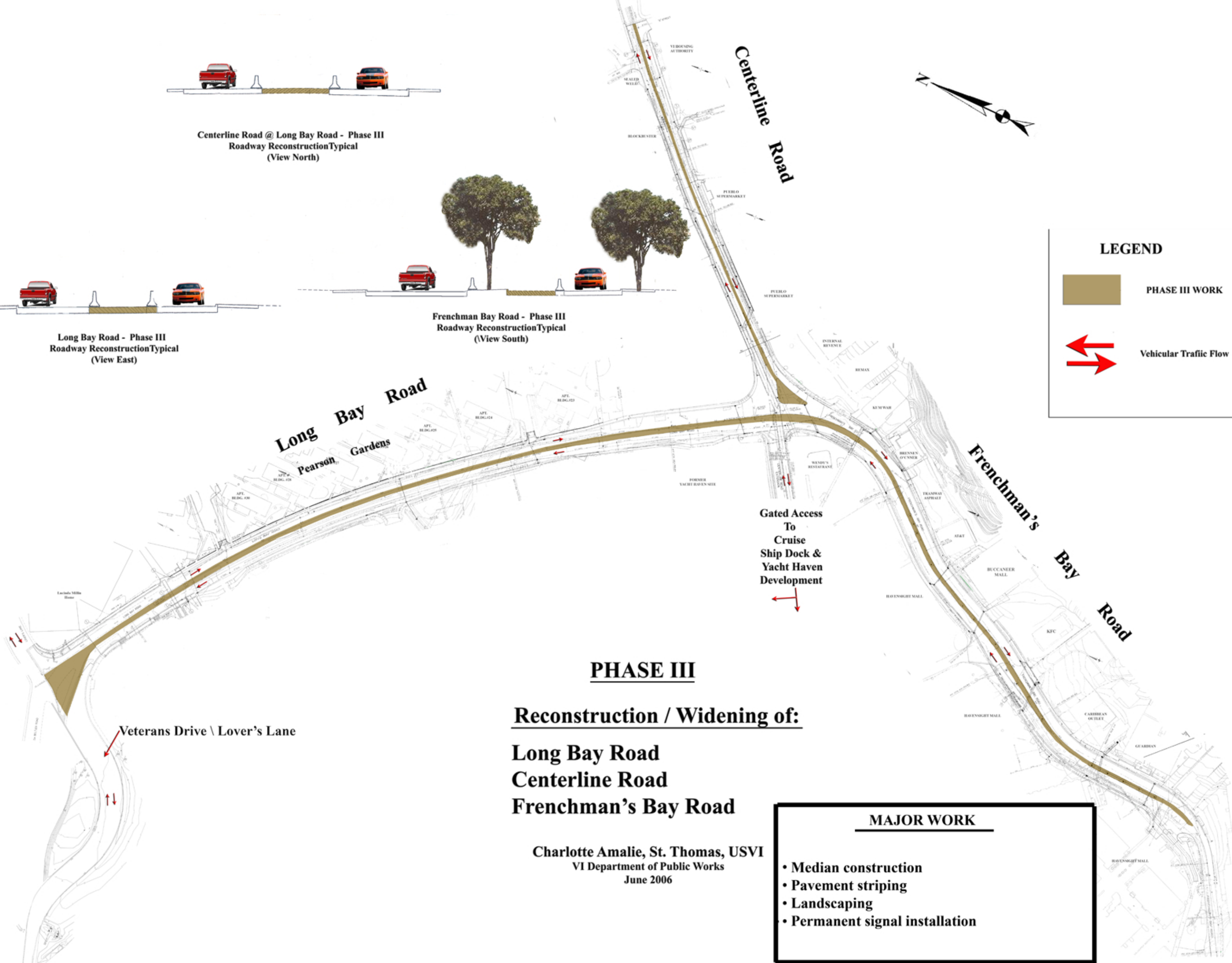

PHASE III

Reconstruction / Widening of:

- Long Bay Road**
- Centerline Road**
- Frenchman's Bay Road**

Charlotte Amalie, St. Thomas, USVI
VI Department of Public Works
June 2006

MAJOR WORK

- Median construction
- Pavement striping
- Landscaping
- Permanent signal installation

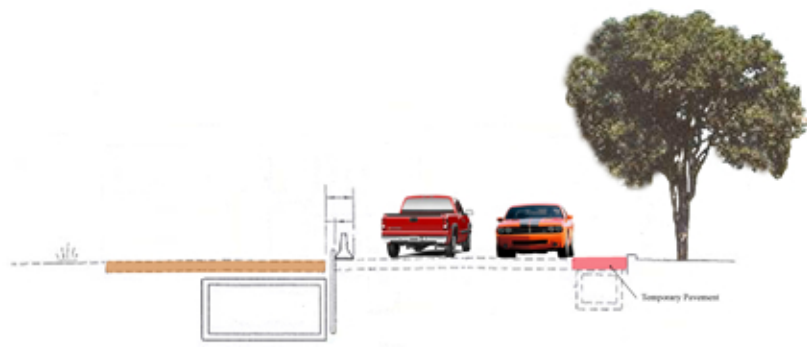

Centerline Road @ Long Bay Road - Phase I Roadway Reconstruction Typical (View North)



Frenchman's Bay Road - Phase I Roadway Reconstruction Typical (View South)

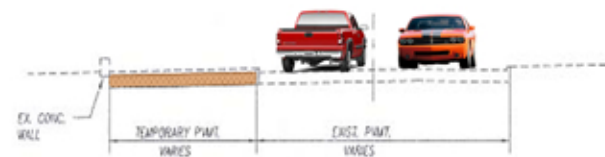





Long Bay Road - Phase I Roadway Reconstruction Typical (View East)

STAGE 1

Centerline Road



LEGEND

-  PHASE I STAGE 1 WORK
-  PHASE I STAGE 2 WORK *
-  Temporary Pavement
-  Vehicular Traffic Flow

* Work on Stage 2 to occur after "Peak Season"

Long Bay Road
Pearson Gardens

Gated Access To Cruise Ship Dock & Yacht Haven Development

Frenchman's Bay Road

PHASE I

**Reconstruction / Widening of:
Long Bay Road
Centerline Road
Frenchman's Bay Road**

Charlotte Amalie, St. Thomas, USVI
VI Department of Public Works
June 2006

Proposed Veterans Drive \ Lover's Lane

Note:
Proposed Veterans Drive \ Lover's Lane will be constructed during Phases I. Existing Veterans Drive \ Lovers' Lane will remain open until Proposed Veterans Drive \ Lover's Lane work is complete and traffic has been diverted to Proposed Veterans Drive \ Lover's Lane.

Existing Veterans Drive

MAJOR WORK

- Utility relocation
- Temporary traffic signal installation
- Box culvert construction along Centerline Road
- Pavement widening and drainage along Long Bay Road / Frenchman's Bay Road
- Sidewalk construction along Centerline Road
- Remove Scotia Bank Building



LEGEND

 Existing Pavement

 Vehicular Traffic Flow

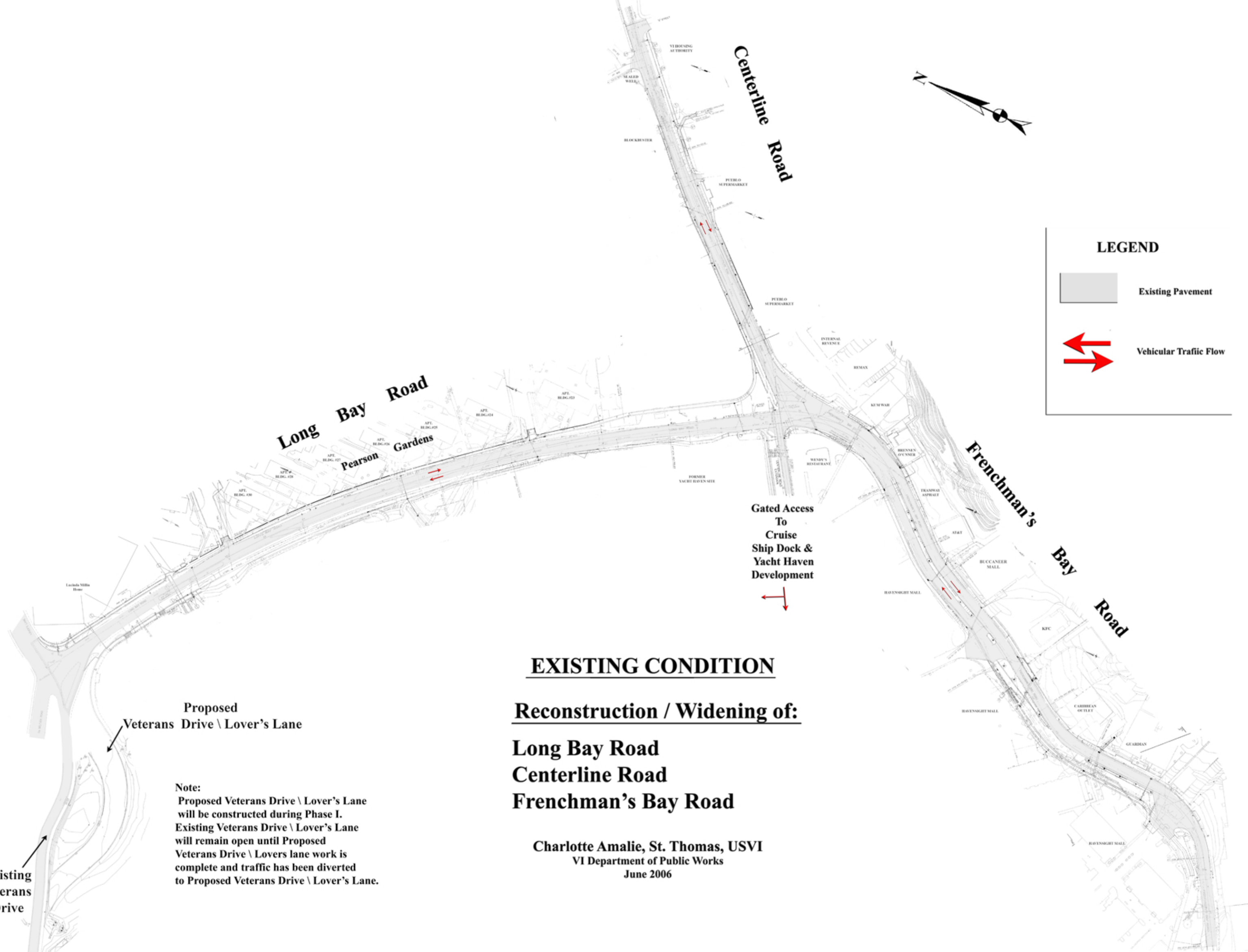

EXISTING CONDITION

Reconstruction / Widening of:

**Long Bay Road
Centerline Road
Frenchman's Bay Road**

Charlotte Amalie, St. Thomas, USVI
VI Department of Public Works
June 2006

Proposed Veterans Drive \ Lover's Lane

Note:
Proposed Veterans Drive \ Lover's Lane will be constructed during Phase I. Existing Veterans Drive \ Lover's Lane will remain open until Proposed Veterans Drive \ Lovers lane work is complete and traffic has been diverted to Proposed Veterans Drive \ Lover's Lane.

Existing Veterans Drive