

GEOGRAPHIC AREAS LEGEND

SYMBOL	NAME STYLE
*****	INTERNATIONAL
*****	AIR (FEDERAL)
◇◇◇◇◇	SDA/SA
◇◇◇◇◇	Tribal Subdivision
///////	STATE
■■■■■	COUNTY
○○○○○	MINOR CIVIL DIV. ¹
■■■■■	Incorporated Place ¹
■■■■■	Census Designated Place ¹
■■■■■	Voting District ²
●●●●●	SLD-Senate
▲▲▲▲▲	SLD-House
■	Military
Inset	Inset
Out Area	Out Area

Abbreviation Reference: AIR - American Indian Reservation; SDA/SA - State Designated American Indian Statistical Area; Tribal Subdivision - American Indian Tribal Subdivision

1 A * following a place name indicates that the place is coterminous with a MCD. A * indicates that the place is also a false MCD. In both cases, the MCD name is shown only when it differs from the place name.

2 A * following a VTD code indicates an actual voting district. Its absence indicates that the VTD is a pseudo-voting district or no information is available as to its status.

Voting Districts

Code	Name
UNA*	Unaka Voting District
RANG*	Ranger Voting District
GRACK*	Grain Creek Voting District
HIDAM*	Hiveseen Dam Voting District
BMSCRU	Broadfork CRU Voting District
HMNCRU	HAMN CRU Voting District

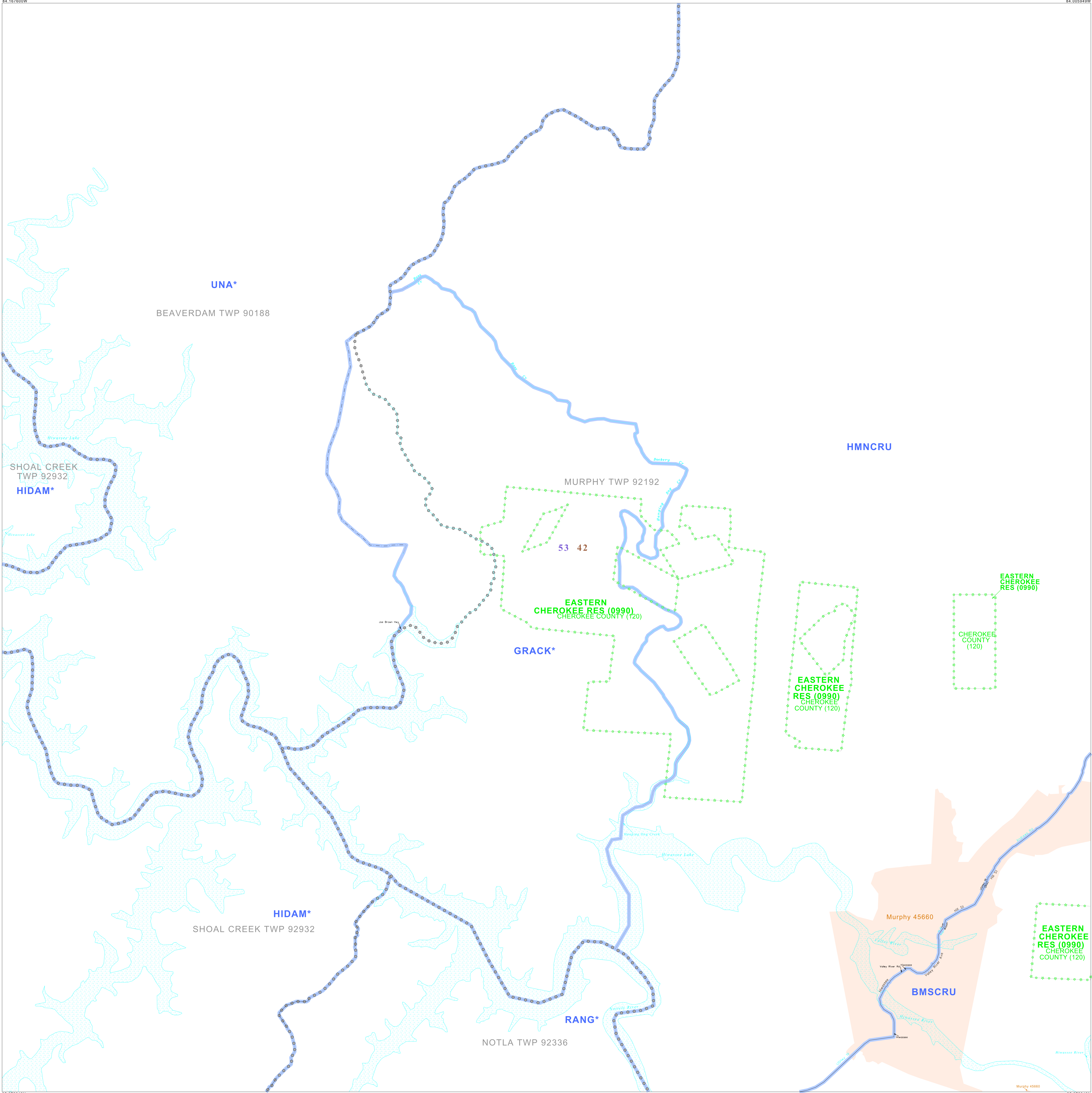

35 073340N
84 167600W

35 073340N
84 009490W

The plotted map scale is 1:20000

Sheet Location within County

Key to Adjacent Sheets

1	2	3
5	6	7
9	10	11

ST: North Carolina (37)
 COU: Cherokee (039)
 SHEET 6 OF 11 PARENT SHEETS

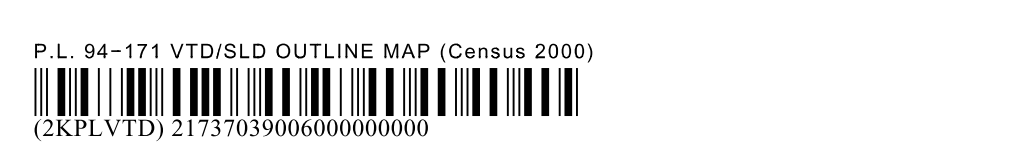

All legal boundaries and names are as of January 1, 2000. The boundaries shown on this map are for Census Bureau statistical data collection and tabulation purposes only; their depiction and designation for statistical purposes does not constitute a determination of jurisdictional authority or rights of ownership or entitlement. U.S. DEPARTMENT OF COMMERCE Economics and Statistics Administration U.S. Census Bureau