

P.L. 94-171 VOTING DISTRICT/STATE LEGISLATIVE DISTRICT OUTLINE MAP (CENSUS 2000)

36 465748N  
80 543869W

36 465748N  
80 379649W

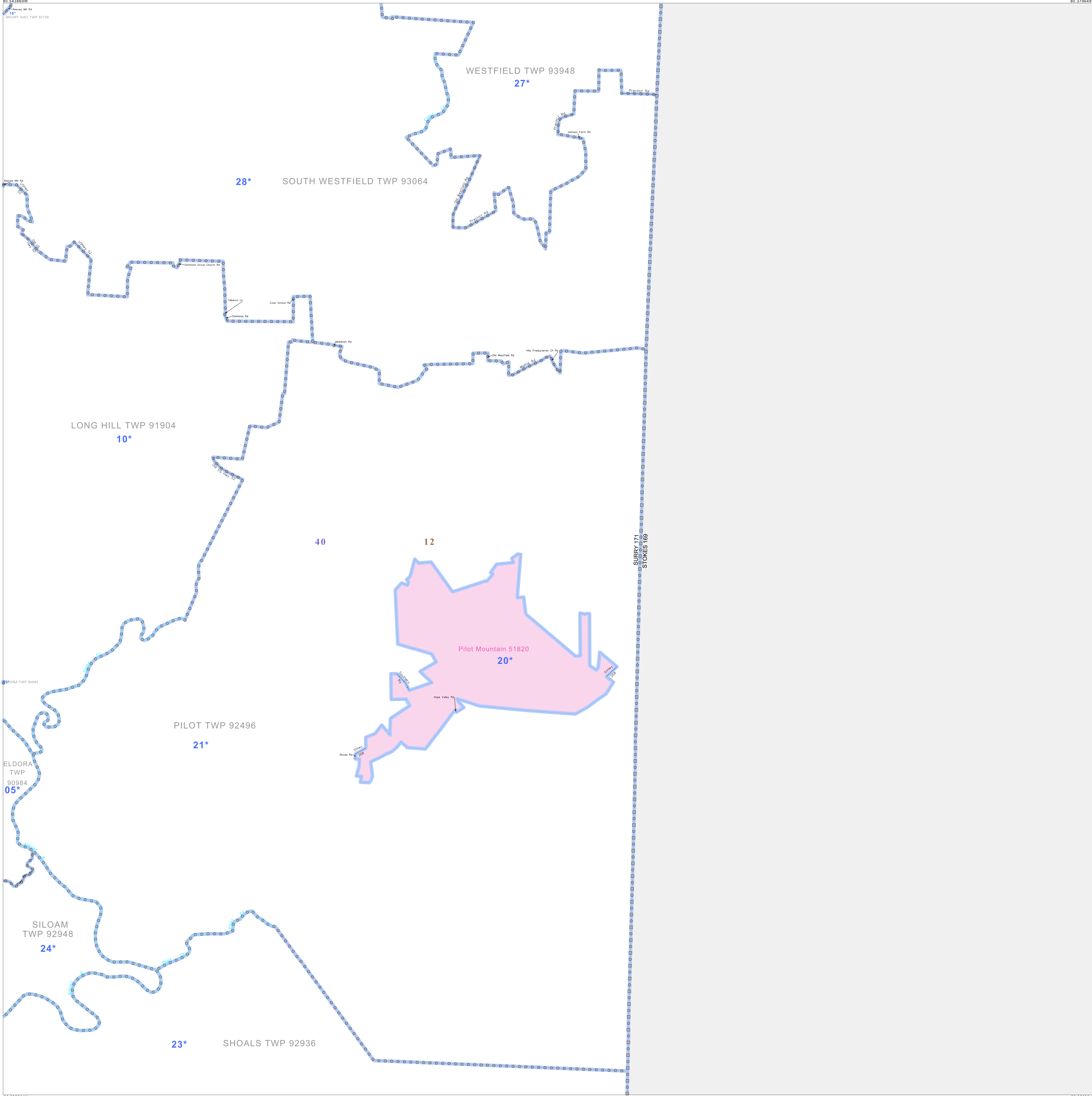

**GEOGRAPHIC AREAS LEGEND**

SYMBOL	NAME STYLE
*****	INTERNATIONAL
*****	AIR (FEDERAL)
◇◇◇◇◇	SDA/SA
◇◇◇◇◇	TRIBAL SUBDIVISION
///////	STATE
#####	COUNTY
#####	MINOR CIVIL DIV. <sup>1</sup>
#####	Incorporated Place <sup>1</sup>
#####	Census Designated Place <sup>1</sup>
#####	Voting District <sup>2</sup>
●●●●●	SLD-Senate
▲▲▲▲▲	SLD-House
▲▲▲▲▲	Military
Inset	Inset
Out Area	Out Area

Abbreviation Reference: AIR - American Indian Reservation; SDA/SA - State Designated American Indian Statistical Area; Tribal Subdivision - American Indian Tribal Subdivision

<sup>1</sup> A \* following a place name indicates that the place is coterminous with a MCD. A \* indicates that the place is also a false MCD. In both cases, the MCD name is shown only when it differs from the place name.

<sup>2</sup> A \* following a VTD code indicates an actual voting district. Its absence indicates that the VTD is a pseudo-voting district or no information is available as to its status.

**Voting Districts**

Code	Name
05*	Eldora Voting District
10*	Long Hill Voting District
18*	Mount Airy 8 Voting District
20*	Pilot 1 Voting District
21*	Pilot 2 Voting District
23*	Shoals Voting District
24*	Siloam Voting District
27*	North Westfield Voting District
28*	South Westfield Voting District

36 332984N  
80 543869W

36 332984N  
80 379649W

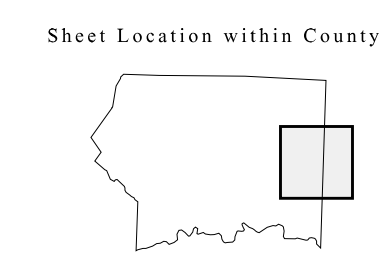
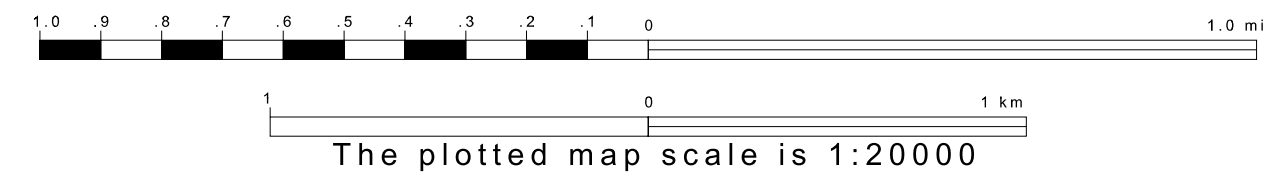
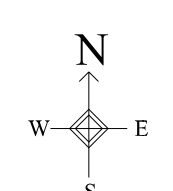

Key to Adjacent Sheets

3	4
7	8
11	12

ST: North Carolina (37)  
COU: Surry (171)  
SHEET 8 OF 12 PARENT SHEETS

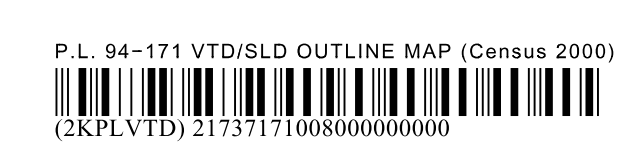

All legal boundaries and names are as of January 1, 2000. The boundaries shown on this map are for Census Bureau statistical data collection and tabulation purposes only; their depiction and designation for statistical purposes does not constitute a determination of jurisdictional authority or rights of ownership or entitlement. U.S. DEPARTMENT OF COMMERCE Economics and Statistics Administration U.S. Census Bureau