

P.L. 94-171 VOTING DISTRICT/STATE LEGISLATIVE DISTRICT OUTLINE MAP (CENSUS 2000)

35 939760N
81 896480W

35 939760N
81 896480W

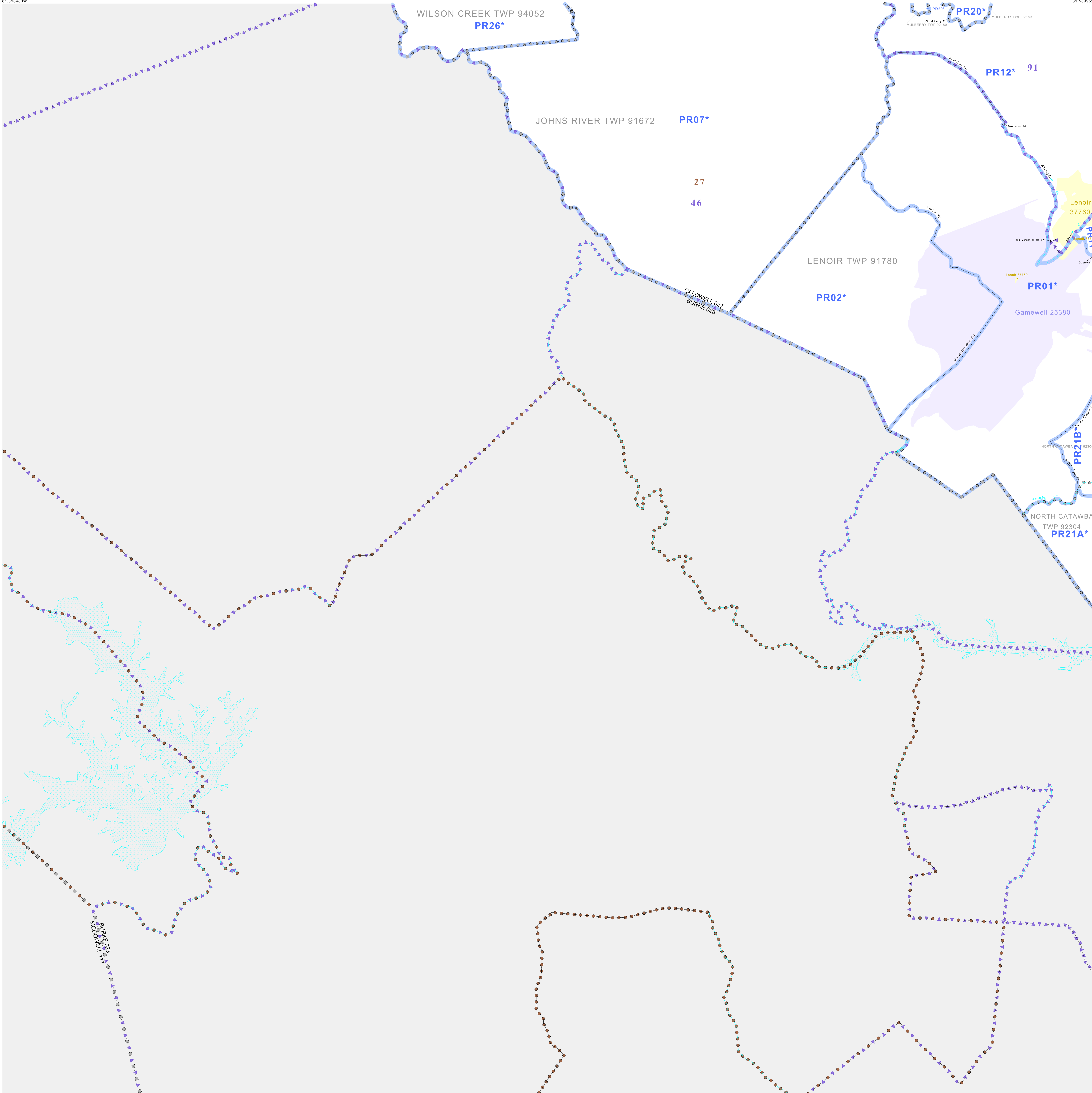

GEOGRAPHIC AREAS LEGEND

SYMBOL	NAME STYLE
*****	INTERNATIONAL
*****	AIR (FEDERAL)
◇◇◇◇◇	SDA/ISA
◇◇◇◇◇	TRIBAL SUBDIVISION
///////	STATE
	COUNTY
□□□□□	MINOR CIVIL DIV. ¹
■	Incorporated Place ¹
■	Census Designated Place ¹
—	Voting District ²
●●●●●	SLD-Senate
▲▲▲▲▲	SLD-House
■	Military
Inset	Inset
Out Area	Out Area

Abbreviation Reference: AIR - American Indian Reservation; SDA/ISA - State Designated American Indian Statistical Area; Tribal Subdivision - American Indian Tribal Subdivision

1 A * * following a place name indicates that the place is coterminous with a MCD. A * * indicates that the place is also a false MCD. In both cases, the MCD name is shown only when it differs from the place name.

2 A * * following a VTD code indicates an actual voting district. Its absence indicates that the VTD is a pseudo-voting district or no information is available as to its status.

Voting Districts

Code	Name
PR01*	Gamewell 1 Voting District
PR02*	Gamewell 2 Voting District
PR03*	Oshe-Catawba River Voting District
PR04*	Lenoir 1 Voting District
PR05*	Lenoir 2 Voting District
PR06*	Lenoir 3 Voting District
PR07*	Lenoir 4 Voting District
PR08*	Wilson Creek Voting District
PR09*	North Catawba 1 Voting District
PR10*	North Catawba 2 Voting District

35 874212N
81 896480W

35 874212N
81 896480W

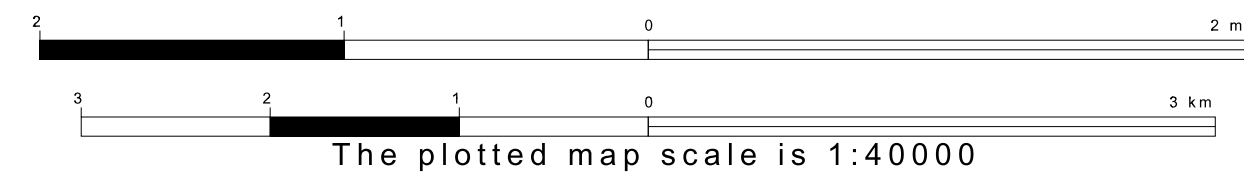

Sheet Location within County

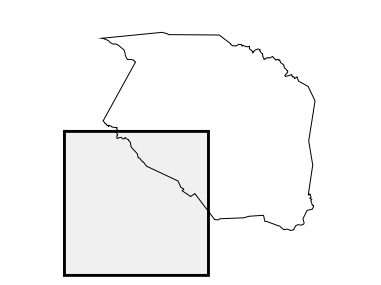

Key to Adjacent Sheets

1	2
3	4

ST: North Carolina (37)
 COU: Caldwell (027)
 SHEET 3 OF 4 PARENT SHEETS

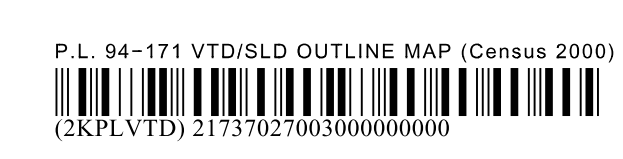

All legal boundaries and names are as of January 1, 2000. The boundaries shown on this map are for Census Bureau statistical data collection and tabulation purposes only; their depiction and designation for statistical purposes does not constitute a determination of jurisdictional authority or rights of ownership or entitlement. U.S. DEPARTMENT OF COMMERCE Economics and Statistics Administration U.S. Census Bureau