

P.L. 94-171 VOTING DISTRICT OUTLINE MAP (CENSUS 2000)

**GEOGRAPHIC AREAS LEGEND**

SYMBOL	NAME STYLE
*****	INTERNATIONAL
*****	AIR (FEDERAL)
*****	Trust Land
//////	STATE
	COUNTY
o-o-o-o	CENSUS COUNTY DIV.
Yellow/Pink	Incorporated Place
Yellow/Pink	Census Designated Place
Blue	Voting District
Blue Dashed	Military
Inset	Inset
Out Area	Out Area

Abbreviation Reference: AIR - American Indian Reservation; Trust Land - Off-Reservation Trust Land  
 1. A "\*" following a VTD code indicates an actual voting district. Its absence indicates that the VTD is a pseudo voting district or no information is available as to its status.

**Voting Districts**

Code	Name
0301	Voting District 0301
0401	Voting District 0401

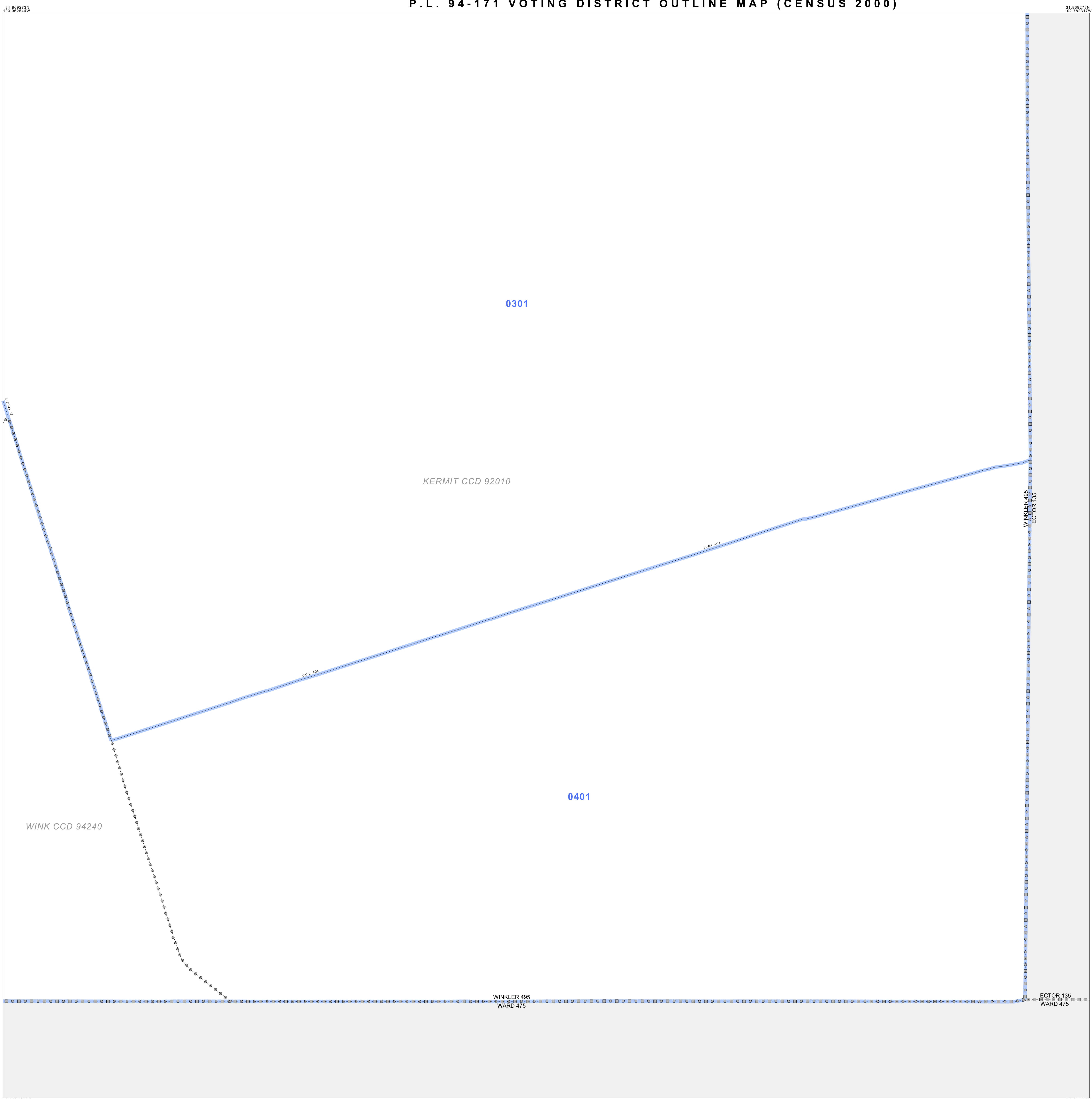

31 869273N 103.062544W (top left), 31 630120N 102.782317W (top right), 31 830120N 103.062544W (bottom left), 31 630120N 102.782317W (bottom right)

**Scale:** The plotted map scale is 1:36000. Scale bars show 1 mile and 3 kilometers.

**Sheet Location within County:** A diagram showing a 2x2 grid of sheets, with the current sheet (4) shaded in the bottom-right position.

**Key to Adjacent Sheets:** A 2x2 grid with numbers 1, 2, 3, and 4 in each cell.

All legal boundaries and names are as of January 1, 2000. The boundaries shown on this map are for Census Bureau statistical data collection and tabulation purposes only; their depiction and designation for statistical purposes does not constitute a determination of jurisdictional authority or rights of ownership or entitlement. U.S. DEPARTMENT OF COMMERCE Economics and Statistics Administration U.S. Census Bureau

ST: Texas (48)  
 COU: Winkler (495)  
 SHEET 4 OF 4 PARENT SHEETS

P.L. 94-171 VTD OUTLINE MAP (Census 2000)  
 (CKPLVTD) 2154849506400000000