

Quality Assurance Site Information for Mira Loma

This page updated February 10, 2005

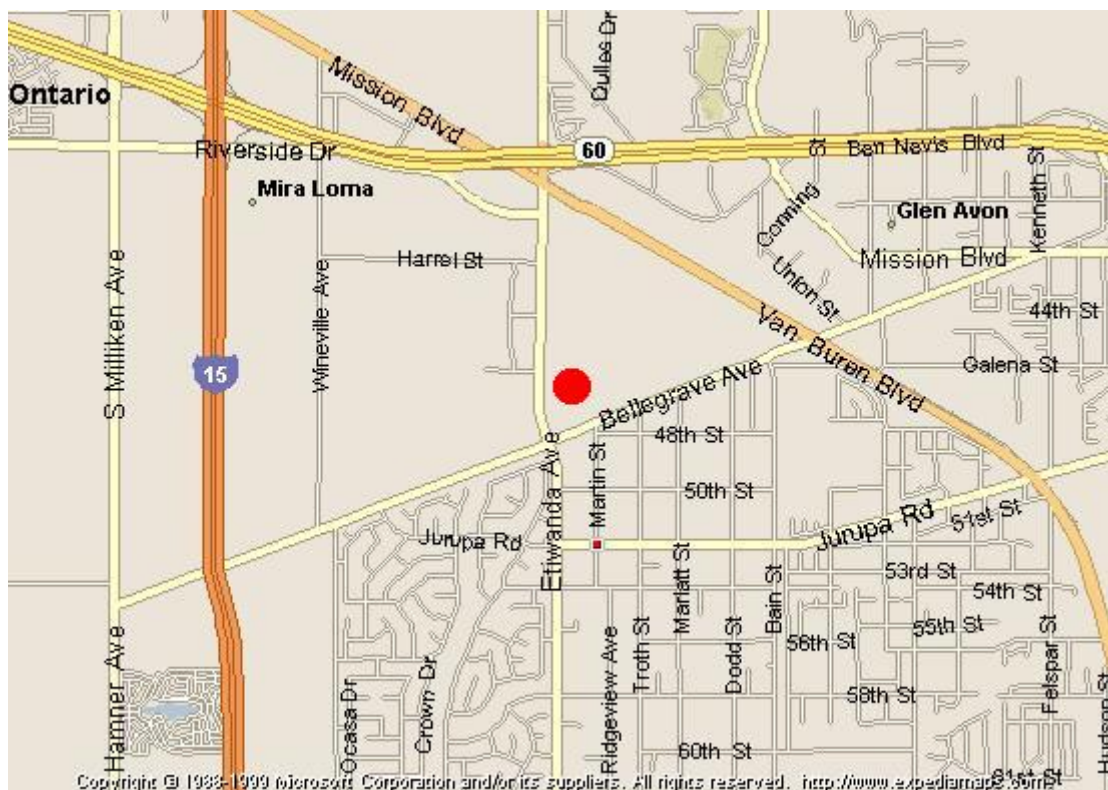

AIRS Number	ARB Number	Site Start Date	Reporting Agency and Agency Code
None	33163	Not Available	South Coast AQMD (061)

Site Address	County	Air Basin	Latitude	Longitude	Elevation
10551 Bellegrave, Mira Loma CA 91752	Riverside	South Coast	34° 0' 7"	117° 31' 21"	230

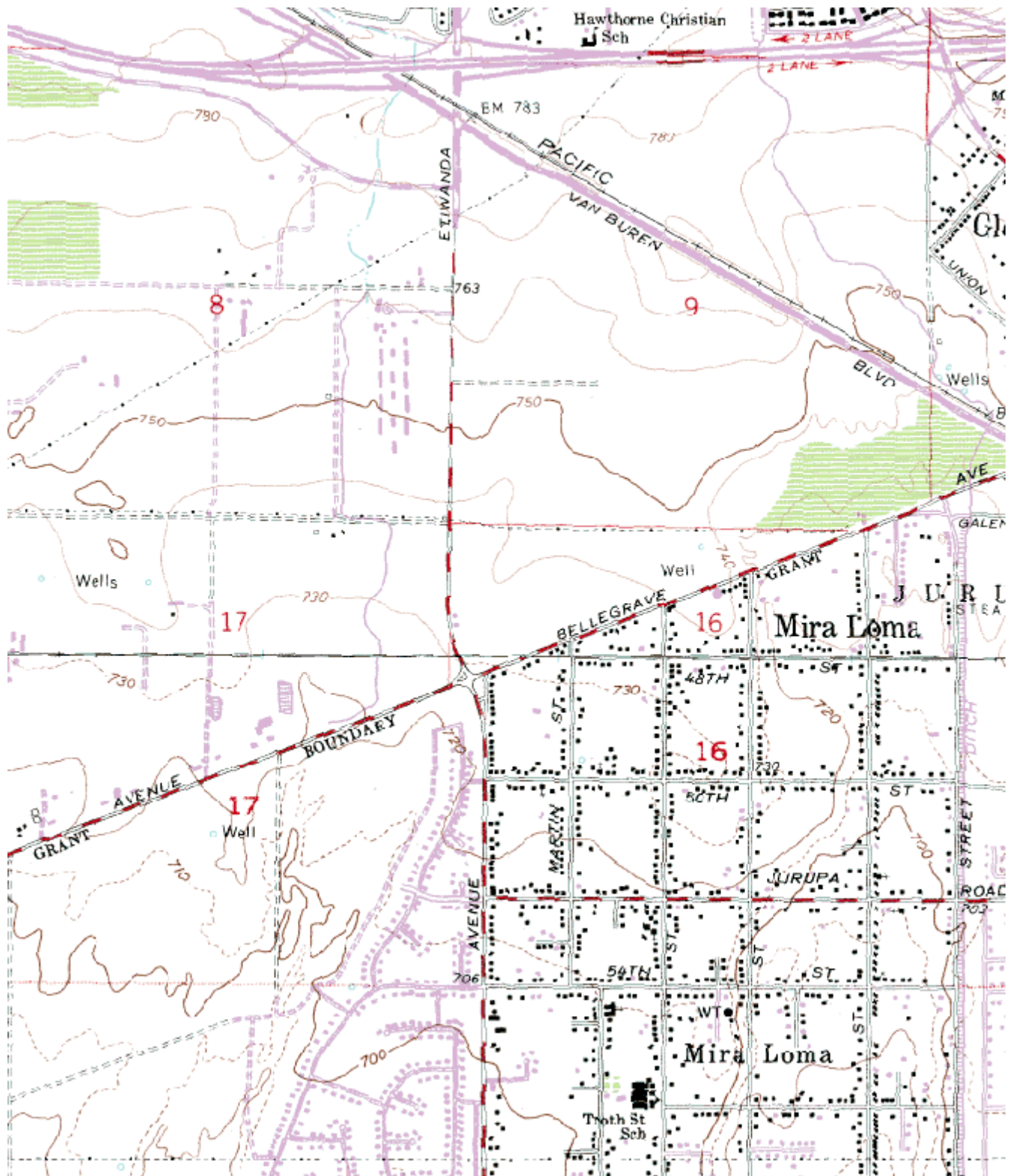

Site Survey Report

Siting Information

Site Name: Mira Loma	Audit Date: 2005-08-16	ARB Number: 33163	AIRS Number: None
Address: 10551 Bellegrave Mira Loma, CA 91752	Latitude: 34° 0' 7"	Longitude: 117° 31' 21"	Elevation (m): 230
	Auditors: Don Fitzell Alvin Danque	Site Technician: Eric Trinn	Site Phone:
Operating Agency: South Coast AQMD		Site Report: Yes	Site Photos: Yes

General Siting Conditions

Station Temperature Controlled: Yes Recorded: Yes Inside Temp: 24 Degrees Celsius	Traffic Description: Commercial Distance: 200 meters Count (Veh/Day): 40000	Topography Site: Level Region: Level	Predominant Wind Direction: Southwest
			Arc Air Flow (Deg): 360 Degrees
		Meteorology Located With Instruments: No Shadowing: No Boom Orientation (Deg): N/A Temp(Motor/Natural):	Non-vehicular Local Sources Description: Agriculture Distance: 600 meters Direction: W
Agency: South Coast AQMD	Manifold Clean: Yes		
Urbanization: Suburban	Cleaning Schedule: As needed		
Ground Cover: dirt	Autocalibrator Type: Envirionics 100		
	Site Survey Complete: Yes		
	Logbook Up To Date: Yes		

Action Items

Comments

Site Survey Report (Cont.)

Monitor Type	Carbon Monoxide	Nitrogen Dioxide	Ozone	TEOM
Manufacturer/Model	Horiba APMA-360	API 200	API/Teledyne 400	R&P 1400
Serial Number	16507	E000218	183	20013779
POC				1
Data For Record?	No	No	No	No
Purpose				
Objective				
Scale				
Height Above Ground	4.3	4.3	4.3	4.9
Height Above Platform	1.3	1.3	1.3	1.8
Sampler Spacing				
Current Manual Available?	Yes	Yes	Yes	Yes
Instrument Log Up-to-date?	Yes	Yes	Yes	Yes
In-line Filter Change Date	2005-08-03	2005-08-03	2005-08-03	
Cal. Gas Cert. Date	2004-03-31	2004-03-31		
Calibration Current?	Yes	Yes	Yes	Yes
Calibration Date	2005-03-11	2005-06-14	2005-02-12	2004-12-02
Cal. Equipment Cert. Date	2005-03-11	2005-06-14	2005-02-18	Not Available
Obstacle Description	None	None	None	None
Distance to Obstacle	-	-	-	-
Height Above Inlet	-	-	-	-
Distance to Walls, etc.	-	-	-	-
Distance to Dripline	-	-	-	-
Dominant Influence	Vehicular	Vehicular	Vehicular	Vehicular
Residence Time (sec)	10.3	10.3	9.9	