

1 | F- XXXXXXXXT-7-24-06-final draft Med Guide Multidose Pen
2

3 **MEDICATION GUIDE**

4

5 **INTRON® A**
6 (Interferon alfa-2b, recombinant)
7

8 **Including appendix with instructions for using INTRON A Multidose Pen for**
9 **Injection**

10
11 Read this Medication Guide carefully before you start to take INTRON A (In-tron
12 aye) for Injection alone or INTRON A in combination with REBETOL (REB-eh-tole)
13 (ribavirin, USP) Capsules. Read the Medication Guide each time you refill your
14 prescription because there may be new information. The information in this
15 Medication Guide does not take the place of talking with your healthcare provider.
16

17 If you are taking INTRON A and REBETOL combination therapy, also read the
18 Medication Guide for REBETOL (ribavirin, USP) Capsules.
19
20

21 **What is the most important information I should know about INTRON A?**

22

23 INTRON A is a treatment for some people who have hairy cell leukemia, malignant
24 melanoma, follicular lymphoma, AIDS-related Kaposi's sarcoma, chronic hepatitis B,
25 chronic hepatitis C and condylomata acuminata. If you have chronic hepatitis C, your
26 healthcare provider may prescribe INTRON A in combination with REBETOL.
27 INTRON A used by itself or with REBETOL can help you but can also have serious
28 side effects and may cause death in rare cases. Before starting treatment, you
29 should talk to your healthcare provider about the possible benefits and possible side
30 effects of INTRON A alone or in combination with REBETOL, to decide if this
31 treatment is right for you. While taking INTRON A alone or in combination with
32 REBETOL, you need to see a healthcare provider regularly for medical examinations
33 and lab tests to make sure the treatment is working and to check for side effects.
34

35 **You should call your doctor immediately if you develop any of these**
36 **conditions while taking INTRON A:**

- 37 • you become pregnant or if you are a male and your female partner becomes
38 pregnant
- 39 • new or worsening mental health problems such as thoughts about hurting or
40 killing yourself or others
- 41 • decreased vision
- 42 • trouble breathing or chest pain
- 43 • severe stomach or lower back pain
- 44 • bloody diarrhea or bloody bowel movements
- 45 • high fever
- 46 • easy bruising or bleeding
47

48 The most serious possible side effects of INTRON A include:
49

50 **RISK TO PREGNANCY.** Combination INTRON A and REBETOL therapy can
51 cause death, serious birth defects or other harm to your unborn child. If you
52 are pregnant, you or your male partner must not take INTRON A and REBETOL
53 combination therapy. You must not become pregnant while either you or your
54 partner are taking the combination of INTRON A and REBETOL and for 6
55 months after you stop taking the combination. If you are a woman of
56 childbearing age you must have negative pregnancy tests immediately before
57 starting treatment, during treatment, and for 6 months after you have stopped
58 treatment. You should use two forms of birth control during and for 6 months
59 after you have stopped treatment. If you are a man taking INTRON A/REBETOL
60 combination therapy, one of the two forms of birth control should be a
61 condom. You must use birth control even if you believe that you are not fertile
62 or that your fertility is low. You should talk to your doctor about birth control
63 for you and your partner. If you or your partner becomes pregnant while
64 either of you is being treated or within 6 months of stopping treatment, tell
65 your doctor right away.
66

67 **Mental health problems and suicide.** INTRON A may cause patients to develop
68 mood or behavioral problems. These can include irritability (getting easily upset)
69 and depression (feeling low, feeling bad about yourself, or feeling hopeless). Some
70 patients may have aggressive behavior. Former drug addicts may fall back into drug
71 addiction or overdose. Some patients think about hurting or killing themselves or
72 other people. Some patients have killed themselves (suicide) or hurt themselves or
73 others. You must tell your doctor if you are being treated for a mental illness or had
74 treatment in the past for any mental illness, including depression and suicidal
75 behavior. You should also tell your doctor if you have ever been addicted to drugs
76 or alcohol.
77

78 **Eye problems.** If you notice any changes in your eyesight, such as difficulty seeing,
79 it could mean that your eyes are being affected, so you should call your doctor right
80 away.
81

82 **Heart problems.** Some patients taking INTRON A may develop problems with their
83 heart, including low blood pressure, fast heart rate, and very rarely, heart attacks.
84 Tell your doctor if you have had any heart problems in the past.
85

86 **Blood problems.** INTRON A commonly lowers two types of blood cells (white
87 blood cells and platelets). In some patients, these blood counts may fall to
88 dangerously low levels. If your blood cell counts become very low, you could get
89 infections or have bleeding problems.
90

91 If you are taking INTRON A and REBETOL combination therapy, REBETOL can
92 cause a drop in your number of red blood cells (anemia). A very low red blood cell
93 count can be dangerous, especially if you have heart or breathing problems.
94

95 *For other possible side effects of INTRON A, see "What are the possible side effects*
96 *of INTRON A?" in this Medication Guide.*

97

98

What is INTRON A?

99

100

The INTRON A product contains a man-made protein called interferon. Interferon is a protein that is part of the body's immune system that "interferes" with the growth of viruses or cancer cells.

101

102

103

104

It is not known if INTRON A or INTRON A/REBETOL combination therapy can cure hepatitis B or C (*permanently eliminate the virus*) or if it can prevent liver failure or liver cancer that is caused by hepatitis B or C infection.

105

106

107

It is also not known if INTRON A or INTRON A/REBETOL combination therapy will prevent one infected person from infecting another person with hepatitis B or C.

108

109

110

Who should not take INTRON A?

111

Do not take INTRON A alone or in combination with REBETOL if you:

112

113

- are pregnant, planning to get pregnant, or breast-feeding
- are a male patient on combination therapy and have a female sexual partner who is pregnant or plans to become pregnant while you are being treated with REBETOL or during the 6 months after your treatment has ended
- have autoimmune hepatitis (hepatitis caused by your immune system attacking your liver) or unstable liver disease (yellowing of the skin and eyes, swelling of the abdomen)
- had an allergic reaction to another alpha interferon or ribavirin or are allergic to any of the ingredients in INTRON A or REBETOL

114

115

116

117

118

119

120

121

122

123

If you have any of the following conditions or serious medical problems, tell your doctor before taking INTRON A alone or in combination with REBETOL:

124

125

- depression or anxiety
- eye problems
- sleep problems
- high blood pressure
- previous heart attack, or other heart problems
- liver problems (other than hepatitis B or C)
- any kind of autoimmune disease (where the body's immune system attacks the body's own cells), such as psoriasis, sarcoidosis, systemic lupus erythematosus, rheumatoid arthritis
- thyroid problems
- diabetes
- colitis (inflammation of the bowels)
- cancer
- hepatitis B or C infection
- HIV infection (the virus that causes AIDS)
- kidney problems
- bleeding problems
- alcoholism
- drug abuse or addiction

126

127

128

129

130

131

132

133

134

135

136

137

138

139

140

141

142

143

- 144 • body organ transplant and are taking medicine that keeps your body from
145 rejecting your transplant (suppresses your immune system)
- 146 • high blood triglycerides (fat particles normally found in your blood)

147

148 How should I take INTRON A?

149

150 To get the most benefit from this medicine, it is important that you take INTRON A
151 exactly as your doctor tells you. Your doctor will decide your dose of INTRON A and
152 how often you will take it. Do not take more than your prescribed dose. INTRON A is
153 given as an injection either under the skin (subcutaneous) or into a muscle
154 (intramuscular). You should be completely comfortable with how to prepare and
155 measure your dose of INTRON A and how to inject yourself before you use INTRON
156 A for the first time. Your healthcare provider will train you on how to use and inject
157 INTRON A properly.

158

159 INTRON A comes in different strengths and different forms (a powder in a vial, a
160 solution in a vial, and a multidose pen). Your doctor will determine which form is best
161 for you. The instructions for giving a dose of INTRON A are at the end of this leaflet.

162

163 If you miss a dose of INTRON A, take the missed dose as soon as possible during
164 the same day or the next day, then continue on your regular dosing schedule. If
165 several days go by after you miss a dose, check with your doctor to see what to do.
166 **Do not double your next dose** or take more than your prescribed dose without
167 talking to your doctor. Call your doctor right away if you take more than your
168 prescribed dose. Your doctor may wish to examine you more closely and take blood
169 for testing.

170

171 If you are taking INTRON A in combination with REBETOL, you should also read the
172 Medication Guide for REBETOL (ribavirin, USP) for more information about side
173 effects and how to take REBETOL. **REBETOL capsules should be taken twice a**
174 **day with food.** Taking REBETOL with food helps your body take up more of the
175 medicine. Taking REBETOL at the same time of day every day will help keep the
176 amount of medicine in your body at a steady level. This can help your doctor decide
177 how your treatment is working and how to change the number of REBETOL
178 capsules you take if you have side effects. If you miss a dose of REBETOL, take the
179 missed dose as soon as possible during the same day. If an entire day has passed,
180 check with your doctor about what to do. **Do not double your next dose.**

181

182 You must see your doctor on a regular basis for blood tests so your doctor can
183 check how the treatment is working for you and to check for side effects.

183

184 Tell your doctor if you are taking or planning to take other prescription or non-
185 prescription medicines, including vitamin and mineral supplements and herbal
186 medicines.

187

188 What should I avoid while taking INTRON A?

189

- 190 • Avoid becoming pregnant while taking INTRON A. INTRON A alone and
191 INTRON A taken in combination with REBETOL may harm your unborn child or
cause you to lose your baby (miscarry). If you or your partner becomes pregnant

192 during treatment or during the 6 months after treatment with INTRON
193 A/REBETOL combination therapy, immediately report the pregnancy to your
194 doctor. Your doctor will make decisions about your treatment.

- 195 • Do not breast-feed your baby while taking INTRON A.

196

197 What are the possible side effects of INTRON A?

198

199 Possible, serious side effects include:

200

- 201 • **Risk to pregnancy; mental health problems, including suicide; blood**
202 **problems; heart problems and eye problems.** see "*What is the most*
203 *important information I should know about INTRON A?*"
- 204 • **Other body organ problems.** Certain symptoms, like severe pain in the middle
205 of your body, nausea, and vomiting, may mean that your liver or pancreas is
206 being damaged. A few patients have lung problems such as pneumonia
207 (inflammation of the lung tissue), and inflammation of the kidney. If you are short
208 of breath, coughing, or have severe stomach or back pains or a fever, you should
209 call your doctor right away.
- 210 • **Thyroid problems.** Some patients develop changes in the function of their
211 thyroid. Symptoms of thyroid changes include the inability to concentrate, feeling
212 cold or hot all the time, a change in your weight, and changes to your skin.
- 213 • **New or worsening autoimmune disease.** Some patients taking INTRON A
214 develop autoimmune diseases (a condition where the body's immune cells attack
215 other cells or organs in the body), including rheumatoid arthritis, systemic lupus
216 erythematosus, sarcoidosis, and psoriasis. In some patients who already have
217 an autoimmune disease, the disease may worsen while on INTRON A.

218

219 Common but less serious side effects include:

220

- 221 • **Flu-like symptoms.** Most patients who take INTRON A have "flu-like"
222 symptoms (headache, muscle aches, tiredness, and fever) that usually lessen
223 after the first few weeks of therapy. You can reduce some of these symptoms by
224 injecting your INTRON A dose at bedtime. Over-the-counter pain and fever
225 medications can be used to prevent or reduce the fever and headache. If your
226 fever does not go away you should tell your doctor.
- 227 • **Extreme fatigue (tiredness).** Many patients become extremely tired while on
228 INTRON A.
- 229 • **Appetite problems.** Nausea, loss of appetite, and weight loss occur commonly.
- 230 • **Blood sugar problems.** Some patients develop problems with the way their
231 body controls their blood sugar and may develop high blood sugar or diabetes.
- 232 • **Skin reactions.** Redness, swelling, and itching are common at the site of
233 injection. If after several days these symptoms do not disappear, contact your
234 doctor. You may get a rash during therapy. If this occurs, your doctor may
235 recommend medicine to treat the rash.
- 236 • **Hair thinning.** Hair thinning is common during INTRON A treatment. Hair loss
237 stops and hair growth returns after therapy is stopped.

238

239 These are not all the side effects of INTRON A or INTRON A/REBETOL combination
240 therapy. Your healthcare provider can give you a more complete list.

241

242 **General advice about prescription medicines**

243 Medicines are sometimes prescribed for purposes other than those listed in a
244 Medication Guide. If you have any concerns about the INTRON A product, ask your
245 healthcare provider. Your healthcare provider can give you additional information
246 about INTRON A. Do not use INTRON A for a condition for which it was not
247 prescribed. Do not share this medication with other people.

248

249 This Medication Guide has been approved by the U.S. Food and Drug
250 Administration.

251

252 Manufactured by: Schering Corporation Kenilworth, NJ 07033 USA

253

254 Issued: 12/05

255

256 Instructional leaflet and video are available through your doctor.

257

258 *Novofine is a registered trademark of Novo Nordisk

259

260 Copyright © 1996, 2001, Schering Corporation. All rights reserved.

261 Rev. 12/05

B-XXXXXXXX

262

263 **Medication Guide Appendix: Instructions for Preparing and Giving a Dose of**
264 **INTRON A Multidose Pen**

265

266 The INTRON A Solution for Injection multidose pen is a pre-filled, multidose pen that
267 contains six doses of either 3, 5, or 10 million international units (MIU) of INTRON A.
268 The multidose pen can also be used for different doses if your healthcare provider
269 wants you to increase or decrease your dose.

270

271 The multidose pen can provide between 3 to 12 doses depending upon the dose
272 your healthcare provider tells you to use. The multidose pen prescribed for you by
273 your healthcare provider will be one of the following:

274

275 • 3 Million International Units (MIU) with a brown push button and a brown color-
276 coding strip. The different doses that it can deliver are 1.5 MIU, 3.0 MIU, 4.5
277 MIU, and 6.0 MIU. Six MIU is the maximum dose that this pen can deliver at one
278 time.

279 • 5 Million International Units (MIU) with a light blue push button and a light blue
280 color-coding strip. The different doses that it can deliver are 2.5 MIU, 5.0 MIU,
281 7.5 MIU, and 10.0 MIU. Ten MIU is the maximum dose that this pen can deliver
282 at one time.

283 • 10 Million International Units (MIU) with a pink push button and a pink color-
284 coding strip. The different doses that it can deliver are 5.0 MIU, 10.0 MIU, 15.0
285 MIU, and 20.0 MIU. Twenty MIU is the maximum dose that this pen can deliver
286 at one time.

287
288
289
290
291
292

Make sure that you have the correct INTRON A multidose pen as prescribed by your healthcare provider.

Description of your INTRON A multidose pen

293
294
295
296
297
298
299
300
301

- The INTRON A multidose pen should **ONLY** be used with **Novofine*** needles. These are the needles that come packaged with the pen. If you use other needles, the pen may not work properly, and you could get the wrong dose of INTRON A.

The two diagrams below show all the different parts of the INTRON A multidose pen and the Novofine needle. The parts of the pen you need to become familiar with are:

INTRON A Pen

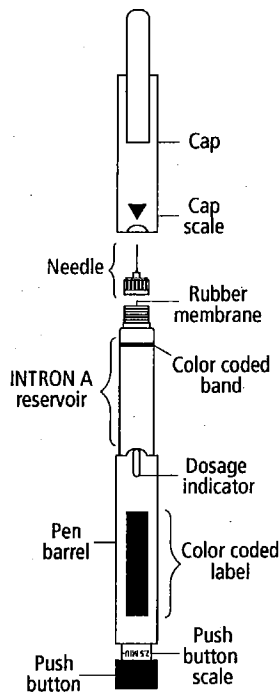

Novofine Needle Assembly

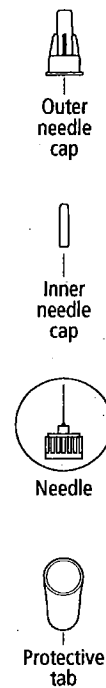

302
303
304
305
306
307
308
309
310
311
312
313

- The **color-coded push button** and **push button scale**. These are located at the bottom of the pen when it is held with the cap side up. This tells you the dose that has been set.
- The **color-coding band**. This is located on the INTRON A reservoir. The band lets you know the dose that you are using. The 3 MIU INTRON A multidose pen has a brown push button, a brown color-coding band and color-coded label. The 5 MIU INTRON A multidose pen has a light blue push button, a light blue color-coding band and color-coded label. The 10 MIU INTRON A multidose pen has a pink push button, a pink color-coding band and color-coded label.

- 314 • The **cap**. The cap is used for setting the dose and storing the pen. You will not
315 be able to set the dose or completely close the pen unless you line up the
316 **triangle** on the **cap scale** with the **dosage indicator** on the barrel.
317

318 **To avoid the possible transmission of disease, do not allow anyone else to**
319 **use your multidose pen.**
320

321 **Storing INTRON A Solution Multidose Pen for Injection**

322 INTRON A Solution Multidose Pen for Injection should be stored in the refrigerator
323 between 2° and 8°C (36° and 46°F). Discard any unused INTRON A pen remaining
324 after 4 weeks. **DO NOT FREEZE.**
325

326 **How do I prepare for an injection using the INTRON A multidose pen?**
327

328 1. Find a well-lit, clean, flat working surface such as a table. Collect the supplies
329 you will need for an injection:

- 330
- 331 • the Intron A Multidose Pen
 - 332 • two alcohol swabs
 - 333 • a cotton ball or gauze
 - 334 • a puncture-proof disposable container
- 335

336 2. Before removing the Multidose Pen from the carton, check the date printed on
337 the carton to make sure that the expiration date has not passed. Do not use if
338 the expiration date has passed.
339

340 3. Wash your hands with soap and warm water. It is important to keep your work
341 area, your hands, and injection site clean to minimize the risk of infection.

342 4. Remove the multidose pen from the carton. Pull the cap off the pen and wipe the
343 rubber membrane with one alcohol swab.
344

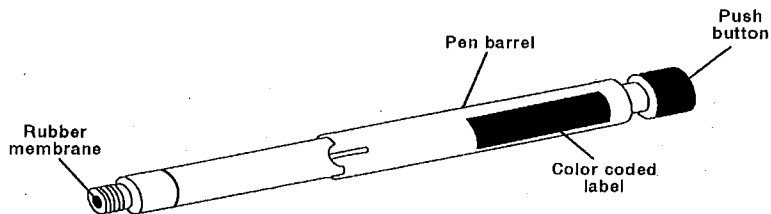

- 345 5. Check the solution inside the pen. The solution should be clear and colorless,
346 without particles. Do not use the INTRON A if the medicine is cloudy, has
347 particles, or is any color besides clear and colorless.
348
349
350 6. Remove the paper backing from the Novofine needle by pulling the paper tab.
351 You will see the back of the needle once the paper tab is removed.
352

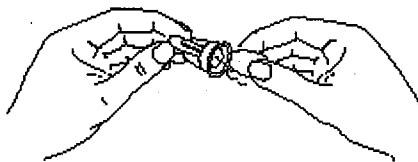

- 353
354
355
356 7. Keep the needle in its outer clear needle cap and gently push the Novofine
357 needle straight into the pen's rubber membrane you just cleaned. Screw the
358 needle onto the INTRON A multidose pen by turning it clockwise.
359

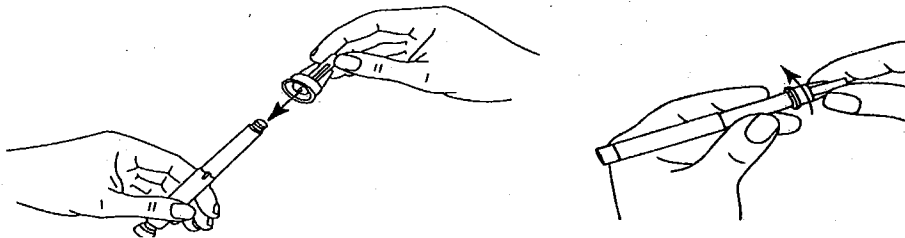

- 360
361
362 8. With the needle facing up, pull off the outer clear needle cap and set the outer
363 needle cap down on your flat work surface for later use. Next, carefully pull off
364 the white inner needle cap. The needle will now be exposed.

365

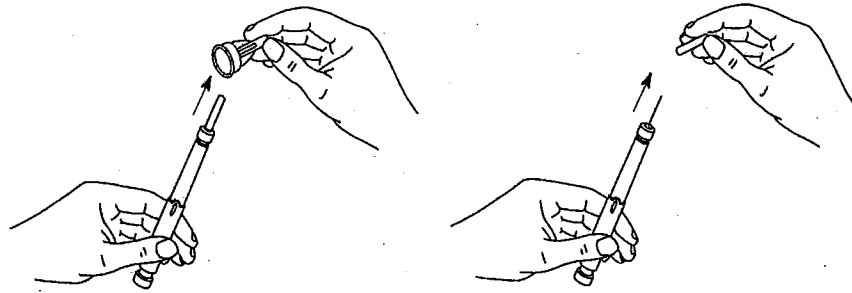

366

367

368

369

370

371

372

373

9. Keep the needle facing up and remove any air bubbles that may be in the reservoir by tapping the reservoir with your finger. If you have any air bubbles, they will rise to the top of the reservoir.

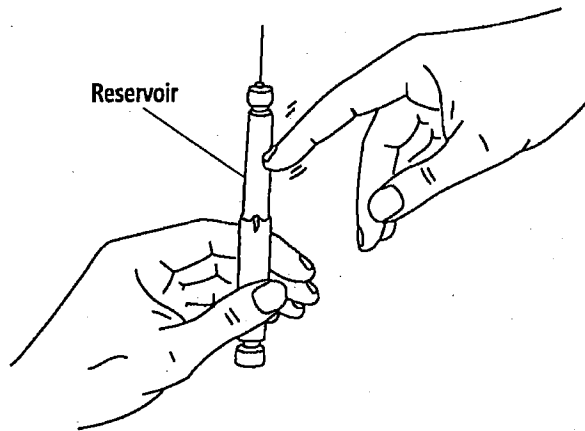

374

375

376

377

378

379

10. Hold the pen by the barrel and turn the INTRON A reservoir clockwise until you feel it click into place.



380

381

382

383

11. Keep the needle facing up and press the push button all the way up. A drop of INTRON A solution should come out of the tip of the needle.

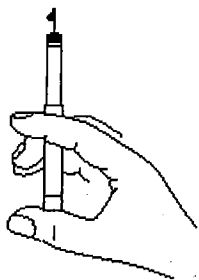

384
385
386
387
388
389

12. Place the cap back on the INTRON A multidose pen. Make sure you line up the black triangle on the pen cap with the dosage indicator on the pen barrel. The pen is now ready to set the dose.

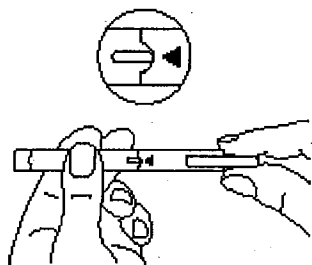

390
391
392

Setting the dose prescribed by your doctor

393
394
395

13. Hold the pen horizontally in the middle of the pen barrel so the push button can move freely. With the other hand, hold the multidose pen cap.

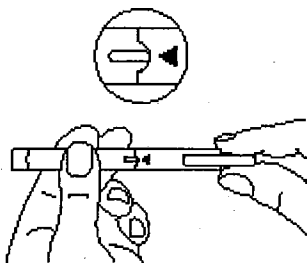

396
397

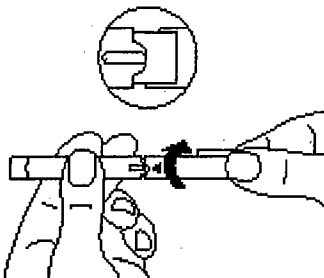

398
399
400

14. Set the dose prescribed by your healthcare provider by turning the cap clockwise. With each clockwise turn, the push button will rise and you will see

401 the push button scale. Do not use force to turn the pen cap or you may damage
402 the pen.

403

- 404 | • To set a 3.0 MIU dose using the 3 MIU multidose pen, turn the cap 2 full turns
405 (10 clicks) = 3.0 MIU.

406

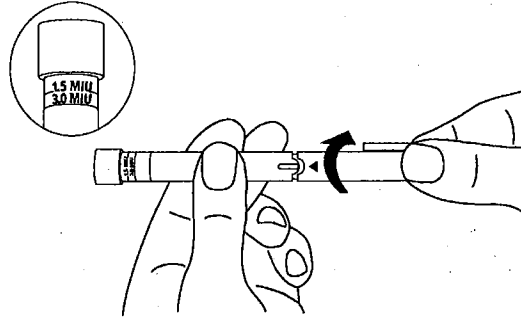

407

408

- 409 | • To set a 5 MIU dose using the 5 MIU multidose pen, turn the cap 2 full turns
410 (10 clicks) = 5.0 MIU.

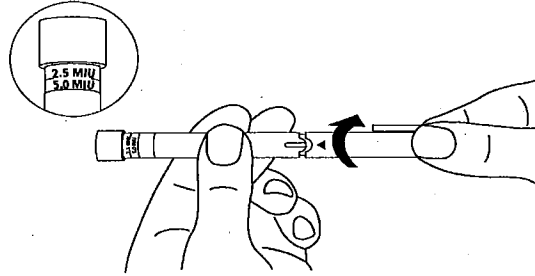

411

412

- 413 | • To set a 10 MIU dose using the 10 MIU multidose pen, turn the cap 2 full
414 turns (10 clicks) = 10.0 MIU.

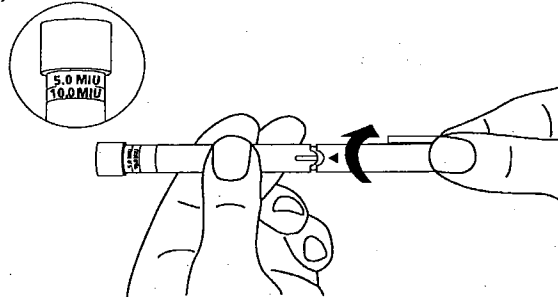

415

416

417

418 15. After each complete turn, make sure the triangle on the cap is lined up with the
419 dosage indicator on the pen barrel.

420

421 **IF YOUR HEALTHCARE PROVIDER HAS PRESCRIBED A DOSE OTHER THAN**
422 **3.0, 5.0, OR 10.0 MIU, THE DOSE CAN BE SET BY TURNING THE CAP AS**
423 **MANY TIMES AS SHOWN BELOW:**

424

425 **A dose prescribed other than 3.0 MIU from the 3 MIU multidose pen**

426 1 full turn (5 clicks) = 1.5 MIU

427 3 full turns (15 clicks) = 4.5 MIU

428 4 full turns (20 clicks) = 6.0 MIU

429

430 **A dose prescribed other than 5.0 MIU from the 5 MIU multidose pen**

431 1 full turn (5 clicks) = 2.5 MIU

432 3 full turns (15 clicks) = 7.5 MIU

433 4 full turns (20 clicks) = 10.0 MIU

434

435 **A dose prescribed other than 10.0 MIU from the 10 MIU multidose pen**

436 1 full turn (5 clicks) = 5.0 MIU

437 3 full turns (15 clicks) = 15.0 MIU

438 4 full turns (20 clicks) = 20.0 MIU

439

440 16. Check the push button scale to make sure you have set the correct dose.

441

442 17. If you have set a wrong dose, turn the cap back (counterclockwise) as far as you
443 can until the push button is all the way in and the push button scale is completely
444 covered, then begin at step 12 again.

445

446 18. Gently warm the INTRON A Solution for Injection by slowly rolling the capped
447 multidose pen in the palms of your hands for about one minute. DO NOT
448 SHAKE.

449

450 19. Place the multidose pen on your flat work surface until you are ready to inject
451 INTRON A.

452

453 **Choosing an injection site**

454

455 You should inject a dose of INTRON A subcutaneously (under the skin). If it is too
456 difficult for you to inject, ask someone who has been trained to give injections to help
457 you.

458

459 The best sites for injection are areas on your body with a layer of fat between skin
460 and muscle such as:

461

- 462 • the front of the middle thighs
- 463 • the outer area of the upper arms
- 464 • the abdomen, except around the navel

465

466

467



468

469

470 You should use a different site each time you inject INTRON A to avoid soreness at
471 any one site. Do not inject INTRON A into an area where the skin is irritated, red,
472 bruised, infected or has scars, stretch marks, or lumps.

473

474 **Injecting your dose of INTRON A**

475

476 1. Clean the injection site with a new alcohol swab.

477

478 2. Pick up the multidose pen from your flat work surface and remove the cap from
479 the needle.

480

481 3. With one hand, pinch a fold of the skin at the cleaned injection site.

482

483 4. With the other hand, hold the multidose pen (like a pencil) at a **45 degree angle**
484 to the skin. Use a quick "dart-like" motion to push the needle into the skin.

485

486

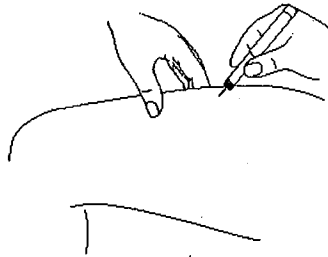

487

488

489 5. After the needle is in, remove the hand used to pinch the skin and use it to hold
490 the pen barrel. If blood comes into the pen reservoir, the needle has entered a
491 blood vessel. **Do not inject INTRON A.** Withdraw the needle and discard the
492 used multidose pen in the puncture-proof container. Contact your healthcare
493 provider. Repeat the steps to prepare for an injection.

494

495 6. If no blood is present in the pen reservoir, inject the medicine by gently pressing
496 the push button all the way down.

497

498 7. Leave the needle in place for a few seconds while holding down the push button.

499

500 8. Slowly release the push button and pull the needle out of the skin.

501

502 9. Place a cotton ball or gauze over the injection site and press for several
503 seconds. Do not massage the injection site. If there is bleeding, cover the
504 injection site with a bandage.

505

506 10. It is important to check your injection site approximately two hours after your
507 injection for redness, swelling, or tenderness. These are signs of inflammation
508 that you may need to talk to your healthcare provider about if they do not go
509 away.

510

511 **Removing the needle from the multidose pen**

512

513 11. Using a scooping motion, carefully replace the outer clear needle cap (like

514 capping a pen).

515

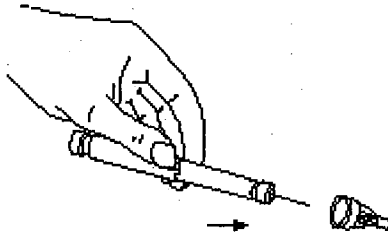

516

517

518 12. Once capped, remove the needle by holding the clear outer needle cap with one

519 hand and holding the pen barrel with the other hand, turning counterclockwise.

520

521

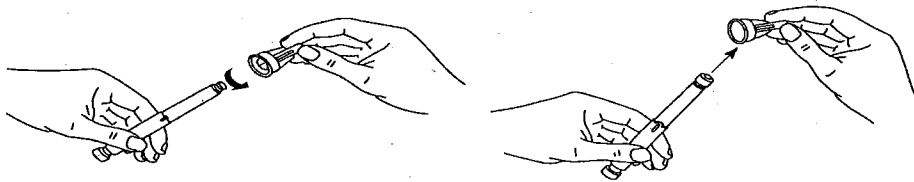

522

523

524 13. Carefully lift the needle off the pen and discard the capped needle. See "*How*

525 *should I dispose of materials used to inject INTRON A?*"

526

527 14. Replace the pen cap over the pen reservoir so that the black triangle is lined up

528 with the dosage indicator.

529

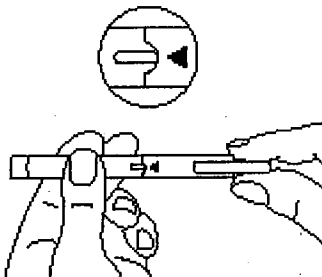

530

531 **Storing INTRON A Solution Multidose Pen for Injection**

532 INTRON A Solution Multidose Pen for Injection should be stored in the refrigerator

533 between 2° and 8°C (36° and 46°F). **DO NOT FREEZE.** Discard any unused

534 INTRON A pen remaining after 4 weeks.

535

536 **How should I dispose of material used to inject INTRON A?**

537

538 There may be special state and local laws for disposal of used needles and
539 multidose pens. Your healthcare provider should provide you with instructions on
540 how to properly dispose of your used needles and multidose pens. Always follow
541 those instructions. The instructions below should be used as a general guide for
542 proper disposal.

543

544 • The needles should never be reused.

545

546 • Place all used needles and multidose pens in a puncture-proof disposable
547 container that is available through your pharmacy or healthcare provider. You
548 may use a hard plastic container with a screw-on cap (like a laundry detergent
549 container). DO NOT use glass or clear plastic containers for disposal of needles.

550

551 • The container should be clearly labeled as "USED NEEDLES AND MULTIDOSE
552 PENS." When the container is about two-thirds full, dispose of the container as
553 instructed by your healthcare provider. DO NOT throw the container in your
554 household trash. DO NOT recycle.

555

556 • **Always keep the container out of the reach of children.**

557

558

559 *Novofine is a registered trademark of Novo Nordisk

560

561

562 Schering Corporation

563 Kenilworth, NJ 07033

564 Copyright© 1996, 2001, Schering Corporation. All rights reserved.

565 U.S. Patent Nos. 5,766,582; 5,935,566; 6,610,830

566 12/05

567 XXXXXXXXT