

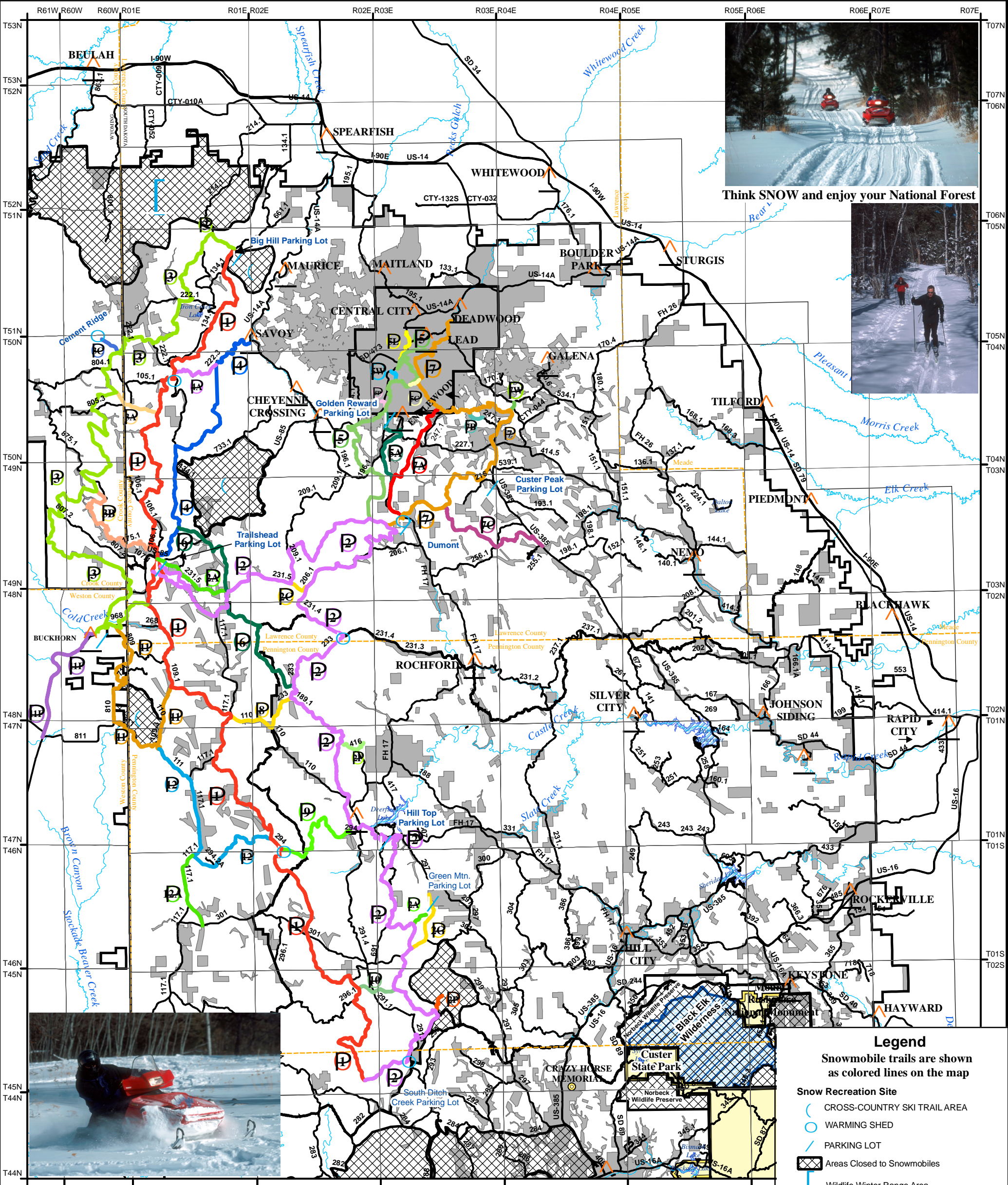

BLACK HILLS NATIONAL FOREST SOUTH DAKOTA AREAS 2006-2007 SNOWMOBILE TRAIL MAP ORDER # 87, APPENDIX A (MAP 1 of 2)

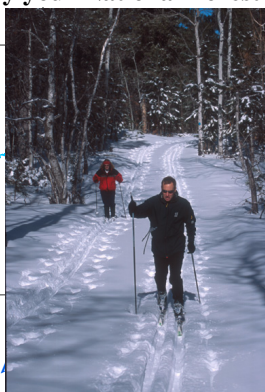

Think SNOW and enjoy your National Forest



Legend

Snowmobile trails are shown as colored lines on the map

Snow Recreation Site

- CROSS-COUNTRY SKI TRAIL AREA
- WARMING SHED
- PARKING LOT
- Areas Closed to Snowmobiles
- Wildlife Winter Range Area

Roads

- Suitable for Passenger Cars
- High Clearance Vehicles Recommended
- Local Cities
- Other Ownership
- Parks/Monuments
- Black Elk Wilderness

0 1 2 3 4 5 Miles

WINTER SPORTS 2006 - 2007

Approximately 350 miles of marked and groomed trails are located on the Black Hills National Forest in South Dakota and Wyoming through a cooperative agreement by the U.S. Forest Service with the South Dakota Parks and Recreation Division and Wyoming State Parks and Historical Sites. Parking areas which serve this trail system are signed, plowed, and have sanitary facilities, maps, and information available. During the designated snowmobile season, the groomed trail system is officially closed to wheeled vehicles.

Some plowed roads and areas are closed to snowmobiles to prevent conflicts with logging traffic, wildlife winter range, and cross country ski trails. These areas and roads are shown on this map and/or marked on the ground.

There may be additional restrictions on the occupancy and use of the National Forest. These restrictions may pertain to campfires, camping, parking, possession of animals, etc. To avoid an inconvenience, you are encouraged to contact a local Forest Service office for current information.



BLACK HILLS NATIONAL FOREST BEARLODGE RANGER DISTRICT 2006-2007 SNOWMOBILE TRAIL MAP ORDER # 87, APPENDIX A (MAP 2 of 2)

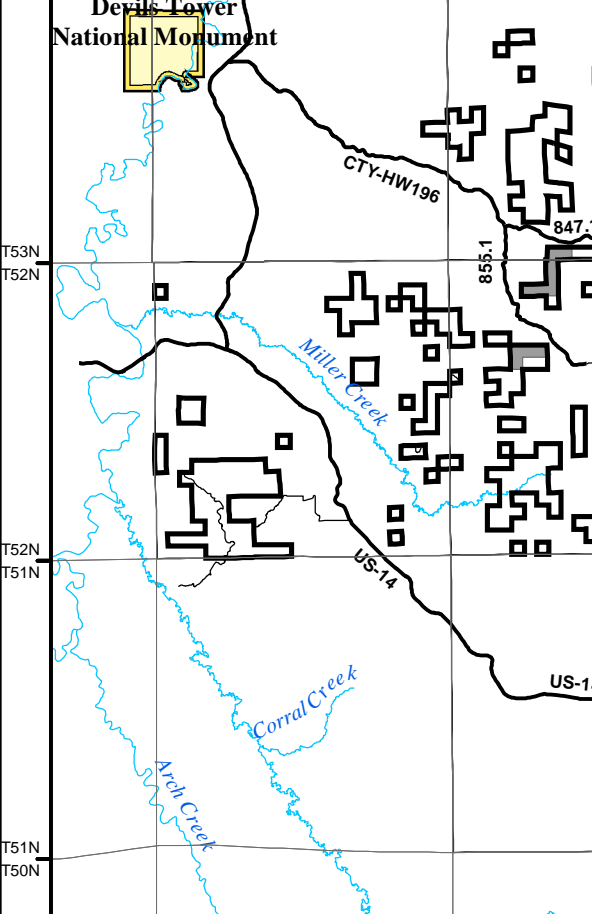
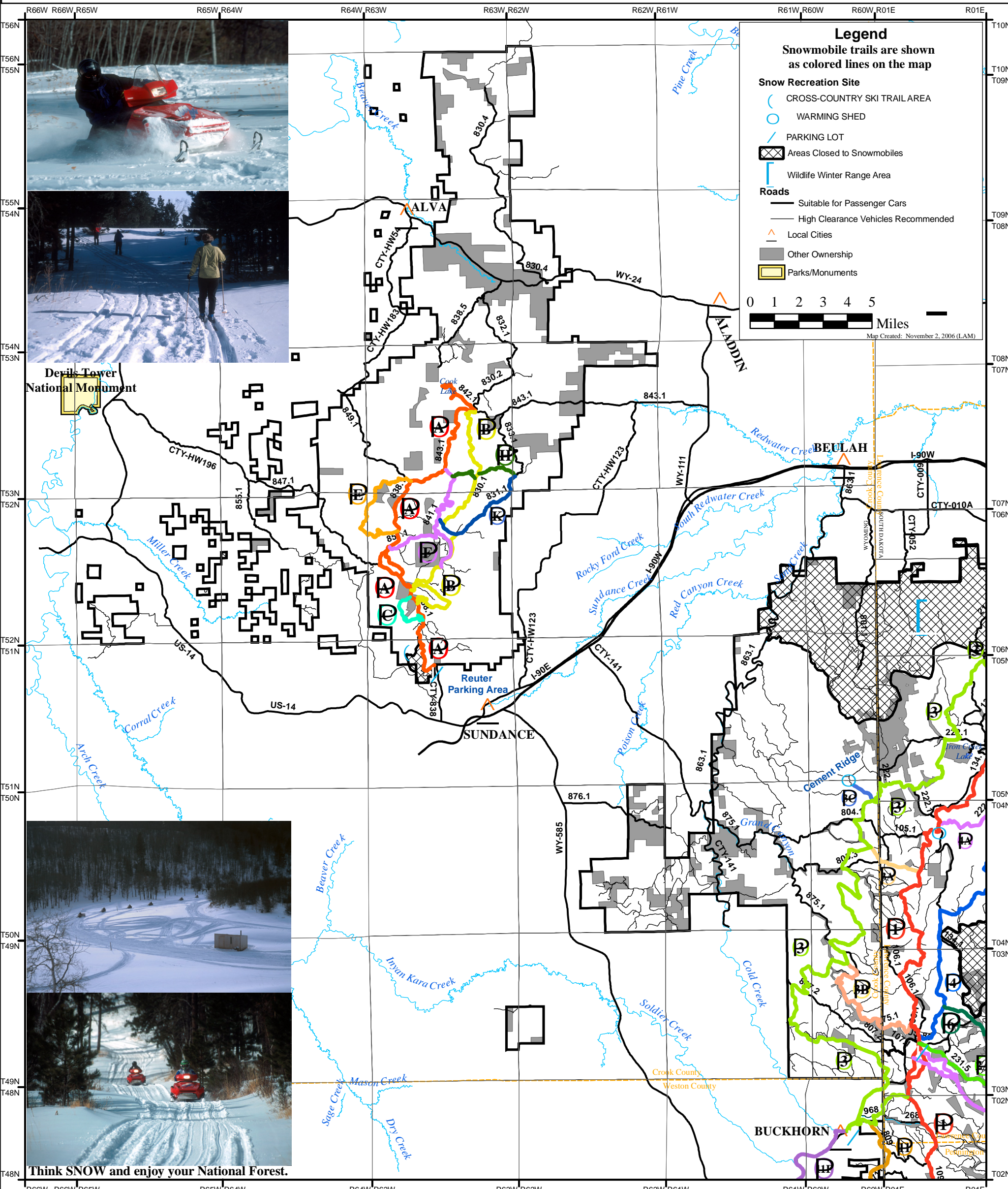

Think SNOW and enjoy your National Forest.

WINTER SPORTS 2006 - 2007

Approximately 350 miles of marked and groomed trails are located on the Black Hills National Forest in South Dakota and Wyoming through a cooperative agreement by the U.S. Forest Service with the South Dakota Parks and Recreation Division and Wyoming State Parks and Historical Sites. Parking areas which serve this trail system are signed, plowed, and have sanitary facilities, maps, and information available. During the designated snowmobile season, the groomed trail system is officially closed to wheeled vehicles.

Some plowed roads and areas are closed to snowmobiles to prevent conflicts with logging traffic, wildlife winter range, and cross country ski trails. These areas and roads are shown on this map and/or marked on the ground.

There may be additional restrictions on the occupancy and use of the National Forest. These restrictions may pertain to campfires, camping, parking, possession of animals, etc. To avoid an inconvenience, you are encouraged to contact a local Forest Service office for current information.



Forest Supervisor's Office
25041 N. Highway 16
Custer, SD 577307239
(605) 673-9200

Bearlodge Ranger District
P.O. Box 680
Sundance, WY 82729
(307) 283-1361

Northern Hills Ranger District
2014 N. Main
Spearfish, SD 57783
(605) 642-4622

Mystic Ranger District
8221 South Highway 16
Rapid City, SD 57702
(605) 343-1567

Hell Canyon Ranger District
330 Mt. Rushmore Road
Custer, SD 57730
(605) 673-4853

Hell Canyon Ranger District
1225 Washington Boulevard
Newcastle, WY 82701
(307) 746-4622