

HELENA NATIONAL FOREST - LINCOLN RANGER DISTRICT  
2880 Skyway Drive  
Helena, MT 59602  
Forest Supervisor's Order

**EMERGENCY ORDER for USE OF VEHICLES  
NATIONAL FOREST SYSTEM ROADS and TRAILS  
Stonewall Trail Closure/Lincoln Ranger District**

Pursuant to Title 36 Code of Federal Regulations 261.50(b), the following restriction is in effect on the Helena National Forest. These restrictions are in addition to those enumerated in Subpart A, Part 261, Title 36, Code of Federal Regulations, become effective when signed and remain in effect until rescinded.

**36CFR 261.55(b) – Forest Development Trails.**

**When provided by an order, the following are prohibited: using any type of vehicle prohibited by the order. [Title 36, 261.55(b)]**

For the purpose of this order it is prohibited to operate a motor vehicle on Helena National Forest lands on the Stonewall Trail #417 as depicted in the map, Attachment A, hereby made part of this order. The reason for this order is to provide for public safety during the rehabilitation/reconstruction of FS Trail #417. The legal description for this closure is: T15N, R8W sections 19, 20, and 29 and T15N R9W sections 14, 23, and 24. The closure does not include FS Road 1821.

Definitions: Vehicles (including cars, trucks, all-terrain vehicles which include 3-wheelers, 4-wheelers, 6-wheelers and motorcycles) means any device in upon, or by which any person or property may be transported, including any frame, chassis, or body of any motor vehicle.

**Exemptions:**

Pursuant to Title 36 CFR 261.50(e), the following are exempt from this order:

1. Any person with a permit authorizing the otherwise prohibited act or omission.
2. Any Federal, State, or local officer, or member of an organized rescue or fighting force in the performance of an official duty.

---

Done this 9<sup>th</sup> day of July, 2007.

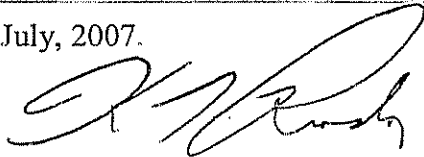

---

KEVIN T. RIORDAN  
Forest Supervisor

**Penalty:**

Violations of these prohibitions are punishable by a fine of not more than \$5,000 for an individual or \$10,000 for an organization, or imprisonment for not more than six months, or both [16 U.S.C. 551, and 18 U.S.C. 3559 and 3571].

**Notification:**

A copy of this order shall be posted as prescribed under 36 CFR 261.51

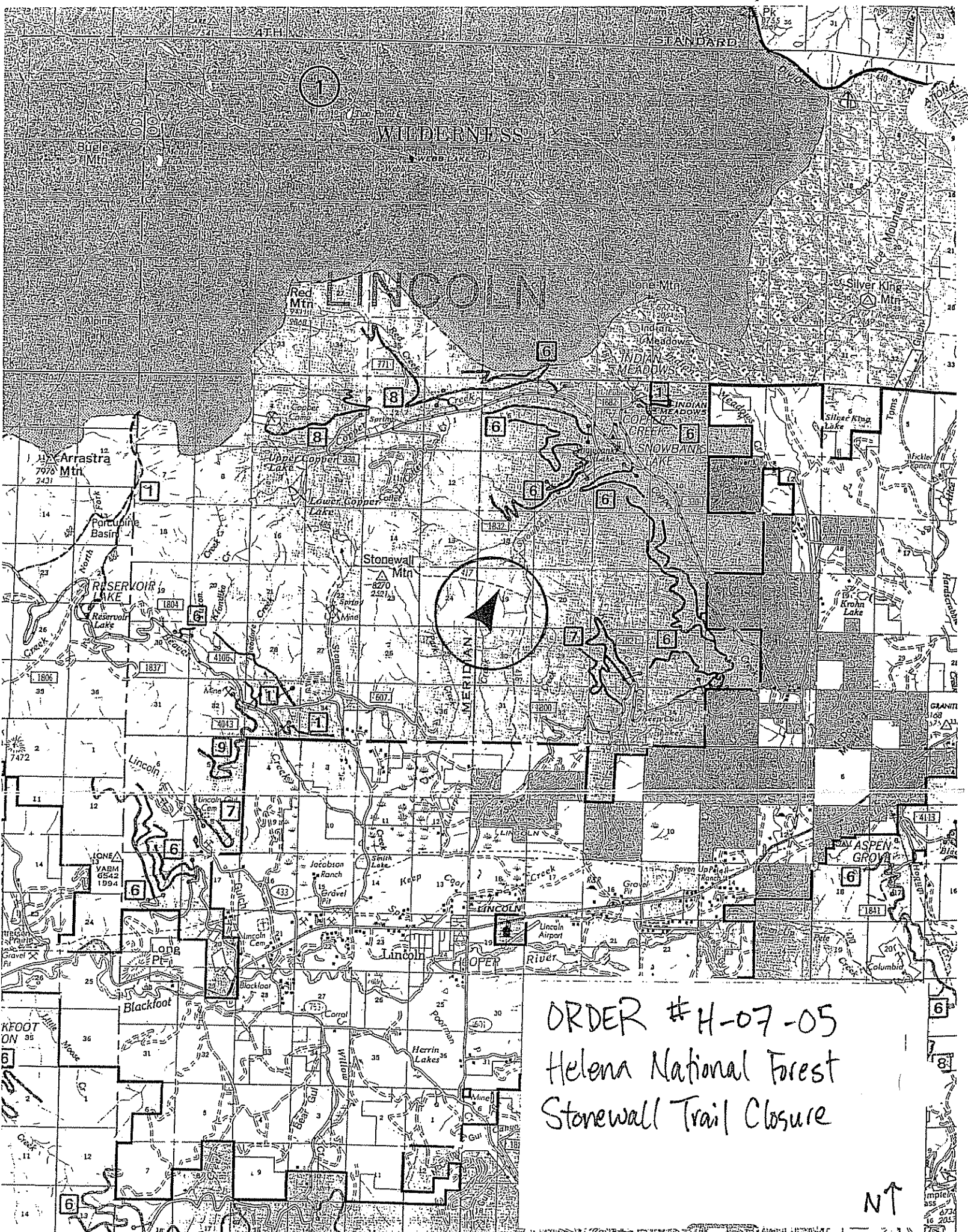

WILDERNESS

1

LINCOLN

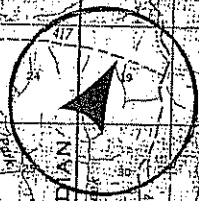

ORDER # H-07-05  
Helena National Forest  
Stonewall Trail Closure

NT

Imp  
555 872  
16 2013

HELENA NATIONAL FOREST  
LINCOLN RANGER DISTRICT  
2880 Skyway Drive  
Helena, MT 59602  
Forest Supervisor's Order

**RESINDING ORDER**

Pursuant to the Title 36, Code of Federal Regulations, Part 261.50, Special Restriction Order HNF-07-05 for the Helena National Forest dated July 9<sup>th</sup>, 2007, and signed by the Forest Supervisor is hereby rescinded.

Signed this 1<sup>st</sup> day of Aug, 2007.



*for* KEVIN T. RIORDAN  
Forest Supervisor

---