

RECEIVED 2280  
JUL - 2 2008

772

### National Register of Historic Places Registration Form

This form is for use in nominating or requesting determinations for individual properties and districts. See instructions in *National Register of Historic Places Registration Form* (National Register Bulletin 16A). Complete each item by marking "x" in the appropriate box. Enter the information requested. If an item does not apply to the property being documented, enter "N/A" for "not applicable." For functions, architectural classification, materials, and areas of significance, enter only categories and subcategories from the instructions. Place additional entries and narrative items on continuation sheets (NPS Form 10-900a). Use a typewriter, word processor, or computer to complete all items.

#### 1. Name of Property

historic name Cobblestone Farmhouse at 1229 Birdsey Road  
other names/site number \_\_\_\_\_

#### 2. Location

street & number 1229 Birdsey Road [ ] not for publication  
town Junius [ ] vicinity  
state New York code NY county Seneca code 099 zip code 13165

#### 3. State/Federal Agency Certification

As the designated authority under the National Historic Preservation Act, as amended, I hereby certify that this [ X ] nomination [ ] request for determination of eligibility meets the documentation standards for registering properties in the National Register of Historic Places and meets the procedural and professional requirements as set forth in 36 CFR Part 60. In my opinion, the property [ X ] meets [ ] does not meet the National Register criteria. I recommend that this property be considered significant [ ] nationally [ ] statewide [ X ] locally. ([ ] see continuation sheet for additional comments.)

Richard Perpoint DSHPO 6/23/08  
Signature of certifying official Title: Commissioner for Historic Preservation Date  
New York State Office of Parks, Recreation & Historic Preservation

In my opinion, the property [ ] meets [ ] does not meet the National Register criteria. ([ ] see continuation sheet for additional comments.)

\_\_\_\_\_  
Signature of certifying official/Title Date  
\_\_\_\_\_  
State or Federal agency and bureau

#### 4. National Park Service Certification

I hereby certify that the property is:  
 entered in the National Register [ ] see continuation sheet  
 determined eligible for the National Register [ ] see continuation sheet  
 determined not eligible for the National Register  
 removed from the National Register  
 other (explain)

Edson H. Ball 8-6-08  
Signature of the Keeper date of action

**Cobblestone Farmhouse at 1229 Birdsey Road  
Junius, Seneca County, New York**

**5. Classification**

**Ownership of Property**  
(check as many boxes as apply)

- private
- public-local
- public-State
- public-Federal

**Category of Property**  
(Check only one box)

- building(s)
- district
- site
- structure
- object

**Number of Resources within Property**  
(Do not include previously listed resources in the count)

Contributing	Non-contributing	
<u>  2  </u>	<u>  1  </u>	buildings
<u>          </u>	<u>          </u>	sites
<u>          </u>	<u>          </u>	structures
<u>          </u>	<u>          </u>	objects
<u>  2  </u>	<u>  1  </u>	<b>TOTAL</b>

**Name of related multiple property listing**  
(Enter "N/A" if property is not part of a multiple property listing)

**Number of contributing resources previously listed in the National Register**

Cobblestone Architecture of New York State

NA

**6. Function or Use**

**Historic Functions**  
(enter categories from instructions)

DOMESTIC; single dwelling

**Current Functions**  
(Enter categories from instructions)

DOMESTIC; single dwelling

**7. Description**

**Architectural Classification**  
(Enter categories from instructions)

Mid-19<sup>th</sup> Century: Greek Revival

**Materials**  
(Enter categories from instructions)

foundation   stone    
walls   cobblestone    
roof   asphalt shingles    
other                                   

**Narrative Description**

(Describe the historic and current condition of the property on one or more continuation sheets)

**8. Statement of Significance**

**Applicable National Register Criteria**

(Mark "x" in one or more boxes for the criteria qualifying the property for National Register listing.)

- A** Property associated with events that have made a significant contribution to the broad patterns of our history.
- B** Property is associated with the lives of persons significant in our past.
- C** Property embodies the distinctive characteristics of a type, period, or method of construction or represents the work of a master, or possesses high artistic values, or represents a significant and distinguishable entity whose components lack individual distinction.
- D** Property has yielded, or is likely to yield, information important in prehistory or history.

**Criteria Considerations**

(Mark "x" in all boxes that apply.)

- A** owned by a religious institution or used for religious purposes.
- B** removed from its original location
- C** a birthplace or grave
- D** a cemetery
- E** a reconstructed building, object, or structure
- F** a commemorative property
- G** less than 50 years of age or achieved significance within the past 50 years

**Narrative Statement of Significance:** See continuation sheets

**Areas of Significance:**

(Enter categories from instructions)

Architecture

**Period of Significance:**

ca. 1830/40s - 1900

**Significant Dates:**

Ca. 1830s

**Significant Person:**

NA

**Cultural Affiliation:**

NA

**Architect/Builder:**

unknown

**9. Major Bibliographical References**

*American Life in Seneca County, 1820-1880.* Waterloo: Seneca County Historian's Office, 2006.  
*Atlas of Seneca County, 1874.* Philadelphia, PA: Pomeroy, Whitman & Company.  
*History of Seneca County.* Philadelphia: Ensign and Everts, 1876.

**Previous documentation on file (NPS):**

- preliminary determination of individual listing (36 CFR 67) has been requested.
- previously listed in the National Register
- previously determined eligible by the National Register
- designated a National Historic Landmark
- recorded by historic American Building Survey # \_\_\_\_\_
- recorded by Historic American Engineering Record # \_\_\_\_\_

**Primary location of additional data:**

- State Historic Preservation Office
- Other State agency
- Federal Agency
- Local Government
- University
- Other repository: \_\_\_\_\_

Office of the Seneca County Historian

---

## 10. Geographical Data

---

Acreage of Property 12 acres

UTM References: Zone 18

1: 348061/4758851

2: 348072/4758731

3: 347881/4758703

4: 347865/4758854

**Verbal Boundary Description:** The boundary of the nominated property coincides with the legal lot lines as delineated on the attached county tax map (12-1-12.112).

**Boundary Justification:** The boundary coincides with the full extent of land historically and currently associated with the nominated resource.

---

## 11. Form Prepared By:

---

name/title Nancy L. Todd, Program Analyst

organization Division for Historic Preservation

date June 2008

street & number Peebles Island, Box 189

telephone (518) 237-8643 x 3262

city or town Waterford

state NY zip code 12188

### Additional Documentation

Submit the following items with the completed form:

### Continuation Sheets

#### Maps

A **USGS map** (7.5 or 15 minute series) indicating the property's location

A **Sketch map** for historic districts and properties having large acreage or numerous resources.

#### Photographs

Representative **black and white photographs** of the property.

### Property Owner (Complete this item at the request of the SHPO or FPO)

name \_\_\_\_\_

street & number \_\_\_\_\_ telephone \_\_\_\_\_

city or town \_\_\_\_\_ state \_\_\_\_\_ zip code \_\_\_\_\_

---

**United States Department of the Interior  
National Park Service  
National Register of Historic Places**

**Cobblestone Farmhouse at 1229 Birdsey Road  
Junius, Seneca County, NY**

Continuation Sheet

Section 7 Page 1

---

**Description**

The Cobblestone Farmhouse at 1229 Birdsey Road is located on the east side of Birdsey Road in the predominantly rural town of Junius in northwest Seneca County. The cobblestone farmhouse is located on a 12-acre farm (a small portion of the former 100-acre farmstead) characterized by relatively flat terrain, small cultivated fields and scattered copses of deciduous and evergreen trees. The farmhouse is complemented by a large, late-nineteenth century frame barn; all other farm-related support structures have been lost. The farm is surrounded by scattered working farms and a few modern houses, including three small modern ranch houses to the north and one altered, older farmhouse across the road. Also located on the property is a non-contributing, early 20<sup>th</sup> century corrugated metal garage/machine shed. Despite its proximity to the New York State Thruway, its quiet, rural character survives essentially intact.

The house is a two-story, five-bay-wide, center-hall cobblestone building with Greek Revival style details. Brick interior end chimneys pierce the gable roof, which is sheathed with modern shingles. The superstructure, oriented on a north-south axis, rests on a raised fieldstone foundation articulated by a limestone water table. The walls are constructed of irregularly sized (2" to 3" wide and 3" to 4" tall) and variously colored field cobbles laid on a slight diagonal with simply tooled "V" joints between stones. Smoothly hewn, untooled limestone quoins stabilize the corners of the building and smooth stone lintels and sills articulate the door and window openings. Fenestration is symmetrical on the main block; all window openings are rectangular and contain modern, 6/1 double-hung sash.

The centrally placed front entrance is sheltered under a one-story, hip-roofed porch with late 19<sup>th</sup> century Victorian details, including elegant, scroll-sawn brackets. The trabeated front door is surrounded by simple, Greek Revival features, including half side-lights, simple wood panels, and square pilasters. A one-story, gable-roofed former kitchen wing, oriented on an east-west axis, is attached to the east (side) elevation of the main block.

The interior of the main block features an intact, double-pile plan with a central staircase providing access to the second story. Simple Greek Revival style features, including wood trim around door and window openings, also survive in the main block.

A large, gable-roofed frame barn, believed to date from the late 1800s, is located north of the house. It is sheathed with vertical board siding. A modern machine shed/garage is located behind the house.

United States Department of the Interior  
National Park Service  
National Register of Historic Places

**Cobblestone Farmhouse at 1229 Birdsey Road  
Junius, Seneca County, NY**

Continuation Sheet

Section 8 Page 1

---

---

**Significance**

The Cobblestone Farmhouse at 1229 Birdsey Road, believed to date from the 1830/40s, is architecturally significant as a substantially intact, representative example of the cobblestone method of construction in Seneca County, New York. The building embodies the distinctive characteristics of the cobblestone method of construction (as discussed at length in the National Register Multiple Property Documentation Form [MPDF] *Cobblestone Architecture in New York State* [1992]) in the use of field cobbles laid in horizontal rows and bonded with limestone mortar, the use of stone quoins to decorate and stabilize the corners of the building, and the use of stone sills and lintels to ornament and reinforce door and window openings. Typical of vernacular cobblestone buildings executed during the Middle Period (ca. 1835 – ca. 1845) of this particular method of construction, the dwelling features fairly regularly shaped, and variously colored field cobbles roughly laid in rows of between 3 to 4 courses per quoin; the smoothly hewn limestone quoins are untooled. Also typical of vernacular buildings of the Middle Period are the simply hewn stone lintels and sills around door and window openings. The house is additionally significant under criterion C as an outstanding example of vernacular, Greek Revival style domestic architecture in Seneca County.

According to a survey of cobblestone buildings in New York State, conducted by retired engineer Robert Roudabush in the late 1970s/early 1980s, there were some 500-600 cobblestone buildings that survived at the time. In May 1979, Roudabush found approximately 20 cobblestone buildings in Seneca County; most were farmhouses. Also found were a barn, a smokehouse and a hog house. Subsequent investigation suggests that by the early twenty-first century, only about 18 of those 20 survive; of the survivors, only 12-14 appear to retain a relatively high degree of physical integrity. The nominated farmhouse, one of several cobblestone buildings in Junius, is a remarkably intact example of a cobblestone farmhouse executed in the Greek Revival style. In terms of integrity of design, material and craftsmanship associated with the primary components of the cobblestone method of construction, the dwelling is highly intact: all cobblestone walls and stone quoins and door and window lintels and sills are virtually intact to the early nineteenth century date of construction. Its wide, flat-arched stone lintels, exaggerated cornice returns, and trabeated main entrance distinguish it as a fine example of vernacular, Greek Revival style architecture in Seneca County.

**United States Department of the Interior  
National Park Service  
National Register of Historic Places**

**Cobblestone Farmhouse at 1229 Birdsey Road  
Junius, Seneca County, NY**

**Continuation Sheet**

**Section 8 Page 2**

---

---

As is often the case with rural vernacular farmhouses built in the region, little is known about the builder of this cobblestone house or the first/early occupants of the property. Recent research by Walter Gable, Seneca County Historian, and the current owners of the property reveals that a Josiah B. Porter acquired the property on March 7, 1828. In 1842, the property is believed to have been owned by a John Serven. The 1874 *Atlas* indicates the owner as an "M. Story," about whom nothing is known. Regardless of the lack of historical information about the property per se, the house is nonetheless an outstanding example of the cobblestone method of construction in the Finger Lakes region of the state. Similarly, although no information is available about the specific agricultural history of the former farm (and, thus, cannot be justified under criterion A), the complementary barn is significant as an intact, representative example of building technique popular for farm buildings during the nineteenth century in its form, design and materials.

United States Department of the Interior  
National Park Service

National Register of Historic Places  
Continuation Sheet

Cobblestone Farmhouse at 1229 Birdsey Road  
Junius, Seneca County, NY

Section additional documentation Page 1

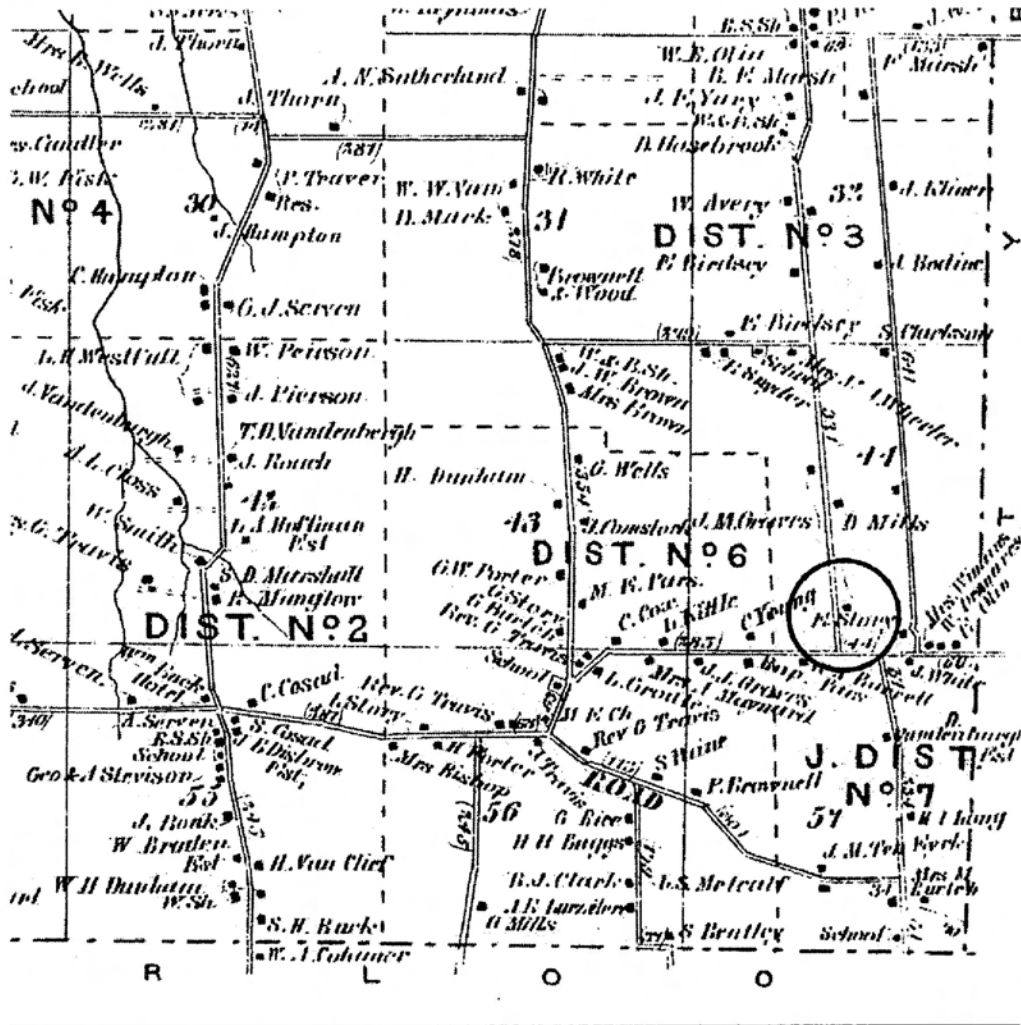

Atlas of Seneca County, 1874



**United States Department of the Interior  
National Park Service**

**National Register of Historic Places  
Continuation Sheet**

**Cobblestone Farmhouse at 1229 Birdsey Road  
Junius, Seneca County, NY**

Section additional documentation Page 2

---

---

**Photo Key**

All digital photos by Nancy L. Todd, 2007, OPRHP

- 1: Front (west) and south façades
- 2: Detail of Victorian trim on front porch
- 3: Detail of quoins and cobblestones
- 4: View of house and barn from southwest
5. Barn, viewed from south

02-108375

10.2  
42343-108350  
2.5 AC  
25.1  
256  
142  
462  
1.8 A  
42380-108350  
25.2  
23  
2.2A(C)  
42380-108340  
200  
661.41  
659.21  
797.76

13.5A (C)  
11  
42450-108357  
766.68

12-1-12.112

6.9A (C)  
24  
42380-108300  
415 (S)

716.42  
ADLER ROAD (49.5 WIDE)

2.4A (C)  
10.112  
42360-108275  
150  
2.5A (C)  
10.12  
42360-108260  
150

179  
197.48  
100  
129.81  
130.61  
170.0  
12.2  
198.11  
129.81  
22.2  
191.5  
191.5  
48.52  
42436-108294  
42450-108296  
42478-108300

435.5  
200  
2.0 AC  
42530-108285  
22.2  
200  
435.5

SEE SECTION MAP

30.0 A (C)  
10.111  
42384-108216  
3111.57  
900 (S)  
901 (S)  
750 (S)

42440-108210  
42440-108202  
42441-108191  
13.1  
175.25  
13.2  
14.8  
175.25

82.0 AC  
22.11  
42543-108185

44

420.75  
482.85  
4.8 A (C)  
26  
42406-108155  
414.00  
445.50  
49.5 WIDE  
12.111  
42443-108174

12.0 A (C)  
12.112  
42484-108116  
746.56  
581.48  
525.78  
638.06  
890 (S)  
530 (S)

3.6A (C)  
42603-108115  
720 (S)  
1.7  
1.6

THRUWAY

17.8A (C)  
17  
42578-108083

Cobblestone House at 1229 Birdsey Rd  
Junius, Seneca County  
Heavy Black outline defines  
boundary of nominated  
property

Tas map 12-1-12.112  
1" = 400'

426000 E  
+1080000 N



Cobblestone Farmhouse at 1229  
Birdsey Rd

Junius, Seneca Co., NY

1



Cobblestone House at 1229  
Birdsey Rd

Junius, Seneca Co., NY

2

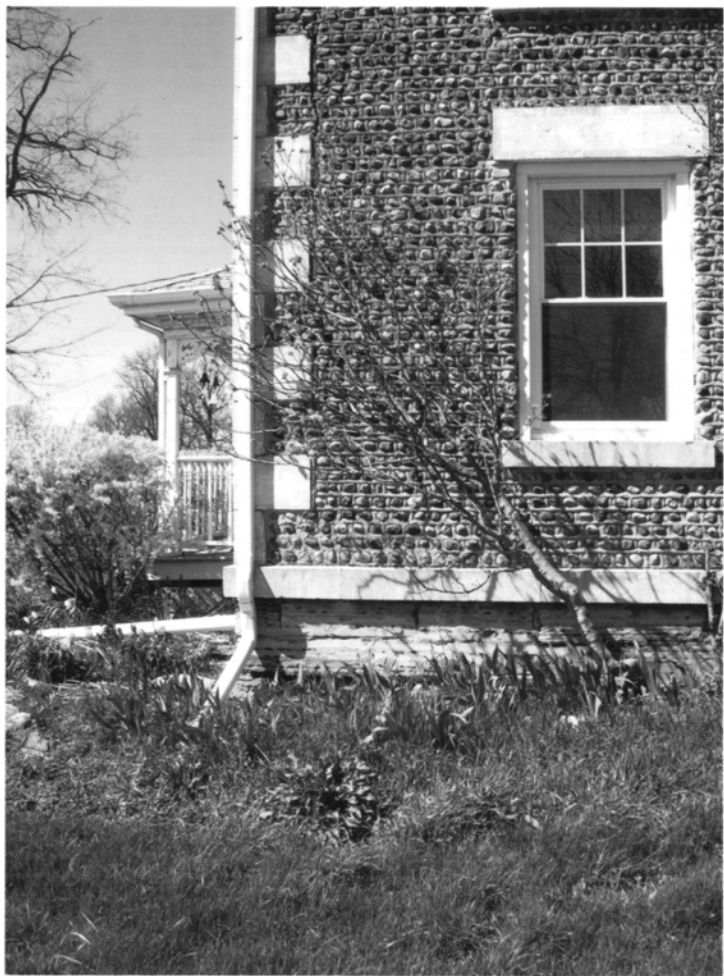

Cobblestone Farmhouse at  
1229 Birdsey Rd

Junius, Seneca Co., NY

3





Cobblestone Farmhouse at

1229 Birdsey Rd

Junius, Seneca Co, NY

4



Cobblestone Farmhouse at

1229 Birdsey Rd

Junius, Seneca Co. NY

5