



DISASTER ACCIDENT REPORT FACTS

U.S. Department of Labor ! Occupational Safety and Health Administration ! Kansas City Region VII No. 20

ACCIDENT SUMMARY

Accident Type: Fall

Weather Conditions: Clear

Type of Company: Roofing Contractor
Residential Construction

Size of Work Crew: 4

Union or Non-Union: Non-union

Worksite Inspections Conducted: Yes

Designated Competent Person on Site: No

Employer Safety and Health Program: Yes

Training and Education for Employees: Yes

Craft of Deceased Employee: Roofer/Laborer

Age/Sex: 19/Male

Time on the Job: 3 days

Time at the Task: 1 day

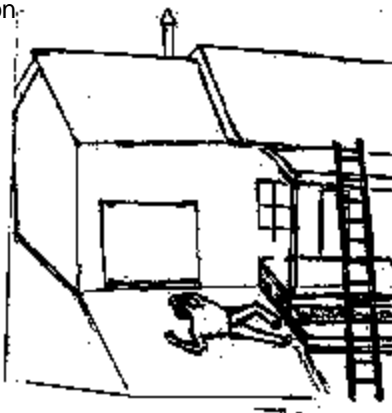

SOURCES OF HELP

g OSHA standards, regulations, documents and technical information are available on the Internet World Wide Web at <http://www.OSHA.gov/>. That information also is on CD-ROM, which may be purchased from the Government Printing Office, phone (202) 512-1800 or fax (202) 512-2250, Order No. 729-13-00000-5; cost \$79 annually; \$28 quarterly.

g For hard copies of OSHA Construction Standards [29 CFR Part 1926], which include all OSHA job safety and health rules and regulations covering construction, contact Government Printing Office, phone (202) 512-1800, fax (202) 512-2250, order number 869-022-00114-1, \$33.

g OSHA-funded free consultation services listed in telephone directories under U.S. Labor Department or under the state government section where states administer their own OSHA programs.

g OSHA Safety and Health Training Guidelines for Construction, Volume III (Available from the National Technical Information Service, 5285 Port Royal Road, Springfield, VA 22161; phone (703)487-4650; Order No. PB-239-312/AS, \$25 to help construction employers establish a training program.

g Courses in construction safety are offered by the OSHA Training Institute, 1555 Times Drive, Des Plaines, IL 60018, (847) 297-4810, and the Metropolitan Community Colleges Business & Technology Center, 6899 Executive Drive, Kansas City, MO 64120, (816) 482-5210.

BRIEF DESCRIPTION OF ACCIDENT

Police reports indicate that the employee fell from the porch to the ground approximately two feet. It is unknown how the employee fell. The employee was working on the roof but was sent down to get a hammer. The employee was last seen descending the ladder. The employee was a laborer and had been working for the company for three days. The company was in the process of re-roofing the house.

ACCIDENT PREVENTION RECOMMENDATIONS

1. The cause of the accident is unknown. A contributing factor may have been not keeping the worksite clear of all fall and tripping hazards.

2. Use an appropriate fall protection system or alternative protection procedures when conducting roofing operations.
 3. Train employees in fall protection procedures and the safe use of ladders.
-

Note: This case described was selected as being representative of improper work practices which likely contributed to a fatality from a fall and/or electrocution. The accident prevention recommendations do not necessarily reflect the outcome of the legal aspects of the incident case. Your company or organization is eligible to receive one free copy of this leaflet which you may duplicate and share with your co-workers. To be placed on the distribution list, send your name, title and address to: U.S. Department of Labor - OSHA, 1100 Main, Suite 800, Kansas City, MO 64105, Attn. TECFAP, or e-mail to dearing-cynthia@dol.gov.