

Motor Vehicle Use Map

2007-2008

Black Kettle and McClellan Creek National Grasslands



America's Great Outdoors

OKLAHOMA and TEXAS 2007-2008

Forest  Service

United States Department of Agriculture

Black Kettle and McClellan Creek
National Grasslands
Route 1, Box 55-B
Cheyenne, Oklahoma 73628-9725
(580) 497-2143

Black Kettle and McClellan Creek Motor Vehicle Use Map 2007 - 2008



THE PURPOSE AND CONTENTS OF THIS MAP

This map dated 09/30/2007 shows the National Forest System roads, National Forest System trails, and the areas on National Forest System lands in the Black Kettle and McClellan Creek National Grasslands, administered by the Cibola National Forest that are designated for motor vehicle use pursuant to 36 Code of Federal Regulations (CFR) 212.51. The map contains a list of those designated roads and trails that enumerates the types of vehicles allowed on each route and in each area and any seasonal restrictions that apply on those routes and in those areas.

Designation of a road, trail, or area for motor vehicle use by a particular class of vehicle under 36 CFR 212.51 should not be interpreted as encouraging or inviting use, or to imply that the road, trail, or area is passable, actively maintained, or safe for travel. Motor vehicle designations include parking along designated routes and at facilities associated with designated routes when it is safe to do so and when not causing damage to National Forest System resources. Seasonal weather conditions and natural events may render designated roads and trails impassable for extended periods. Designated areas may contain dangerous or impassable terrain. Many designated roads and trails may be passable only by high-clearance vehicles or four-wheel drive vehicles. Maintenance of designated roads and trails will depend on available resources, and many may receive little maintenance.

This motor vehicle use map (MVUM) identifies those roads and trails designated for the motor vehicle use under 36 CFR 212.51 for the purpose of enforcing the prohibition at 36 CFR 261.13. This is a limited purpose. The other public roads are shown for information and navigation purposes only and are not subject to designation under the Forest Service travel management regulation.

These designations apply only to National Forest System roads, National Forest trails, and areas on National Forest System lands.

Several designated roads on the Black Kettle National Grasslands can only be accessed by private lands on private roads, which are not shown on this map. To travel to these areas you must obtain permission from the property owners. Only public roads are shown on this map.

PROHIBITIONS

It is prohibited to possess or operate a motor vehicle on National Forest System lands on the Black Kettle and McClellan Creek National Grasslands other than in accordance with these designations (36 CFR 261.13).

Violations of 36 CFR 261.13 are subject to a fine of up to \$5,000 or imprisonment for up to 6 months or both (18 U.S.C. 3571(e)). This prohibition applies regardless of the presence or absence of signs.

This map does not display non motorized uses, over-snow uses, or other facilities and attractions on the Black Kettle and McClellan Creek National Grasslands. Obtain a forest visitor map for more complete information.

Designated roads and trails may also be subject to temporary, emergency closures, and visitors must comply with signs notifying them of such restrictions. A national forest may issue an order to close a road, trail, or area on a temporary basis to protect the life, health, or safety of forest visitors or the natural or cultural resources in these areas. Such temporary and/or emergency closures are consistent with the Travel Management Rule (36 CFR 212.52 (b); 36 CFR 261 subpart B).

The designation "road or trail open to all motor vehicles" does not supercede vehicle size or weight limits imposed through State traffic law.

Important:

There are no areas designated for cross country travel off the designated road and trail system in the Black Kettle and McClellan Creek National Grasslands.

McClellan Creek National Grasslands:

In March 2006, a large wildfire in the Lake McClellan area killed many trees adjacent to roads and trails. Until the hazardous trees have been removed the off highway vehicle (OHV) trails and roads south of the lake are closed for 2007-2008, and not shown as designated routes in this edition of the map. The closed roads are south west of East Bluff Campground #1 and include B553D, B553F, B553G and the southwest portion of B553. These roads and trails will be designated for use on a future edition of the MVUM after the hazardous trees have been removed.

Black Kettle and McClellan Creek Motor Vehicle Use Map 2007 - 2008



OPERATOR RESPONSIBILITIES

Operating a motor vehicle on National Forest System roads and National Forest System trails on National Forest System lands carries a greater responsibility than operating that vehicle in a city or other developed setting. Not only must the motor vehicle operators know and follow all applicable traffic laws, but they need to show concern for the environment as well as other forest users. The misuse of motor vehicles can lead to the temporary or permanent closure of any designated road or trail. Operators of motor vehicles are subject to State traffic law, including State requirements for licensing, registration, and operation of the vehicle in question.

Motor vehicle use, especially off-highway vehicle use, involves inherent risks that may cause property damage, serious injury, and possibly death to participants. Riders should drive cautiously and anticipate rough surfaces and features such as snow, mud, vegetation, and water crossings common to remote driving conditions. Participants voluntarily assume full responsibility for these

damages, risks, and dangers. Motor vehicle operators should take care at all times to protect themselves and those under their responsibility.

Operators visiting the Black Kettle and McClellan Creek National Grasslands should take adequate food, water, first aid supplies, and other equipment appropriate for the conditions and expected weather.

ALWAYS REMEMBER TO RESPECT PRIVATE LAND! PROTECT YOUR PRIVILEGE. STAY ON DESIGNATED ROADS AND TRAILS.

You should read and understand this map in its entirety. If you have questions, please contact the Black Kettle and McClellan Creek National Grasslands office in Cheyenne for clarification.

Road and trail users must comply with this map, as well as all Federal, State, and local laws and regulations. Compliance with these rules is the responsibility of the user.

This map will be reprinted annually. It is the operator's responsibility to obtain a current map.

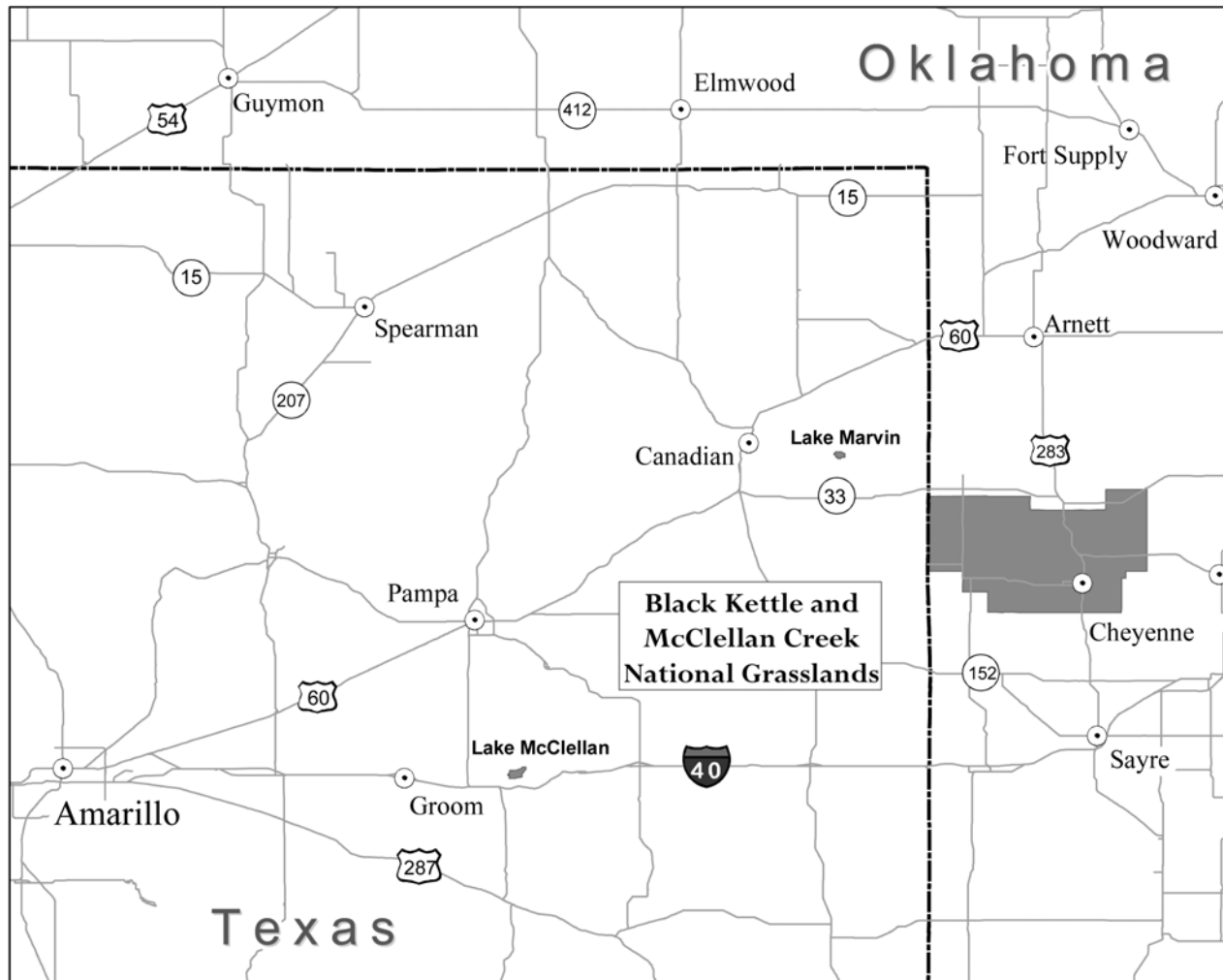

Black Kettle and McClellan Creek Motor Vehicle Use Map 2007 - 2008



Important:

There are no areas designated for cross country travel off the designated road and trail system in the Black Kettle and McClellan Creek National Grasslands.

tread lightly![®]

LEAVING A GOOD IMPRESSION



Travel & recreate with minimum impact. Respect the environment and the rights of others. Educate yourself-plan and prepare before you go. Allow for future use of the outdoors, by leaving it better than you found it. Discover the rewards of responsible recreation. For more information on Tread Lightly!, go to www.treadlightly.org or call 1-800-966-9900.

CIVIL RIGHTS

The U.S. Department of Agriculture (USDA) prohibits discrimination in all its programs and activities on the basis of race, color national origin, age disability, and where applicable, sex, marital status, familial status, parental status, religion, sexual orientation, genetic information, political beliefs, reprisal, or because all or part of an individual's income is derived from any public assistance program. (Not all prohibited bases apply to all programs.) Persons with disabilities who require alternative means for communication of program information (Braille, large print, audiotape, etc.) should contact USDA's TARGET Center at (202) 720-2600 (voice and TDD). To file a complaint of discrimination, write to USDA, Director, Office of Civil Rights, 1400 Independence Avenue, S.W., Washington, D.C. 20250-9410, or call (800) 795-3272 (voice) or (202) 720-6382 (TDD). USDA is an equal opportunity provider and employer.

EXPLANATION OF LEGEND ITEMS

Roads Open to Highway Legal Vehicles Only:

These roads are open only to motor vehicles licensed under State law for general operation on all public roads within the State.

Trails Open to Vehicles 55" or Less in Width:

These trails are open to only motor vehicles less than 55 inches in width at the widest point on the vehicle. (All trails are located in the Lake McClellan area. These trails were not designated for use in this edition, due to hazards resulting from the 2006 fire.)

Seasonal Designation:

This symbol, used in conjunction with one of the other road or trail symbols, indicates that the road or trail is open only during certain portions of the year. Refer to the Seasonal and Special Designation Table for further instructions.

Motorized Trail Access:



This symbol indicates a trail head for access to a motorized route. Not all motorized routes have trail heads and those that do may range from primitive to developed. (The motorized trailhead is located in the Lake McClellan area. This trailhead was not designated for use in this edition, due to hazards resulting from the 2006 fire.)

Seasonal and Special Vehicle Designations

Route Number	Legend	Special Vehicle Designation	Dates Allowed	Beginning Mile Post	Ending Mile Post
B70B	Roads open to highway legal vehicles only, with Seasonal Designations	Seasonal Designation	6/16 – 9/14	0.0200	0.437
B107	Roads open to highway legal vehicles only, with Seasonal Designations	Seasonal Designation	6/16 – 9/14	0.0368	1.235

Black Kettle and McClellan Creek National Grasslands Motor Vehicle Use Map Index

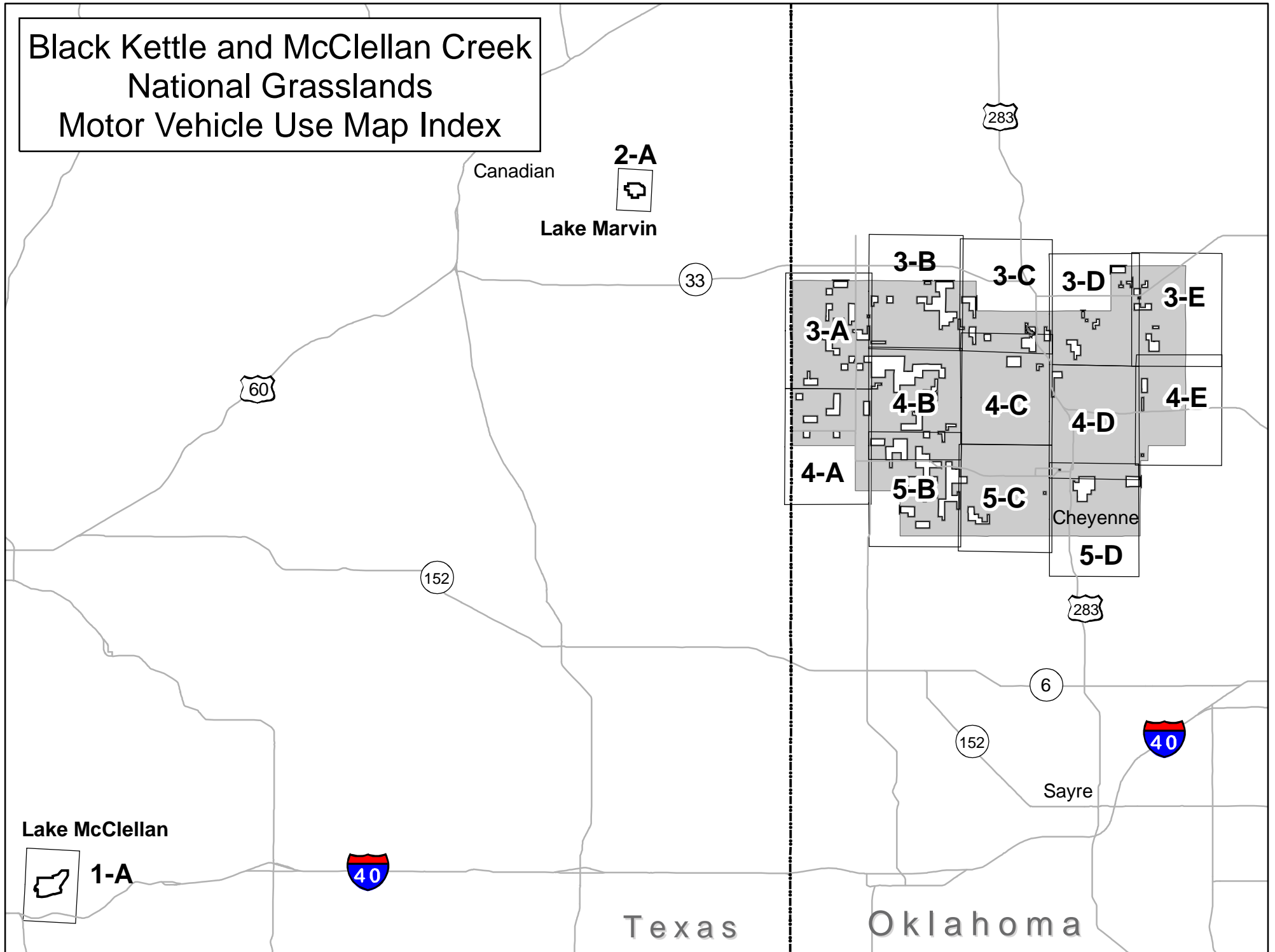

Motor Vehicle Use Map 2007-2008 Black Kettle and McClellan Creek National Grasslands



Map: 1-A

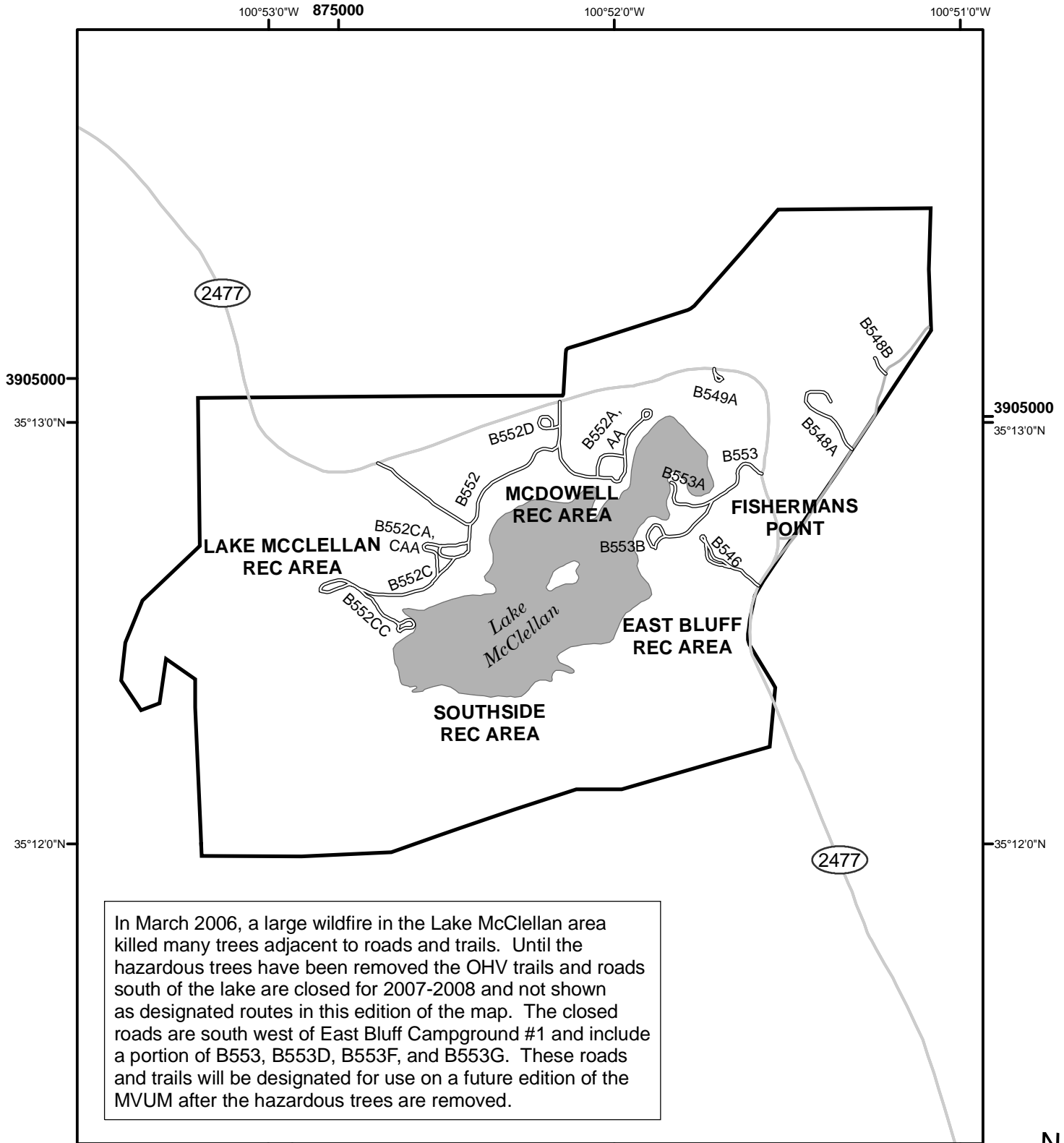

In March 2006, a large wildfire in the Lake McClellan area killed many trees adjacent to roads and trails. Until the hazardous trees have been removed the OHV trails and roads south of the lake are closed for 2007-2008 and not shown as designated routes in this edition of the map. The closed roads are south west of East Bluff Campground #1 and include a portion of B553, B553D, B553F, and B553G. These roads and trails will be designated for use on a future edition of the MVUM after the hazardous trees are removed.

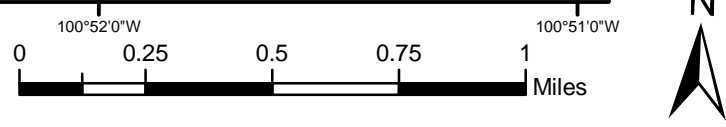
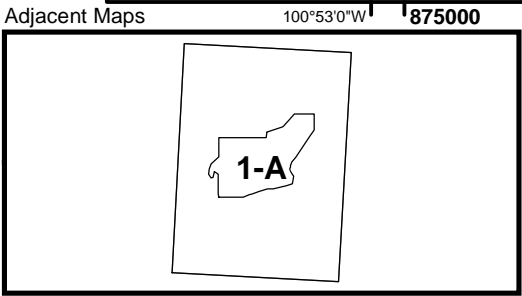

Roads Open to Highway Legal Vehicles Only	Forest or Unit Boundary
Interstate	Non-National Forest System Lands
Other Public Roads	Lakes
Seasonal Designation (See Table) {Used along with road or trail listed above}	

**Motor Vehicle Use Map 2007-2008
Black Kettle and McClellan Creek
National Grasslands**



Map: 2-A

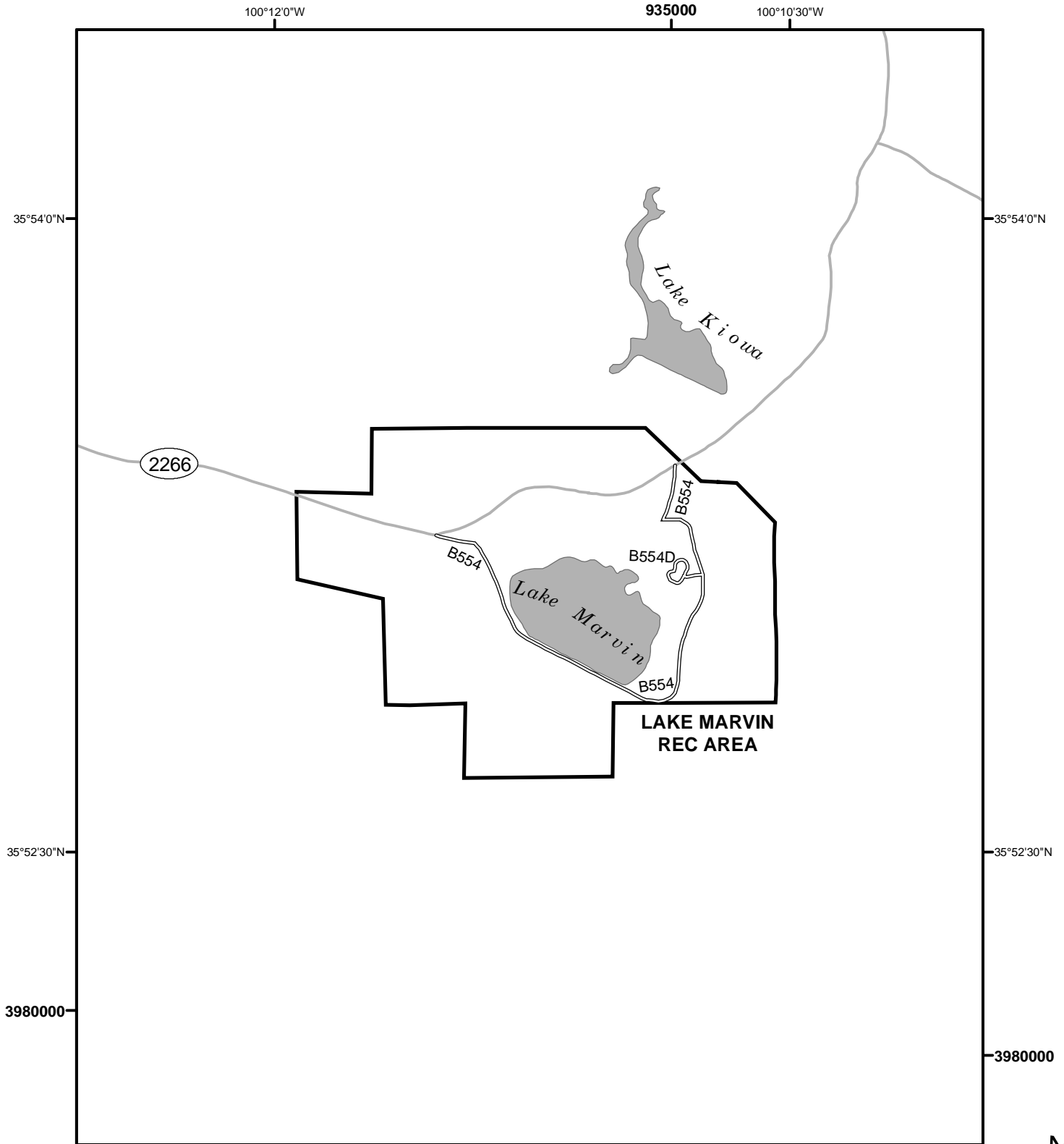

Adjacent Maps 100°12'0"W

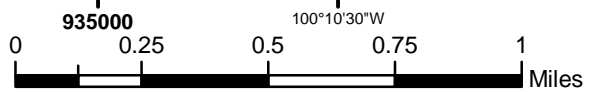
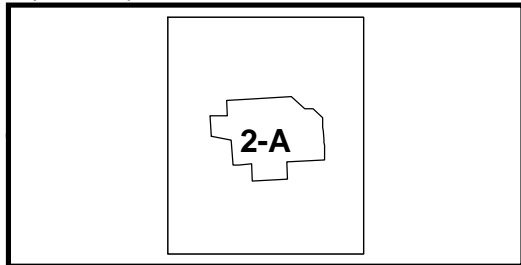

Roads Open to Highway Legal Vehicles Only	Forest or Unit Boundary
Interstate	Non-National Forest System Lands
Other Public Roads	Lakes
Seasonal Designation (See Table) {Used along with road or trail listed above}	

**Motor Vehicle Use Map 2007-2008
Black Kettle and McClellan Creek
National Grasslands**



Map: 3-A

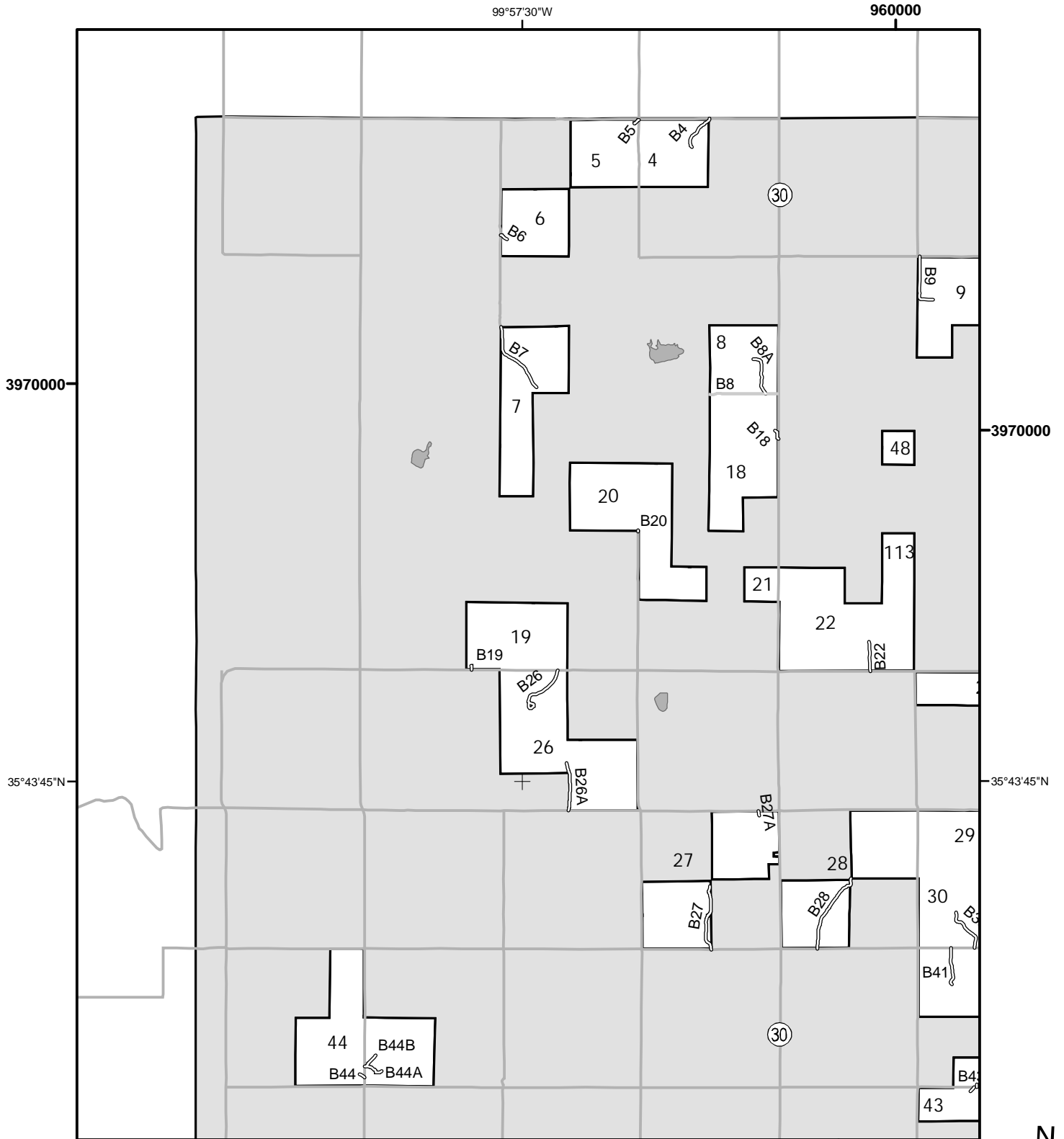

Adjacent Maps

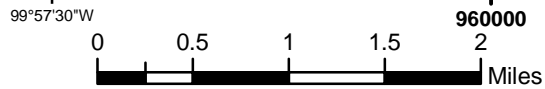
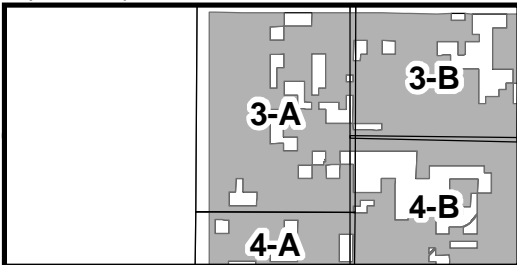

Roads Open to Highway Legal Vehicles Only	Forest or Unit Boundary
Interstate	Non-National Forest System Lands
Other Public Roads	Lakes
Seasonal Designation (See Table) {Used along with road or trail listed above}	

**Motor Vehicle Use Map 2007-2008
Black Kettle and McClellan Creek
National Grasslands**



Map: 3-B

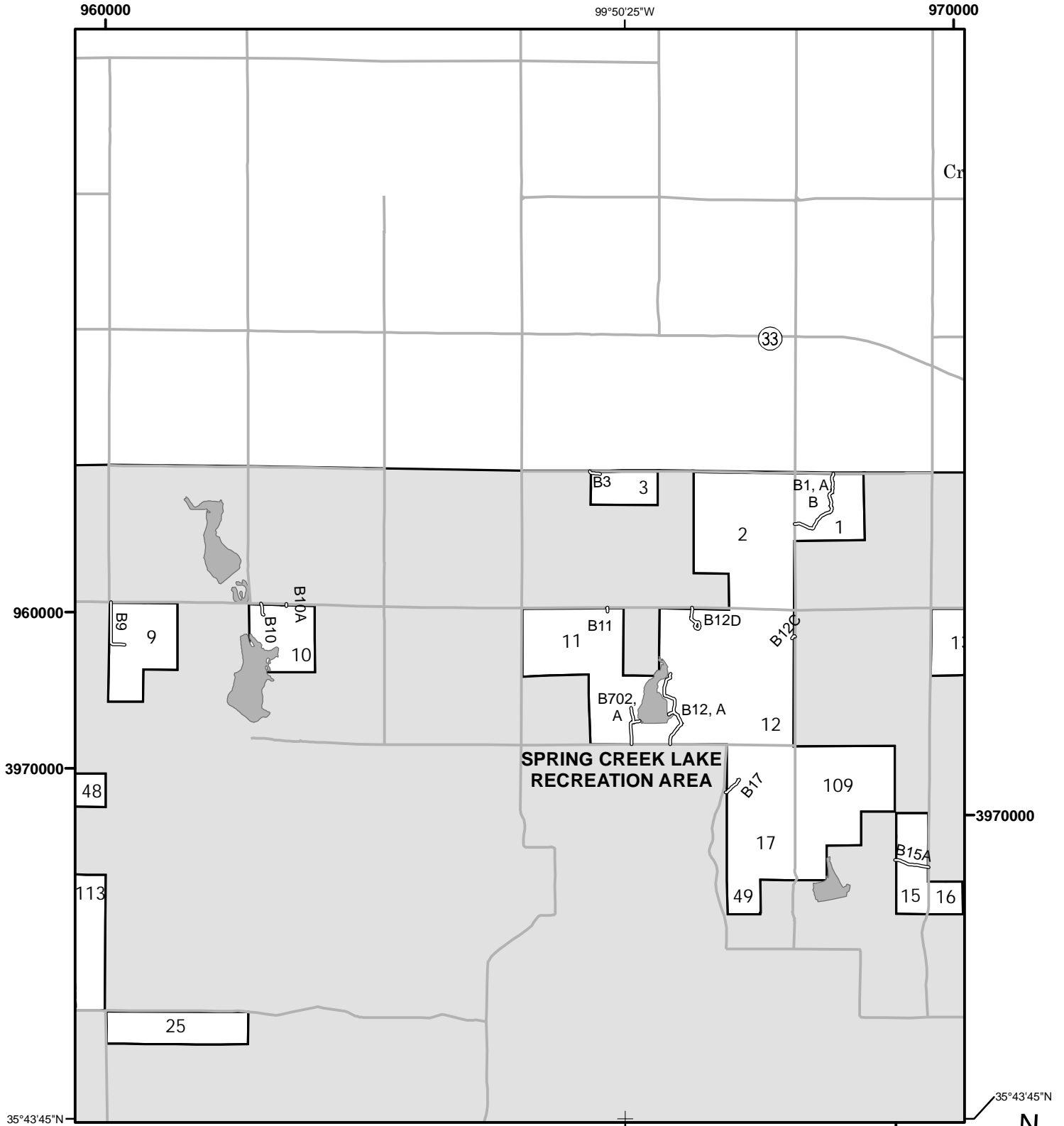

35°43'45"N
Adjacent Maps

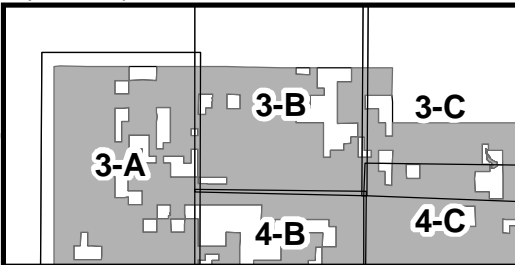

Roads Open to Highway Legal Vehicles Only	Forest or Unit Boundary
Interstate	Non-National Forest System Lands
Other Public Roads	Lakes
Seasonal Designation (See Table) (Used along with road or trail listed above)	

**Motor Vehicle Use Map 2007-2008
Black Kettle and McClellan Creek
National Grasslands**



Map: 3-C

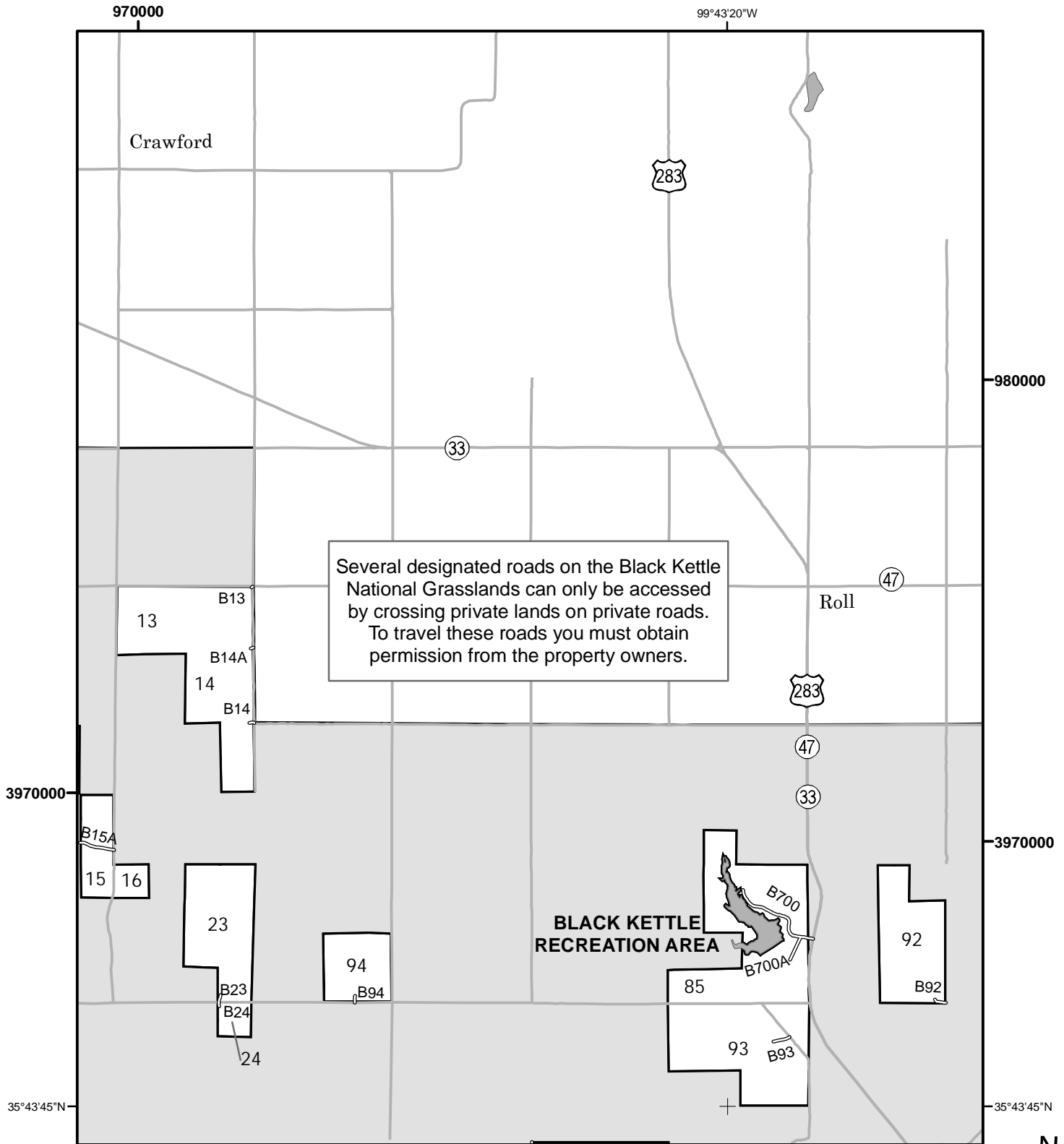

Adjacent Maps

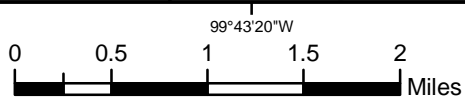
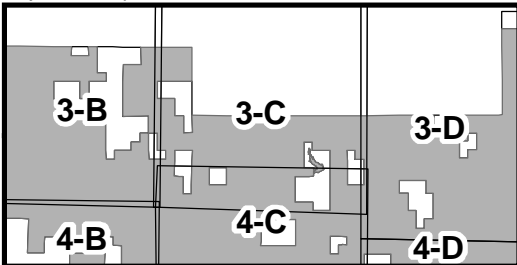

- | | |
|--|----------------------------------|
| Roads Open to Highway Legal Vehicles Only | Forest or Unit Boundary |
| Interstate | Non-National Forest System Lands |
| Other Public Roads | Lakes |
| Seasonal Designation (See Table)
(Used along with road or trail listed above) | |

**Motor Vehicle Use Map 2007-2008
Black Kettle and McClellan Creek
National Grasslands**



Map: 3-D

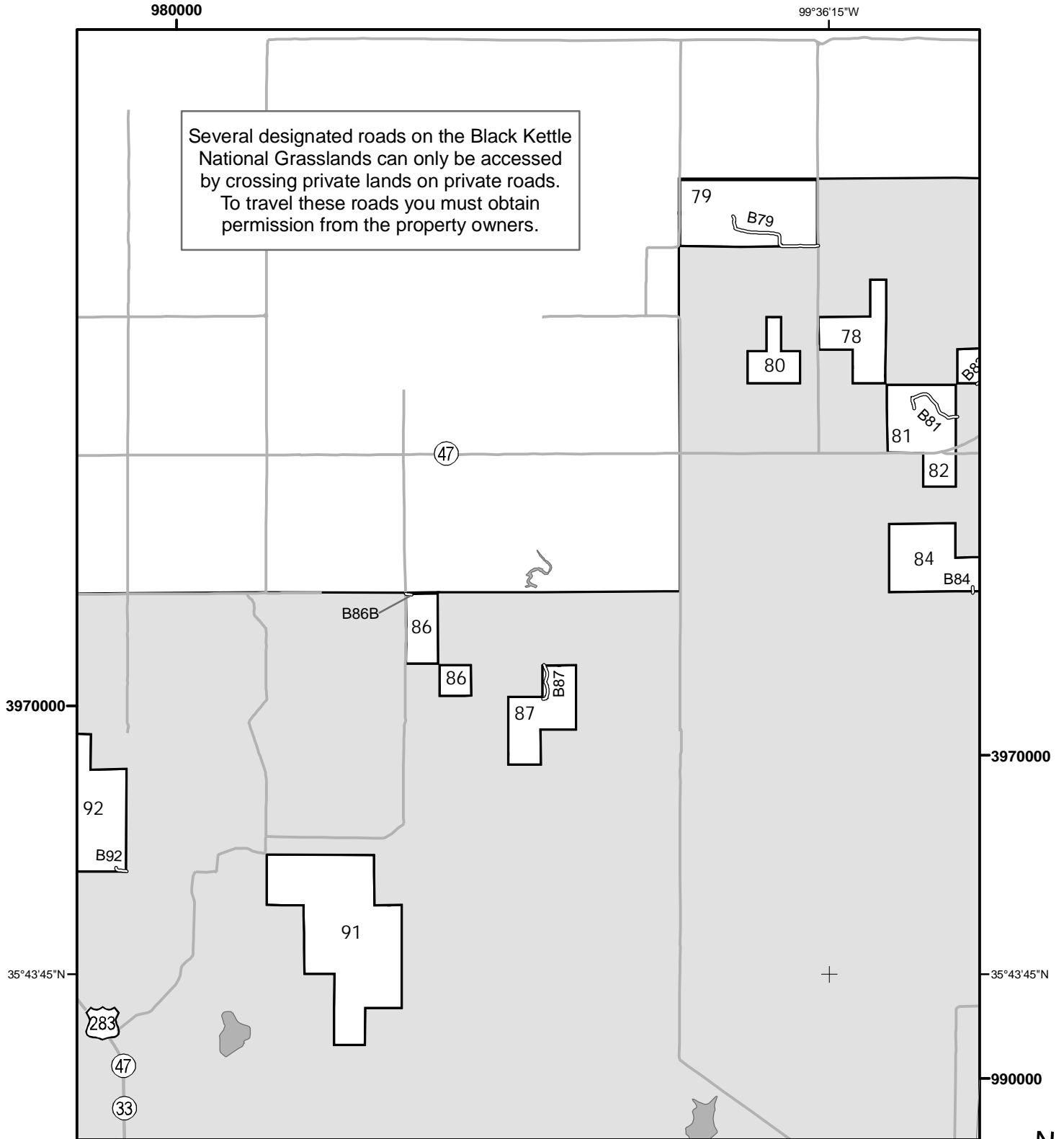

Several designated roads on the Black Kettle National Grasslands can only be accessed by crossing private lands on private roads. To travel these roads you must obtain permission from the property owners.

Adjacent Maps | 980000

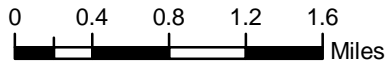
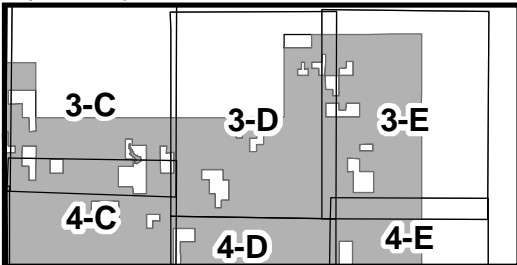

Roads Open to Highway Legal Vehicles Only	Forest or Unit Boundary
Interstate	Non-National Forest System Lands
Other Public Roads	Lakes
Seasonal Designation (See Table) {Used along with road or trail listed above}	

**Motor Vehicle Use Map 2007-2008
Black Kettle and McClellan Creek
National Grasslands**



Map: 3-E

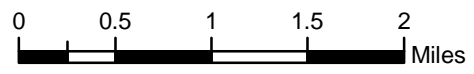
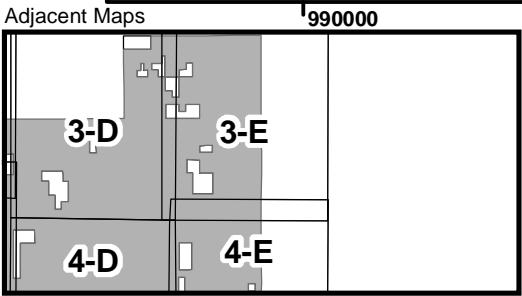
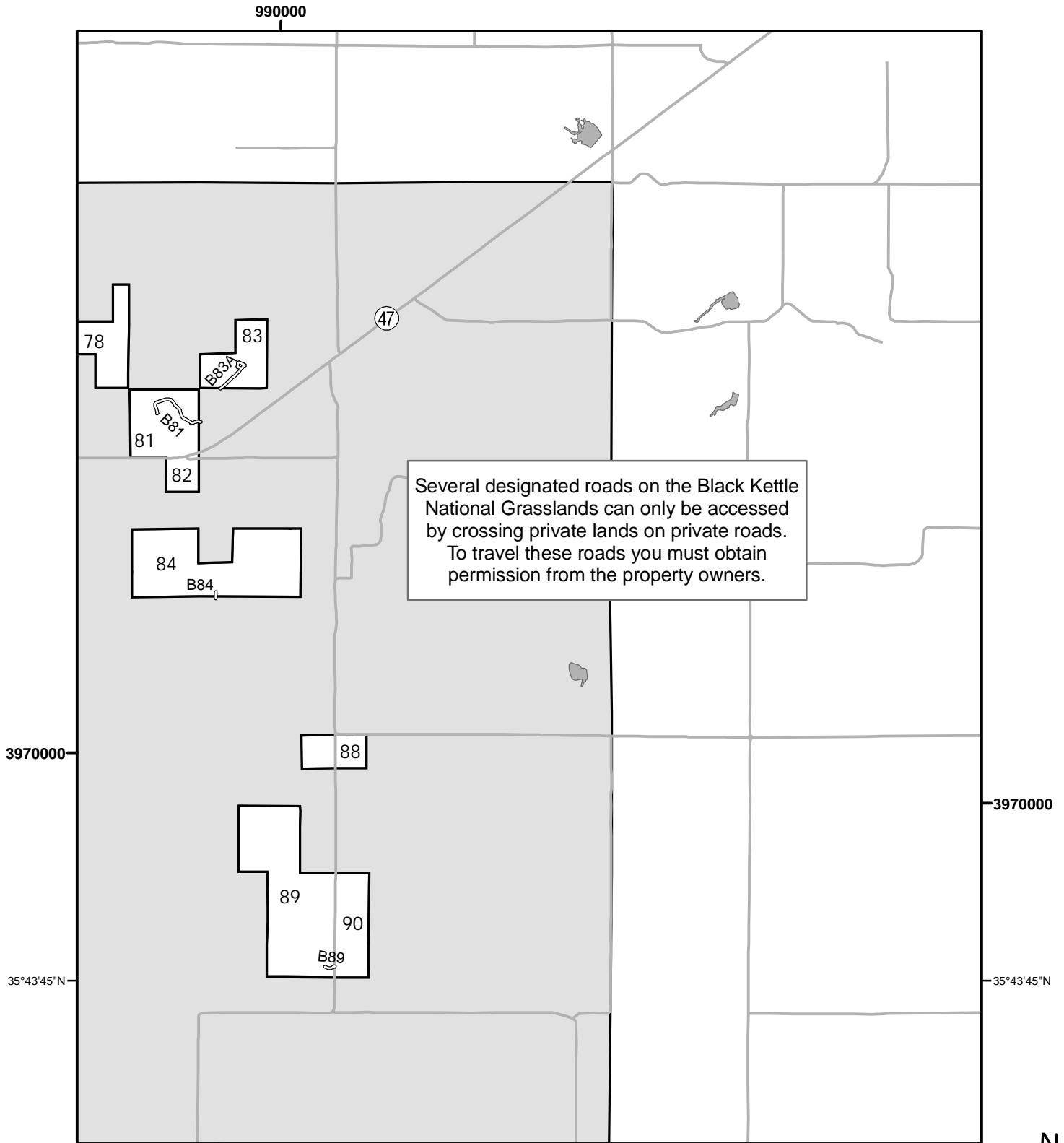

Roads Open to Highway Legal Vehicles Only	Forest or Unit Boundary
Interstate	Non-National Forest System Lands
Other Public Roads	Lakes
Seasonal Designation (See Table) {Used along with road or trail listed above}	

Motor Vehicle Use Map 2007-2008
Black Kettle and McClellan Creek
National Grasslands



Map: 4-A

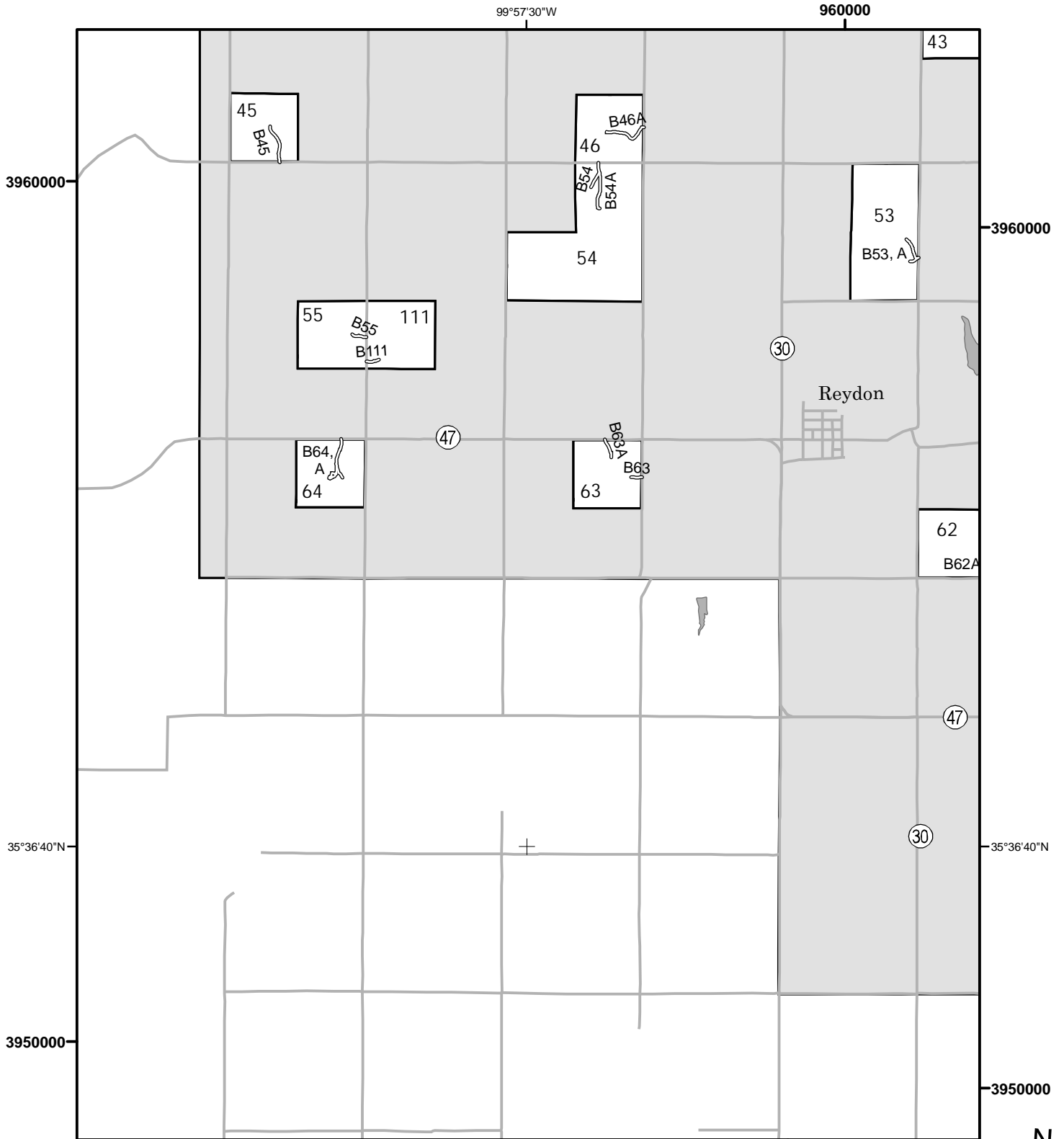

Adjacent Maps

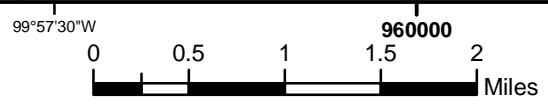
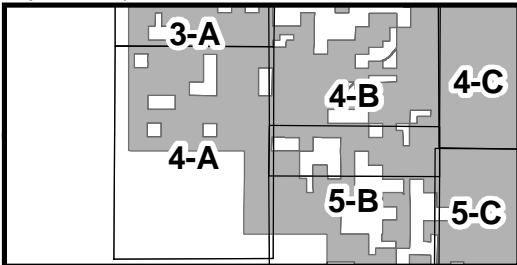

Roads Open to Highway Legal Vehicles Only	Forest or Unit Boundary
Interstate	Non-National Forest System Lands
Other Public Roads	Lakes
Seasonal Designation (See Table) {Used along with road or trail listed above}	

**Motor Vehicle Use Map 2007-2008
Black Kettle and McClellan Creek
National Grasslands**



Map: 4-B

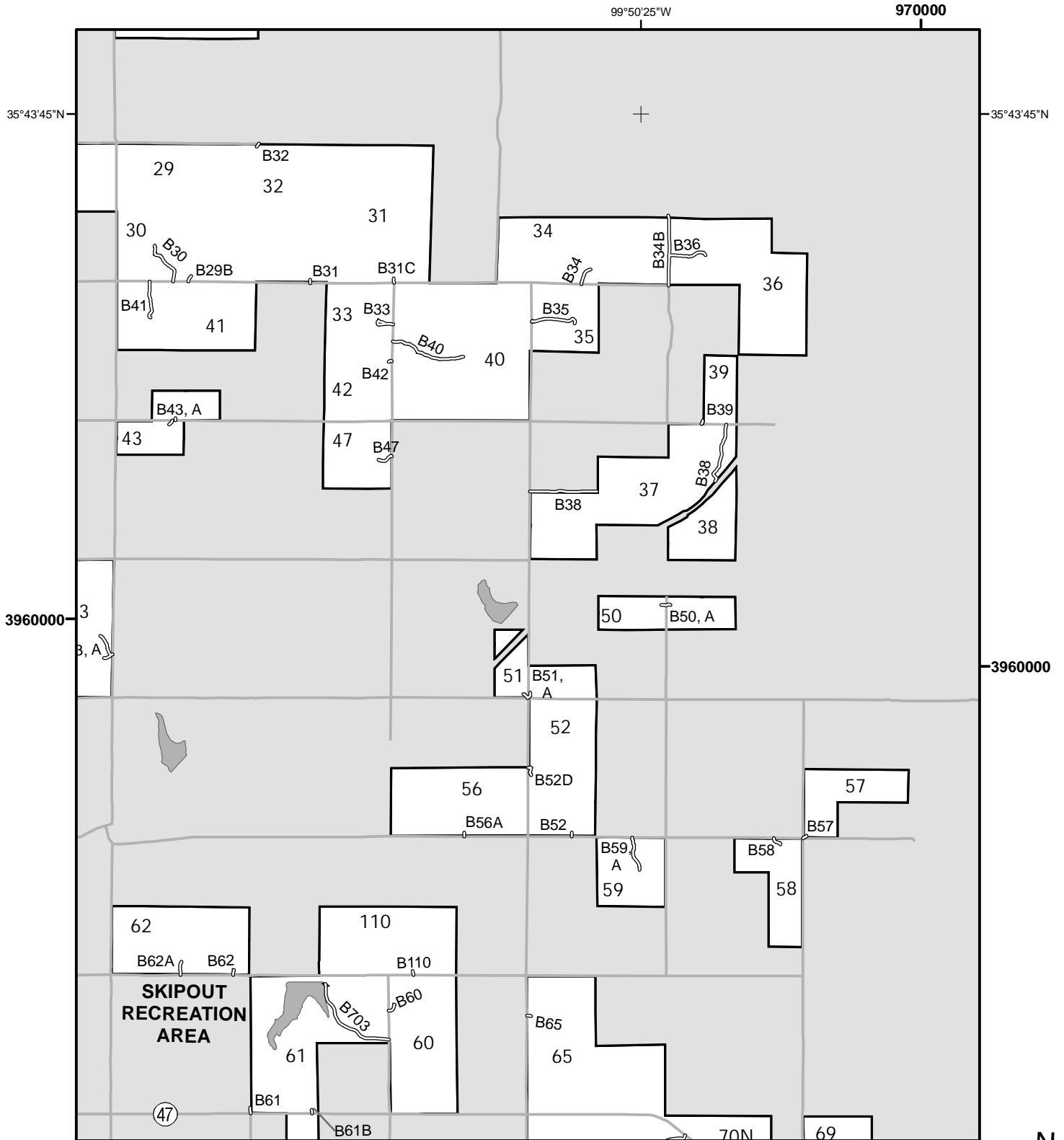

Adjacent Maps

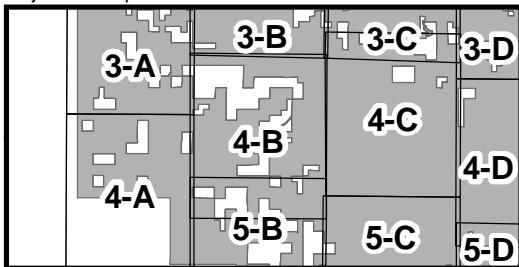

Roads Open to Highway Legal Vehicles Only	Forest or Unit Boundary
Interstate	Non-National Forest System Lands
Other Public Roads	Lakes
Seasonal Designation (See Table) (Used along with road or trail listed above)	

**Motor Vehicle Use Map 2007-2008
Black Kettle and McClellan Creek
National Grasslands**



Map: 4-C

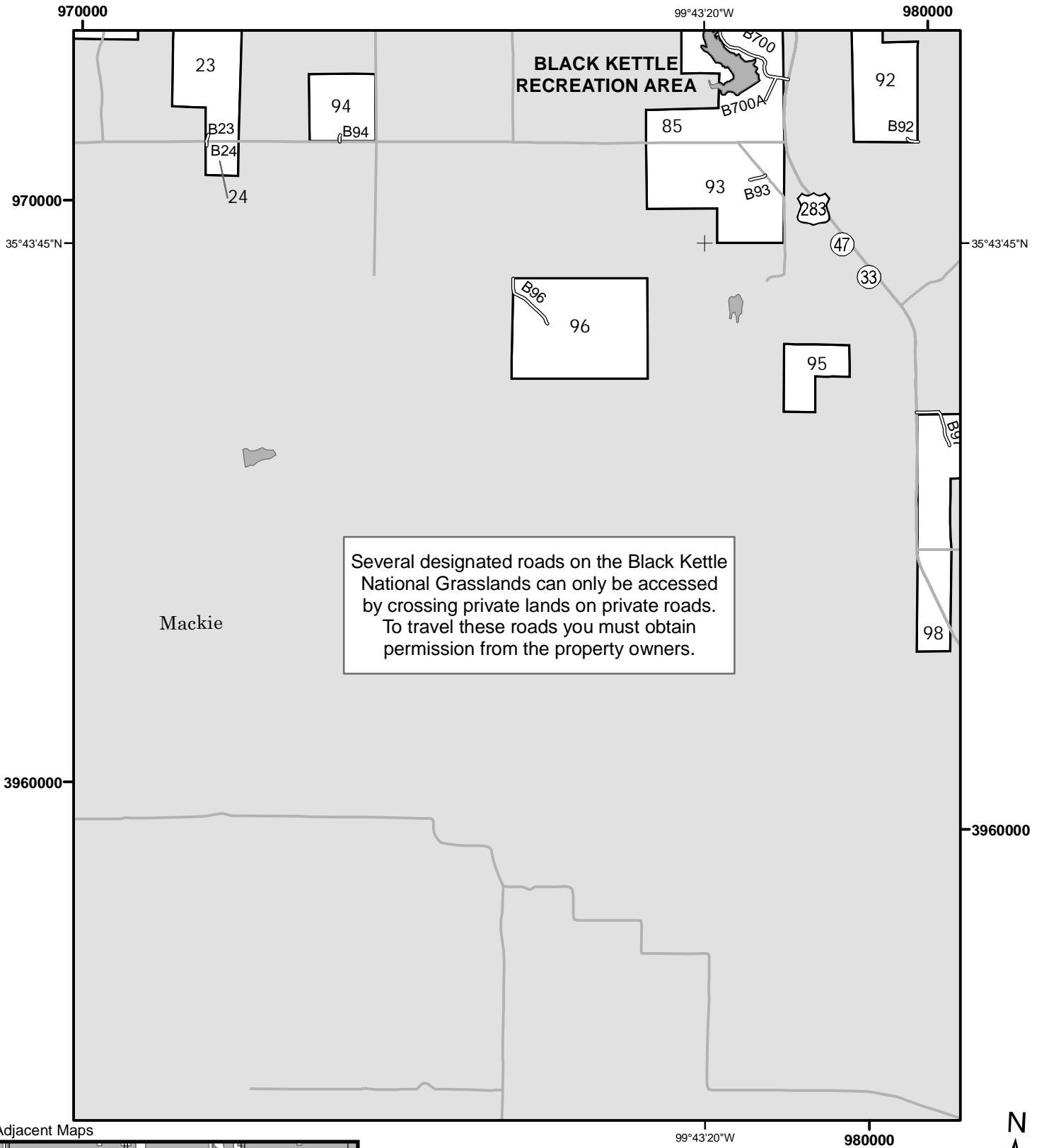

Adjacent Maps

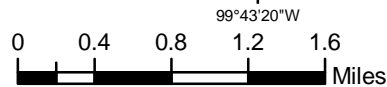
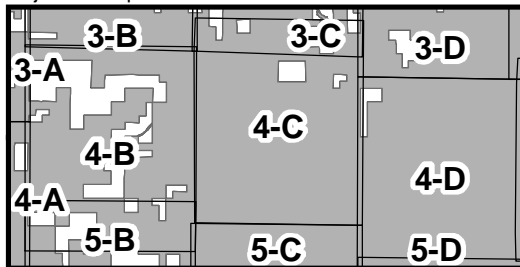

Roads Open to Highway Legal Vehicles Only	Forest or Unit Boundary
Interstate	Non-National Forest System Lands
Other Public Roads	Lakes
Seasonal Designation (See Table) {Used along with road or trail listed above}	

**Motor Vehicle Use Map 2007-2008
Black Kettle and McClellan Creek
National Grasslands**



Map: 4-D

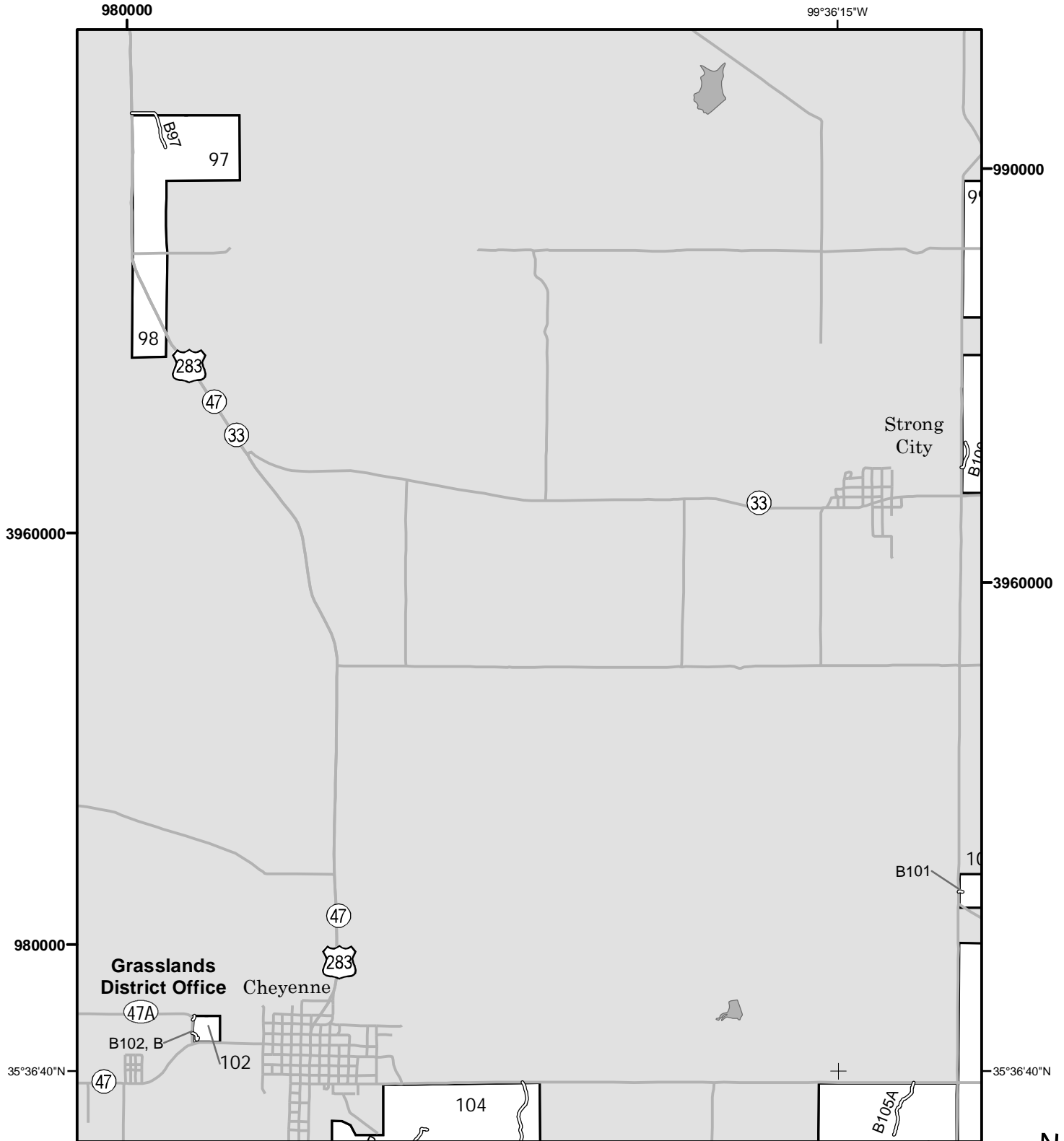

Adjacent Maps

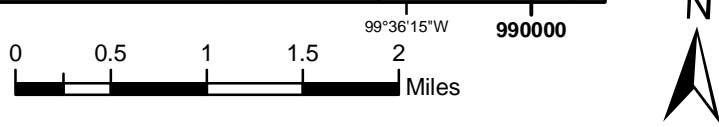
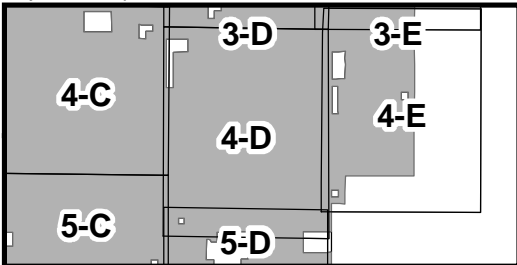

Roads Open to Highway Legal Vehicles Only	Forest or Unit Boundary
Interstate	Non-National Forest System Lands
Other Public Roads	Lakes
Seasonal Designation (See Table) (Used along with road or trail listed above)	

Motor Vehicle Use Map 2007-2008 Black Kettle and McClellan Creek National Grasslands



Map: 4-E

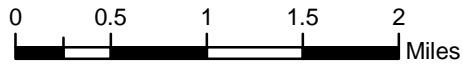
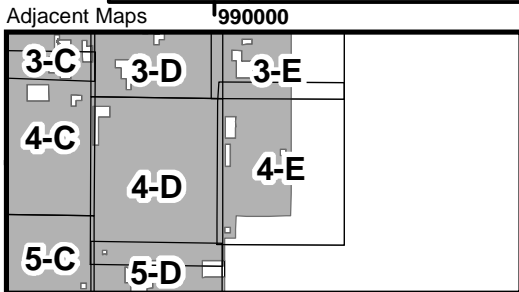
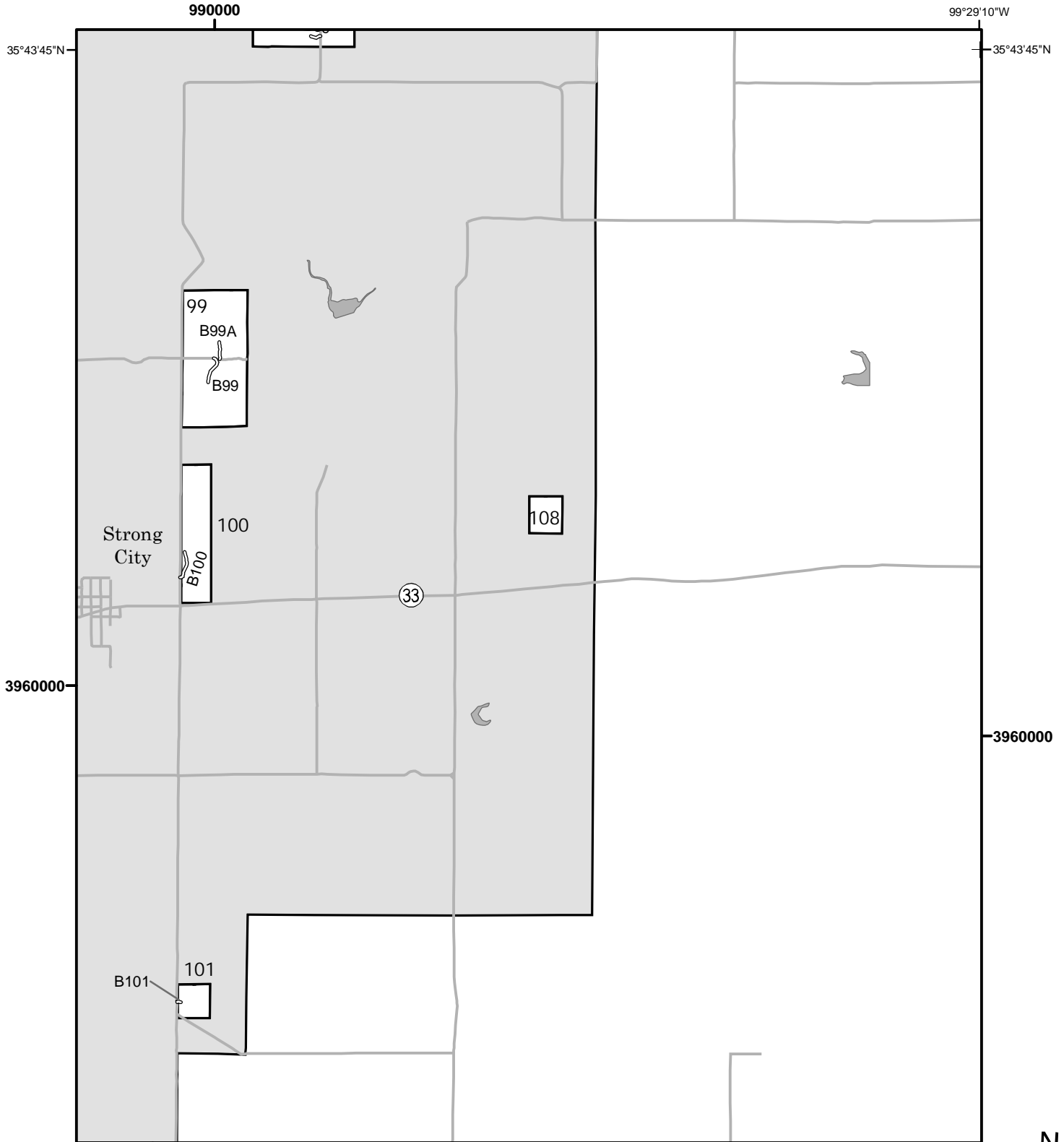

Roads Open to Highway Legal Vehicles Only	Forest or Unit Boundary
Interstate	Non-National Forest System Lands
Other Public Roads	Lakes
Seasonal Designation (See Table) {Used along with road or trail listed above}	

**Motor Vehicle Use Map 2007-2008
Black Kettle and McClellan Creek
National Grasslands**



Map: 5-B

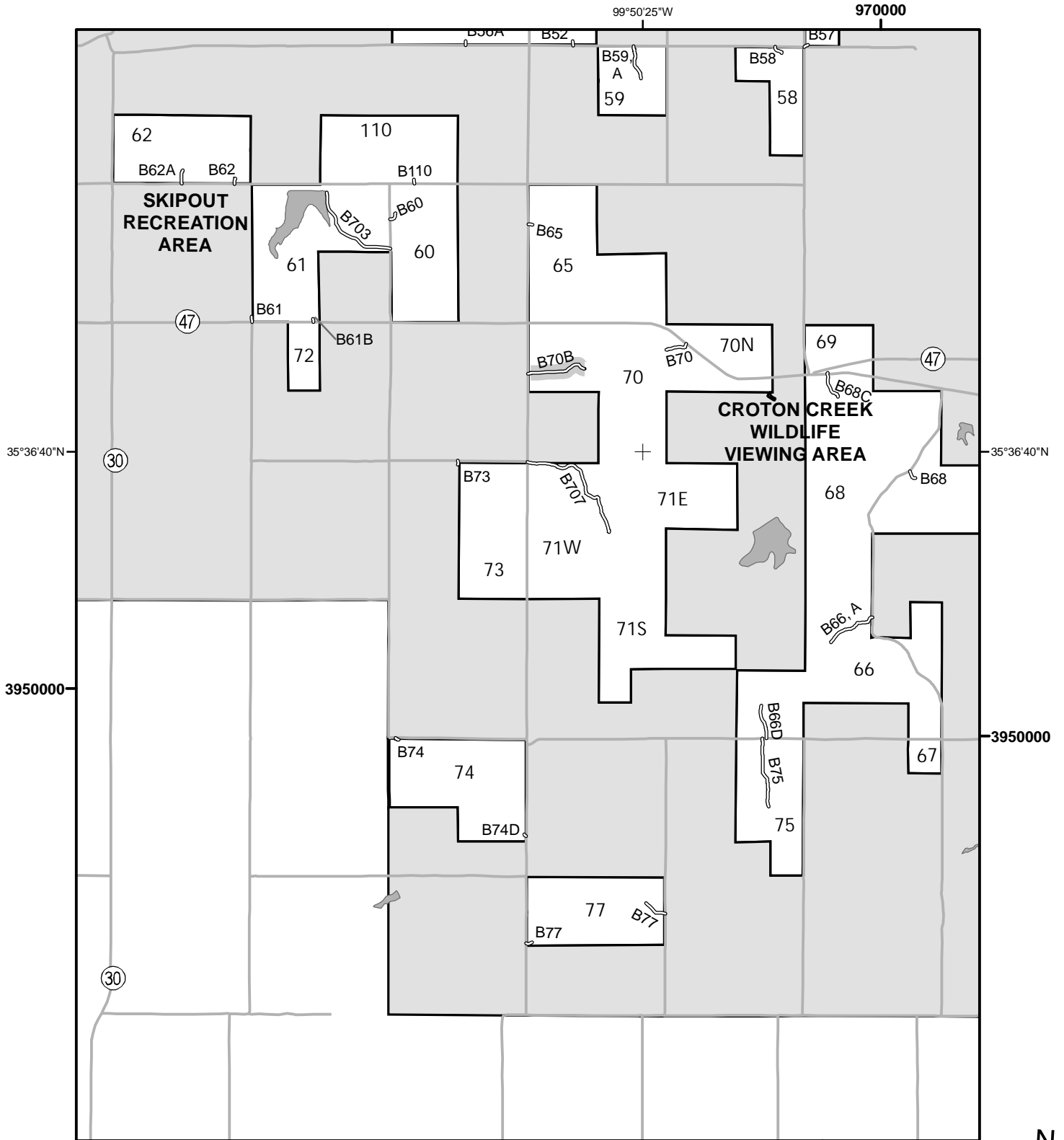

Adjacent Maps

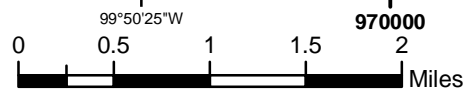
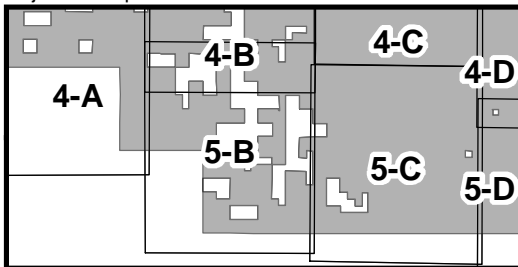

Roads Open to Highway Legal Vehicles Only	Forest or Unit Boundary
Interstate	Non-National Forest System Lands
Other Public Roads	Lakes
Seasonal Designation (See Table) (Used along with road or trail listed above)	

**Motor Vehicle Use Map 2007-2008
Black Kettle and McClellan Creek
National Grasslands**



Map: 5-C

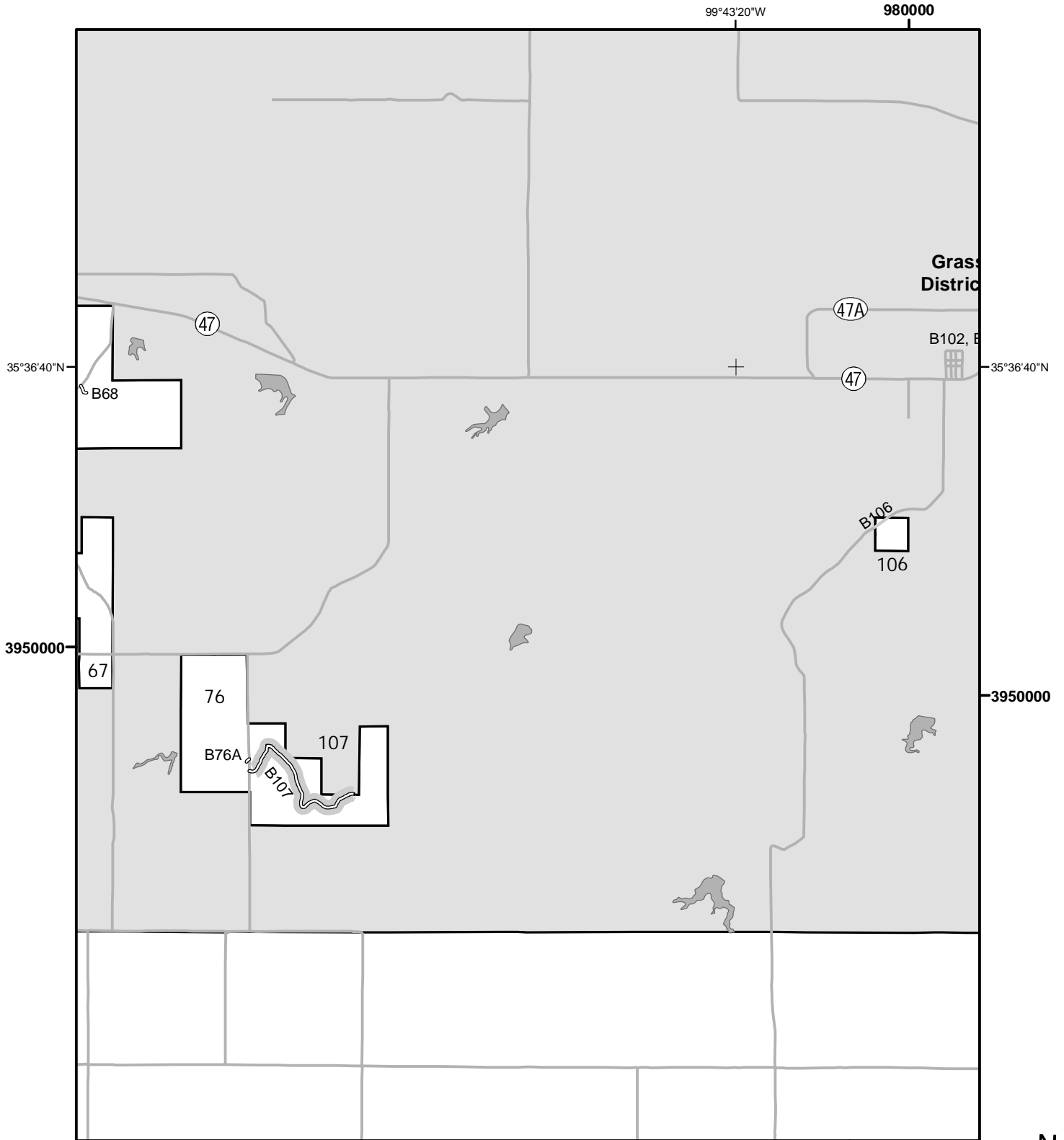

Adjacent Maps

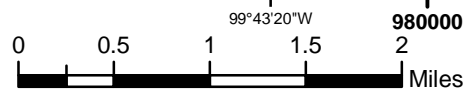
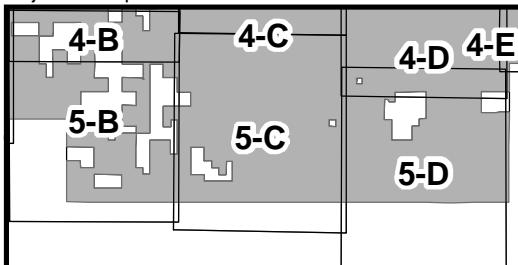

Roads Open to Highway Legal Vehicles Only	Forest or Unit Boundary
Interstate	Non-National Forest System Lands
Other Public Roads	Lakes
Seasonal Designation (See Table) (Used along with road or trail listed above)	

**Motor Vehicle Use Map 2007-2008
Black Kettle and McClellan Creek
National Grasslands**



Map: 5-D

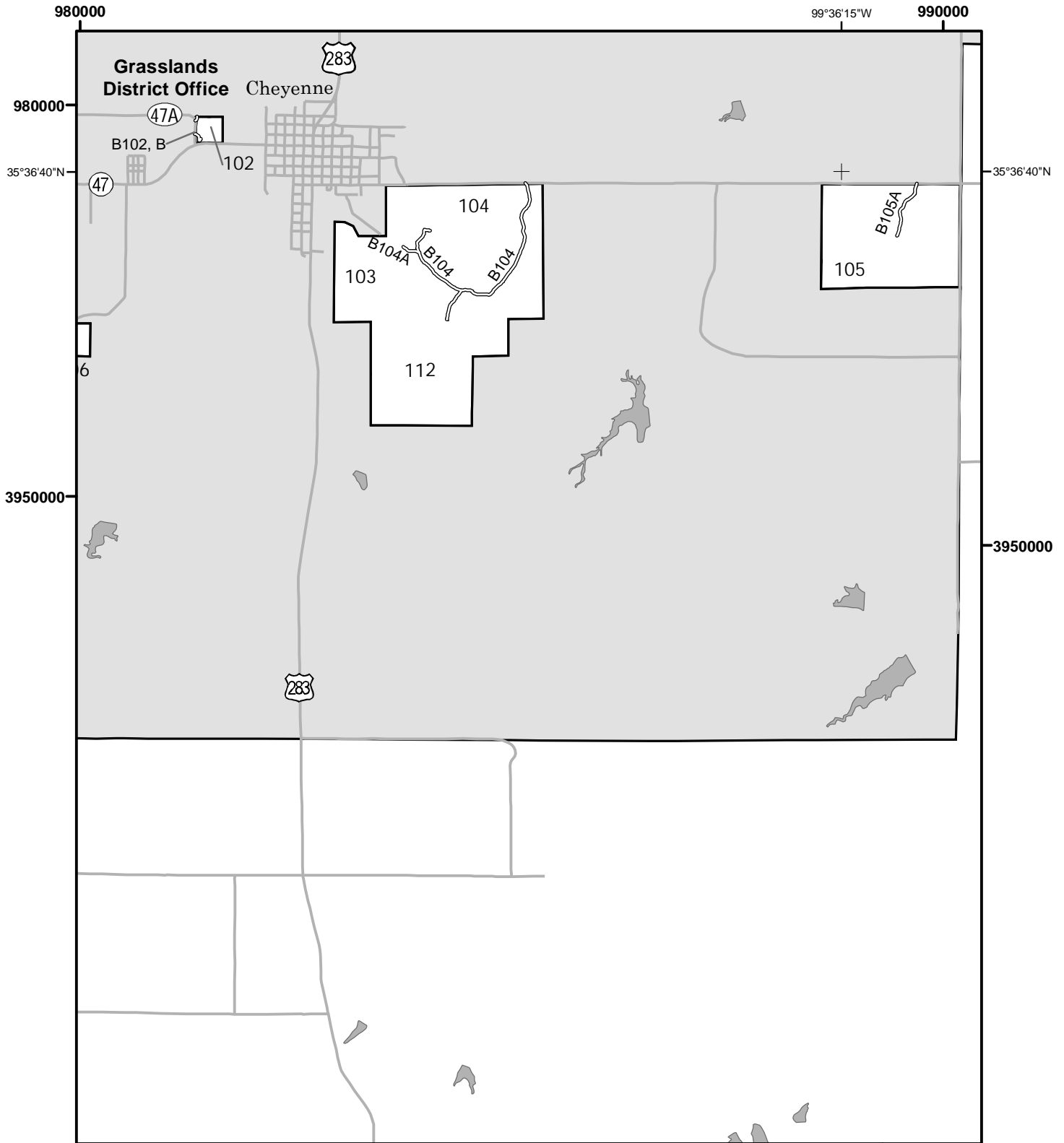

Adjacent Maps

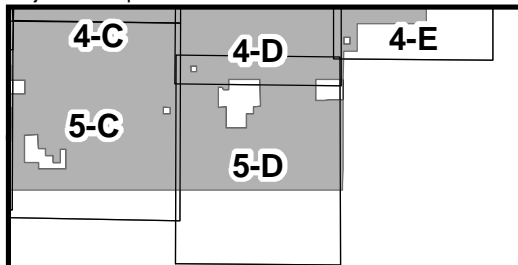

Roads Open to Highway Legal Vehicles Only	Forest or Unit Boundary
Interstate	Non-National Forest System Lands
Other Public Roads	Lakes
Seasonal Designation (See Table) {Used along with road or trail listed above}	