



FINAL REPORT
Prepared for



**Oregon Department of
Transportation**

Stanfield Interchange Access Management Plan



November 2005

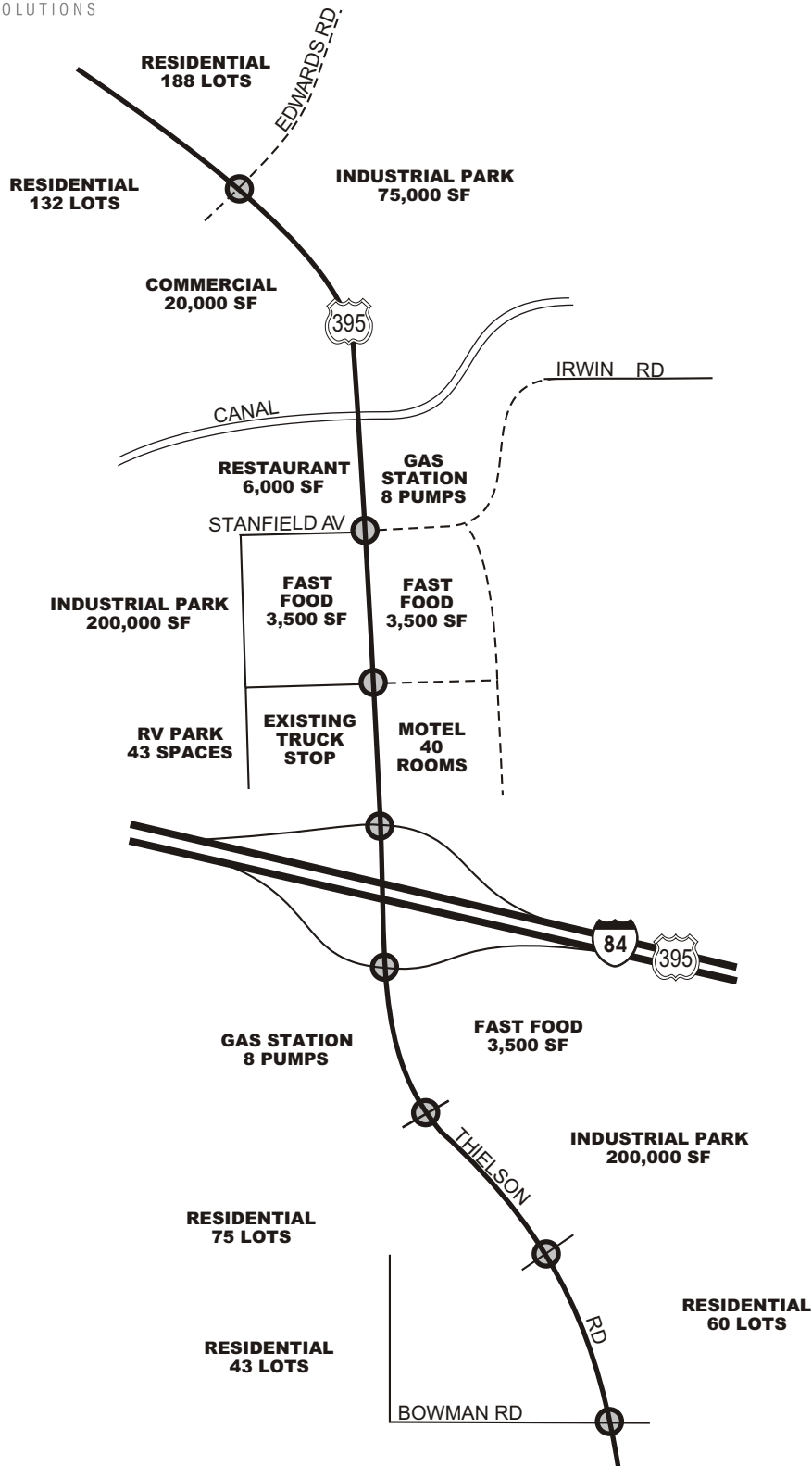

LEGEND

● - Study Intersections

Figure 1
FUTURE FULL BUILD-OUT
LAND USE

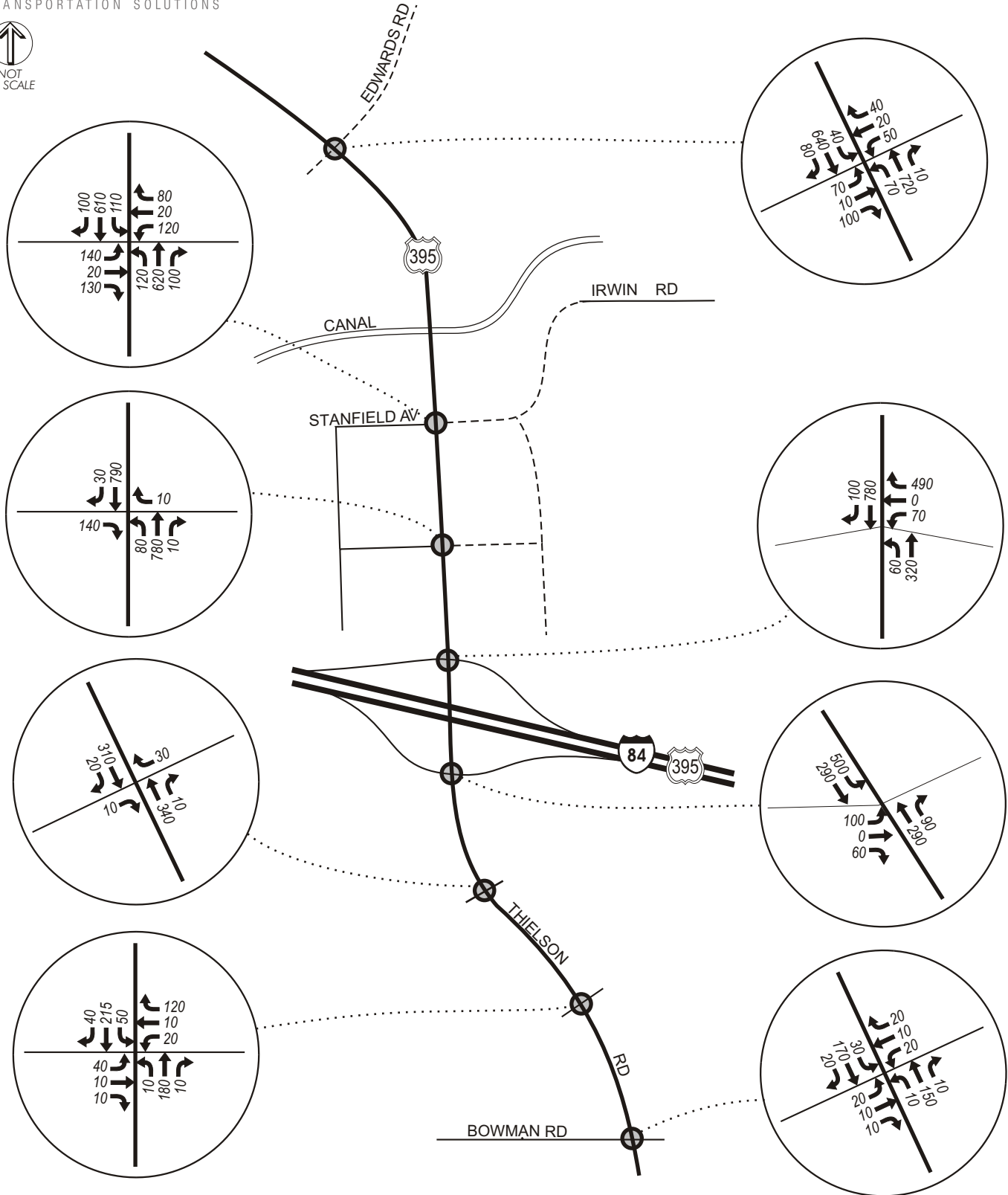

LEGEND

- - Study Intersections
- ← 00 - Peak Hour Traffic Volumes

Figure 2
2024 PM PEAK HOUR
TRAFFIC VOLUMES

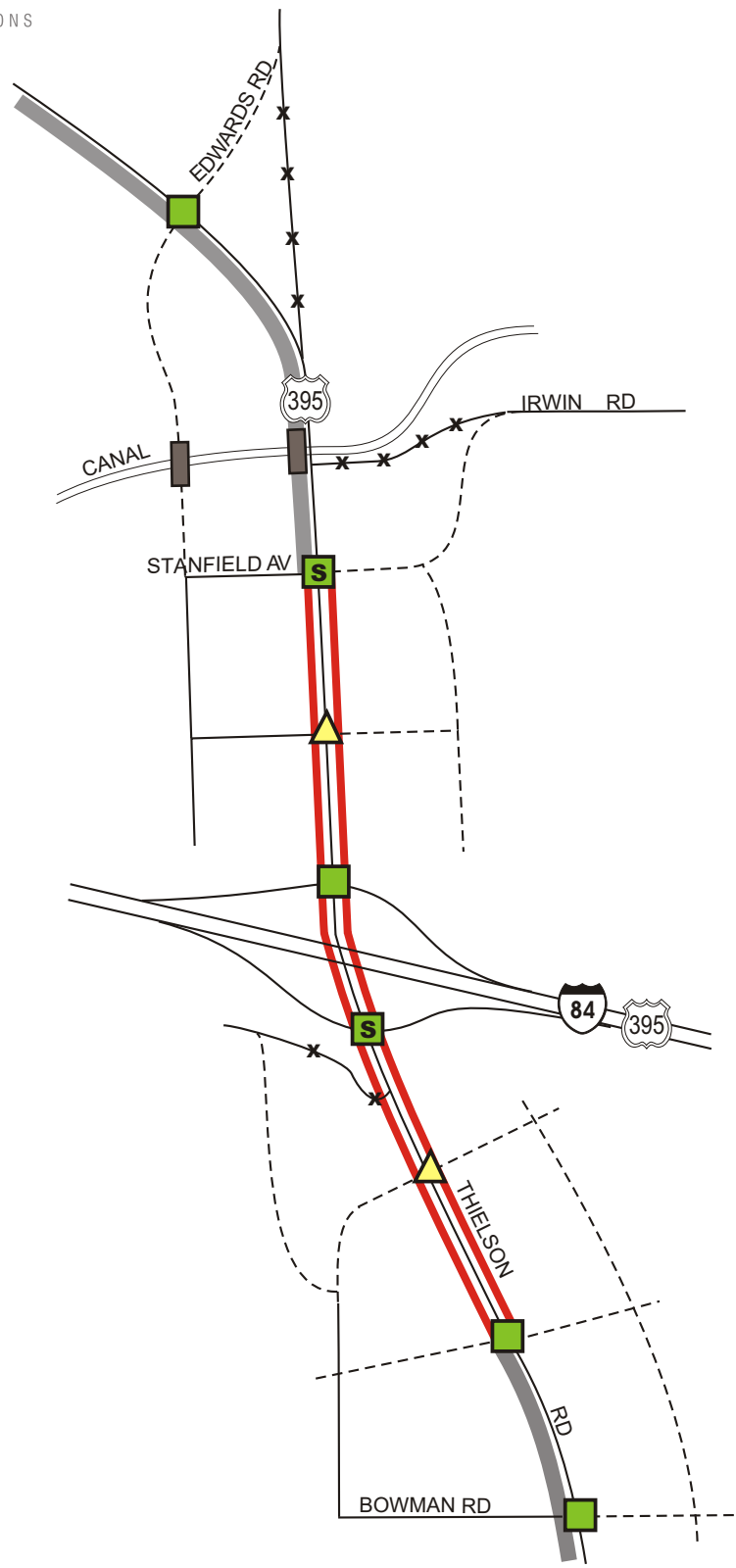

LEGEND

- x-x- - Road Realignment
- - Sidewalk
- Off-Street Trail
- - - - - Proposed Roadway
- S** - Traffic Signal
- Full Access
- Restricted Access
- Bridge

Note: Roadway network does not include the potential future reconstruction of the interchange overpass and Thielson Road.

**Figure 3
INTERCHANGE
STUDY AREA NEEDS**

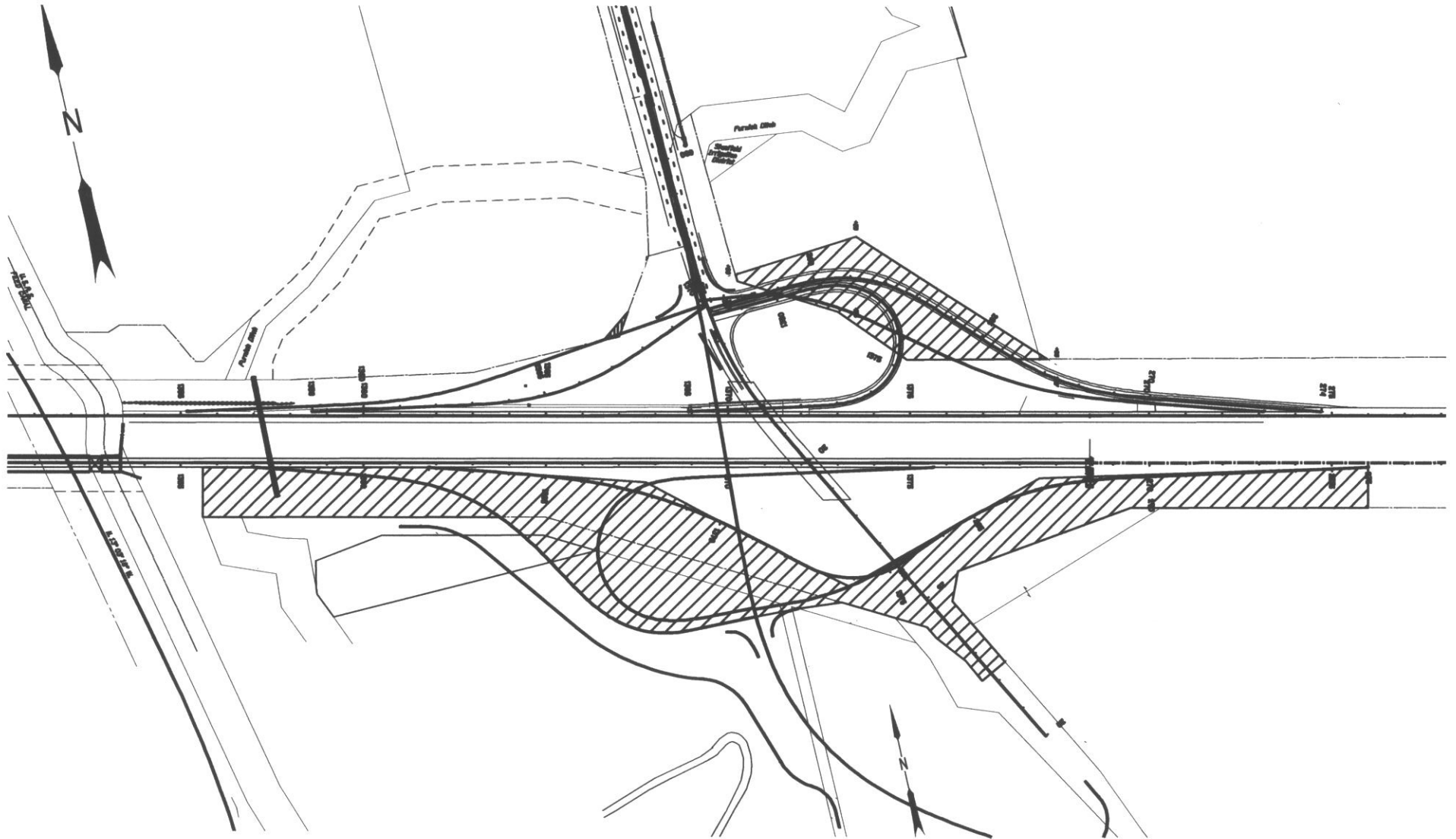
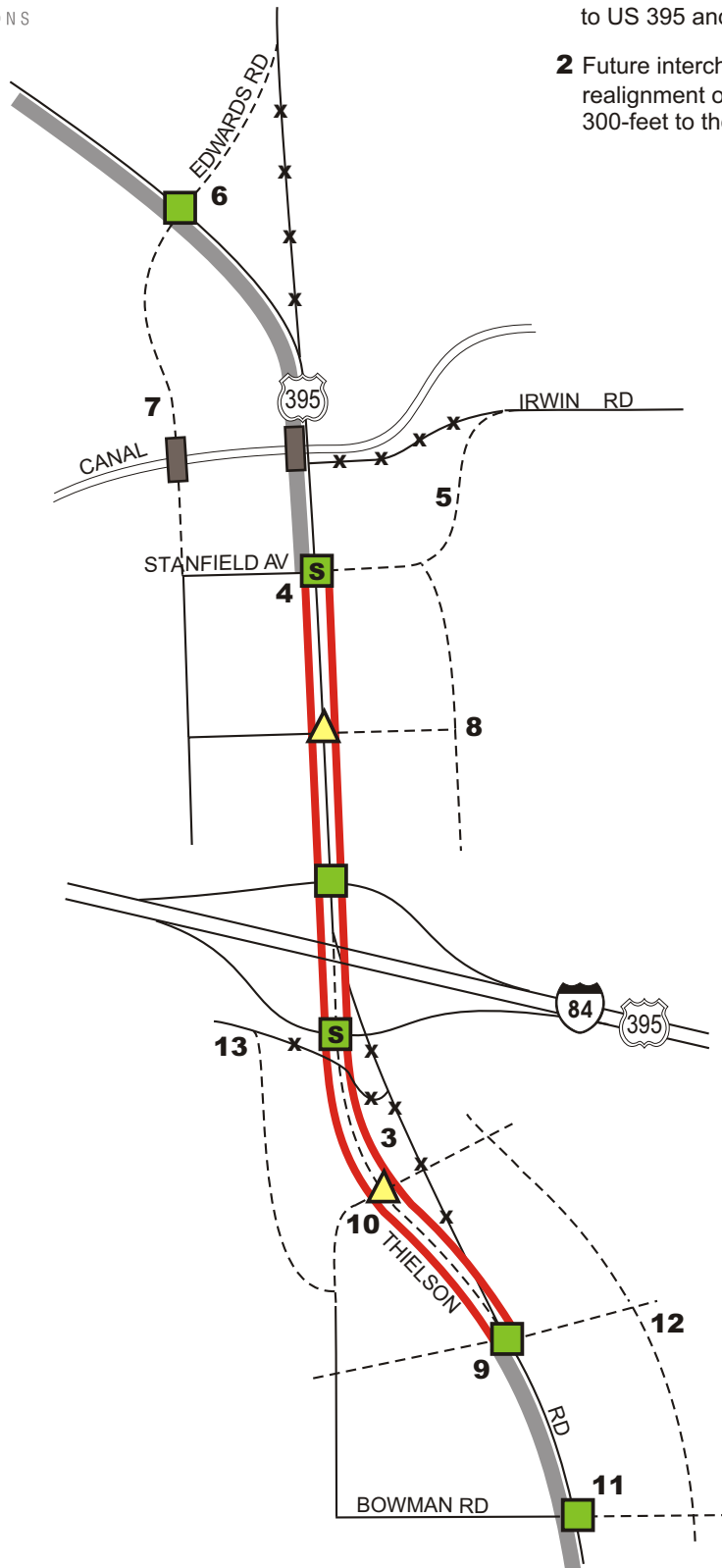

Figure 4
PROPOSED INTERCHANGE
RIGHT OF WAY IMPACTS



- 1** Apply ODOT minimum spacing standards to US 395 and Thielson Road.
- 2** Future interchange reconstruction includes the realignment of Thielson Road approximately 300-feet to the west.



LEGEND



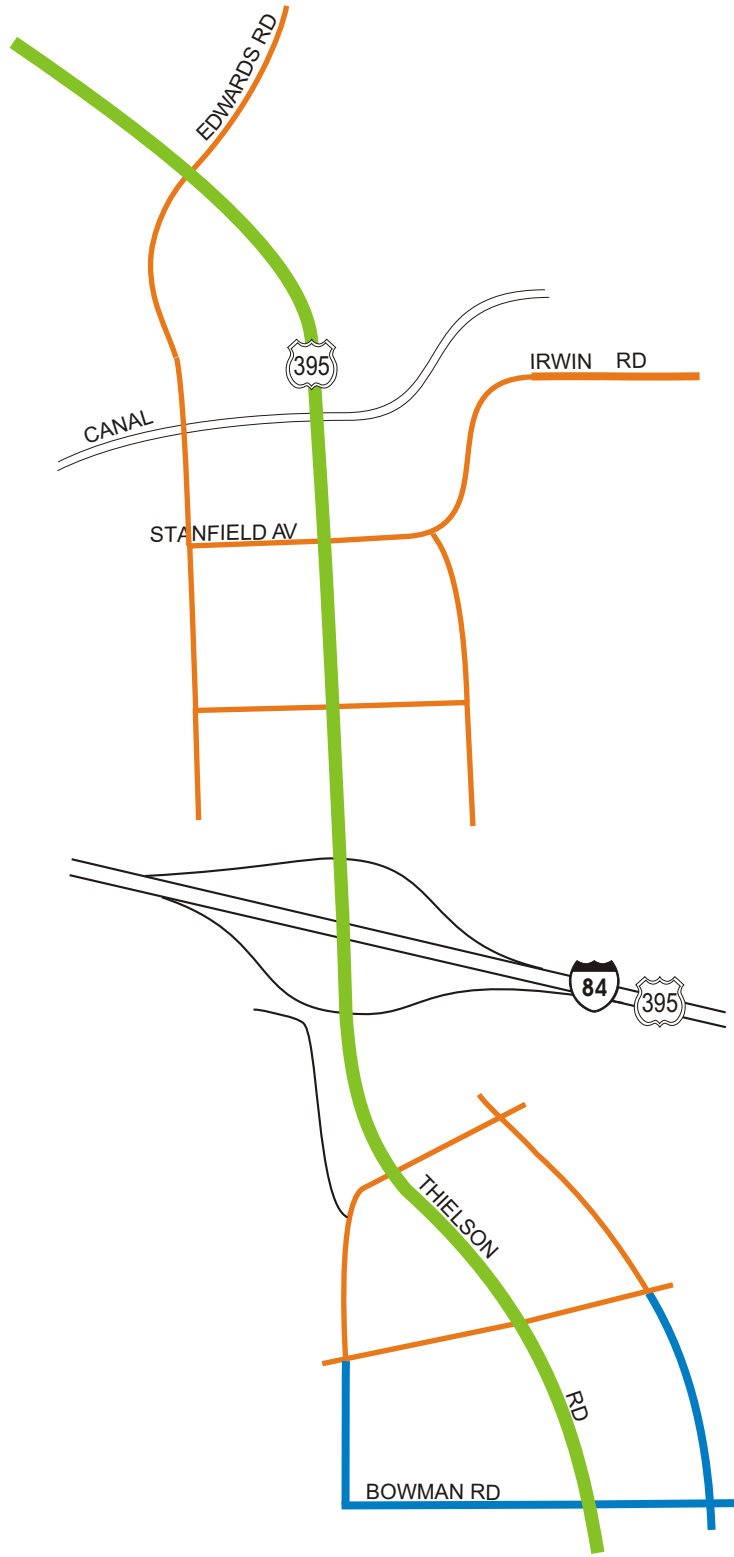

- x-x- Road Realignment
- Sidewalk
- Off-Street Trail
- - - Proposed Roadway
- S** - Traffic Signal
- - Full Access
- ▲ - Restricted Access
- - Bridge

Note: Roadway network includes the potential future reconstruction of the interchange overpass and realignment of Thielson Road.

Figure 5
STANFIELD INTERCHANGE
AREA MANAGEMENT PLAN



LEGEND

-  - Arterial
-  - Residential Collector
-  - Industrial/Commercial Collector
-  - Local Street

Note: Roadway network includes the potential future reconstruction of the interchange overpass and realignment of Thielson Road.

Figure 6
STREET FUNCTIONAL
CLASSIFICATION

Alley

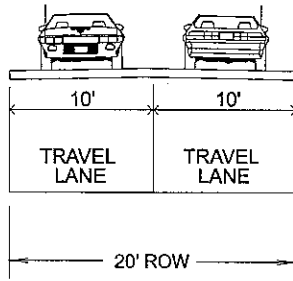

Local Street

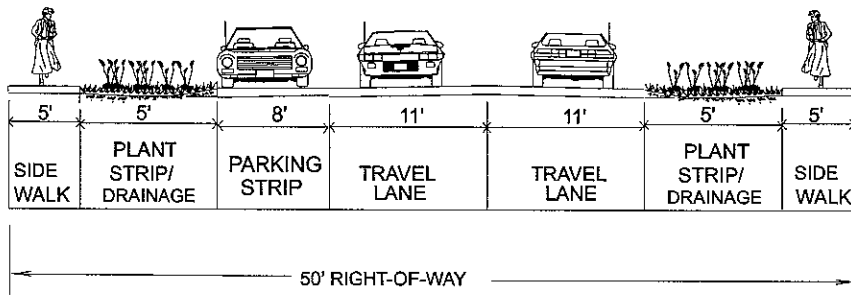

Collector

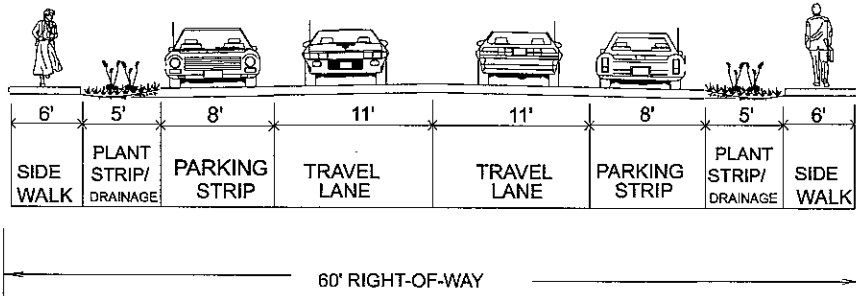

Downtown Arterial

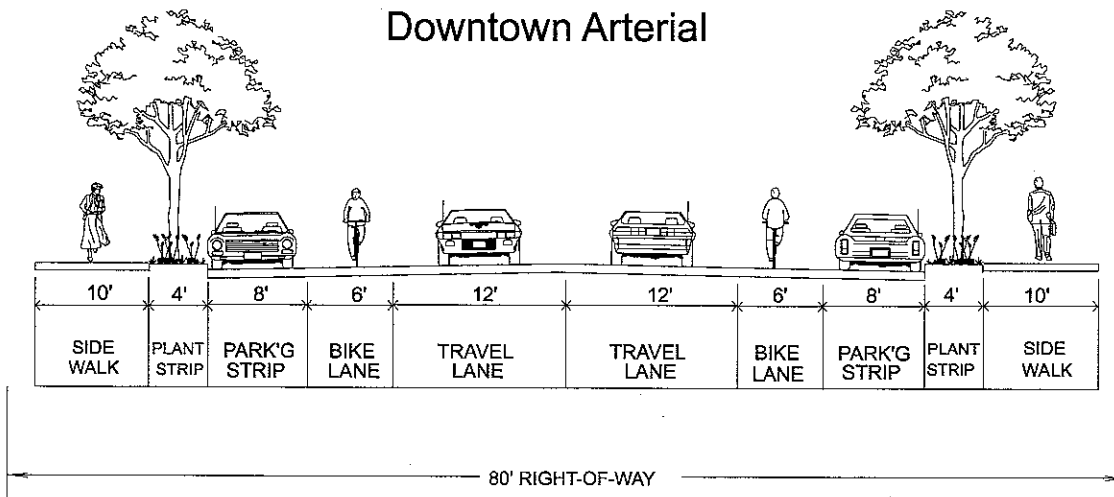
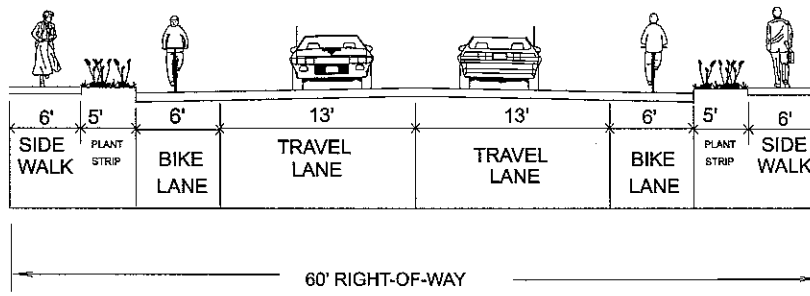

Figure 7
Local/Downtown
Cross-section

Commercial/Industrial Collector



Commercial/Industrial Arterial (Thielsen Road)

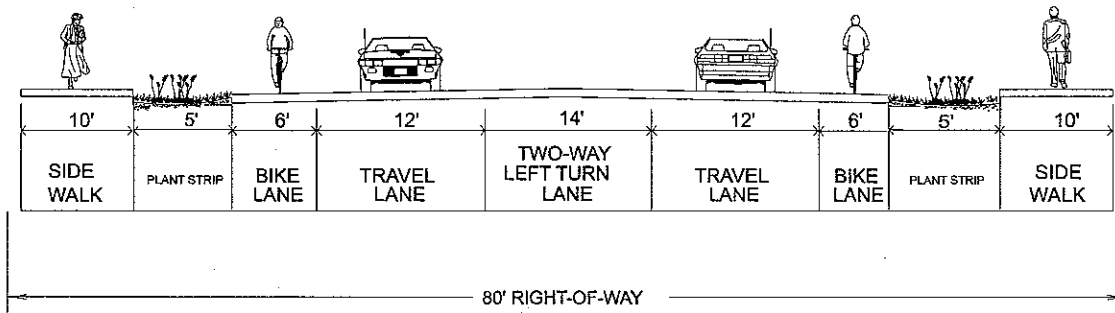
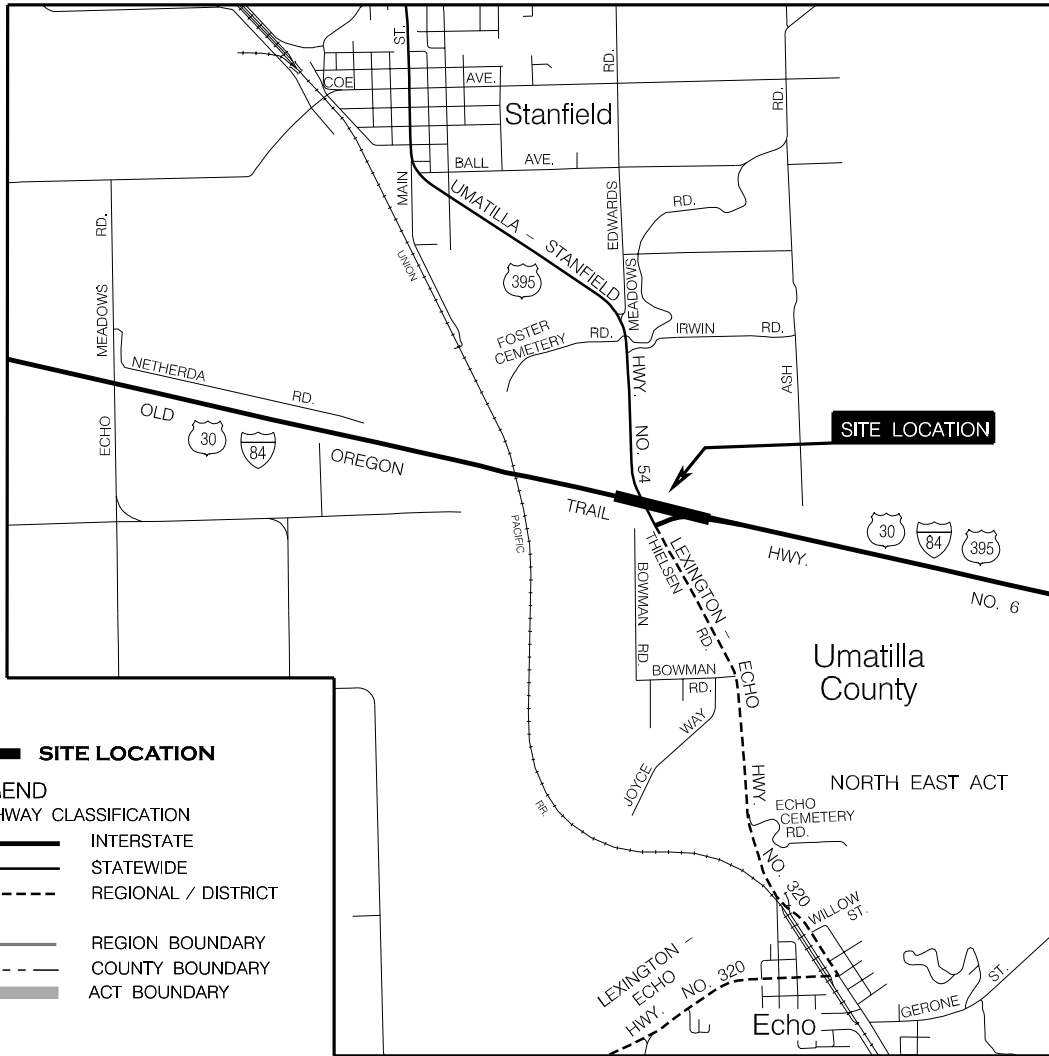

Figure 8
Commercial/Industrial
Cross-section

PROJECT LOCATION

ODOT REGION 5



- LEGEND**
- SITE LOCATION** (thick black line)
 - STATE HIGHWAY CLASSIFICATION**
 - INTERSTATE (double line)
 - STATEWIDE (solid line)
 - REGIONAL / DISTRICT (dashed line)
 - REGION BOUNDARY** (thin solid line)
 - COUNTY BOUNDARY** (dashed line)
 - ACT BOUNDARY** (thick grey line)

STANFIELD ACCESS MANAGEMENT PLAN (STANFIELD INTERCHANGE)

"This product is for informational purposes and may not have been prepared for or be suitable for legal, engineering, or surveying purposes. Users of this information should review or consult the primary data and information sources to ascertain the usability of the information."



SPECIAL PROJECT # 1957
MARCH 2007

PROJECT VICINITY

ODOT REGION 5

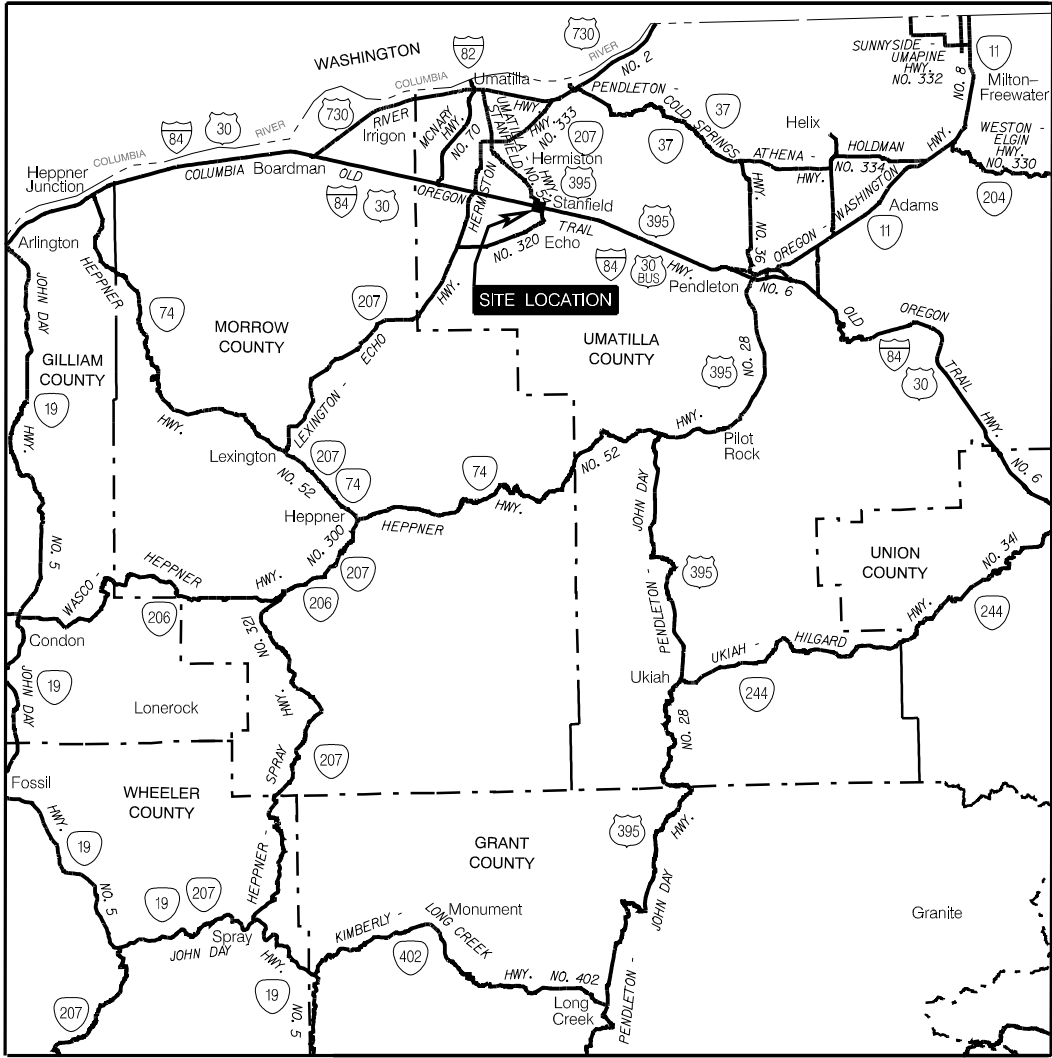

STANFIELD ACCESS MANAGEMENT PLAN (STANFIELD INTERCHANGE)

STATE HIGHWAY -
 COUNTY BOUNDARY -

"This product is for informational purposes and may not have been prepared for or be suitable for legal, engineering, or surveying purposes. Users of this Information should review or consult the primary data and information sources to ascertain the usability of the information."

SCALE
 10 MILES
 SPECIAL PROJECT # 1957
 MARCH 2007

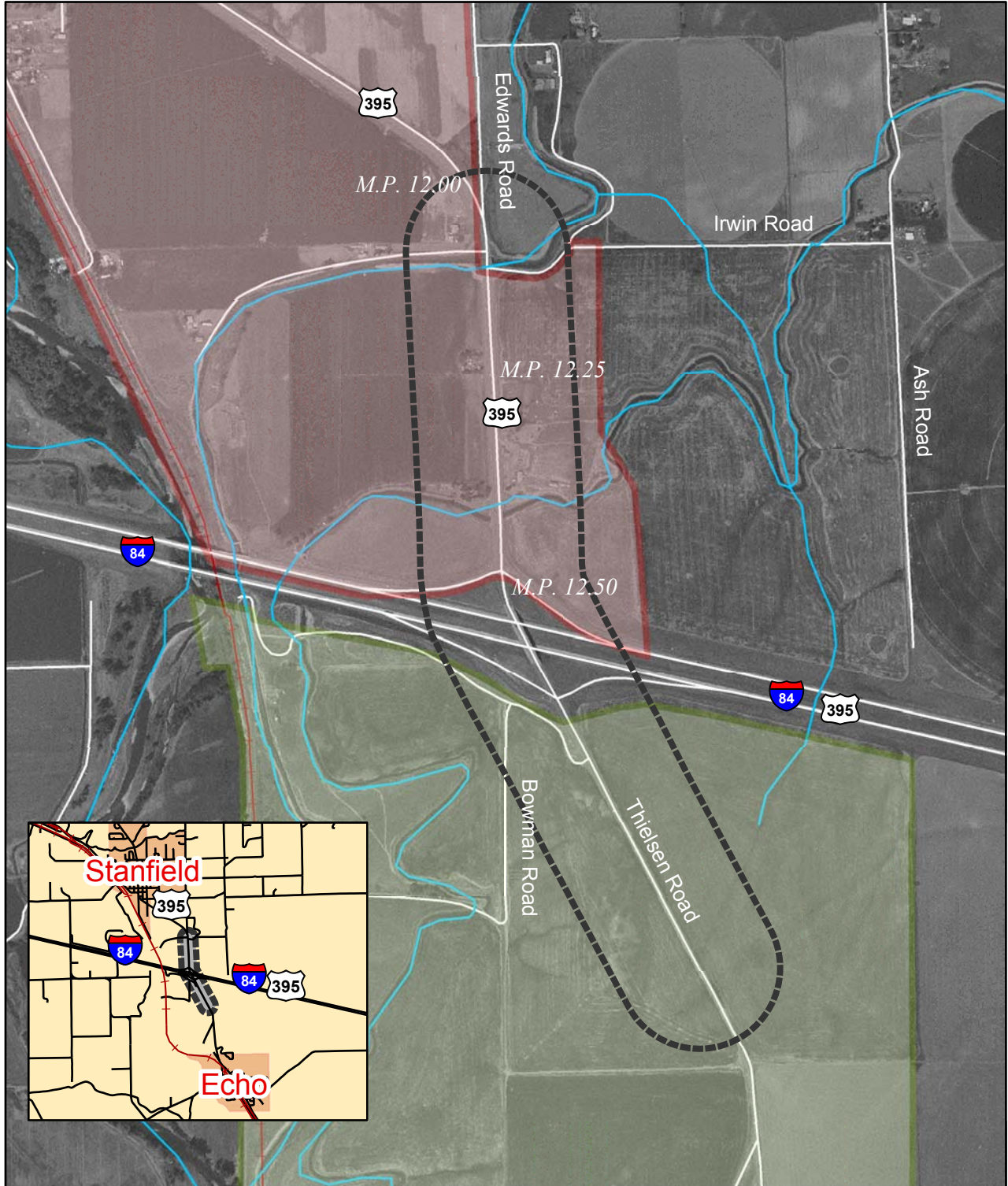

Photo Source: The Oregon Rural Lands Database 2001

Not To Scale

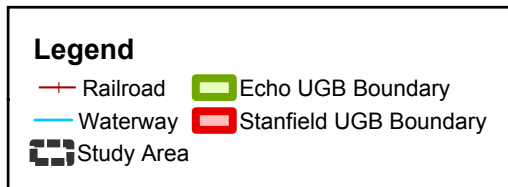

Figure 1
STUDY AREA