

BALMORI ASSOCIATES

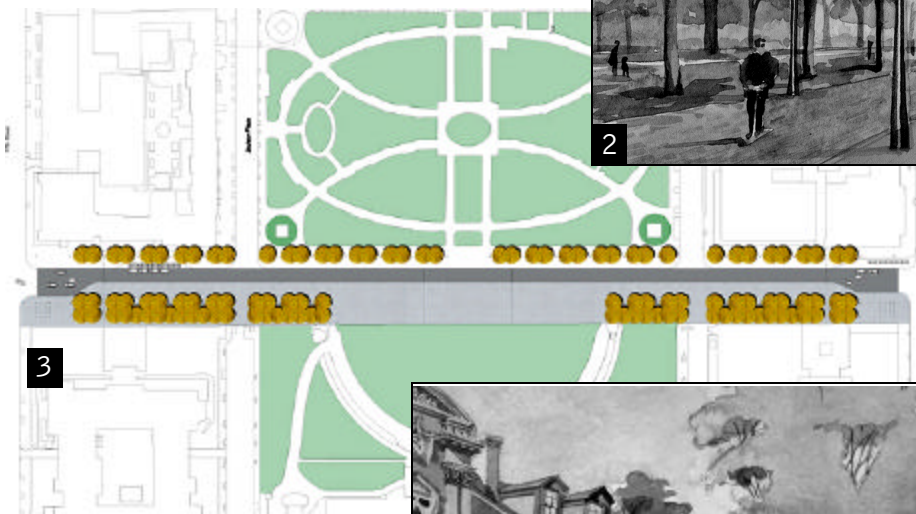

1. The portion of Pennsylvania Avenue is slightly graded to elevate the White House.
2. The design includes a rhythmic grouping of urban furniture and selective lighting that magnifies an atmosphere of civility.
3. Plan of the Avenue between 15th and 17th Streets, NW.
4. Pennsylvania Avenue by the White House becomes a pedestrian boulevard slightly inflected and graded.

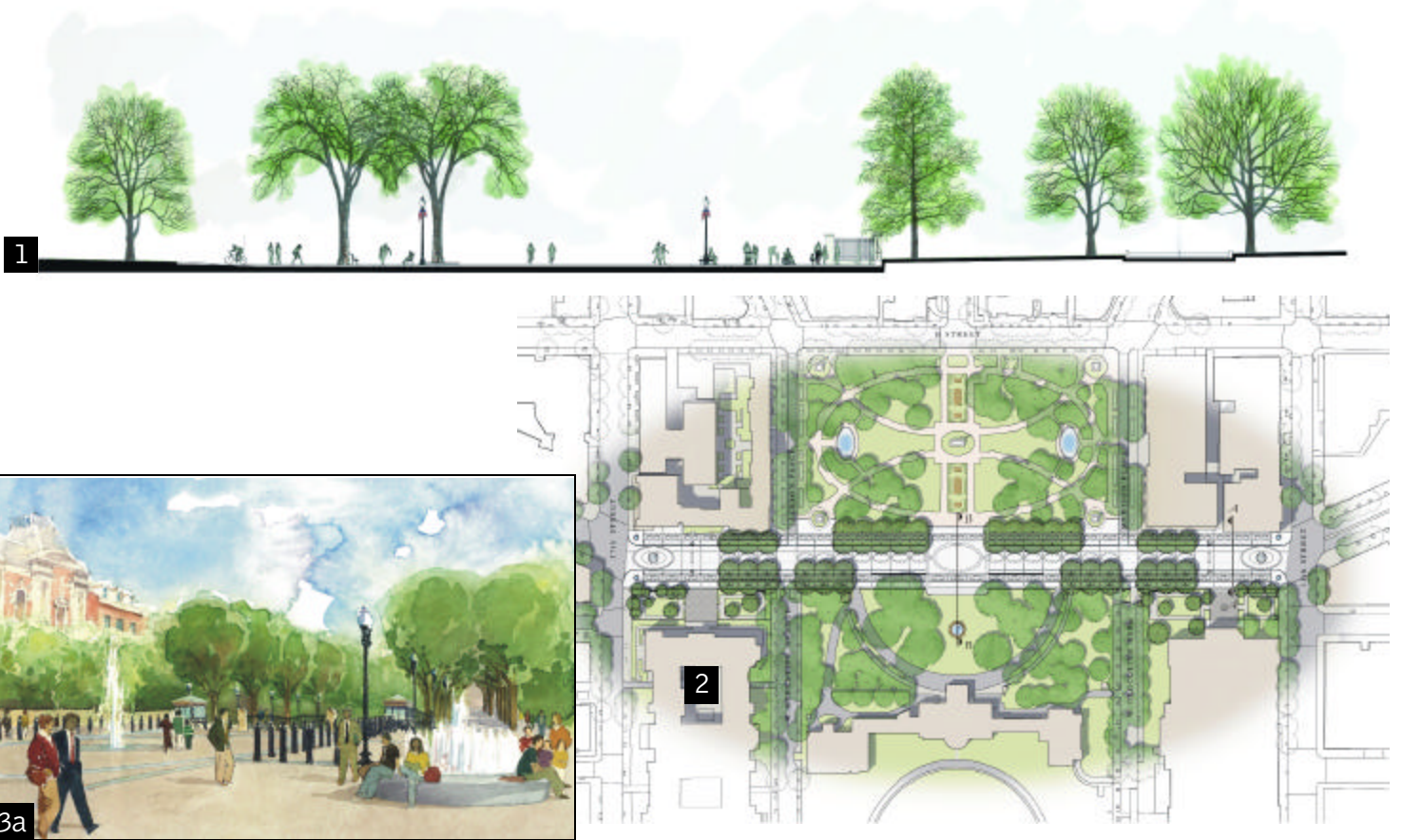

1. Section through the Avenue on the N-S axis of the White House.
2. Plan of the Avenue between 15th and 17th Streets, NW.
3. Pennsylvania Avenue is designed to integrate Lafayette Park with the White House Grounds to create a single, public strolling space. The design, developed from an original sketch by Thomas Jefferson, creates universally accessible strolling, seating and sightseeing spaces along the Avenue. Double allees of great American elms line the Avenue, and continuous benches, lighting, signage and paving patterns enliven and furnish the scene.

MICHAEL VAN VALKENBURGH ASSOCIATES, INC.

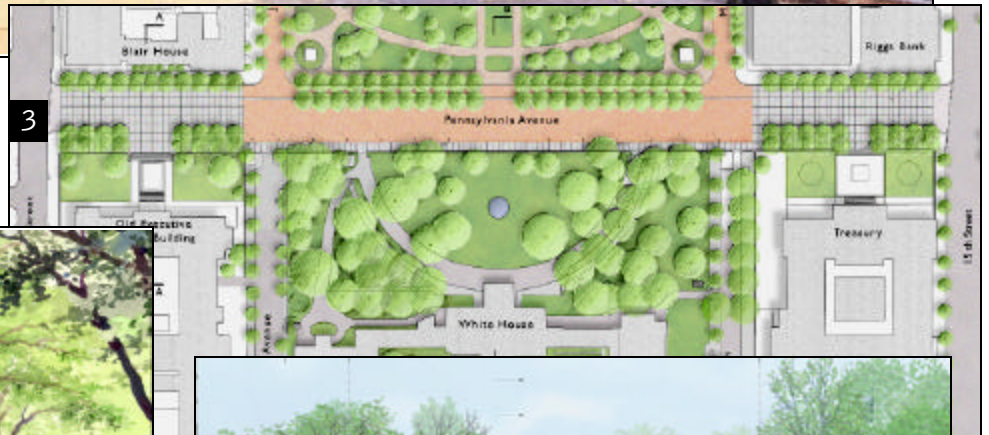

1. The portion of Pennsylvania Avenue between the White House and Lafayette Park has a ground plane surface comprised of a granular paving. This surface would be similar to that used in other renowned civic landscapes around the world.
2. The design includes a simple array of historic Washington light fixtures, stone benches, and discreet bollards.
3. Plan of the Avenue between 15th and 17th Streets, NW.
4. The design creates a pedestrian precinct that preserves the historical axis and existing street pattern while creating an environment that is welcoming, dignified, and able to accommodate multiple uses, including the inaugural parade.
5. Section through the Avenue on the N-S axis of the White House.

PETER WALKER AND PARTNERS

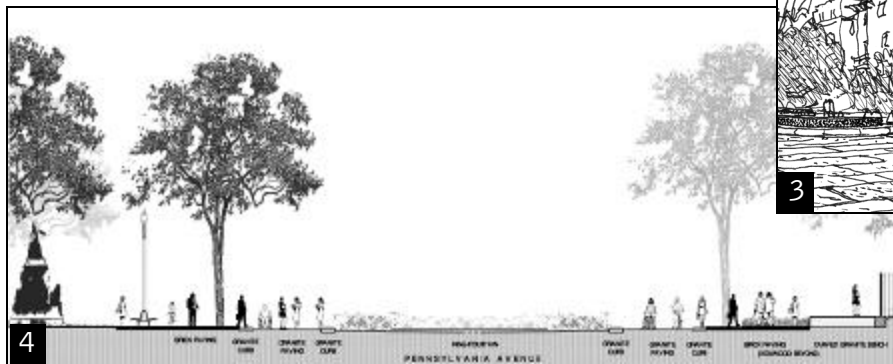
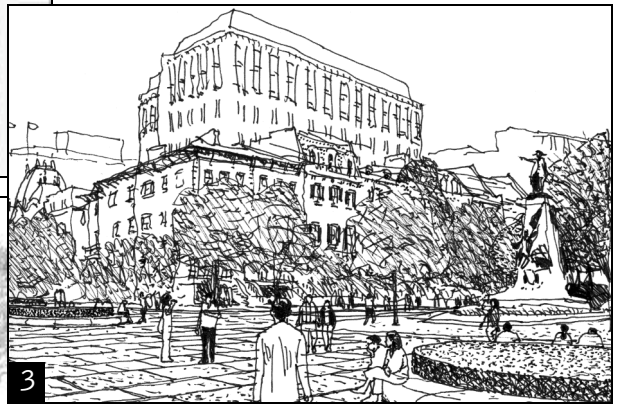
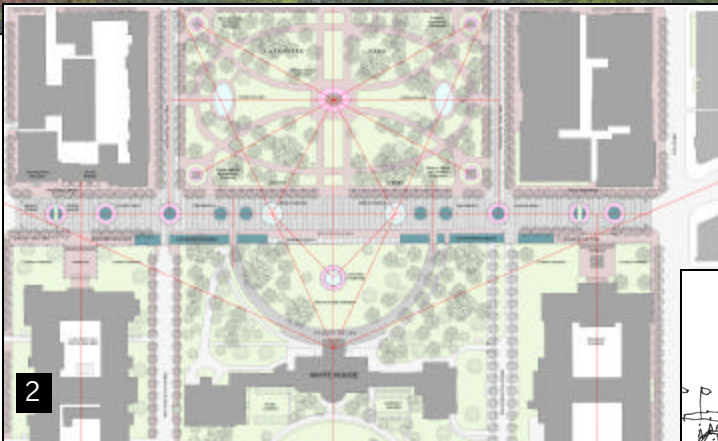
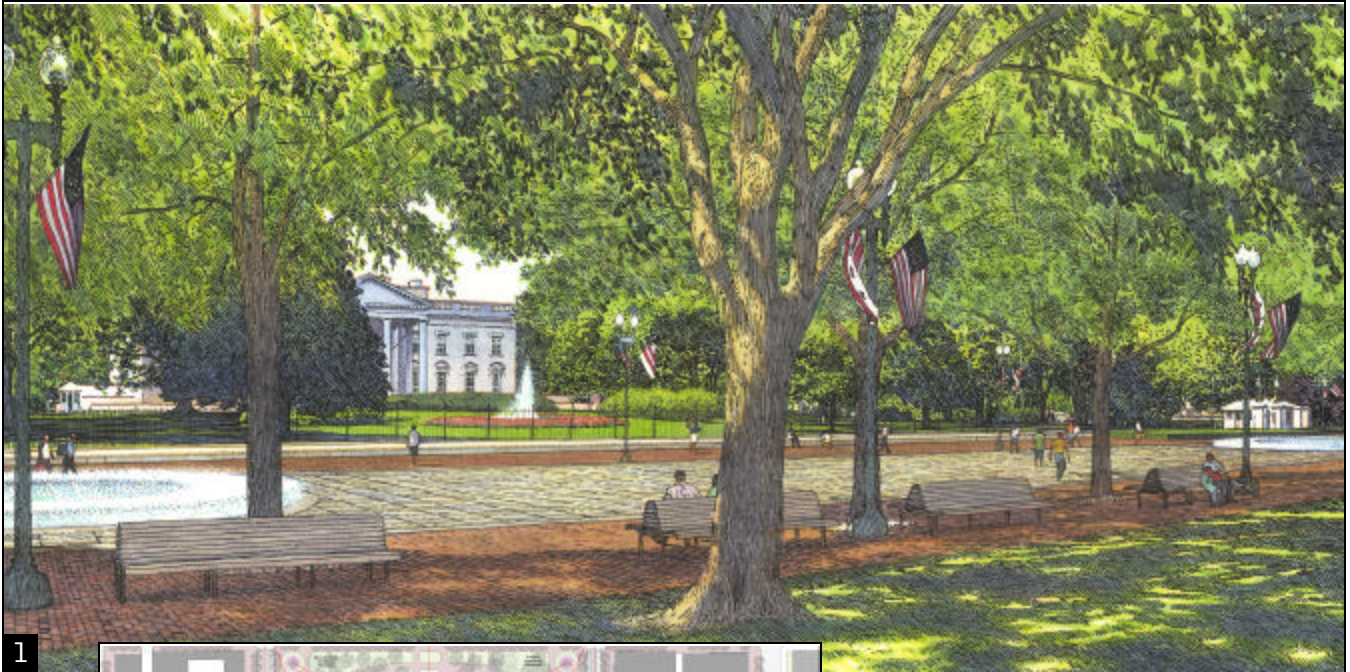

1. Celebrating the Avenue, the design proposes a large-scale granite plank paving framed by carved granite curbs and brick sidewalks. Two low circular fountains are proposed to combine with the existing White House garden fountain.
2. Plan of the Avenue between 15th and 17th Streets, NW.
3. The plan seeks to ensure that the White House Garden and Lafayette Park participate in the street rather than border it. Ten circles composed of hedges, benches, and flowers enliven the expanse of pavement.
4. Section through the Avenue between 15th and 17th Streets, NW.