



## Château de Beaucastel

FAMILLE PERRIN

**Mr. Frank Foote, Director  
Regulations and Rulings Division  
Alcohol and Tobacco Tax and Trade  
Bureau  
1310 G Street, NW Room 200 East  
Washington, D.C. 20220**

Courthezon march 30, 2007

Re: Proposed Paso Robles Westside Viticultural Area – Notice No. 71

Dear Mr. Foote,

I am an owner of Tablas Creek Vineyard in the proposed Paso Robles Westside Viticultural Area at 9339 Adelaida Road (map attached) and am writing to oppose the recognition of that AVA.

The petition misrepresents the “Paso Robles Westside” as a homogeneous viticultural area on the west side of the Salinas River extending from Santa Margarita in the south to San Miguel in the north. As part of its substantiation, petitioner claims on page 6 of its petition that, “[See attachment 12 (Decanter, December 2004)] ‘It was precisely this soil characteristic, [i.e. the high pH] that persuaded the Perrin Brothers of Beaucastel in Chateauneuf-du-Pape that this was the best spot in California to plant Rhone varieties.’”

The inference that we searched the Paso Robles Westside as bounded in the petition is completely false. We spent nearly one year searching and only looked at properties in the Templeton Gap and Adelaida Districts because we felt that the particular soils of these two areas corresponded to our search for high pH soils. We finally chose our property in the Adelaida District because the climate was warmer and more appropriate for ripening Mourvedre and Roussanne grapes than the Templeton Gap. For this same reason, we support the establishment of separate AVAs for the Adelaida District and Templeton Gap. Lumping these two areas together in a long, narrow, north-to-south AVA would not capture any of the viticulturally relevant features in this area and would only misinform consumers in their purchasing decisions.

Because of the above and other incorrect and misleading claims, I request that you reject the proposed Paso Robles Westside Viticultural Area.

Respectfully submitted,

François PERRIN



# Exhibit A

## Map of the West Side Paso Robles Appellation

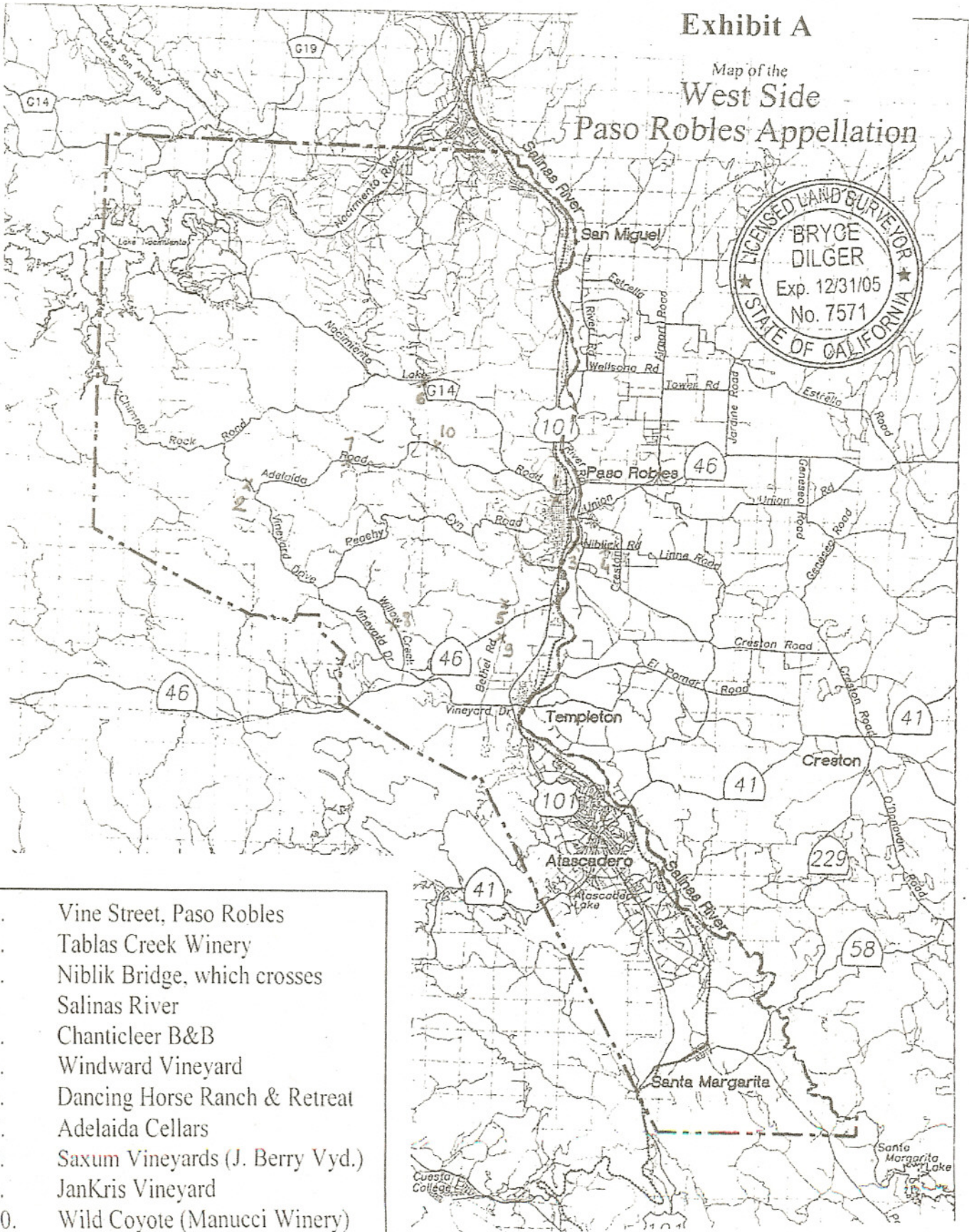
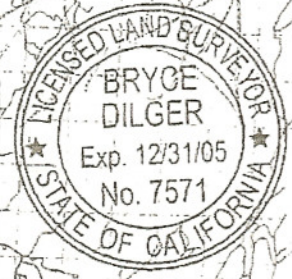

1. Vine Street, Paso Robles
2. Tablas Creek Winery
3. Niblik Bridge, which crosses Salinas River
4. Chanticleer B&B
5. Windward Vineyard
6. Dancing Horse Ranch & Retreat
7. Adelaida Cellars
8. Saxum Vineyards (J. Berry Vyd.)
9. JanKris Vineyard
10. Wild Coyote (Manucci Winery)