

LAND DESCRIPTION DIAGRAM

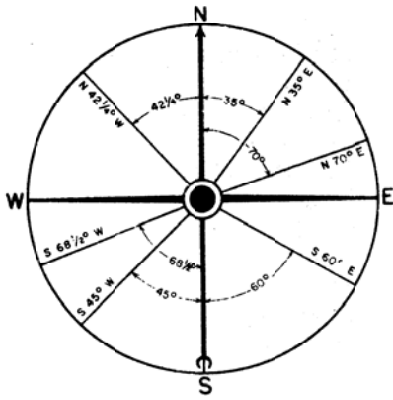

60 seconds equal one minute
60 minutes equal one degree

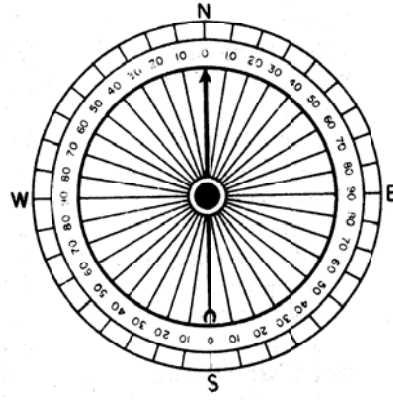

90 degrees in a right angle
360 degrees in a circle

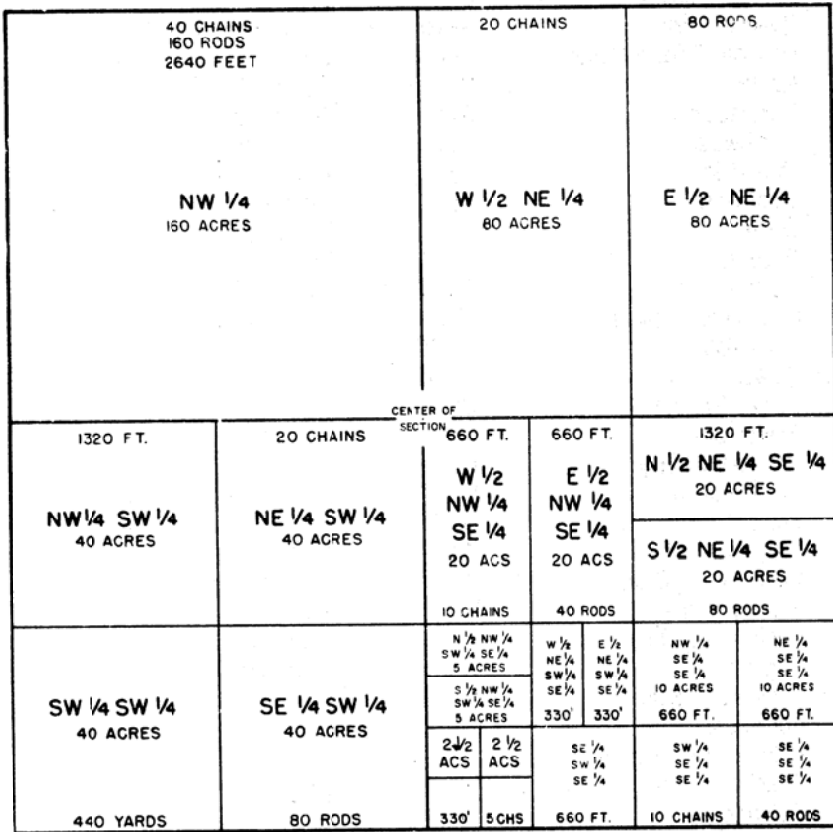

Table of Land Measurements

LINEAR MEASURE	SQUARE MEASURE
1 inch = .0833 ft.	144 sq. in. = 1 sq. foot
7.92 inches = 1 link	9 sq. feet = 1 sq. yard
12 inches = 1 foot	30 1/2 sq. yds. = 1 sq. rod
1 vara = 33 inches	16 sq. rods = 1 sq. chain
2 1/4 feet = 1 vara	1 sq. rod = 272 1/4 sq. ft.
3 feet = 1 yard	1 sq. ch. = 4356 sq. ft.
25 links = 16 1/2 feet	10 sq. chs. = 1 acre
25 links = 1 rod	160 sq. rods = 1 acre
100 links = 1 chain	4840 sq. yds. = 1 acre
16 1/2 feet = 1 rod	43560 sq. ft. = 1 acre
5 1/2 yards = 1 rod	640 acres = 1 sq. mile
4 rods = 100 links	1 sq. mile = 1 section
66 feet = 1 chain	36 sq. miles = 1 Twp.
80 chains = 1 mile	6 miles sq. = 1 Twp.
320 rods = 1 mile	1 sq. mi. = 2.59 sq. kilm
8000 links = 1 mile	
5280 feet = 1 mile	
1760 yards = 1 mile	

An Acre is:

- 43,560 sq. feet.
- 660 feet x 66 feet.
- 165 feet x 264 feet.
- 160 square rods.
- 198 feet x 220 feet.
- 208' 8" square.

or any rectangular tract, the product of the length and width of which totals 43,560 sq. ft.

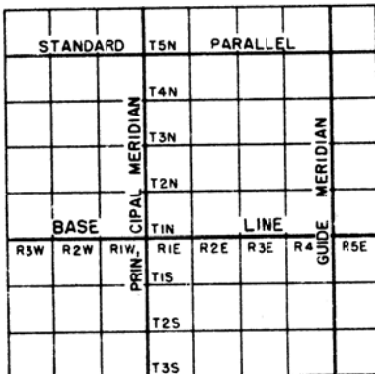

Diagram showing division of tract into Townships



Sectional map of Township showing adjoining Sections

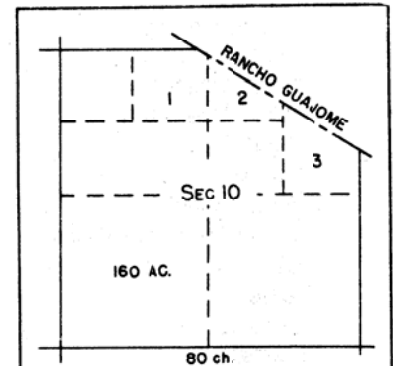

Diagram illustrating division of Fractional Section into Government Lots