

U.S. DEPARTMENT OF THE INTERIOR
BUREAU OF LAND MANAGEMENT

LAND DESCRIPTION DIAGRAM

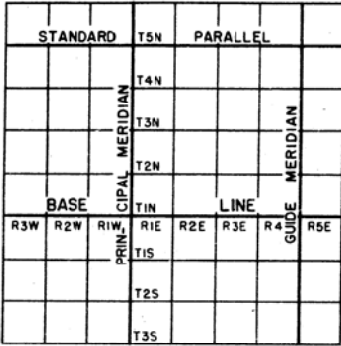

Diagram showing division of tract into Townships

36	31	32	33	34	35	36	31
1	6	5	4	3	2	1	6
12	7	8	9	10	11	12	7
13	18	17	16	15	14	13	18
24	19	20	21	22	23	24	19
25	30	29	28	27	26	25	30
36	31	32	33	34	35	36	31
1	6	5	4	3	2	1	6

Sectional map of Township showing adjoining Sections

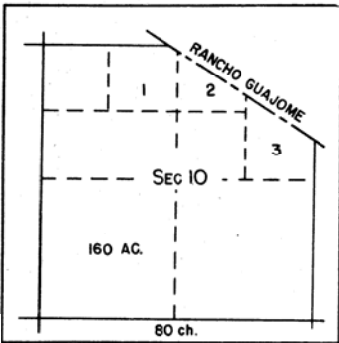
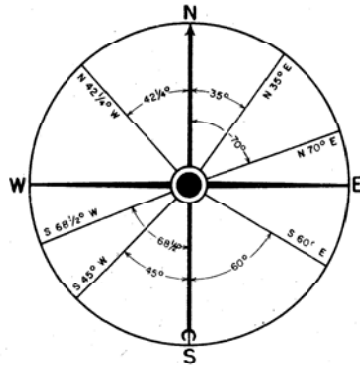
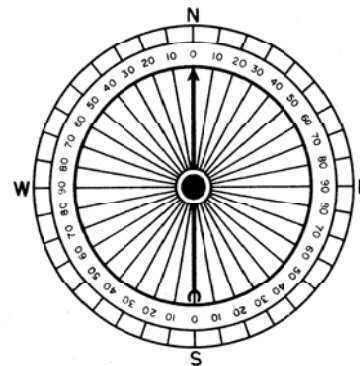

Diagram illustrating division of Fractional Section into Government Lots



60 seconds equal one minute
60 minutes equal one degree



90 degrees in a right angle
360 degrees in a circle

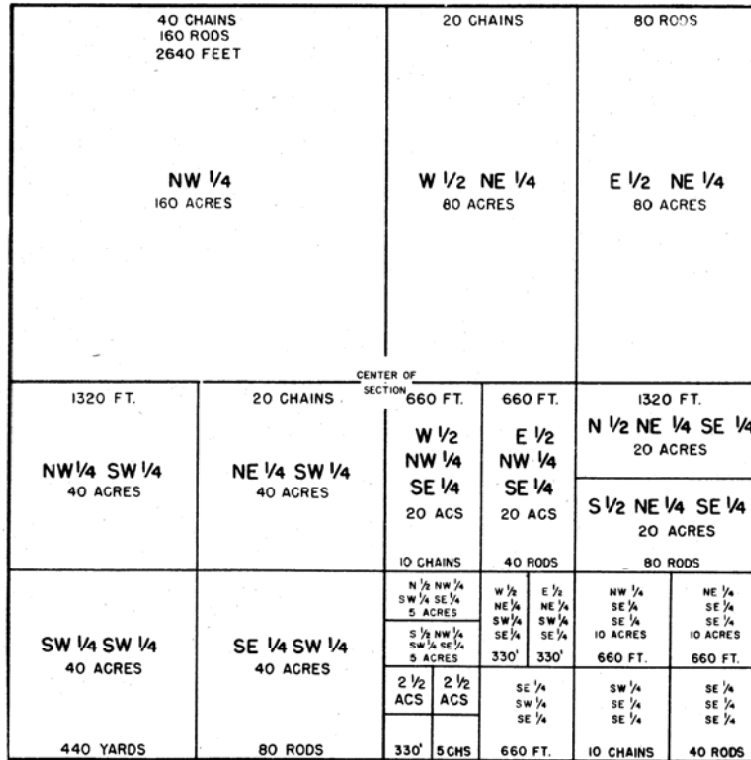

Table of Land Measurements

LINEAR MEASURE	SQUARE MEASURE
1 inch = .0833 ft.	144 sq. in. = 1 sq. foot
7.92 inches = 1 link	9 sq. feet = 1 sq. yard
12 inches = 1 foot	30 1/2 sq. yds. = 1 sq. rod
1 vara = 33 inches	16 sq. rods = 1 sq. chain
2 1/4 feet = 1 vara	1 sq. rod = 272 1/4 sq. ft.
3 feet = 1 yard	1 sq. ch. = 4356 sq. ft.
25 links = 16 1/2 feet	10 sq. chs. = 1 acre
25 links = 1 rod	160 sq. rods = 1 acre
100 links = 1 chain	4840 sq. yds. = 1 acre
16 1/2 feet = 1 rod	43560 sq. ft. = 1 acre
5 1/2 yards = 1 rod	640 acres = 1 sq. mile
4 rods = 100 links	1 sq. mile = 1 section
66 feet = 1 chain	36 sq. miles = 1 Twp.
80 chains = 1 mile	6 miles sq. = 1 Twp.
320 rods = 1 mile	1 sq. mi. = 2.59 sq. kilm
8000 links = 1 mile	
5280 feet = 1 mile	
1760 yards = 1 mile	

An Acre is:

- 43,560 sq. feet.
- 165 feet x 264 feet.
- 198 feet x 220 feet.
- 660 feet x 66 feet.
- 160 square rods.
- 208' 8" square.

or any rectangular tract, the product of the length and width of which totals 43,560 sq. ft.