



How to Show Energy Code Information on the Plan

This pamphlet is one in a series that describes residential energy conservation requirements of the Oregon Residential Specialty Code and the Structural Specialty Code for Group R buildings three stories and less in height. Other pamphlets in this series may be obtained from Oregon Dept of Energy at www.oregon.gov/energy/ or local building departments or from Oregon Building Codes Division.

Using prescriptive options

The following drawings show typical components of residential buildings and energy code details for each path in Table N1104.1(1), "Prescriptive Compliance Paths for Residential Buildings." The drawings are examples and show only energy code details.

Use the drawings and Table N1104.1(1) to make sure all required conservation measures are shown on plans submitted to the building department. Identify the prescriptive path number on the plan.

Using residential thermal performance calculations

If Table 1104.1(2), "Residential Thermal Performance Calculations," is used to demonstrate compliance with energy code, plan drawings should show "Proposed Alternative" conservation measures that are calculated to be thermally equivalent to "Base Path" code measures.

Information presented in this publication supports the Oregon Residential Specialty Code, or Chapter 13 of the Oregon Structural Specialty Code. This publication does not include all code requirements. Refer to the code and check with your code official for additional requirements. If information in this publication conflicts with code or your local officials, follow requirements of code and your local officials.

For more information about the residential energy code, call the Building Codes Division at (503)378-4133 or the Oregon Dept of Energy (503)378-4040 in Salem or toll-free, 1-800-221-8035.

This publication was prepared by Bryan Boe, Oregon State University Extension Energy Program and updated and revised by Alan Seymour, Oregon Dept of Energy for the Oregon Building Codes Division. Illustrations are by Gene Stevenson. Funding was provided by Northwest Energy Efficiency Alliance, Portland General Electric, Northwest Natural Gas, Pacific Power and Light, Bonneville Power Administration, Cascade Natural Gas, WP Natural Gas, and Idaho Power.



Oregon State University Extension Service offers educational programs, activities, and materials without regard to race, color, national origin, sex, or disability as required by Title VI of the Civil Rights Act of 1964 and Title IX of the Education Amendments of 1972, and Section 504 of the Rehabilitation Act of 1973. Oregon State University is an Equal Opportunity Employer.



Contains recycled materials



Figure 1:
Energy Code details for prescriptive path 1

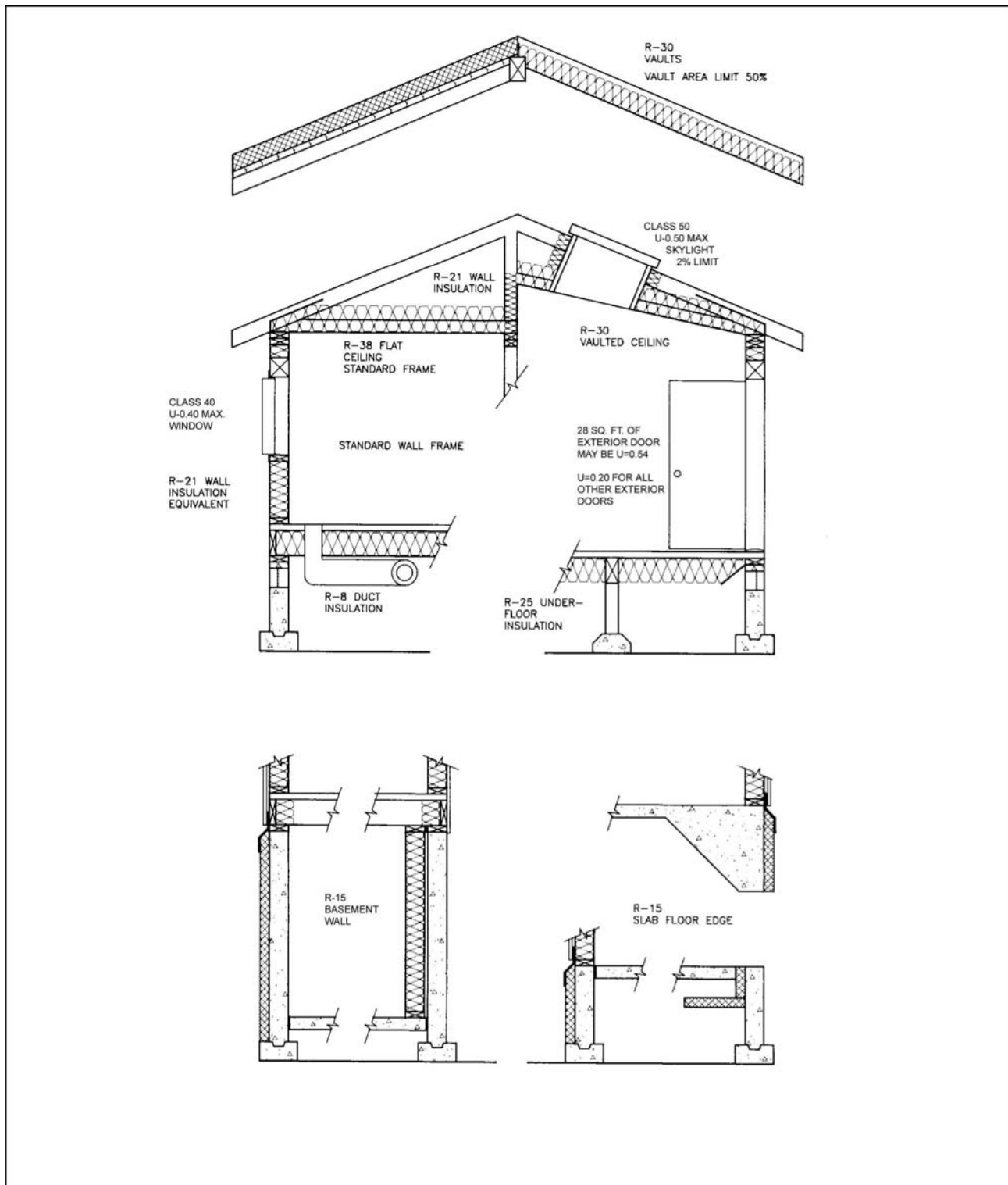

Figure 2:
Energy Code details for prescriptive path 2 - Sun Tempered

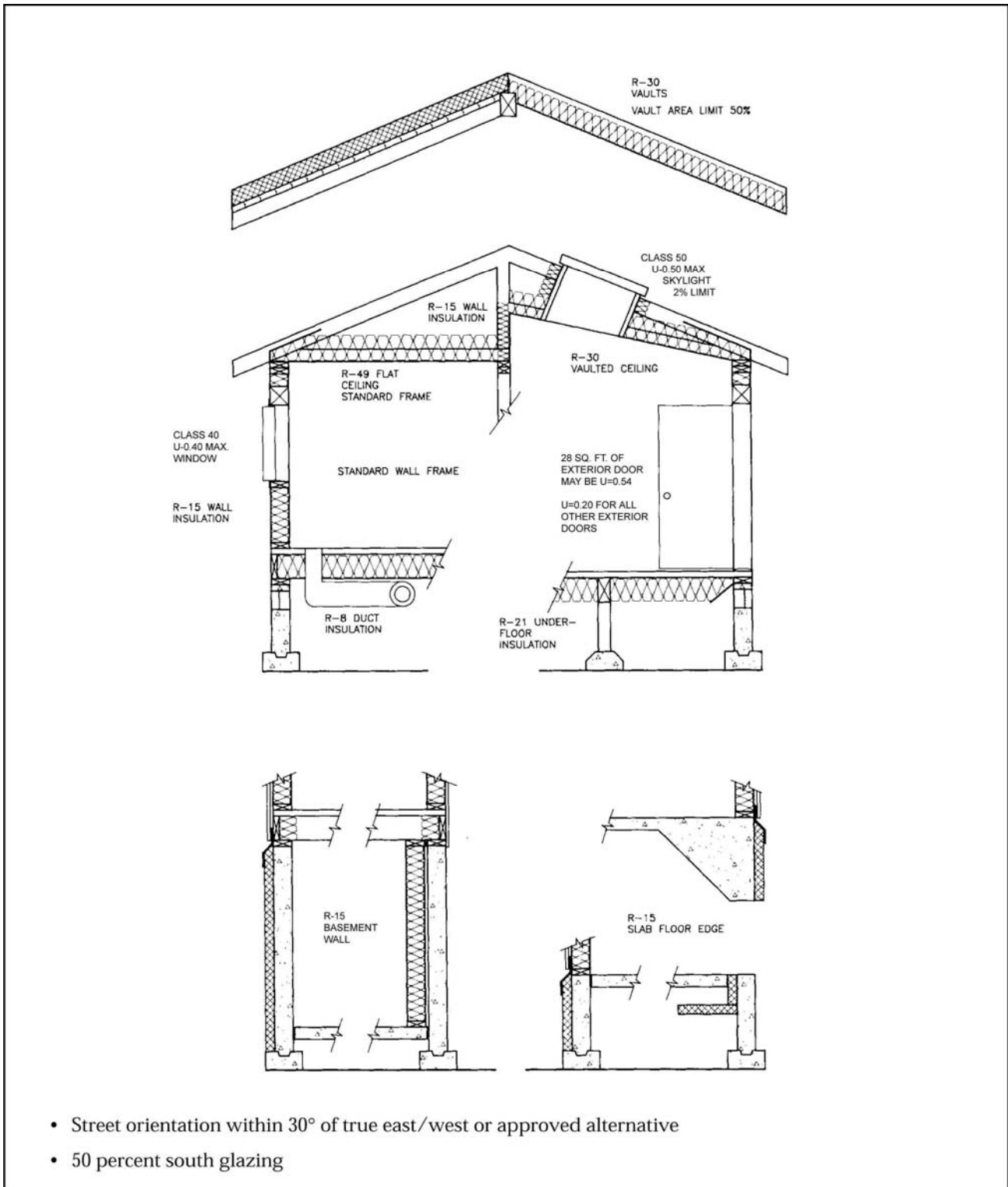

Figure 3:
Energy Code details for prescriptive path 3

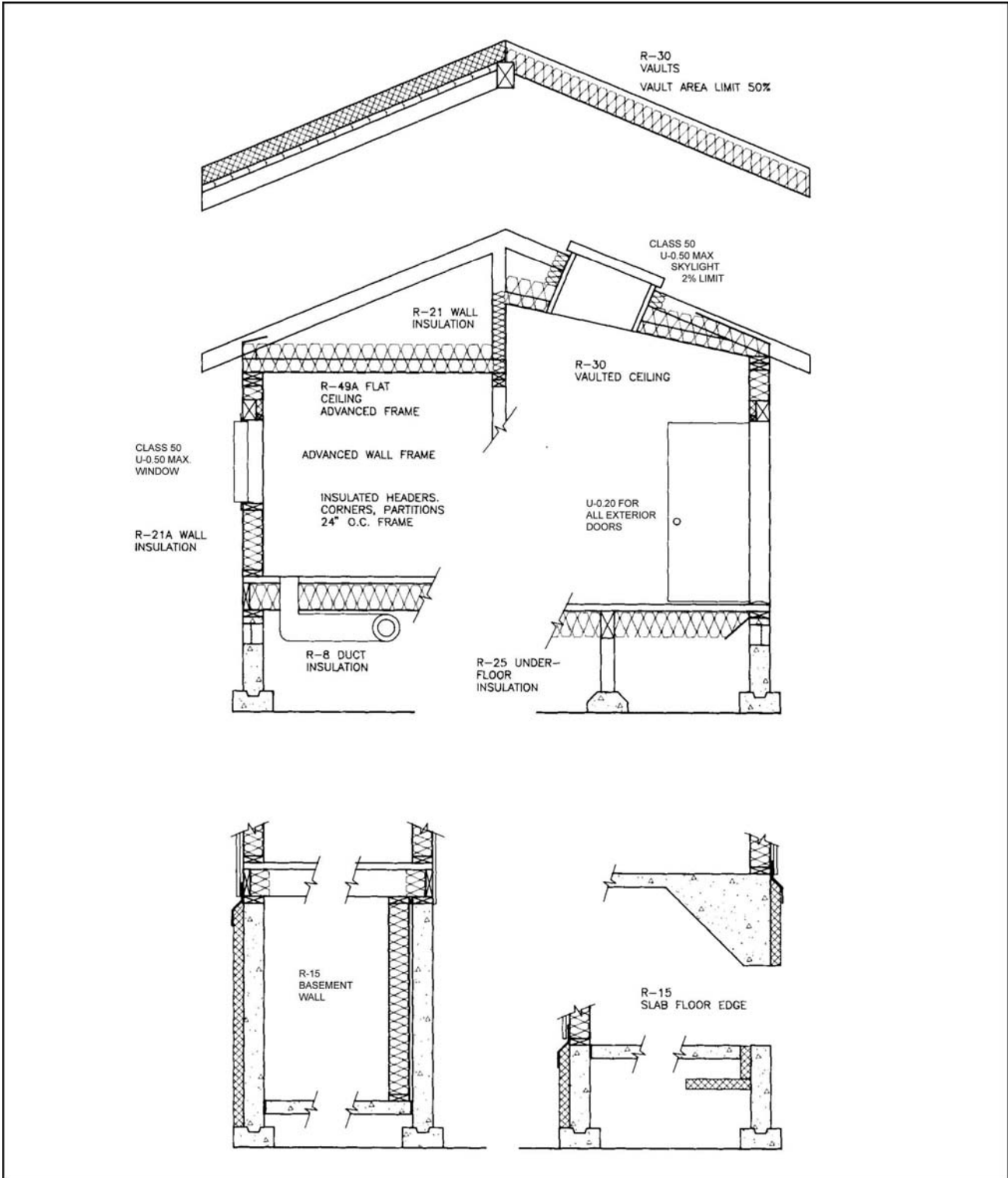
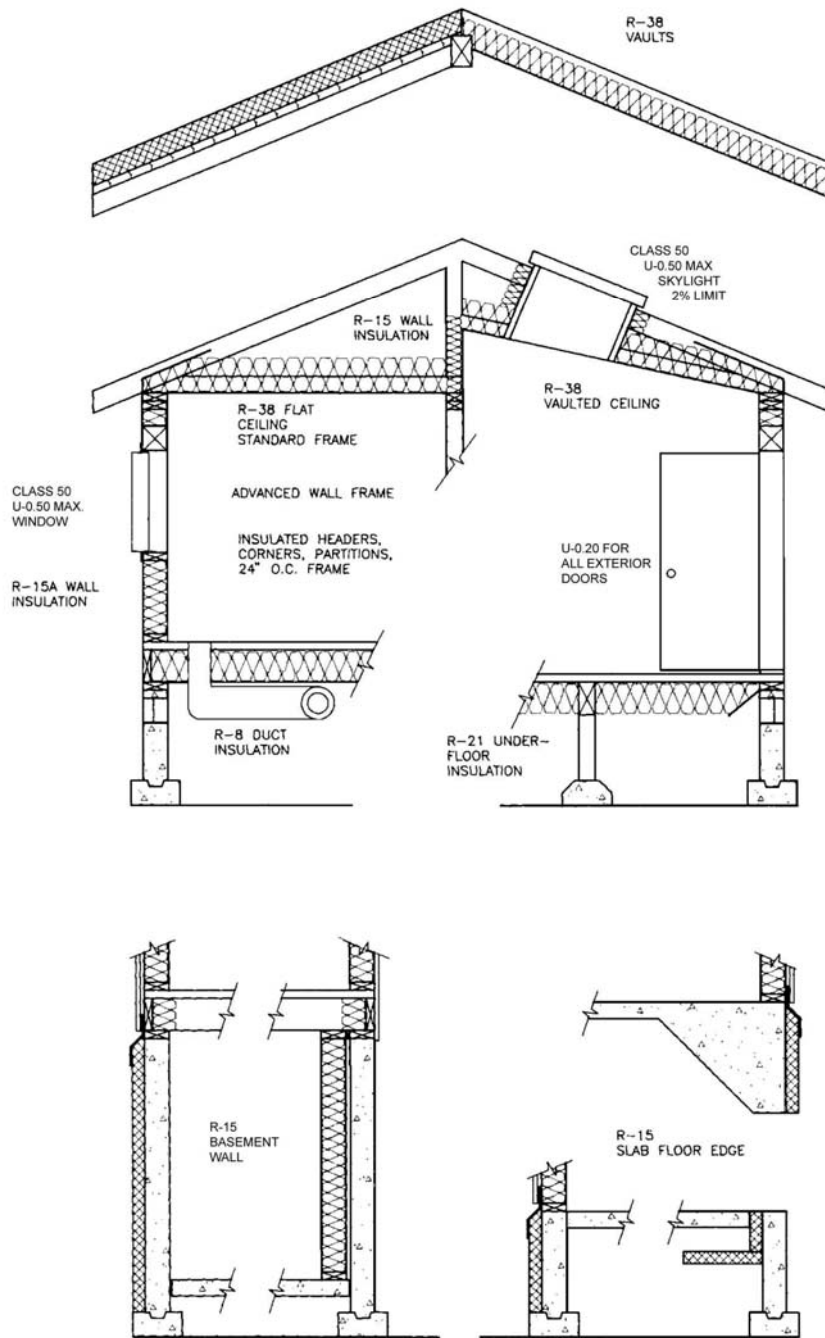

Figure 4:
Energy Code details for prescriptive path 4 - Sun Tempered



- Street orientation within 30° of true east/west or approved alternative
- 50 percent south glazing

Figure 5:
Energy Code details for prescriptive path 5

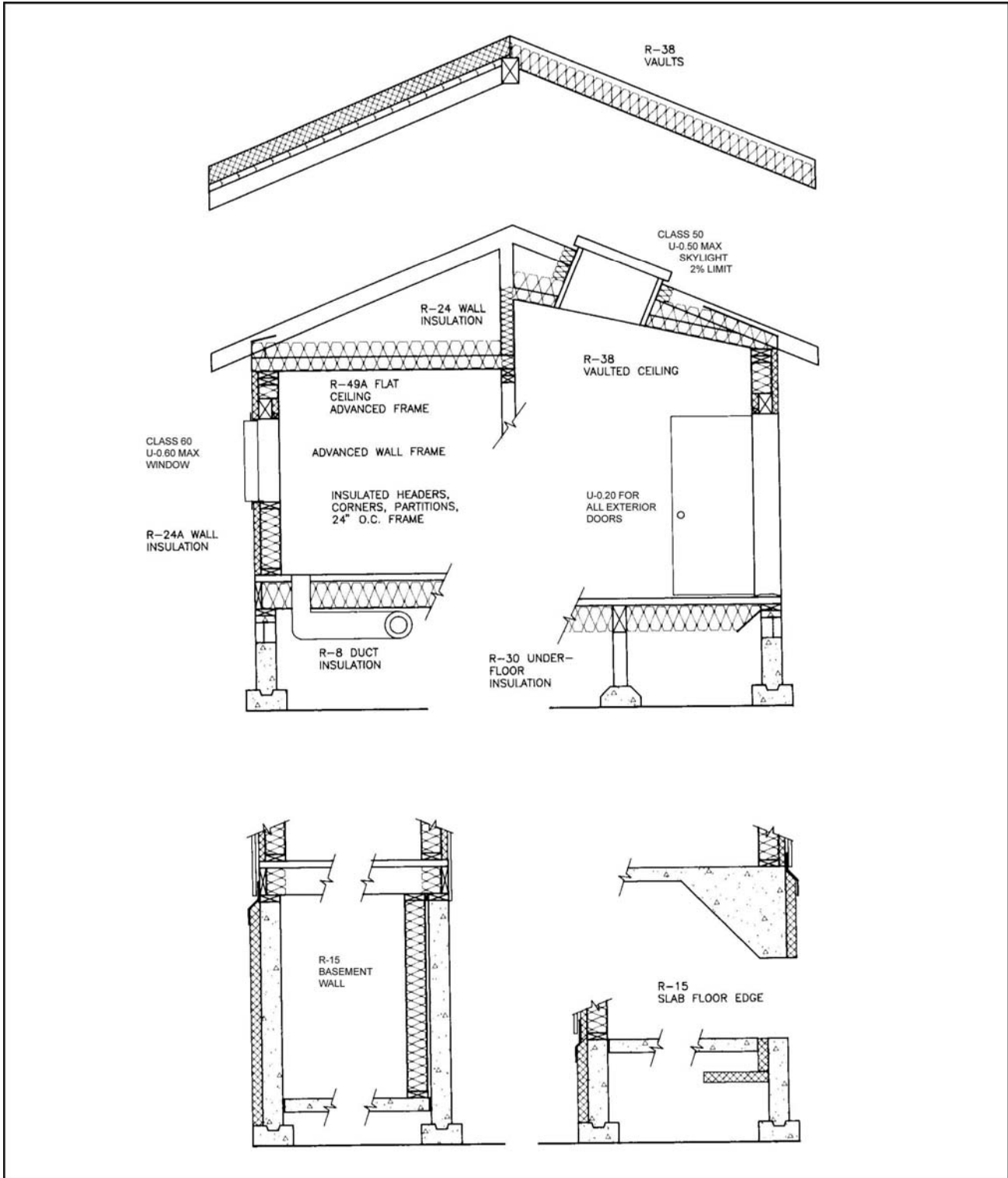

Figure 6:
Energy Code details for prescriptive path 6 - Sun Tempered

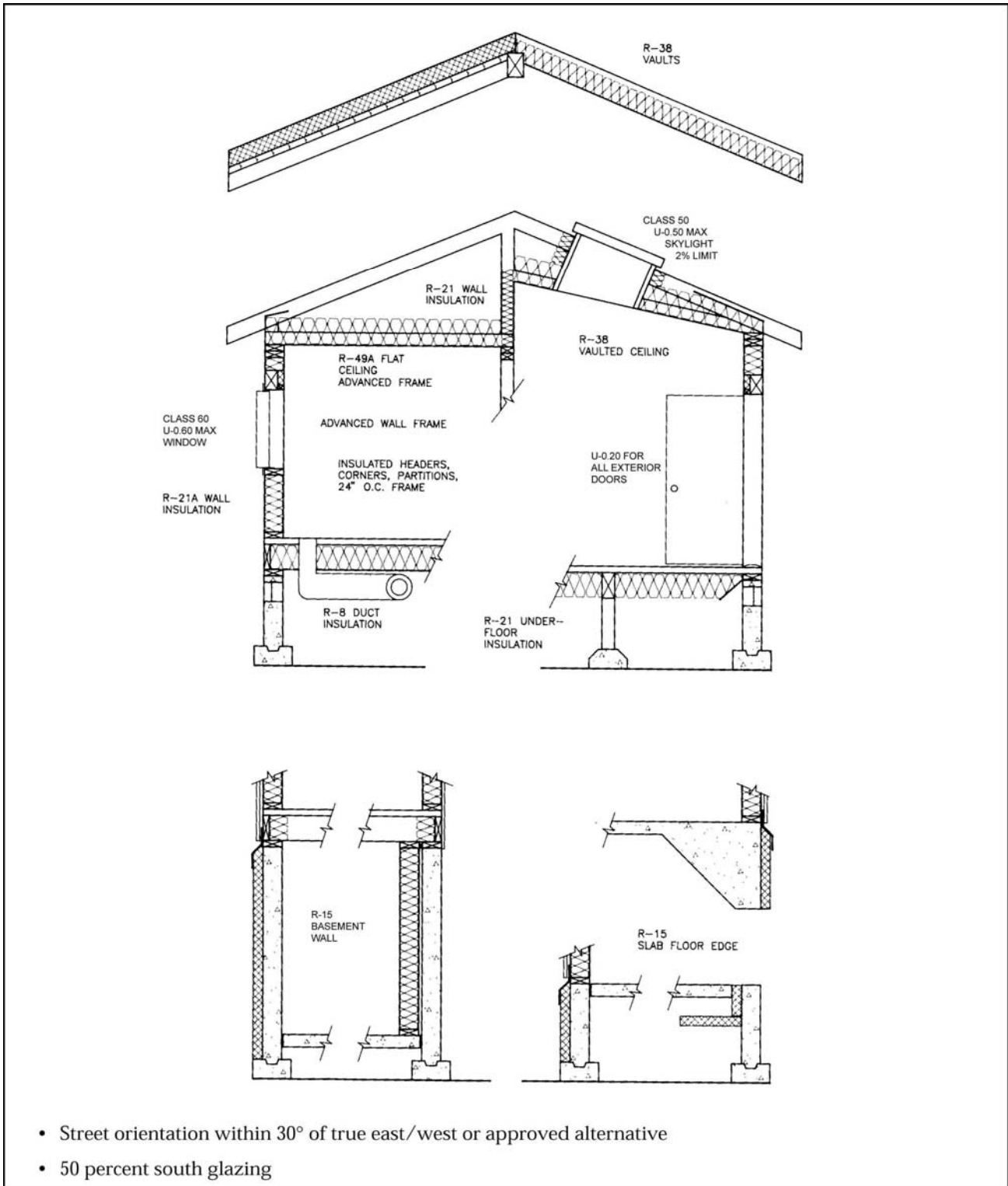
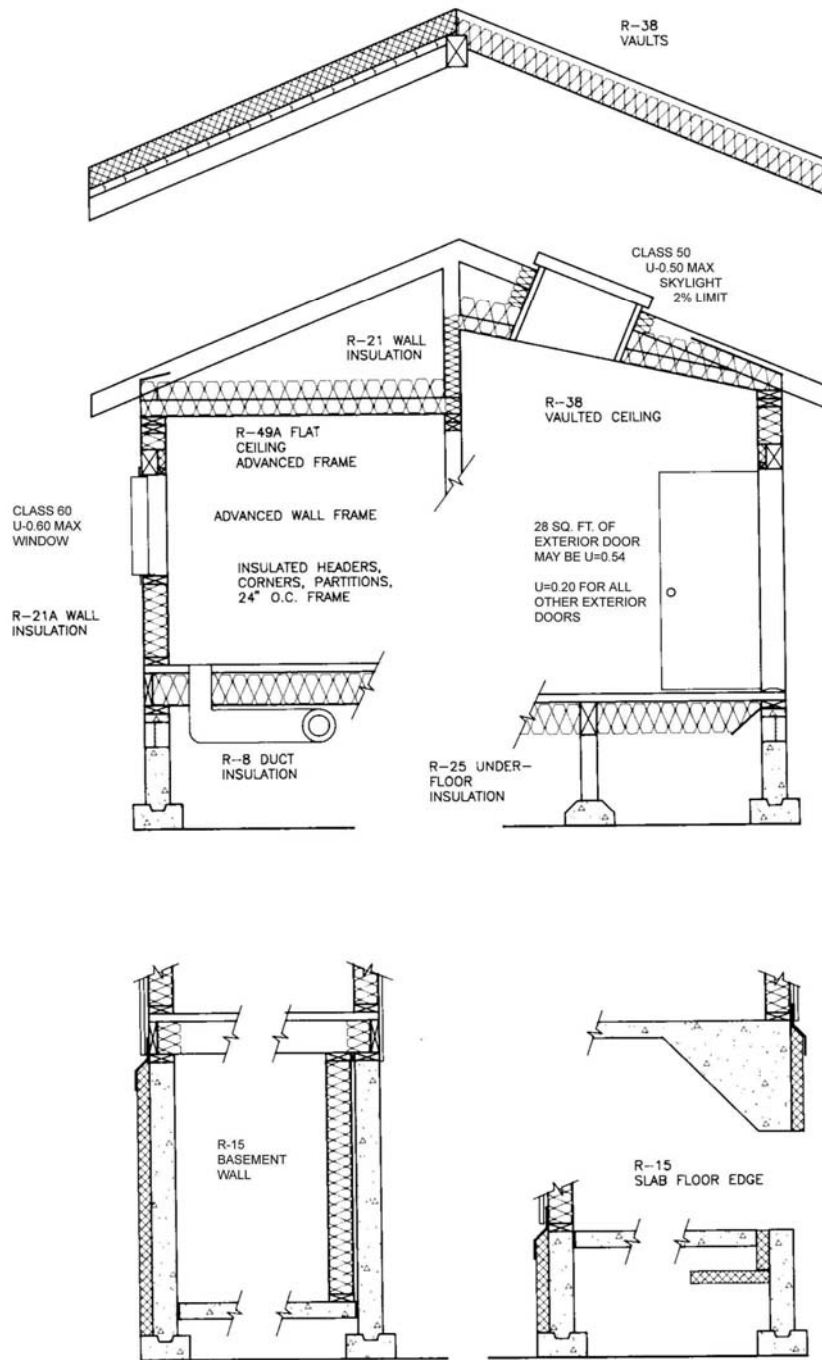

Figure 7:
Energy Code details for prescriptive path 7 - Sun Tempered



- Street orientation within 30° of true east/west or approved alternative
- 50 percent south glazing

Figure 8:
Energy Code details for prescriptive path 8

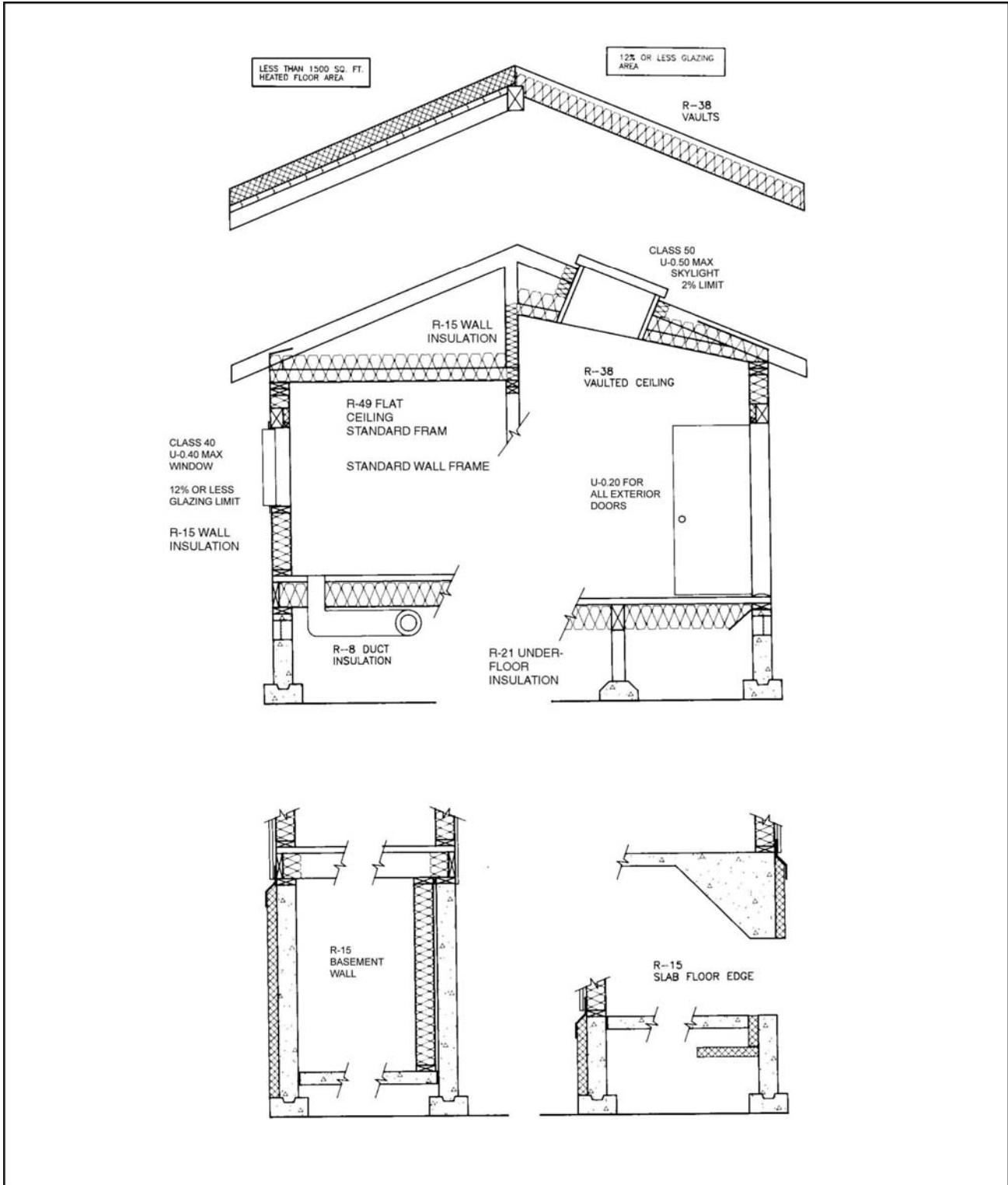

Figure 9:
Energy Code details for prescriptive path 9

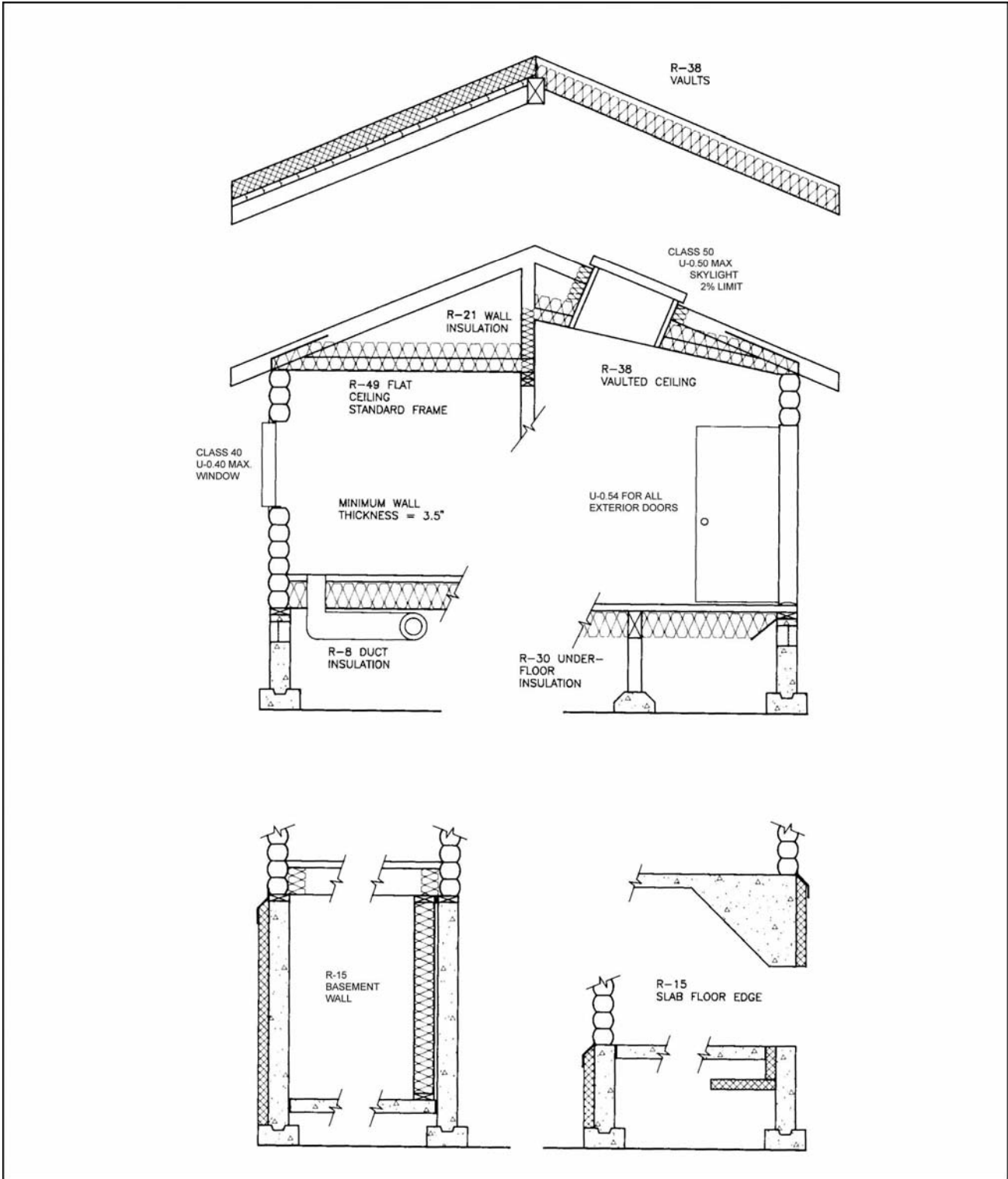

Figure 10:
Energy Code details for prescriptive path 10

