

Base map information including bathymetry was compiled by the U.S. Naval Oceanographic Office. Bathymetry was compiled from National Ocean Service hydrographic surveys and determined by hydrographic information from other sources (see index). NOS bathymetric survey data comply with International Hydrographic Organization (IHO) Publication 44 accuracy standards to those used at the date of the survey. This information is not intended for navigational purposes.

Universal Transverse Mercator Grid. Zone 16. NAD83 waterfalls (0-1) are shown inside the mapline.

©2004 by the U.S. Navy. All rights reserved. This map is the property of the U.S. Navy. It is loaned to you for your use only. It is not to be reproduced, stored in a retrieval system, or transmitted in any form or by any means, electronic, mechanical, photocopying, recording, or by any information storage and retrieval system, without the prior written permission of the U.S. Navy. (OPNAV Form 3800-107)

HYDROGRAPHIC SURVEY INFORMATION			
DATE	NAME	CLASS	STATUS
1994	USNSC 100	USNSC	ACTIVE
1994	USNSC 101	USNSC	ACTIVE
1994	USNSC 102	USNSC	ACTIVE
1994	USNSC 103	USNSC	ACTIVE
1994	USNSC 104	USNSC	ACTIVE
1994	USNSC 105	USNSC	ACTIVE
1994	USNSC 106	USNSC	ACTIVE
1994	USNSC 107	USNSC	ACTIVE
1994	USNSC 108	USNSC	ACTIVE
1994	USNSC 109	USNSC	ACTIVE
1994	USNSC 110	USNSC	ACTIVE
1994	USNSC 111	USNSC	ACTIVE
1994	USNSC 112	USNSC	ACTIVE
1994	USNSC 113	USNSC	ACTIVE
1994	USNSC 114	USNSC	ACTIVE
1994	USNSC 115	USNSC	ACTIVE
1994	USNSC 116	USNSC	ACTIVE
1994	USNSC 117	USNSC	ACTIVE
1994	USNSC 118	USNSC	ACTIVE
1994	USNSC 119	USNSC	ACTIVE
1994	USNSC 120	USNSC	ACTIVE



Published at Washington, D.C.
U.S. DEPARTMENT OF COMMERCE
NATIONAL OCEANIC AND ATMOSPHERIC ADMINISTRATION
NATIONAL OCEAN SERVICE
1994

BATHYMETRIC CONTOUR INTERVALS: 50 METERS TO MAXIMUM DEPTH,
SUPPLEMENTED BY 10-METER INTERVALS

DATUM: MEAN LOWER LOW WATER

TRANSVERSE MERCATOR PROJECTION
Scale 1:250,000

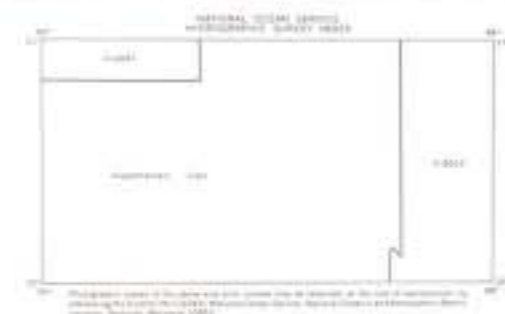

INDEX TO ADJACENT SHEETS			
WEST	EAST	NORTH	SOUTH
15-4	16-4	16-3	16-4
15-5	16-5	16-4	16-5
15-6	16-6	16-5	16-6
15-7	16-7	16-6	16-7
15-8	16-8	16-7	16-8
15-9	16-9	16-8	16-9
15-10	16-10	16-9	16-10
15-11	16-11	16-10	16-11
15-12	16-12	16-11	16-12
15-13	16-13	16-12	16-13
15-14	16-14	16-13	16-14
15-15	16-15	16-14	16-15
15-16	16-16	16-15	16-16
15-17	16-17	16-16	16-17
15-18	16-18	16-17	16-18
15-19	16-19	16-18	16-19
15-20	16-20	16-19	16-20
15-21	16-21	16-20	16-21
15-22	16-22	16-21	16-22
15-23	16-23	16-22	16-23
15-24	16-24	16-23	16-24
15-25	16-25	16-24	16-25
15-26	16-26	16-25	16-26
15-27	16-27	16-26	16-27
15-28	16-28	16-27	16-28
15-29	16-29	16-28	16-29
15-30	16-30	16-29	16-30
15-31	16-31	16-30	16-31
15-32	16-32	16-31	16-32
15-33	16-33	16-32	16-33
15-34	16-34	16-33	16-34
15-35	16-35	16-34	16-35
15-36	16-36	16-35	16-36
15-37	16-37	16-36	16-37
15-38	16-38	16-37	16-38
15-39	16-39	16-38	16-39
15-40	16-40	16-39	16-40
15-41	16-41	16-40	16-41
15-42	16-42	16-41	16-42
15-43	16-43	16-42	16-43
15-44	16-44	16-43	16-44
15-45	16-45	16-44	16-45
15-46	16-46	16-45	16-46
15-47	16-47	16-46	16-47
15-48	16-48	16-47	16-48
15-49	16-49	16-48	16-49
15-50	16-50	16-49	16-50
15-51	16-51	16-50	16-51
15-52	16-52	16-51	16-52
15-53	16-53	16-52	16-53
15-54	16-54	16-53	16-54
15-55	16-55	16-54	16-55
15-56	16-56	16-55	16-56
15-57	16-57	16-56	16-57
15-58	16-58	16-57	16-58
15-59	16-59	16-58	16-59
15-60	16-60	16-59	16-60
15-61	16-61	16-60	16-61
15-62	16-62	16-61	16-62
15-63	16-63	16-62	16-63
15-64	16-64	16-63	16-64
15-65	16-65	16-64	16-65
15-66	16-66	16-65	16-66
15-67	16-67	16-66	16-67
15-68	16-68	16-67	16-68
15-69	16-69	16-68	16-69
15-70	16-70	16-69	16-70
15-71	16-71	16-70	16-71
15-72	16-72	16-71	16-72
15-73	16-73	16-72	16-73
15-74	16-74	16-73	16-74
15-75	16-75	16-74	16-75
15-76	16-76	16-75	16-76
15-77	16-77	16-76	16-77
15-78	16-78	16-77	16-78
15-79	16-79	16-78	16-79
15-80	16-80	16-79	16-80
15-81	16-81	16-80	16-81
15-82	16-82	16-81	16-82
15-83	16-83	16-82	16-83
15-84	16-84	16-83	16-84
15-85	16-85	16-84	16-85
15-86	16-86	16-85	16-86
15-87	16-87	16-86	16-87
15-88	16-88	16-87	16-88
15-89	16-89	16-88	16-89
15-90	16-90	16-89	16-90
15-91	16-91	16-90	16-91
15-92	16-92	16-91	16-92
15-93	16-93	16-92	16-93
15-94	16-94	16-93	16-94
15-95	16-95	16-94	16-95
15-96	16-96	16-95	16-96
15-97	16-97	16-96	16-97
15-98	16-98	16-97	16-98
15-99	16-99	16-98	16-99
15-100	16-100	16-99	16-100

LUND
NOS NG 16-4