

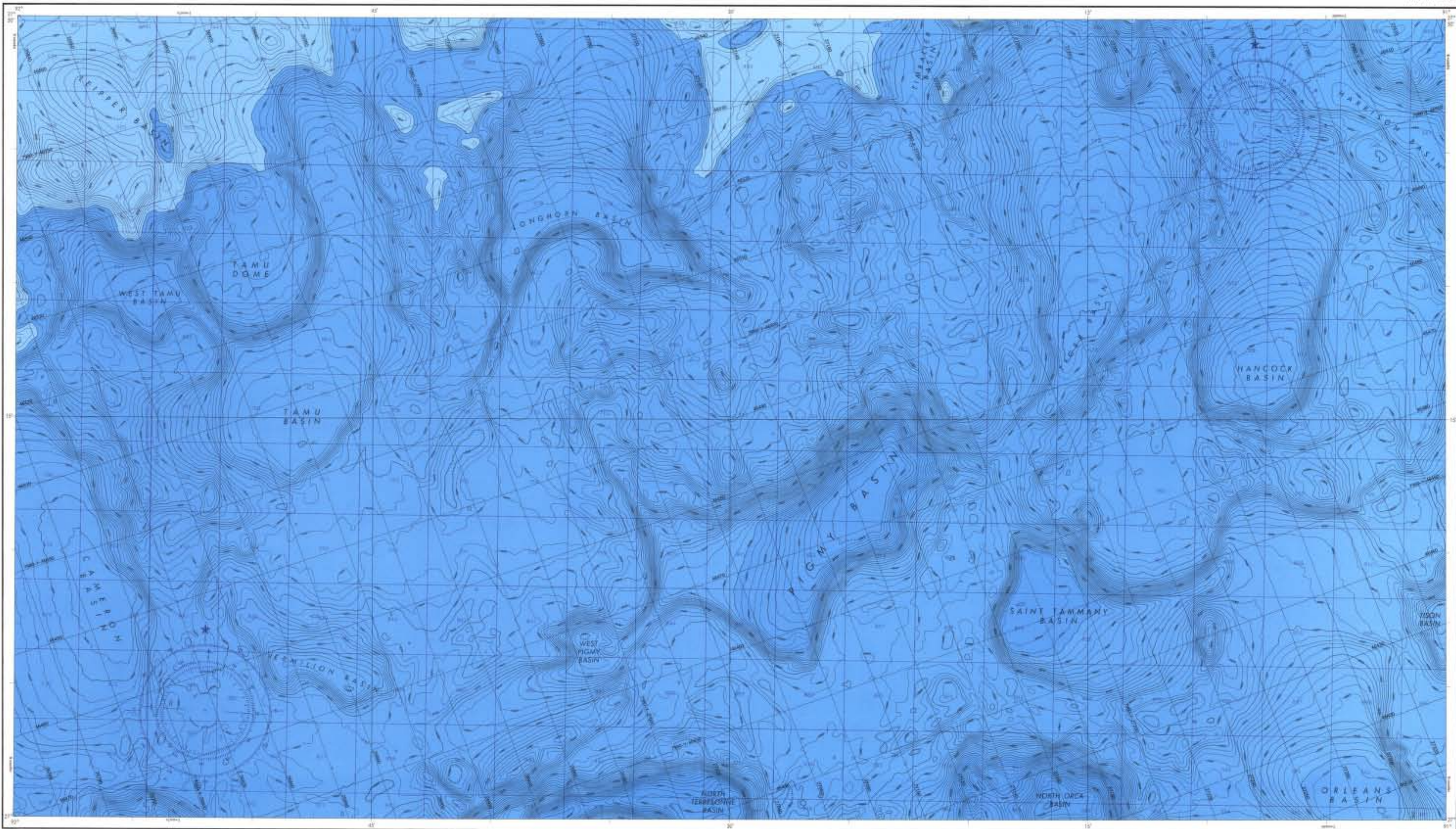

UNITED STATES

BATHYMETRIC MAP

GULF OF MEXICO
PIGMY BASIN



Base map information including bathymetry was compiled by the National Ocean Service (NOS). Bathymetry was compiled from 1932 multibeam survey data (see notes) which comply with International Hydrographic Organization (IHO) Special Publication of Accuracy Standards or those used at the date of the survey. As the map is not intended through flight to be a navigational instrument, for navigational safety, no soundings shall be used as a basis for navigation.

Where precision survey data, limited in magnitude, compiled by the National Ocean Service, Navy fleet hydrographic units, or other sources are available, they are shown in this map.

The information on this map is not for Federal Government purposes for such purposes only by the OCS. OCS is not responsible for any errors or omissions in this map.

Copyright © 1991 by the National Ocean Service, U.S. Department of Commerce. All rights reserved.

North American Datum 1983

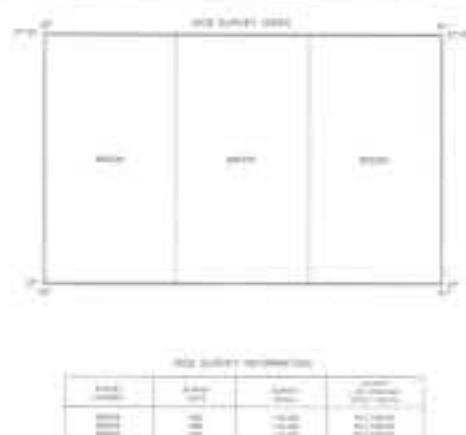

Published at Washington, D.C.
U.S. DEPARTMENT OF COMMERCE
NATIONAL OCEANIC AND ATMOSPHERIC ADMINISTRATION
NATIONAL OCEAN SERVICE
1991

BATHYMETRIC CONTOUR INTERVAL 30 METERS TO MAXIMUM DEPTH

DATUM: MEAN LOWER LOW WATER

SCALE 1:50,000



3-DIMENSIONAL VIEW



PIGMY BASIN
(N270091W)
BATHYMETRIC MAP LM165

TABLE TO ACCOMPANY SHEETS

Sheet	Scale	Area
LM165	1:50,000	1:10,000
LM166	1:50,000	1:10,000
LM167	1:50,000	1:10,000
LM168	1:50,000	1:10,000
LM169	1:50,000	1:10,000
LM170	1:50,000	1:10,000
LM171	1:50,000	1:10,000
LM172	1:50,000	1:10,000
LM173	1:50,000	1:10,000
LM174	1:50,000	1:10,000
LM175	1:50,000	1:10,000
LM176	1:50,000	1:10,000
LM177	1:50,000	1:10,000
LM178	1:50,000	1:10,000
LM179	1:50,000	1:10,000
LM180	1:50,000	1:10,000
LM181	1:50,000	1:10,000
LM182	1:50,000	1:10,000
LM183	1:50,000	1:10,000
LM184	1:50,000	1:10,000
LM185	1:50,000	1:10,000
LM186	1:50,000	1:10,000
LM187	1:50,000	1:10,000
LM188	1:50,000	1:10,000
LM189	1:50,000	1:10,000
LM190	1:50,000	1:10,000
LM191	1:50,000	1:10,000
LM192	1:50,000	1:10,000
LM193	1:50,000	1:10,000
LM194	1:50,000	1:10,000
LM195	1:50,000	1:10,000
LM196	1:50,000	1:10,000
LM197	1:50,000	1:10,000
LM198	1:50,000	1:10,000
LM199	1:50,000	1:10,000
LM200	1:50,000	1:10,000

U.S. Government Printing Office
Washington, D.C. 20540-0001
5010-108/91
GPO : 1991