

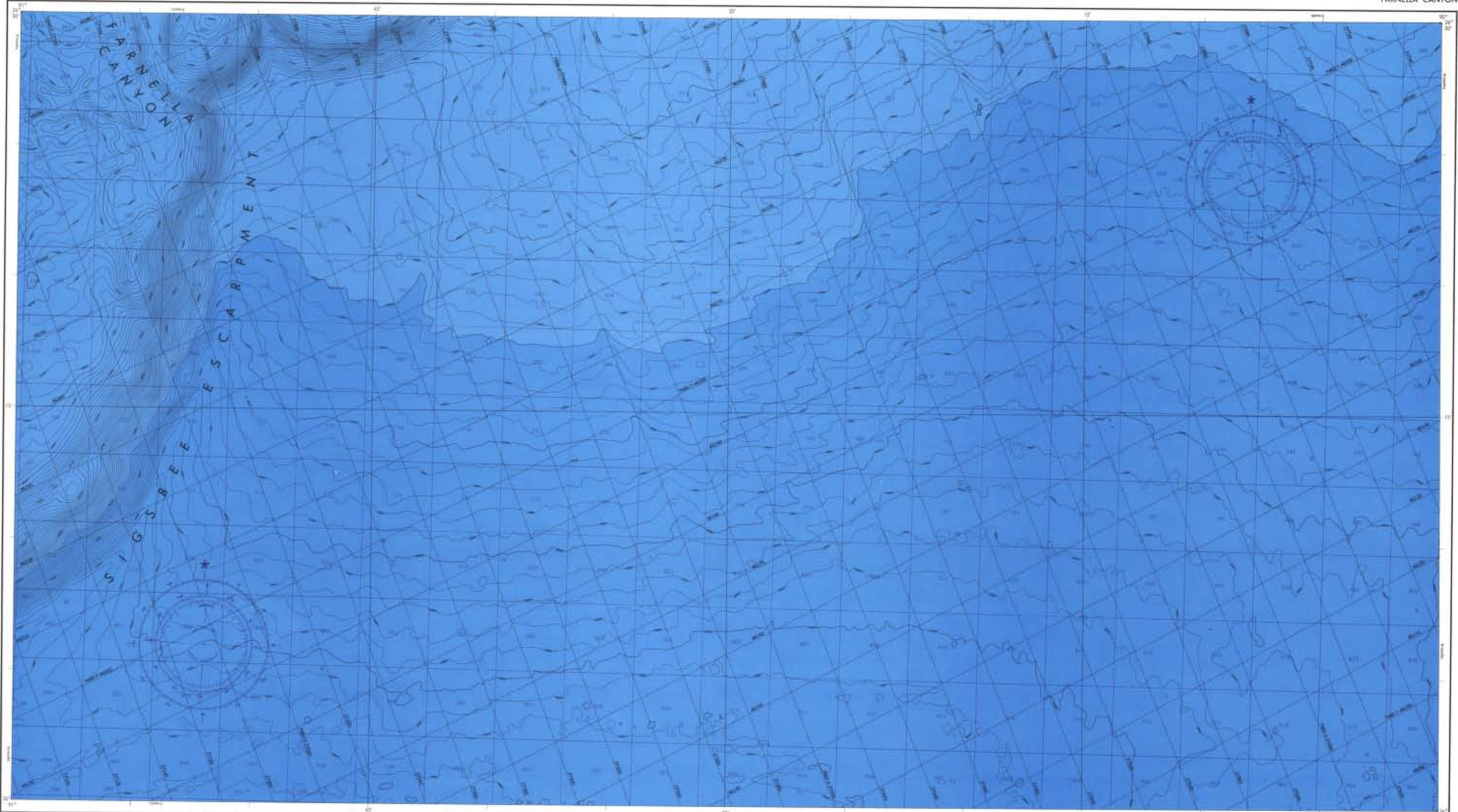

UNITED STATES

# BATHYMETRIC MAP

GULF OF MEXICO  
FARNELLA CANYON



Best bathymetric information (including bathymetry) was compiled by the National Ocean Service (NOS). Bathymetry was compiled from ADCIRC multibeam sonar data (see initial chart number) with International Hydrographic Organization (IHO) Sounding Publication 44 accuracy standards or their read or the date of the survey. As this map is not maintained through NOAA's Maintenance System for logical and sequential updates, this product is not intended for navigational purposes. For navigational safety, mariners must use updated charts.

Offshore position lines were derived or adapted, courtesy of the Maritime Transportation Security Act (MTSA) from NOAA's Office of Marine and Coastal Affairs (OMCA). The information on this map was not used for Federal listing purposes. For additional information, refer to the OGC Official Publication Database available from the National Ocean Service.

Geographic Names Authority (GNA) (see 16 CFR 101.10) (see 16 CFR 101.10) (see 16 CFR 101.10)

Depth Reference Datum (DRD)

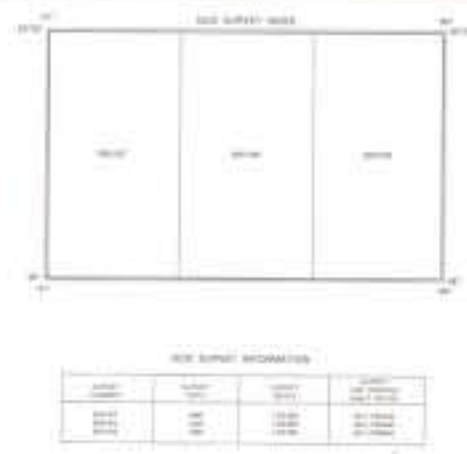

Published at Washington, D.C.  
U.S. DEPARTMENT OF COMMERCE  
NATIONAL OCEANIC AND ATMOSPHERIC ADMINISTRATION  
NATIONAL OCEAN SERVICE  
1991

BATHYMETRIC CONTOUR INTERVAL: 20 METERS TO MAXIMUM DEPTH

DATUM: MEAN LOWER LOW WATER

SCALE 1:10,000



3-DIMENSIONAL VIEW

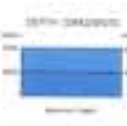

FARNELLA CANYON  
(N260090W)  
BATHYMETRIC MAP LM145

INDEX TO ADJACENT SHEETS

|       |       |       |
|-------|-------|-------|
| LM144 | LM145 | LM146 |
| LM147 | LM148 | LM149 |

NOAA Administration: 222 R Street, SW  
Washington, DC 20543  
U.S. GOVERNMENT PRINTING OFFICE: 1991

