

Big Blue No. 7 Mine



- Superintendent
- T Smith

2004 WKMI MINE RESCUE CONTEST
June 9, 2004
SUPERINTENDENT'S STATEMENT

MY NAME IS _____. I AM SUPERINTENDENT OF THE BIG BLUE No. 7 MINE. THANK YOU FOR ANSWERING OUR CALL FOR HELP. YOU ARE LOCATED AT THE FRESH AIR BASE ESTABLISHED BY STATE TEAMS.

EARLY THIS MORNING, Four (4) MEN ENTERED THE No. 3 SECTION TO RUN COAL. AT APPROXIMATELY 5:00 A.M. THE FACE BOSS CALLED OUTSIDE AND SAID AN EXPLOSION HAD JUST OCCURRED AND THAT HE WAS GOING TO LOOK FOR HIS CREW.

THE NO. 3 SECTION HAS 4 ENTRIES THAT ARE BEING DEVELOPED FOR THE NEW NO.7 MINE. THE BLOWING FAN ON THE SURFACE IS RUNNING AND CANNOT BE REVERSED OR STOPPED. A 9 FOOT AIR SHAFT WITH EXHAUST FAN ON THE SURFACE HAS ALSO BEEN DEVELOPED ON THE NO.3 SECTION. THE EXHAUST FAN IS OFF, BUT CAN TURNED ON AND OFF IF NEEDED.

ALL ELECTRICAL CIRCUITS HAVE BEEN DE-ENERGIZED, LOCKED OUT AND GUARDED. STATE TEAM 'BLUE' IS HERE TO SERVE AS BACK-UP AND WORK OUTBY IF NEEDED. MAPS SHOWING VENTILATION BEFORE AND AFTER THE INCIDENT WILL BE GIVEN TO YOU.

THE MINE MAPS ARE UP-TO-DATE.

WE HAVE A COMPETENT LIFELINE PERSON TO GIVE AND RETURN SIGNALS (POINT THIS PERSON OUT).

WRITTEN INSTRUCTIONS AND MINE MAPS WILL BE PROVIDED WHEN YOU ARE READY TO WORK

NON-PRODUCING #1 SECTION

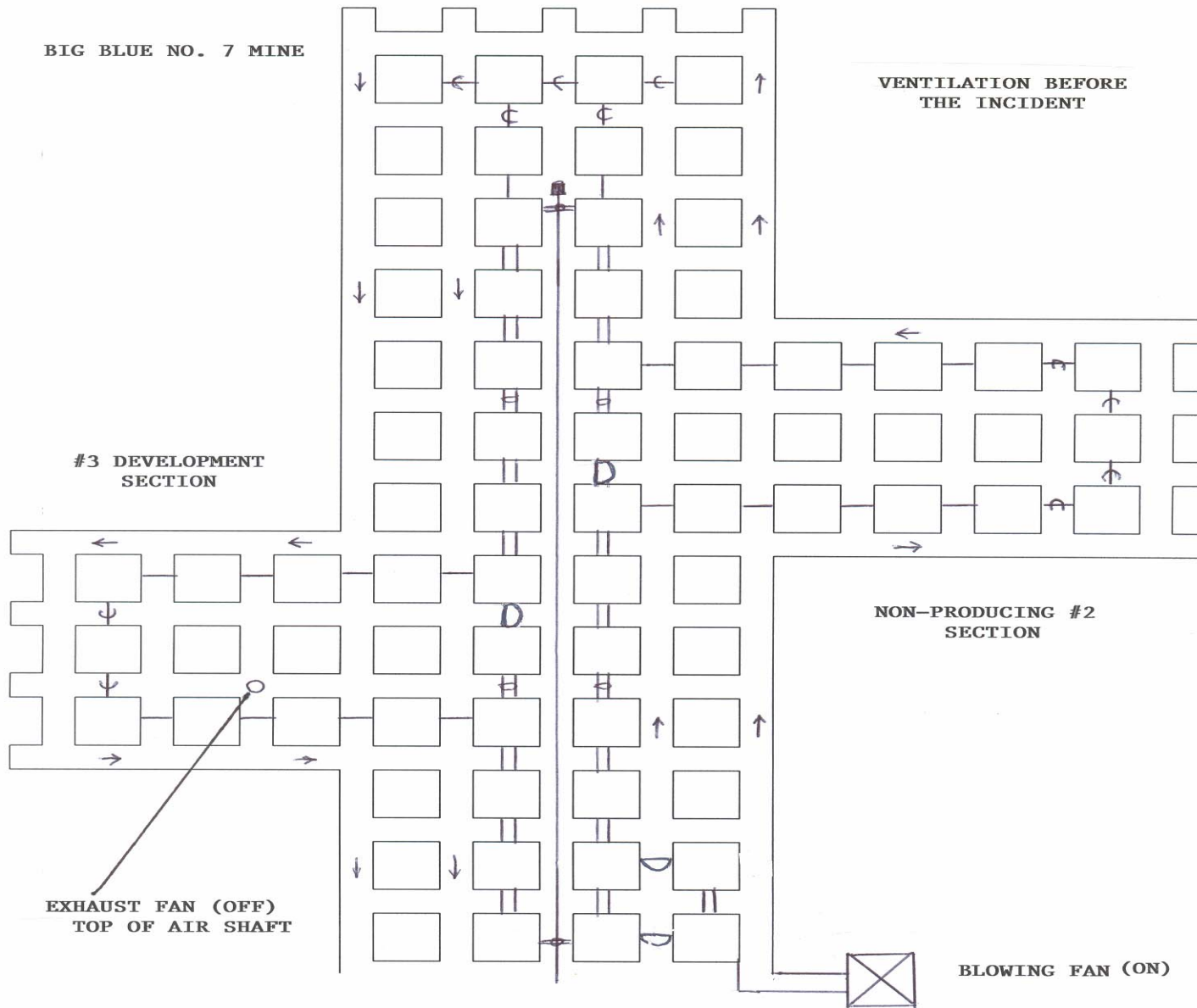

#1 SECTION

BIG BLUE NO. 7 MINE

VENTILATION AFTER
THE INCIDENT AND
AREA EXPLORED

CAVED AIR TIGHT

#3 SECTION

#2 SECTION

EXHAUST FAN (OFF)
TOP OF AIR SHAFT

BLOWING FAN (ON)

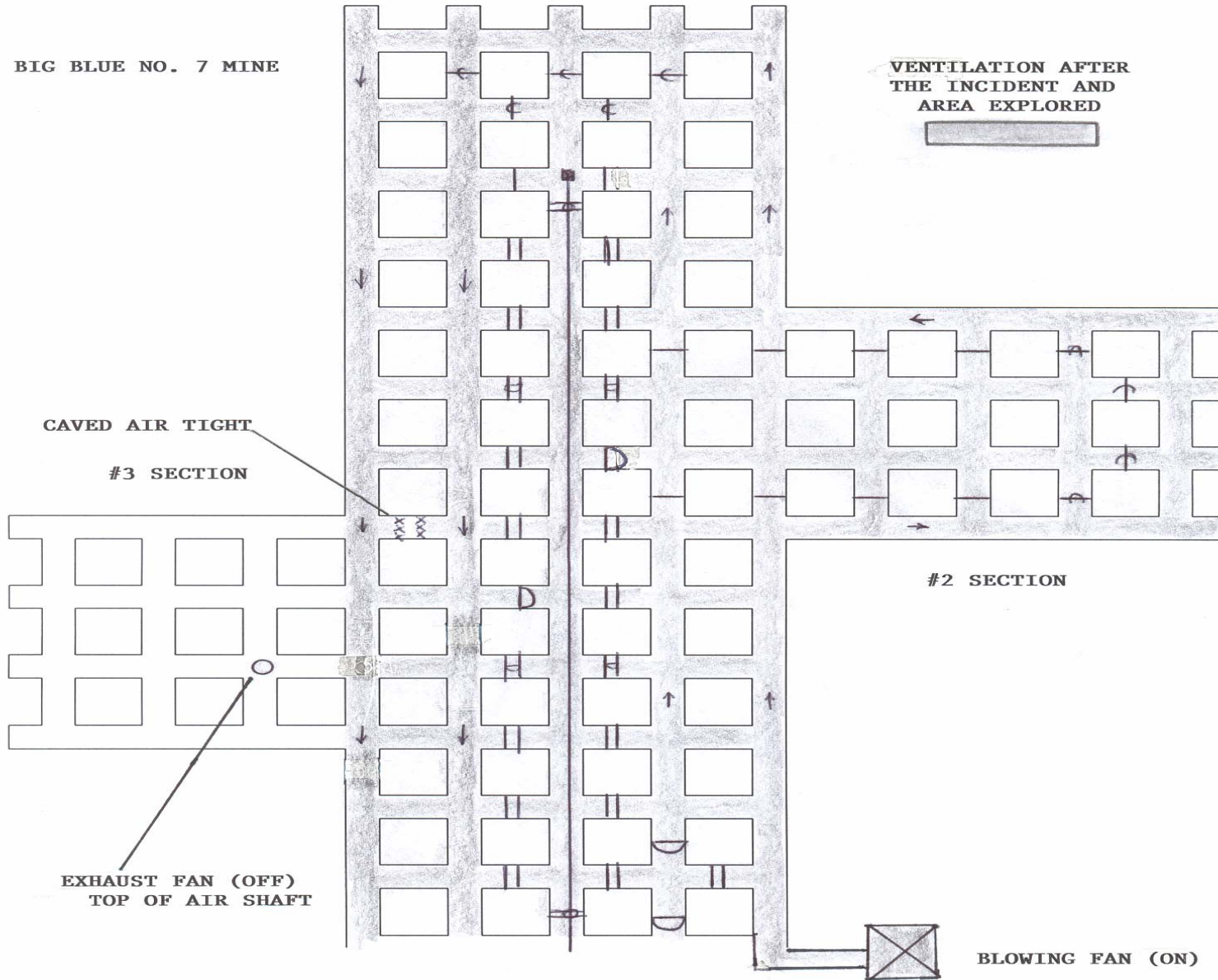

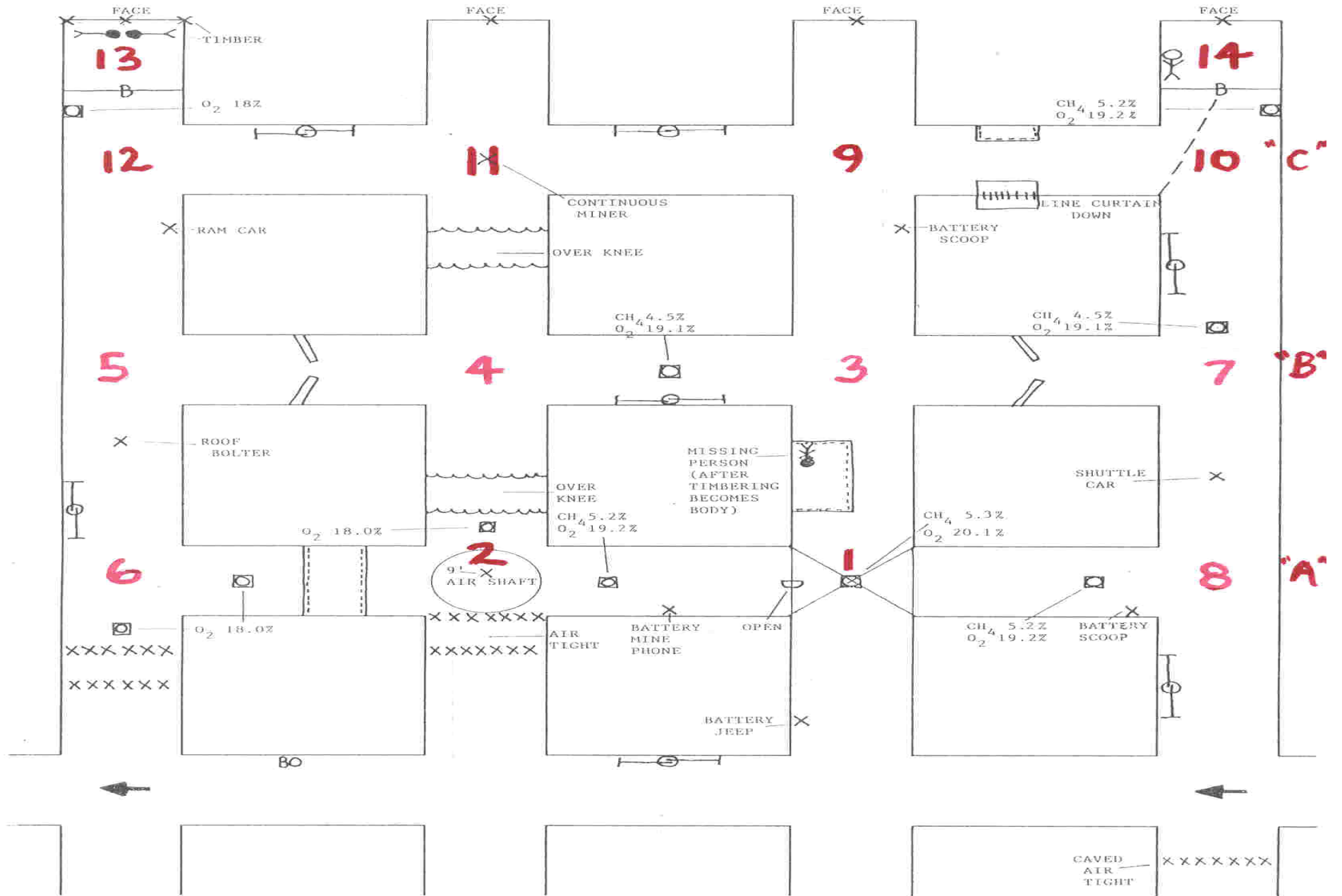

1ST VENTILATION

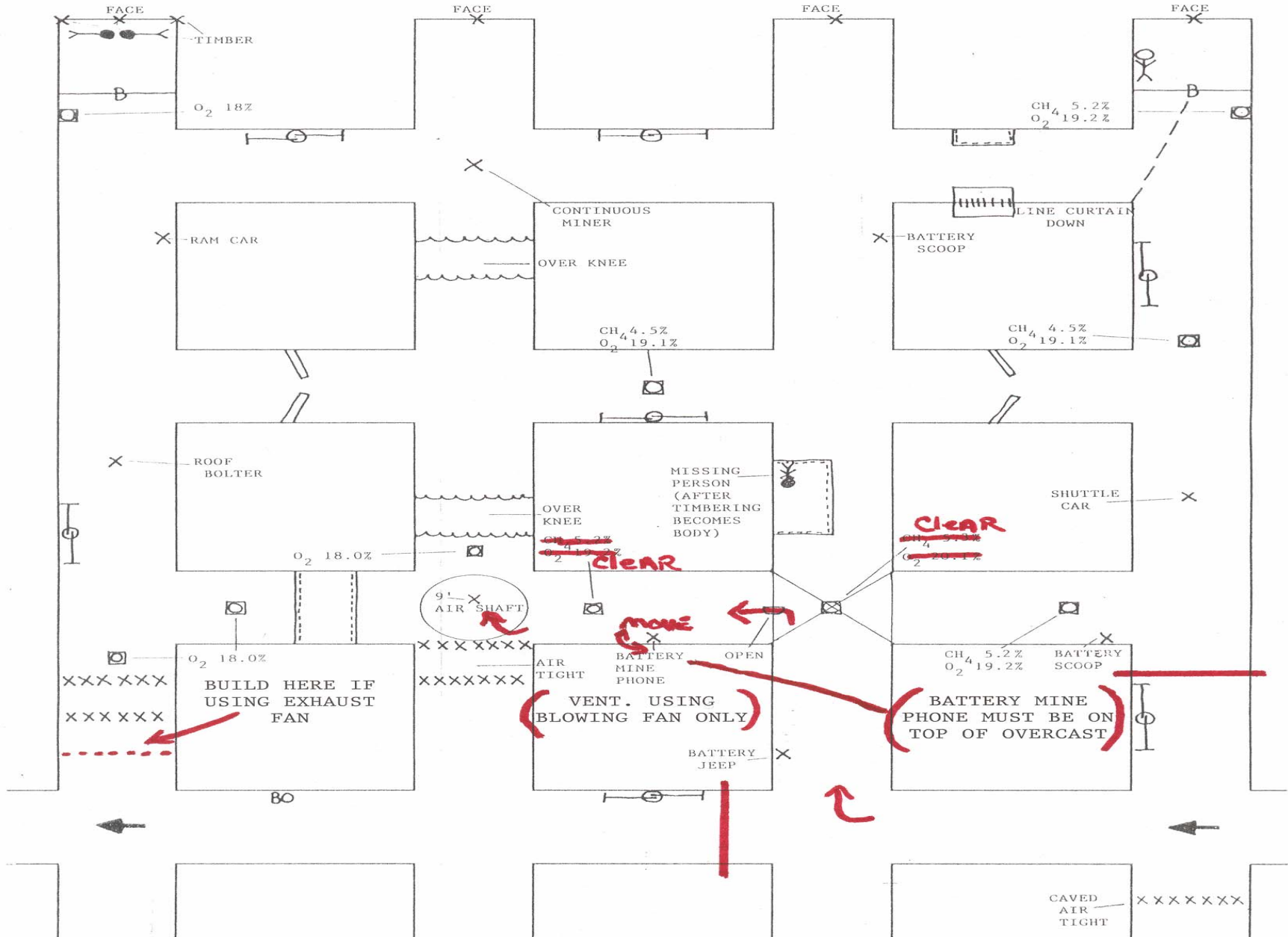

2ND ALTERNATE VENTILATION

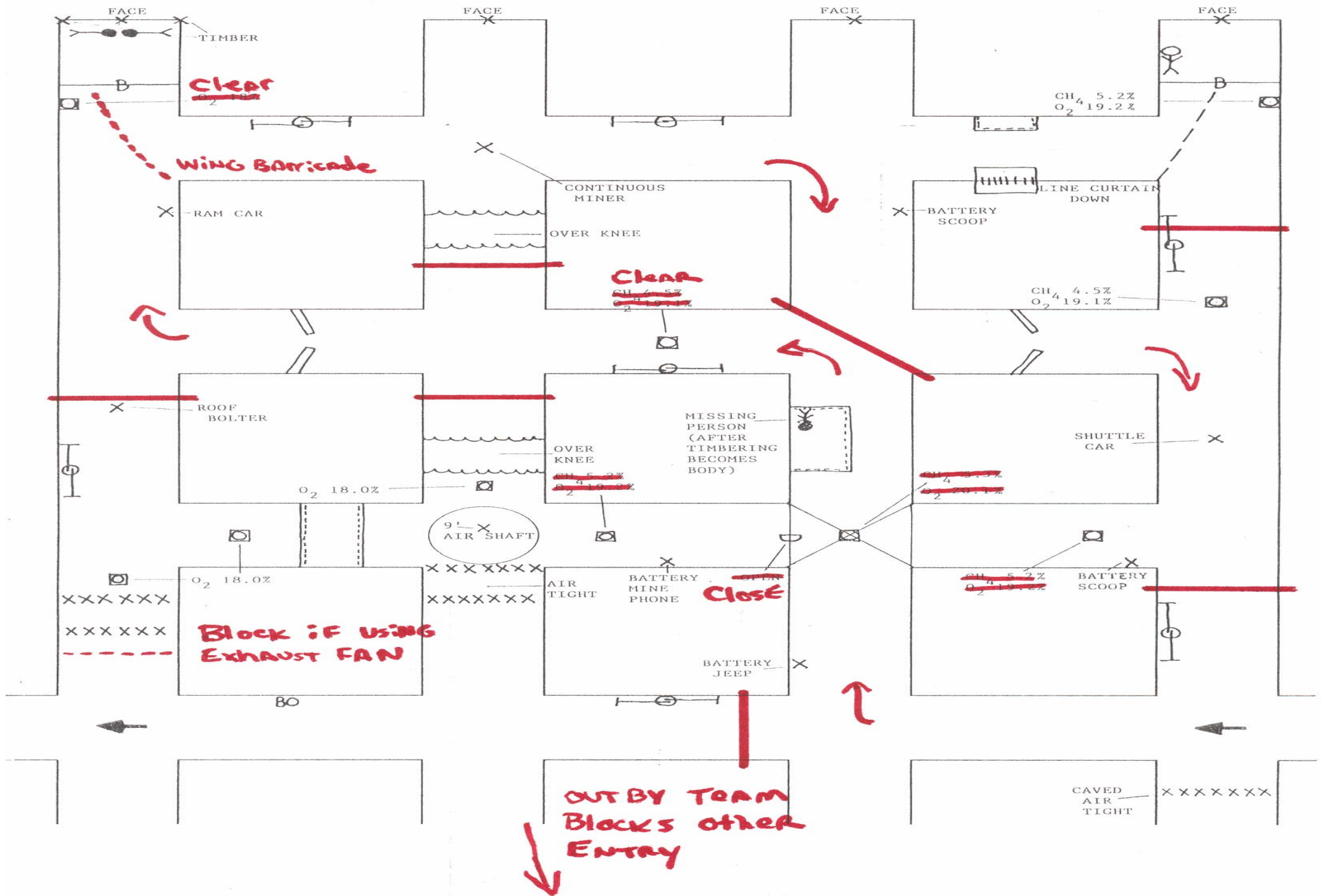

2ND Ventilation OUTBY

#1 SECTION

BIG BLUE NO. 7 MINE

VENTILATION AFTER
THE INCIDENT AND
AREA EXPLORED

CAVED AIR TIGHT

#3 SECTION

FOR
2ND
Ventilation

#2 SECTION

Contest
Team

EITHER
OF
TWO WAYS

This build by outby
Team & Contest Team
builds in FAB

These two Builds by
OUTBY Team & Contest
Team Builds in BY

EXHAUST FAN (OFF)
TOP OF AIR SHAFT

BLOWING FAN (ON)

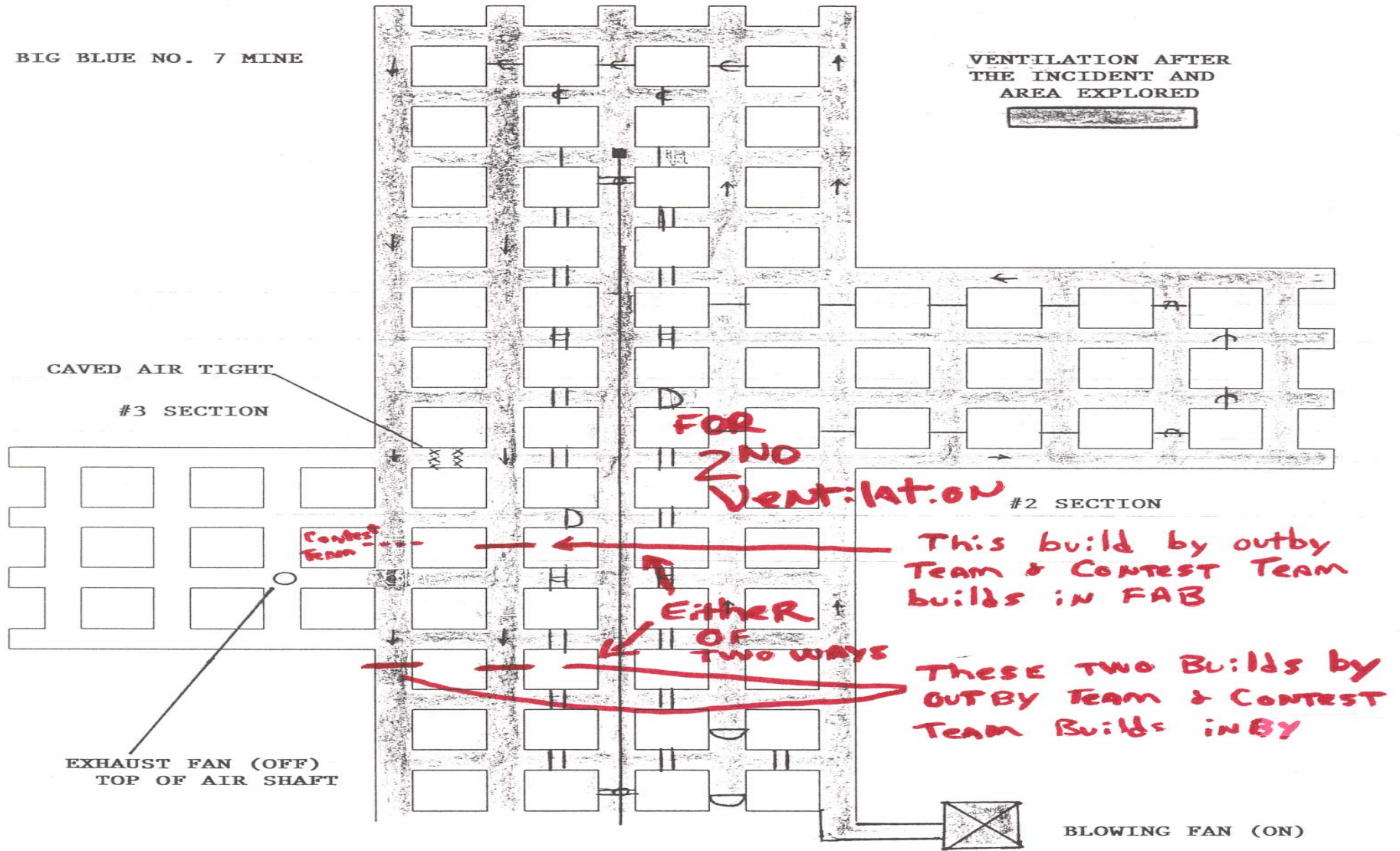

3RD VENTILATION

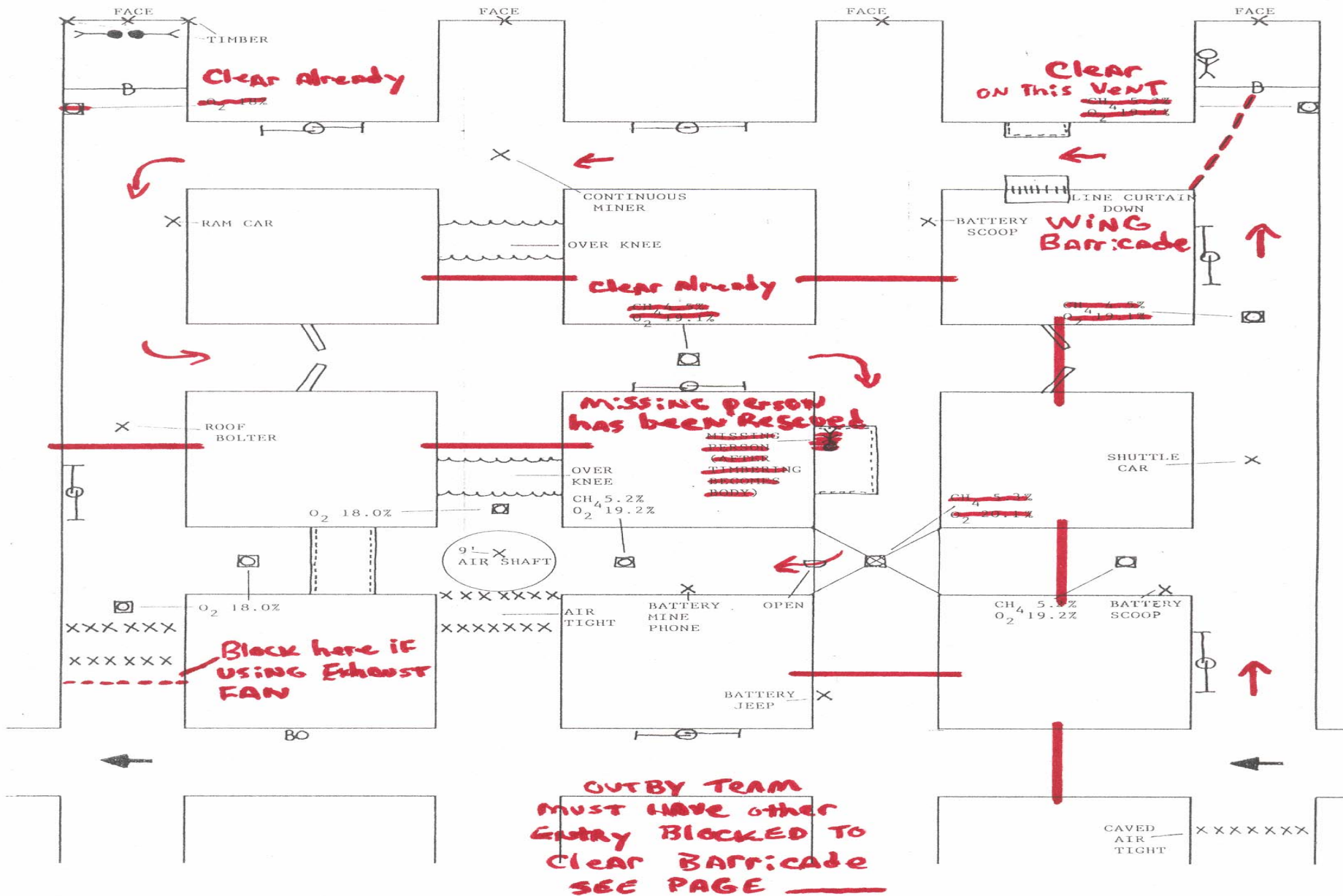

3RD Outby Ventilation

