

# Designing the Tempe Center for the Arts

Barton Myers Associates, Inc., based in Los Angeles, and ARCHITEKTON, based in Tempe, were the architects for the Tempe Center for the Arts. Before they could start designing the Tempe Center for the Arts, they had to understand what the city of Tempe wanted the center to do.



(L to R): John Kane, Doug Brown and Joe Salvatore, of Tempe-based ARCHITEKTON.

The architects needed to understand the function of the center as a place for traditional and experimental theater, dance and music performances; a place where people can go to see art exhibits; and a place to participate to other special events.

The architects made drawings (called renderings) of how they imagined the center would look from different angles inside and out. These renderings helped the people in charge of the project in Tempe to understand what the architects had in mind.





They made floor plans to show what the building would look like from above with no roof or ceiling.

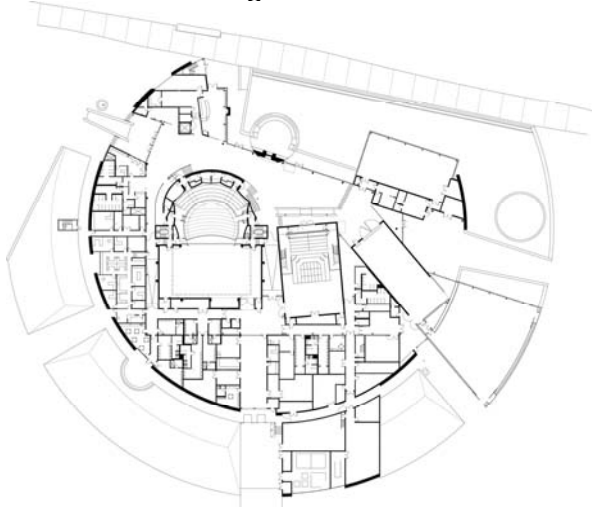

Architects also made three-dimensional models of a building to help others see how it would look when it was constructed



When the city of Tempe and the architects agreed on the plan, the architects made hundreds of specific drawings, called blueprints, to show how all the parts of the center should be constructed and put together to make the finished building.



Hundreds of people worked to build the center, from city administrators to contractors, engineers and trades people (excavators, steel workers, carpenters, electricians, plumbers and others). All used the architects' plans to complete the Tempe Center for the Arts.







