

**NOTE:**

1. Dimensions not labeled are in millimeters.
2. Lap longitudinal reinforcement not less than 325 mm.
3. Lap transverse reinforcement not less than 225 mm.
4. Eliminate all longitudinal and transverse reinforcing steel, wire, or bars where plain portland cement concrete pavement or base is required.
5. Provide the same type of dowel assemblies and tie bars for joints in plain portland cement concrete pavement as shown for joints in reinforced pavement.
6. Space transverse expansion joints at a minimum of 90 meters.
7. Space transverse contraction joints for reinforced concrete pavement at not more than 12 meter intervals and for plain concrete pavement or base at not more than 6 meter intervals.
8. See Standard M501-2 for Joint Details and Joint Sealing Details.

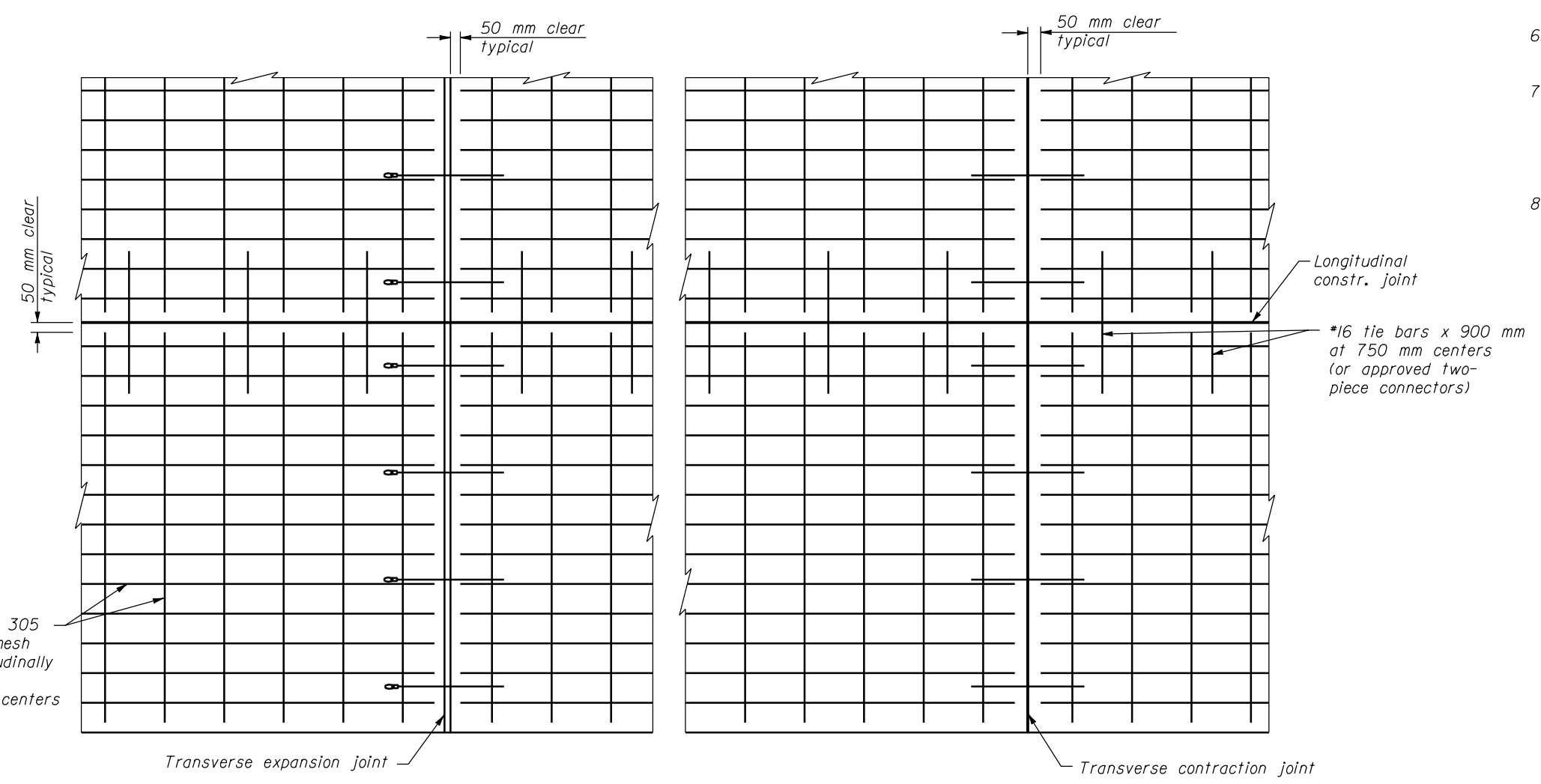

PLAN

NO SCALE

U.S. DEPARTMENT OF TRANSPORTATION FEDERAL HIGHWAY ADMINISTRATION FEDERAL LANDS HIGHWAY	
<b>METRIC STANDARD</b>	
<b>PORTLAND CEMENT CONCRETE PAVEMENT</b>	
STANDARD APPROVED FOR USE 3/1996 REVISED: 5/1997	STANDARD <b>M501-1</b>

16 NOV 2000

f:\standrow\metric\ms+501\dgn