

**DETAIL A**  
Passing zone both directions  
Two-way traffic

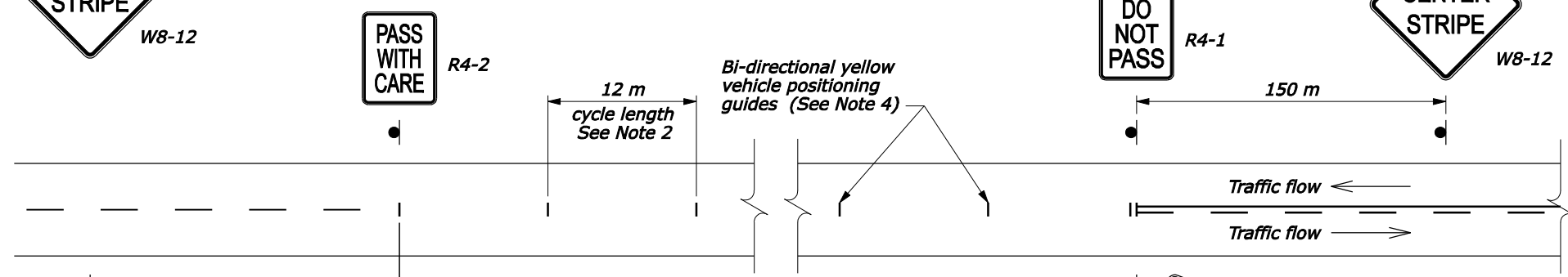

**DETAIL B**  
No Passing zone one direction  
Two-way traffic

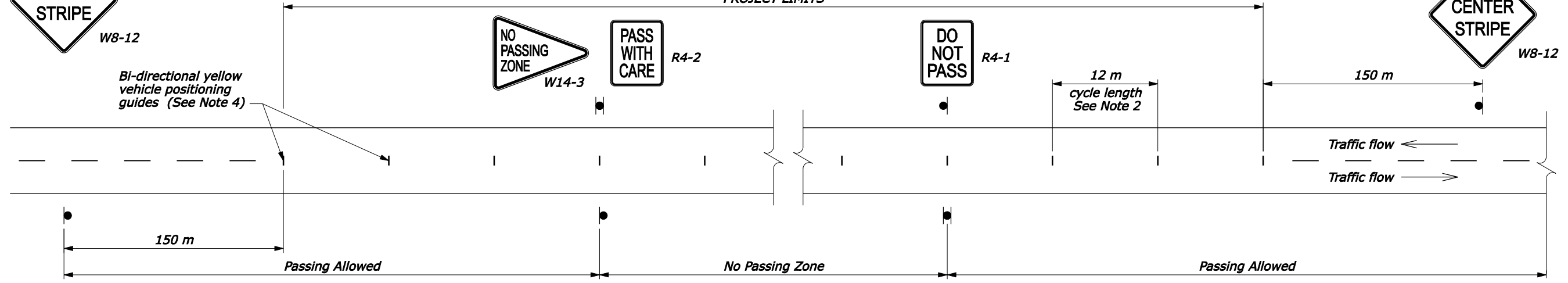

**DETAIL C**  
No Passing zone both directions  
Two-way traffic

**NOTE:**

1. For periods noted in Table A, pavement may be unmarked if vehicle positioning guides and signing are provided per this detail. For longer periods/higher ADT or for application of temporary markings with paint or tape, use Standard M635-2.
2. On curves with radius less than 150 m, reduce cycle length to 6 m.
3. Use permanent markings plan to determine no passing zones for each direction of travel.
4. Ensure vehicle positioning guides meet the requirements of Sub-Section 718.21(b), Raised pavement markers.
5. Repeat R4-1 at 1.5 km intervals.
6. Repeat W8-12 after each major intersection.
7. If signs will be in place more than 72 consecutive hours, use ground-mounted post.

ADT	Maximum Duration Before Markings Are Required
≤ 1000	14 Days
> 1000	3 Days

U.S. DEPARTMENT OF TRANSPORTATION  
FEDERAL HIGHWAY ADMINISTRATION  
FEDERAL LANDS HIGHWAY  
METRIC STANDARD

**DELINEATION AND SIGNING  
FOR UNMARKED PAVEMENTS**

STANDARD APPROVED FOR USE 6/1998  
REVISED: 6/2005  
DRAFT: 1/2007

STANDARD  
M635-3

NO SCALE