

NOTE:

1. For periods noted in Table A, pavement may be unmarked if vehicle positioning guides and signing are provided per this detail. For longer periods/higher ADT or for application of temporary markings with paint or tape, use Standard 635-2.
2. On curves with radius less than 500', reduce cycle length to 20'.
3. Use permanent markings plan to determine no passing zones for each direction of travel.
4. Ensure vehicle positioning guides meet the requirements of Sub-Section 718.21(b), Raised pavement markers.
5. Repeat R4-1 at 1 mile intervals.
6. Repeat W8-12 after each major intersection.
7. If signs will be in place more than 72 consecutive hours, use ground-mounted post.

ADT	Maximum Duration Before Markings Are Required
≤ 1000	14 Days
> 1000	3 Days

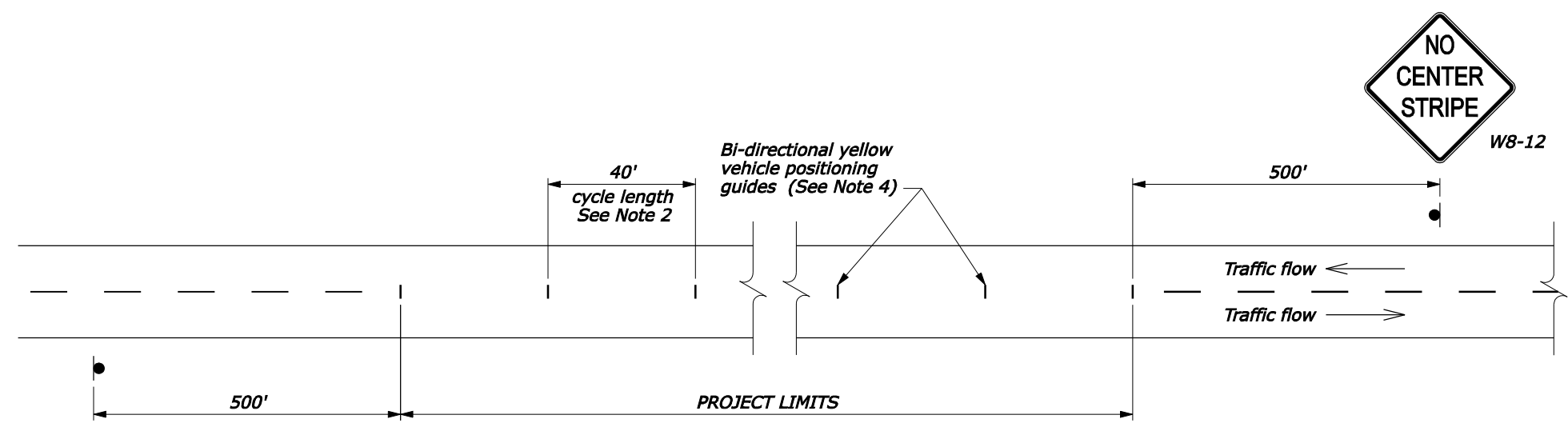

DETAIL A
Passing zone both directions
Two-way traffic

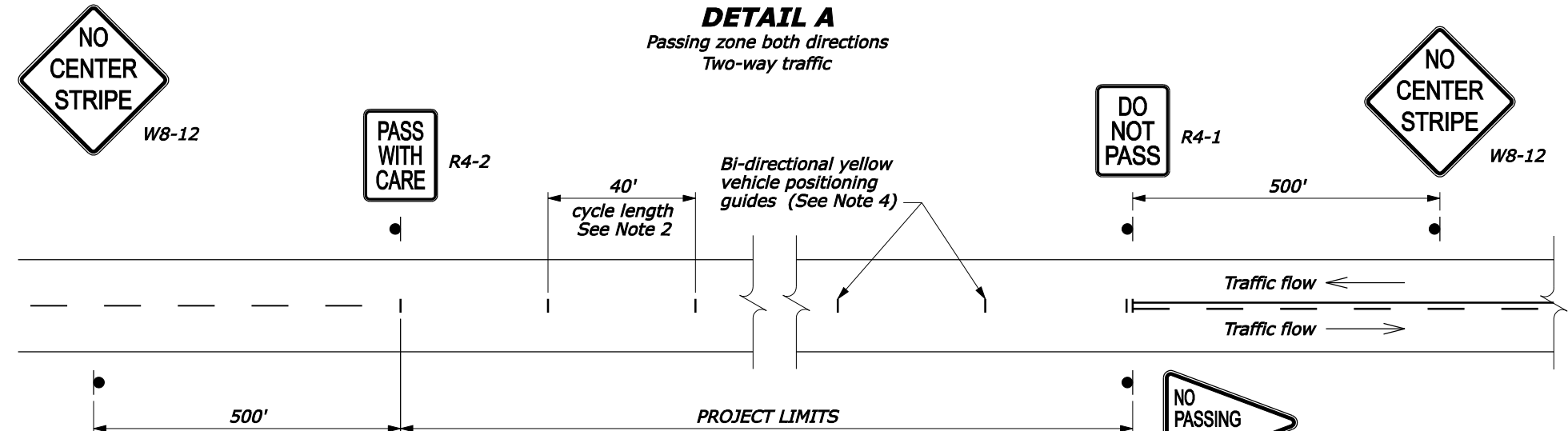

DETAIL B
No Passing zone one direction
Two-way traffic

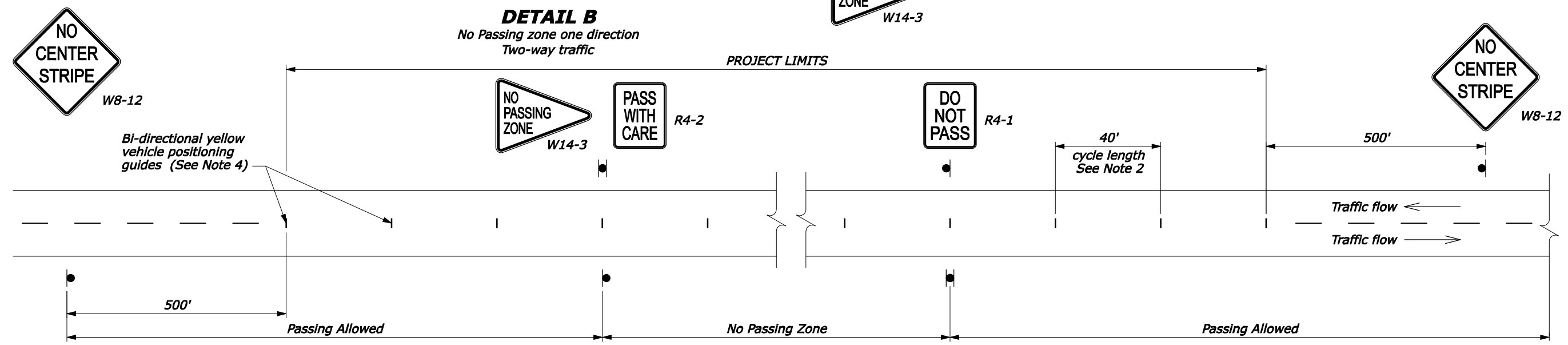

DETAIL C
No Passing zone both directions
Two-way traffic

NO SCALE

U.S. DEPARTMENT OF TRANSPORTATION
FEDERAL HIGHWAY ADMINISTRATION
FEDERAL LANDS HIGHWAY

U.S. CUSTOMARY STANDARD

**DELINEATION AND SIGNING
FOR UNMARKED PAVEMENTS**

STANDARD APPROVED FOR USE 6/2005	STANDARD
REVISED: DRAFT: 1/2007	635-3

F:\StdDraw\std63503.dgn [US Customary] 24-Jan-2007 05:19 PM