

7 6 5 4 3 2 1

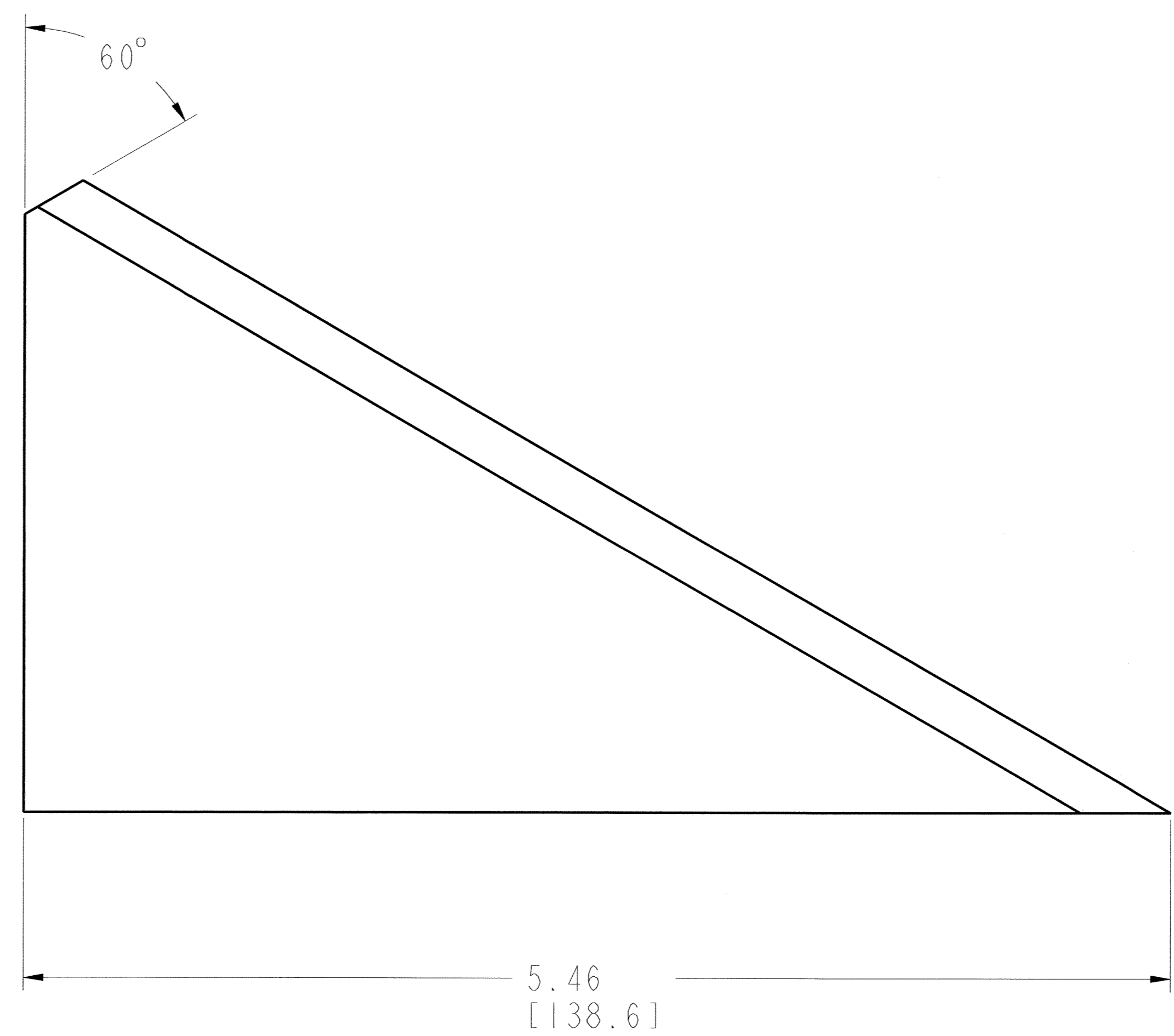
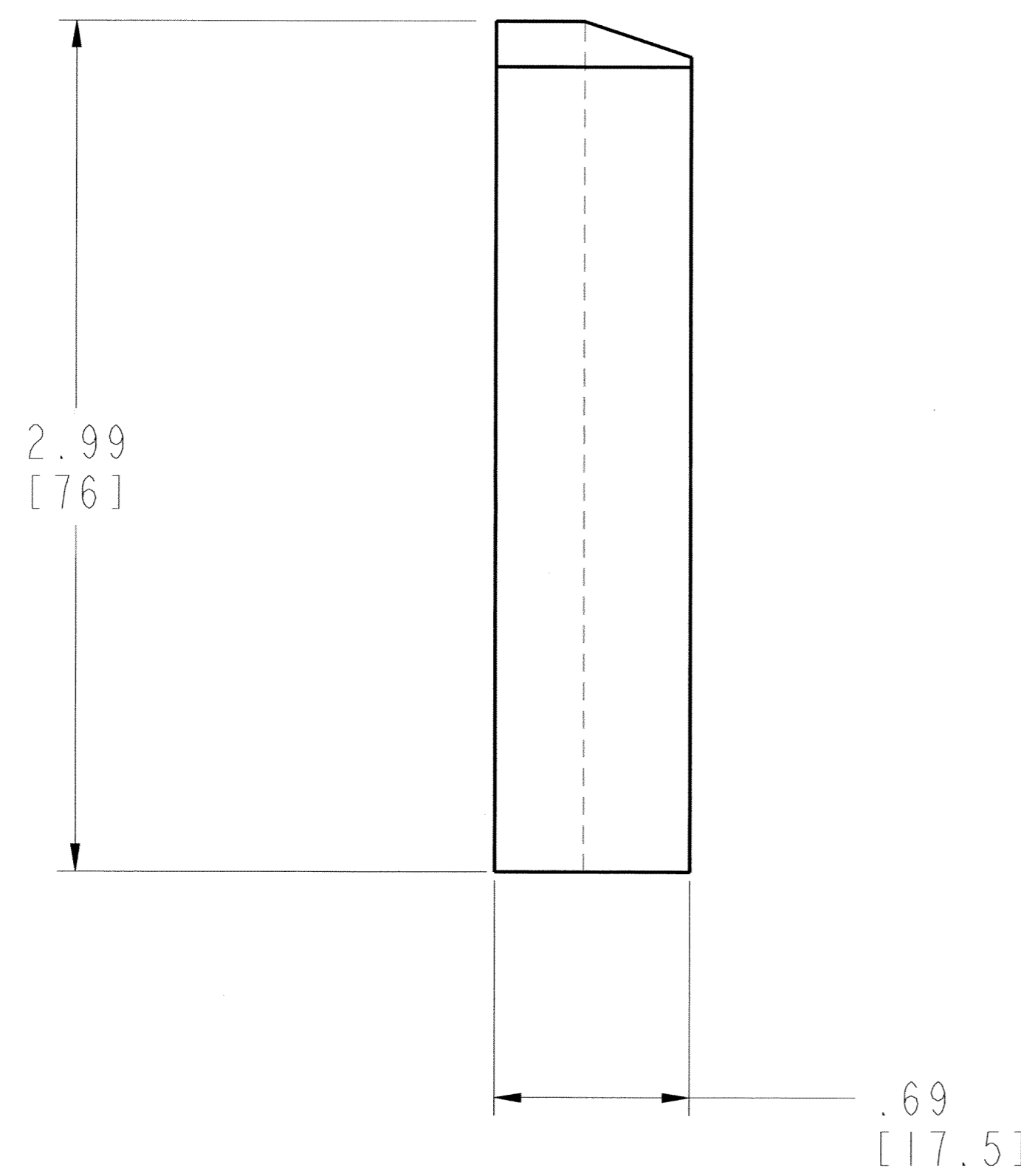

MATERIAL:
ALLOY 22 UNS N06022

- NOTES:
1. ALL DIMENSIONS ARE IN INCHES, MILLIMETERS ARE IN BRACKETS.
 2. ALL DIMENSIONS ARE REFERENCE ONLY.
 3. DO NOT SCALE FROM DRAWING.
 4. THE EMPLACEMENT PALLET IS NOT A SAFETY CATEGORY ITEM. HOWEVER, THE QARD IS APPLICABLE BECAUSE EMPLACEMENT PALLET DESIGN INFORMATION IS USED IN SUPPORT OF PERFORMANCE ASSESSMENT ACTIVITIES.
 5. WELD PREPARATIONS ARE NOT DIMENSIONED.

THIS DRAWING IS PRELIMINARY AND NOT INTENDED FOR CONSTRUCTION, PROCUREMENT OR FABRICATION.

DESIGN INPUTS
SEE DOCUMENT INPUT REFERENCE SYSTEM (DIRS)

APPROVALS		INITIAL/DATE	U.S. DEPARTMENT OF ENERGY Yucca Mountain Site Characterization Project BECHTEL Civilian Radioactive Waste Management System SAIC MANAGEMENT & OPERATING CONTRACTOR DESIGN AND ENGINEERING EMPLACEMENT PALLET ASSEMBLY PLATE 7								
DRAWN	DAN MCKENZIE	JH 2/18/04									
ORIGINATOR	DAN MCKENZIE	JH 2/18/04									
CHECKED	ADAM SCHEIDER	AS 2/18/04									
VERIFICATION	NA										
DESIGN LEAD ENGINEER	ADAM SCHEIDER	AS 2/18/04									
QUALITY ENGINEERING REP	JERRY HEANEY	JH 2/18/04	SIZE: D								
PROJECT ENGINEER	CARL CHAGNON	CC 2-18-04	SCALE: NONE								
REV	DESCRIPTION	DATE	DRN	ORG	CHK	VER	EQS	QER	PE	DOCUMENT IDENTIFIER: 000-M00-SSE0-00310-000-00A	REV
00A	INITIAL ISSUE	2-18-04									10 OF 15

RECORD DESIGNATOR QA:QA

NAME: MCKENZIE, DAN; OBJECT: EMPLACEMENT_PALLETS_ASSEMBLY_10; DATE: 17-Feb-04 16:23;

8 7 6 5 4 3 2 1