

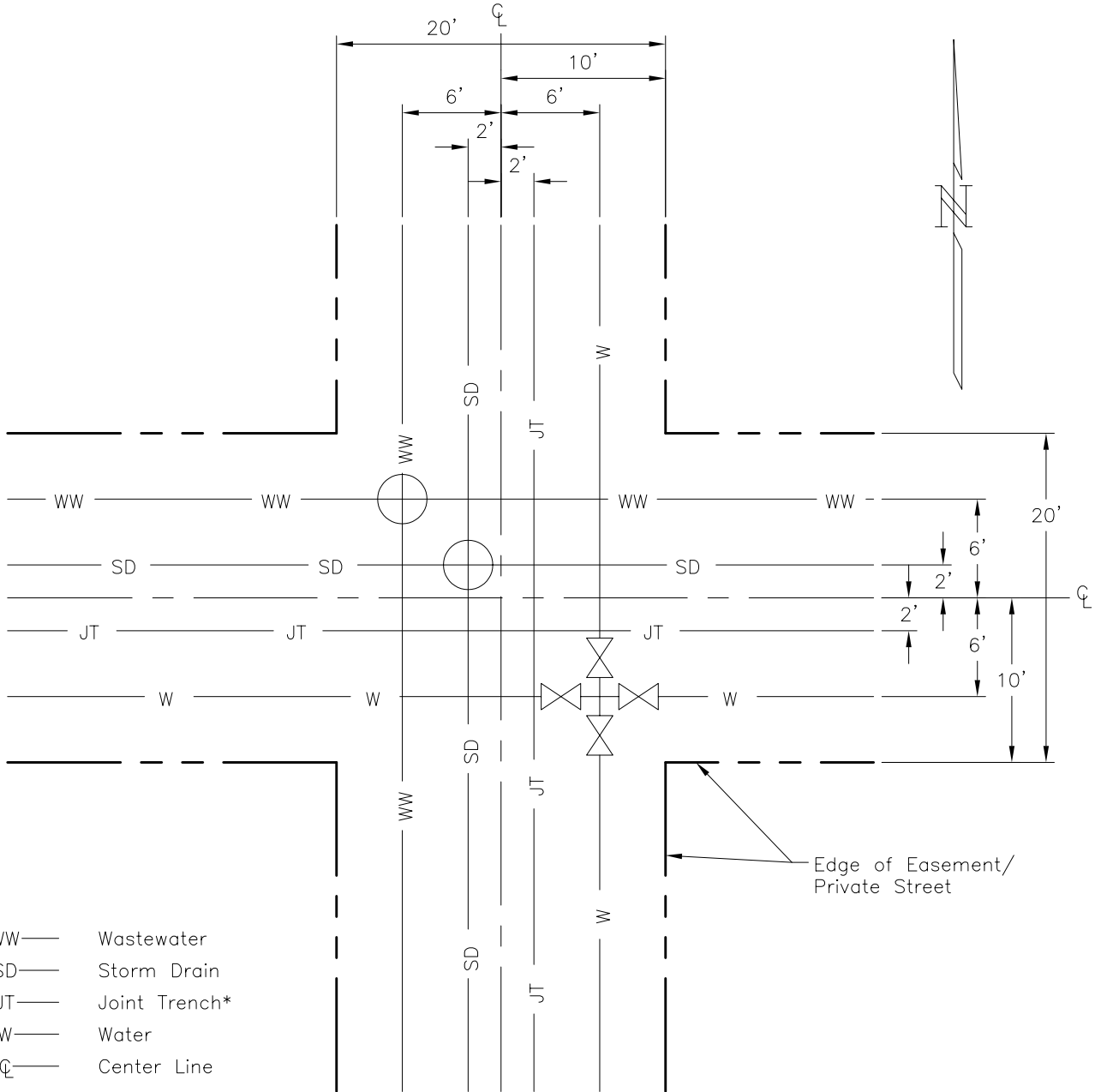

CITY OF LODI

PUBLIC WORKS DEPARTMENT

Standard Utility Locations In Easements/ Private Streets



* See Std Plan 507 for Details

Notes:

Private utilities to be located outside of limits shown unless otherwise approved by the Public Works Department.

Dr. KT	No.	Date	Revision	Appr.	Approved By:	STD PLAN
Ch. WS					<i>F. Wally Sandelin</i>	602
Date 12/00					F. Wally Sandelin City Engineer R.C.E. 39895	12/28/00 Date